

**4' HIGH WOVEN WIRE FENCE**  
 RTE 289 STA 716+00, 115' RT TO RTE 289 STA 717+43, 115' RT  
 RTE 289 STA 717+43, 115' RT TO RTE 289 STA 728+00, 115' RT  
 RTE 289 STA 716+00, 150' LT TO RTE 289 STA 722+00, 160' LT  
 RTE 289 STA 722+00, 160' LT TO RTE 289 STA 724+50, 155' LT  
 RTE 289 STA 724+50, 155' LT TO RTE 289 STA 725+60, 106' LT  
 RTE 289 STA 725+60, 106' LT TO RTE 289 STA 726+70, 139' LT  
 RTE 289 STA 726+70, 139' LT TO RTE 289 STA 728+00, 127' LT

**VERMONT ELECTRIC POWER CO., INC.  
 (LOSS OF ACCESS)**

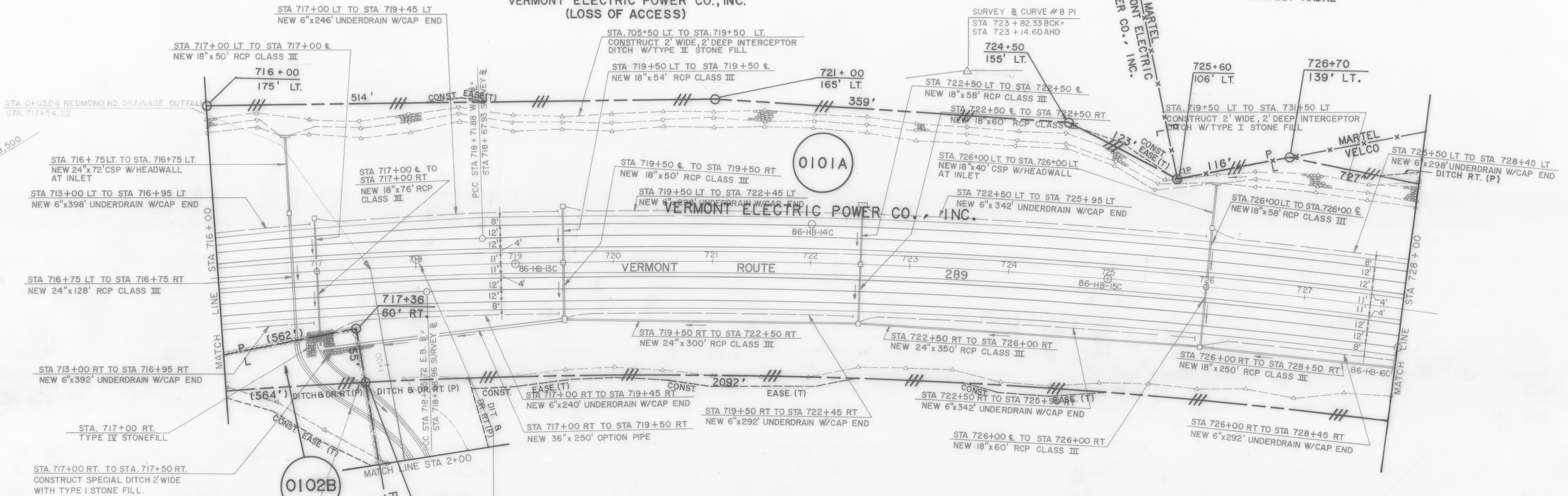

**CURVE # 8 DATA RTE 289**  
 R = 6000'  
 Δ = 29°10'11.04"  
 L = 3054.65'  
 T = 1561.19'  
 E = 199.78'  
 D = 0° 57' 17.75"

B.M.  
 SPIKE IN A 2" STUMP  
 718+00 2' LT  
 564.56

VERMONT ELECTRIC POWER CO., INC.

DATUM  
 VERTICAL \_\_\_\_\_  
 HORIZONTAL \_\_\_\_\_

**R. O. W. PLANS**

SURVEYED BY PINKHAM ENG. DATE 6/87  
 DRAWN BY D. R. O. DATE 12/88  
 TRACED BY A. P. P. DATE 12/88  
 VERMONT ROUTE 289 (F.A.P.)  
 TOWN OF WILLISTON  
 PROJ WILLISTON- NO. PB 033-1(1)  
 COLCHESTER  
 SHEET 16 OF 35