

END ROAD WORK

**BEGIN PROJECT
STP BIKE (27) S
STA 1+000.00
(MATCH EXISTING)**

SIDE ROAD WORK AHEAD

END ROAD WORK

NOTES:

1. CONTRACTOR TO MAINTAIN CIRCULATION OF TRAFFIC IN THE PRESTON MUNICIPAL PARKING LOT DURING CONSTRUCTION.
2. ALL TRAFFIC CONTROL MEASURES AND DEVICES TO BE INSTALLED PRIOR TO ANY CONSTRUCTION AND SHALL MEET THE REQUIREMENTS SET FORTH IN THE MANUAL ON UNIFORM TRAFFIC CONTROL DEVICES (MUTCD 2003).
3. CONTRACTOR SHALL ALLOW THE NECESSARY ACCESS FOR DELIVERY TRUCKS AT THE BAST CORPORATION BUILDING THROUGHOUT THE CONSTRUCTION PERIOD.
4. ALL EXISTING PARKING NOT SHOWN SHALL REMAIN UNDISTURBED DURING CONSTRUCTION.
5. THE CONTRACTOR SHALL BE RESPONSIBLE FOR ALL TRAFFIC CONTROL, INCLUDING SIGNING, BARRICADES, NOTIFICATION TO LOCAL OFFICIALS AND PROPERTY OWNERS OF SCHEDULED DELAYS AND/OR CLOSURES, AND ANY OTHER ITEMS DEEMED NECESSARY BY THE ENGINEER. ALL TEMPORARY TRAFFIC CONTROL DEVICES SHALL BE IN ACCORDANCE WITH THE APPLICABLE VAOT "E-SERIES" STANDARD DRAWINGS. THIS WORK SHALL BE PAID UNDER ITEM 641.10 "TRAFFIC CONTROL". FLAGGERS ARE TO BE PAID FOR UNDER ITEM 630.15 "FLAGGERS".
6. EXISTING TEMPORARY BRIDGE TO BE REMOVED BY OWNER. BRIDGE SHALL BE LEFT IN PLACE AS LONG AS PRACTICAL FOR PEDESTRIAN ACCESS BETWEEN THE PRESTON MUNICIPAL PARKING LOT AND BROOKSIDE PLAZA PARKING LOT. CONTRACTOR MUST GIVE THE TOWN ONE MONTH'S WRITTEN NOTICE BEFORE THE BRIDGE NEEDS TO BE REMOVED. DURING THIS TIME, THE TOWN SHALL COORDINATE THE REMOVAL OF THE EXISTING TEMPORARY BRIDGE WITH THE CONTRACTOR.
7. STATIONS ARE GIVEN IN KILOMETERS AND DIMENSIONS ARE GIVEN IN MILLIMETERS.

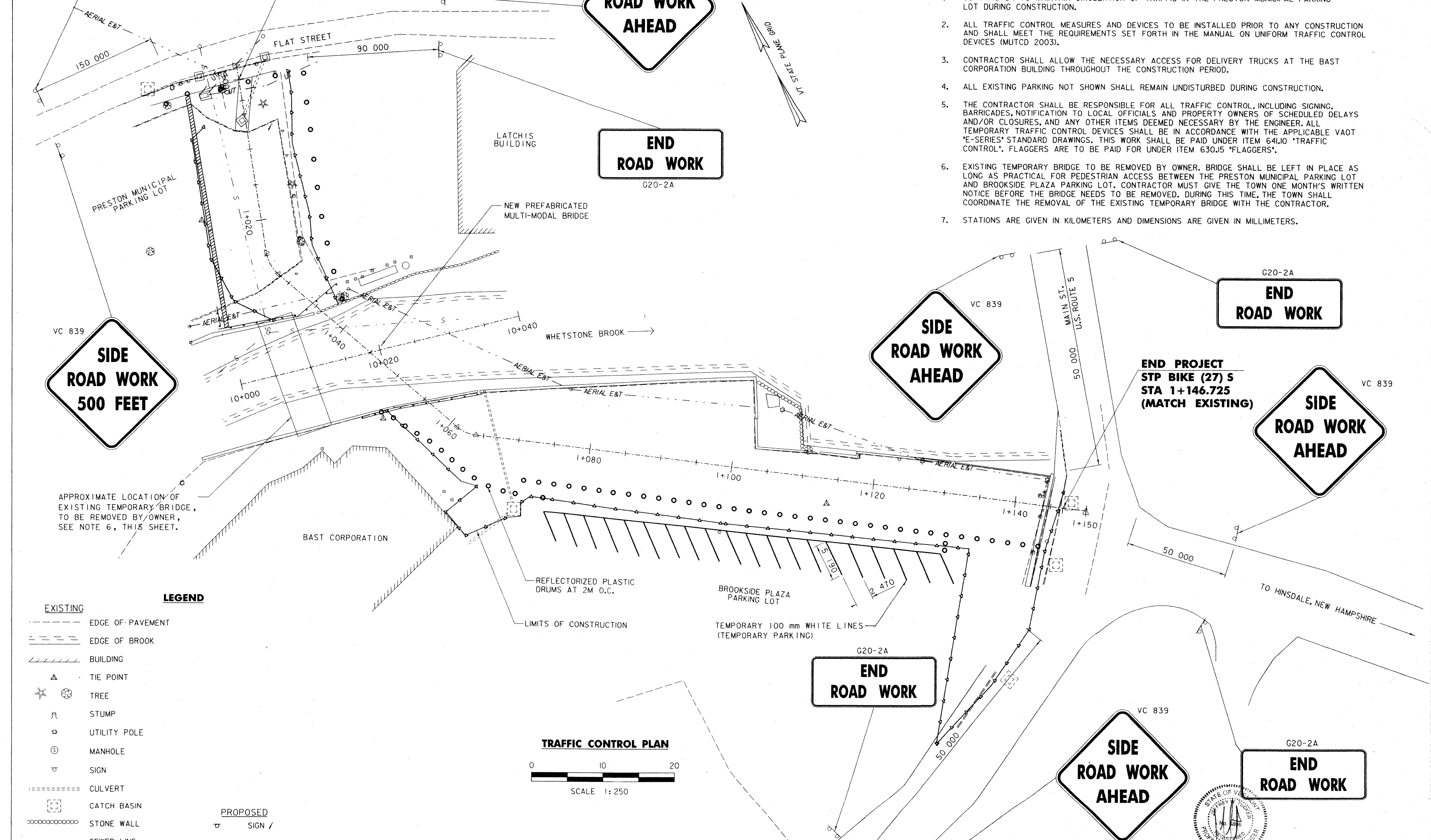

SIDE ROAD WORK 500 FEET

SIDE ROAD WORK AHEAD

END ROAD WORK

SIDE ROAD WORK AHEAD

**END PROJECT
STP BIKE (27) S
STA 1+146.725
(MATCH EXISTING)**

END ROAD WORK

SIDE ROAD WORK AHEAD

END ROAD WORK

LEGEND

- EXISTING**
- EDGE OF PAVEMENT
 - EDGE OF BROOK
 - /// BUILDING
 - ▲ TIE POINT
 - * TREE
 - ⊥ STUMP
 - ⊕ UTILITY POLE
 - ⊙ MANHOLE
 - ⊖ SIGN
 - CULVERT
 - ⊠ CATCH BASIN
 - ⊘ STONE WALL
 - S- SEWER LINE
 - AERIAL E&T- AERIAL E+T

- PROPOSED**
- ⊖ SIGN
 - CULVERT
 - LIMITS OF CONSTRUCTION
 - TEMPORARY TRAFFIC BARRIER
 - TEMPORARY PAVEMENT MARKING

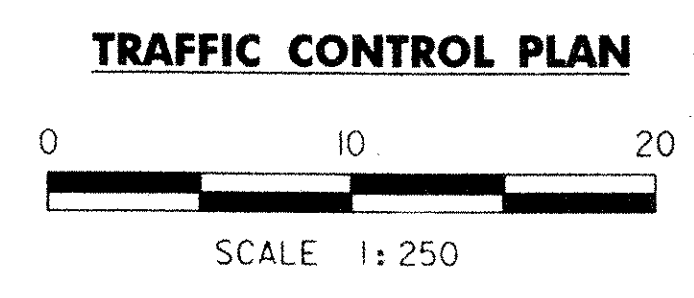

DATUM

VERTICAL	NVD 88
HORIZONTAL	NAD 83

DuBois & King
engineering planning management development

TOWN OF BRATTLEBORO
BRATTLEBORO, VERMONT
WHETSTONE BROOK PATHWAY PROJECT
STP BIKE (27) S
TRAFFIC CONTROL SHEET

DRAWN BY	SJB	DATE	FEB. 2004
CHECKED BY	JOH	PROJ. NO.	R16544
PROJ. ENG.	SDA	DRAW. NO.	11446
			SHEET 18 OF 30

PLOTTED: 03/11/2004