

MONUMENT FOOTING PLAN
SCALE 1:30

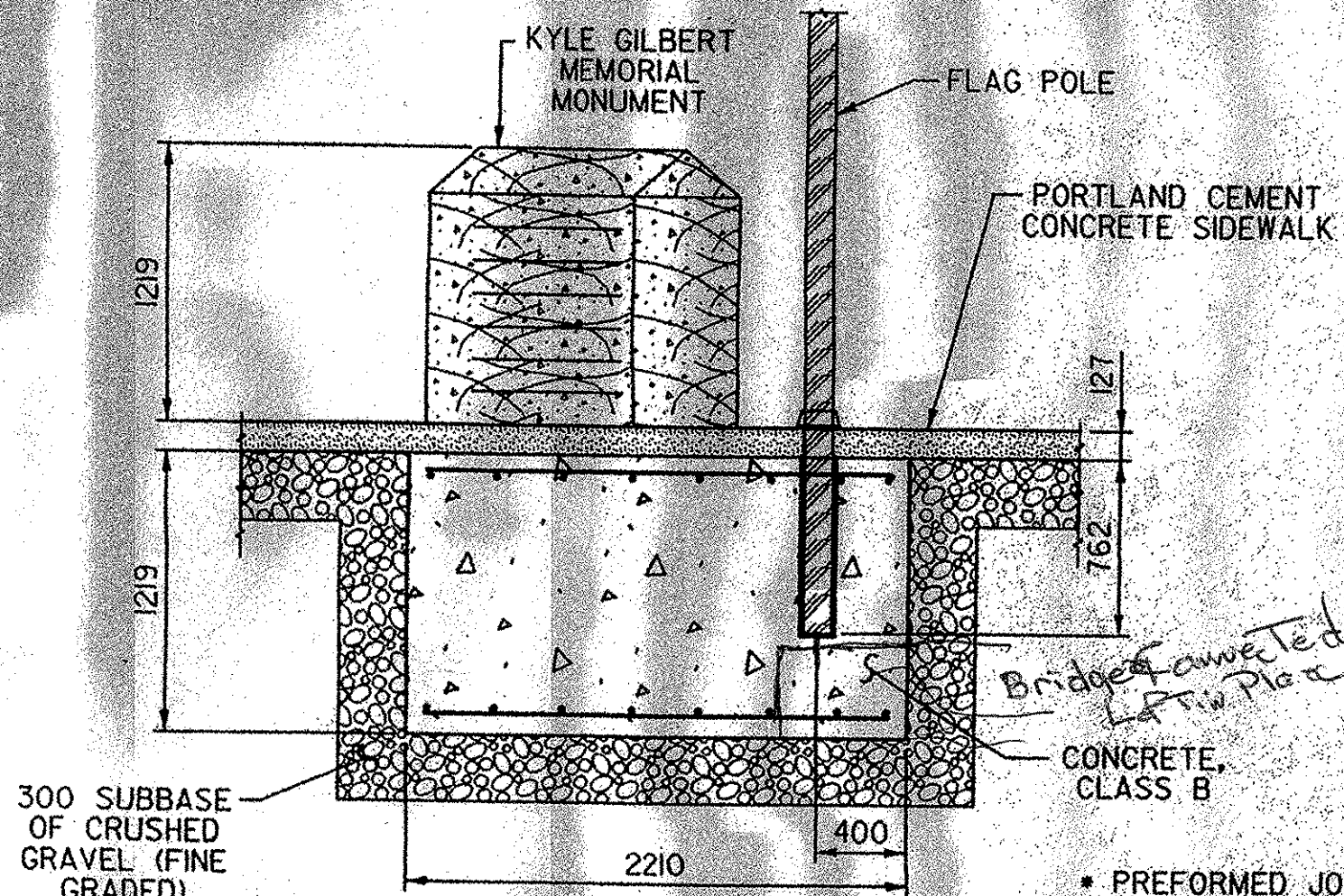

MONUMENT FOOTING ELEVATION
SCALE 1:30

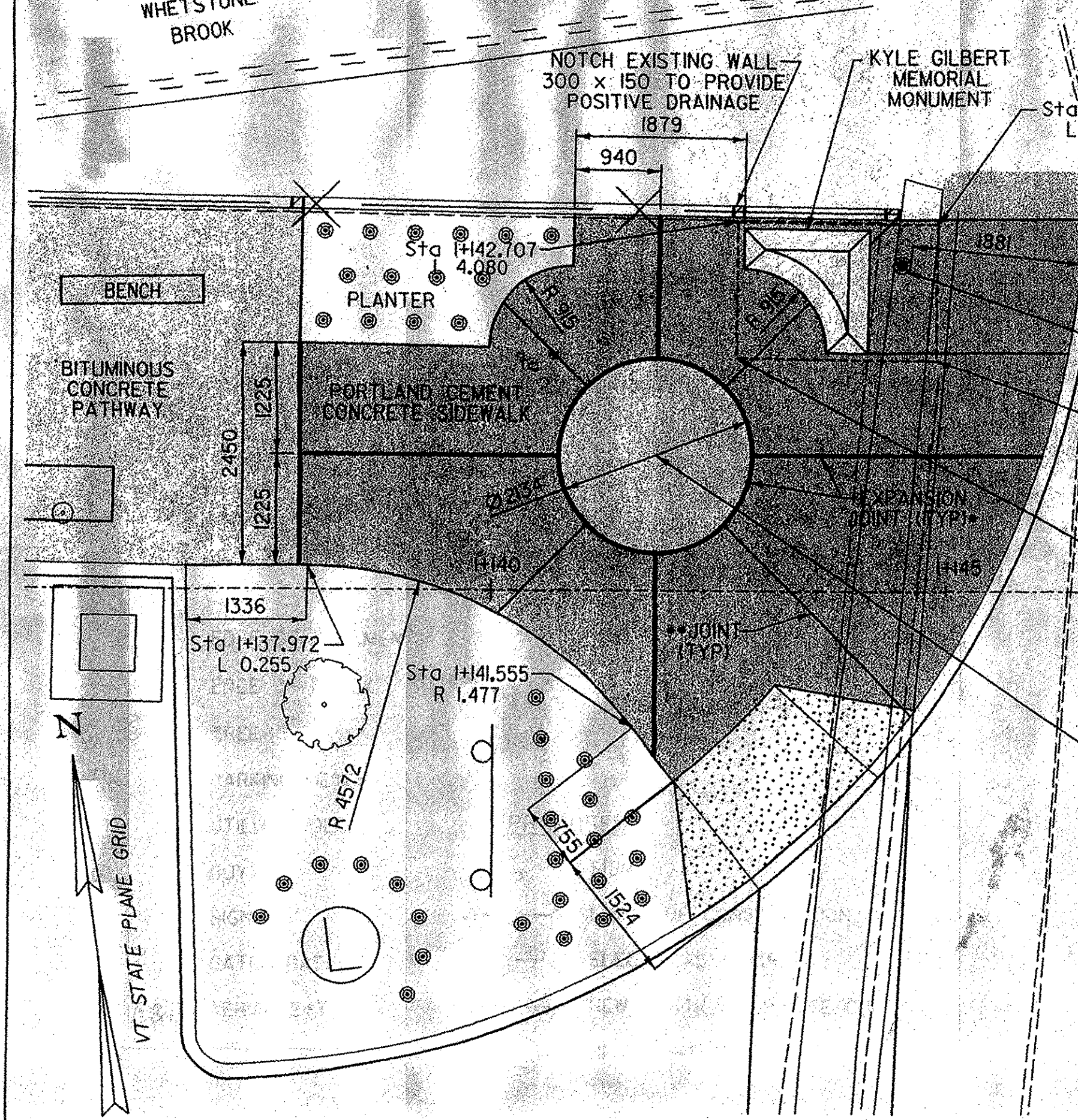

MONUMENT & STREETPRINT LAYOUT
SCALE = 1:50

DATUM
VERTICAL NVD 88
HORIZONTAL NAD 83

EXISTING SIGN ASSEMBLY TO BE RELOCATED
GRANITE MONUMENT WITH CONCRETE FOOTING TO FROST DEPTH (SEE DETAILS THIS SHEET)
EXISTING PARKING METER TO BE REMOVED BY OWNER (TYP.)
STREETPRINT PANEL (2.14m DIA.) Exposed Aggregate

APPROXIMATE LOCATION OF RELOCATED FIRE BOX
STA. H+140.000, OFFSET 0.000 RT
FINAL LOCATION TO BE DETERMINED IN THE FIELD BY THE TOWN.
MATERIALS TO BE PROVIDED BY THE TOWN. CONTRACTOR SHALL INSTALL. PAYMENT SHALL BE INCIDENTAL TO ITEM 635.10 "MOBILIZATION".

STA. H+136.490
OFFSET 0.107 LT

NEW LOCATION OF SIGN ASSEMBLY
STA. H+140.000,
OFFSET 2.500 RT

NEW LIGHT POLE AND LUMINAIRE (TYP.)
STA. H+138.359,
OFFSET 3.908 RT
SEE DETAIL, SHEET 22.

• PREFORMED JOINT FILLER 5mm THICK SHALL BE INSTALLED IN THE EXPANSION JOINTS. JOINTS SHALL EXTEND FOR THE FULL DEPTH OF WALKWAY.

STA. H+136.621
OFFSET 4.895 RT

STA. H+137.135
OFFSET 5.382 RT

100mm DOUBLE YELLOW LINE
100mm WHITE LINE

STA. H+133.001
OFFSET 15.878 RT

STA. H+135.000
OFFSET 16.833 RT

NEW LIGHT POLE AND FIXTURE (TYP.)
SEE DETAIL, SHEET 22.
STA. H+138.359, OFFSET 16.982 RT

NEW LOCATION OF "CANAL ST" SIGN
STA. H+140.812, OFFSET 17.988 RT

BITUMINOUS CONCRETE SIDEWALK (NO. 1 TEXTURED) (SEE PRELIMINARY INFORMATION SHEET #2 FOR DETAILS)
STA. H+141.804
OFFSET 1.479 LT

LEGEND

EXISTING	PROPOSED
--- EDGE OF PAVEMENT	⊕ SIGN
--- EDGE OF BROOK	△ LIMITS OF CONSTRUCTION
★ TREE	--- ELECTRICAL CONDUIT
⊙ PARKING METER	--- NEW VERTICAL GRANITE CURB
⊙ UTILITY POLE	⊙ NEW LIGHT POLE
⊙ GUY	
⊙ SIGN	
⊙ CATCH BASIN	
--- AERIAL E&T	

MATCH BACK OF EXISTING SIDEWALK
STA. H+134.344
OFFSET 31.707 RT

**BROOKSIDE PLAZA & ROUTE 5
DETAIL LAYOUT SHEET**

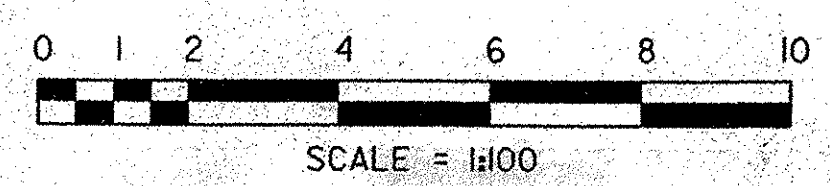

POLE NO. 1/2" IA NET-T TO BE REMOVED BY CVPS
7.62m FLAG POLE (GROUNDSET) IN MONUMENT CONCRETE FOOTING
STA. H+144.513 OFFSET 3.593 LT
END CURB
STA. H+146.686
OFFSET 4.618 LT
EXISTING GRANITE SLAB AND CONCRETE CURB TO BE REMOVED WITHIN PROJECT LIMITS AND TO BE PAID UNDER ITEM 203.16 "SOLID ROCK EXCAVATION".
EXISTING "CANAL ST" SIGN AND POST TO BE RELOCATED. EXISTING PUBLIC PARKING SIGN TO BE REMOVED AND SALVAGED TO THE TOWN.
EXISTING CATCH BASIN TO REMAIN UNDISTURBED (TYP.)

**END PROJECT
STP BIKE (27) S
STA 1+146.725
(MATCH EXISTING)**

SIDEWALK RAMP TYPE 5
SEE VTRANS STD. C-3A.
STA. H+143.651
OFFSET 2.661 RT

EXISTING TELEPHONE UNDERGROUND VAULT ACCESS TO BE LOWERED TO PROPOSED GRADE BY UTILITY OWNER (VERIZON)

EXISTING PARKING METERS TO BE REMOVED BY TOWN

INSTALL NEW PORTLAND CEMENT CONCRETE SIDEWALK, COMMERCIAL DRIVE. SEE VTRANS STD. C-2BM

600mm STOP BAR

STA. H+141.97
OFFSET 15.887 RT

BEGIN NEW SIDEWALK RAMP TYPE 1
STA. H+143.279
OFFSET 18.086 RT

NEW SIDEWALK RAMP TYPE 1
SEE VTRANS STD. C-3A

NEW VERTICAL GRANITE CURB AND PORTLAND CEMENT CONCRETE SIDEWALK. SEE VTRANS STD. C-1M

REMOVE EXISTING SIDEWALK RAMP

END NEW SIDEWALK AND CURB
STA. H+139.591
OFFSET 25.434 RT

MATCH EXISTING GRADE AT SIDEWALK

APPROXIMATE LOCATION OF THE EXISTING SIDEWALK AND CURB

NOTES:

- REMOVAL OF THE EXISTING SIDEWALK ALONG MAIN STREET NECESSARY FOR CONSTRUCTION SHALL BE COMPLETED PRIOR TO THIS PROJECT AND IS NOT PAID FOR THROUGH THIS PROJECT.
- ALL THE LOCATIONS OF SIGNS, LIGHT POLES AND THE FIRE BOX ARE APPROXIMATE AND THE FINAL LOCATION SHALL BE DECIDED BY THE TOWN BEFORE PLACEMENT.
- THE EXISTING PARKING LOT SIGN SHALL BE REMOVED AND SALVAGED TO THE TOWN.
- THE EXISTING CANAL STREET SIGN SHALL BE RELOCATED AS SHOWN ON THIS SHEET.
- FOR DETAILS ON THE REMOVAL OF THE POLE 1/2" IA, SEE SHEET 14 AND THE UTILITY RELOCATION NOTES ON SHEET 19 FOR DETAILS.
- STATIONS ARE GIVEN IN KILOMETERS, OFFSETS ARE GIVEN IN METERS AND DIMENSIONS ARE GIVEN IN MILLIMETERS.

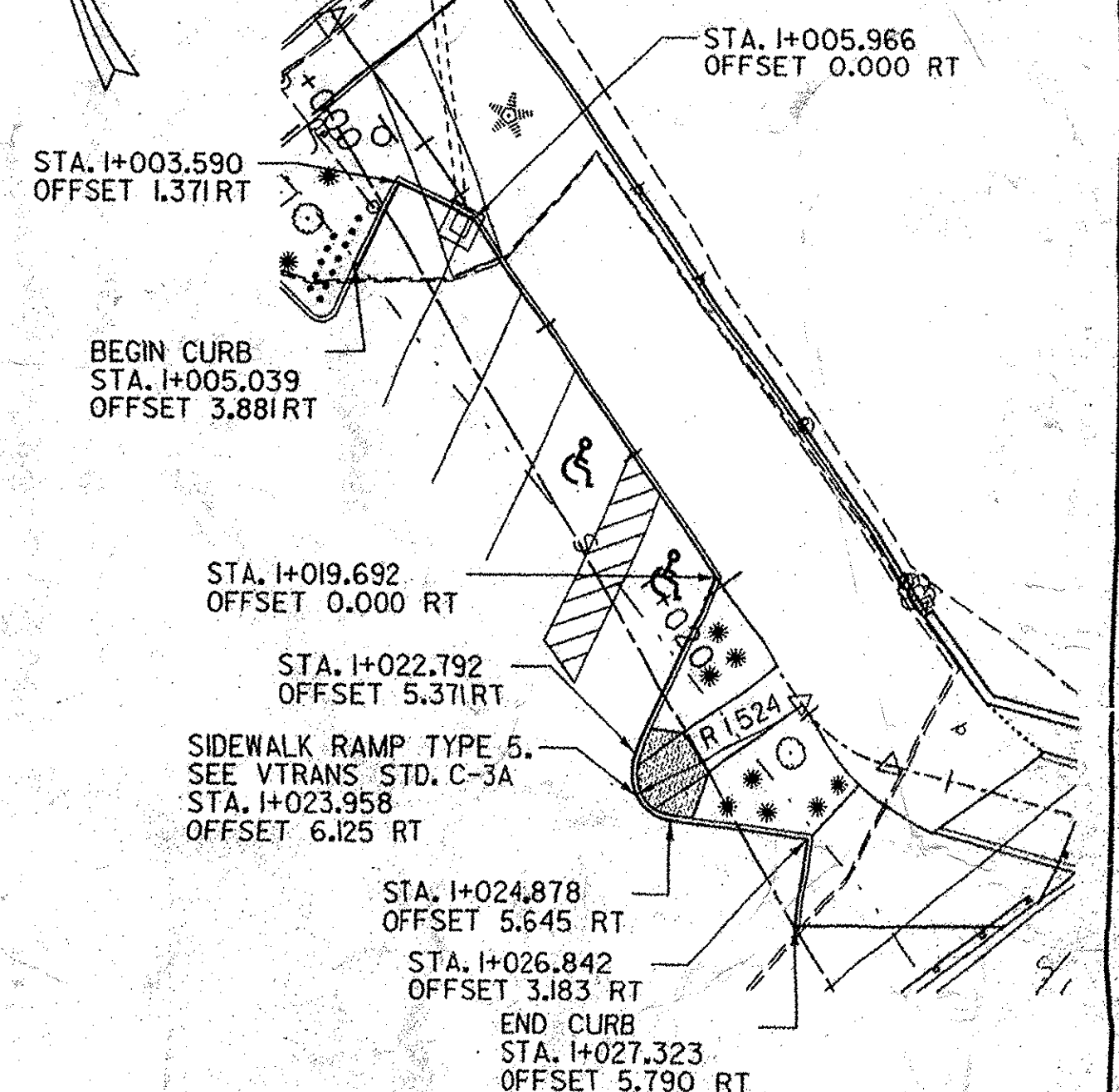

**PRESTON LOT
CURB LAYOUT DETAIL**
SCALE 1:200

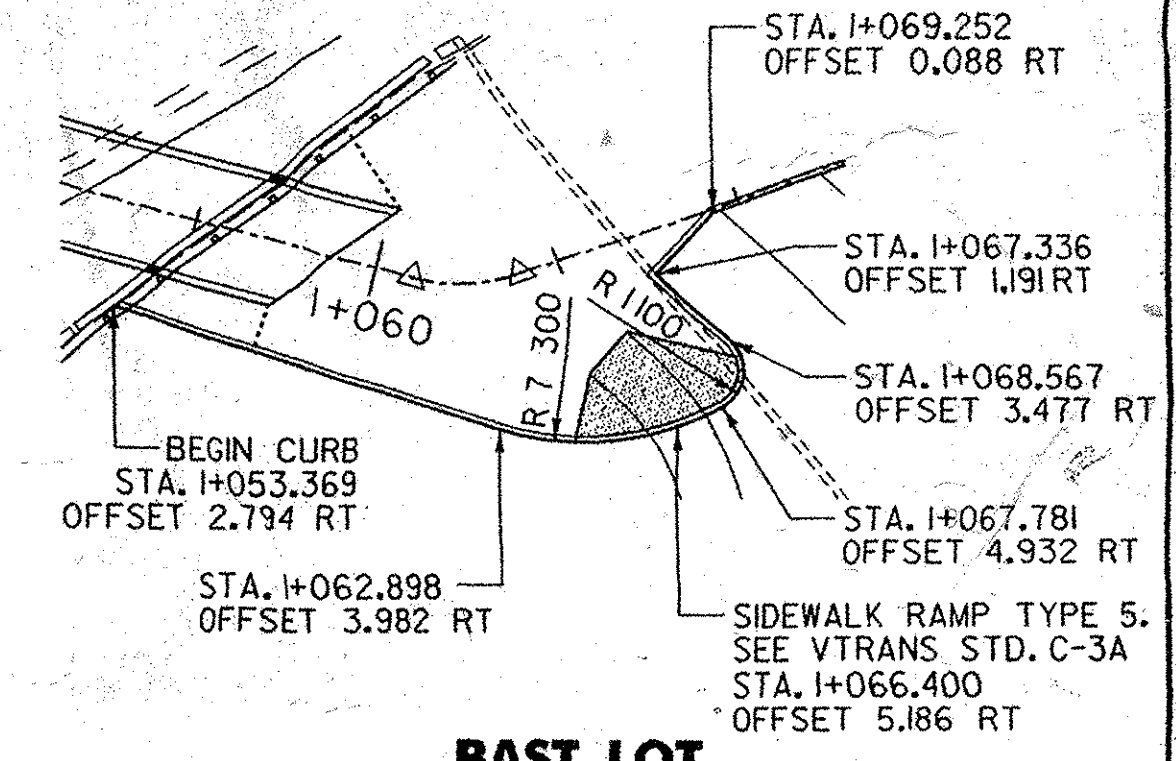

**BAST LOT
CURB LAYOUT DETAIL**
SCALE 1:200

APPROXIMATE LOCATION OF THE EXISTING ENTRANCE TO THE BAST PARKING LOT, TO BE RELOCATED.

<p>engineering planning management development</p>	<p>TOWN OF BRATTLEBORO BRATTLEBORO, VERMONT</p>	<p>DRAWN BY SJB/PJG</p>	<p>DATE 9/03/04</p>
	<p>WHETSTONE BROOK PATHWAY PROJECT STP BIKE (27) S</p>	<p>CHECKED BY</p>	<p>PROJ. NO. R16544</p>
	<p>BROOKSIDE PLAZA & U.S. ROUTE 5 DETAIL LAYOUT SHEET</p>	<p>PROJ. ENG.</p>	<p>DRAW. NO.</p>
	<p>SHEET 15 OF 30</p>	<p>PLOTTED: 09/10/2004</p>	<p>PLANNING</p>