

NEW 760mm DOWEL (TYP.) TO BE DRILLED AND SPACED 300mm ON CENTER AND GROUTED INTO THE EXISTING WALL. PLACEMENT OF DOWELS TO BE INSTALLED ONLY IF FEASIBLE, AS DETERMINED BY THE RESIDENT ENGINEER. DOWELS TO BE PAID FOR UNDER PAY ITEM 507.16, 'DRILLING AND GROUTING DOWELS'.

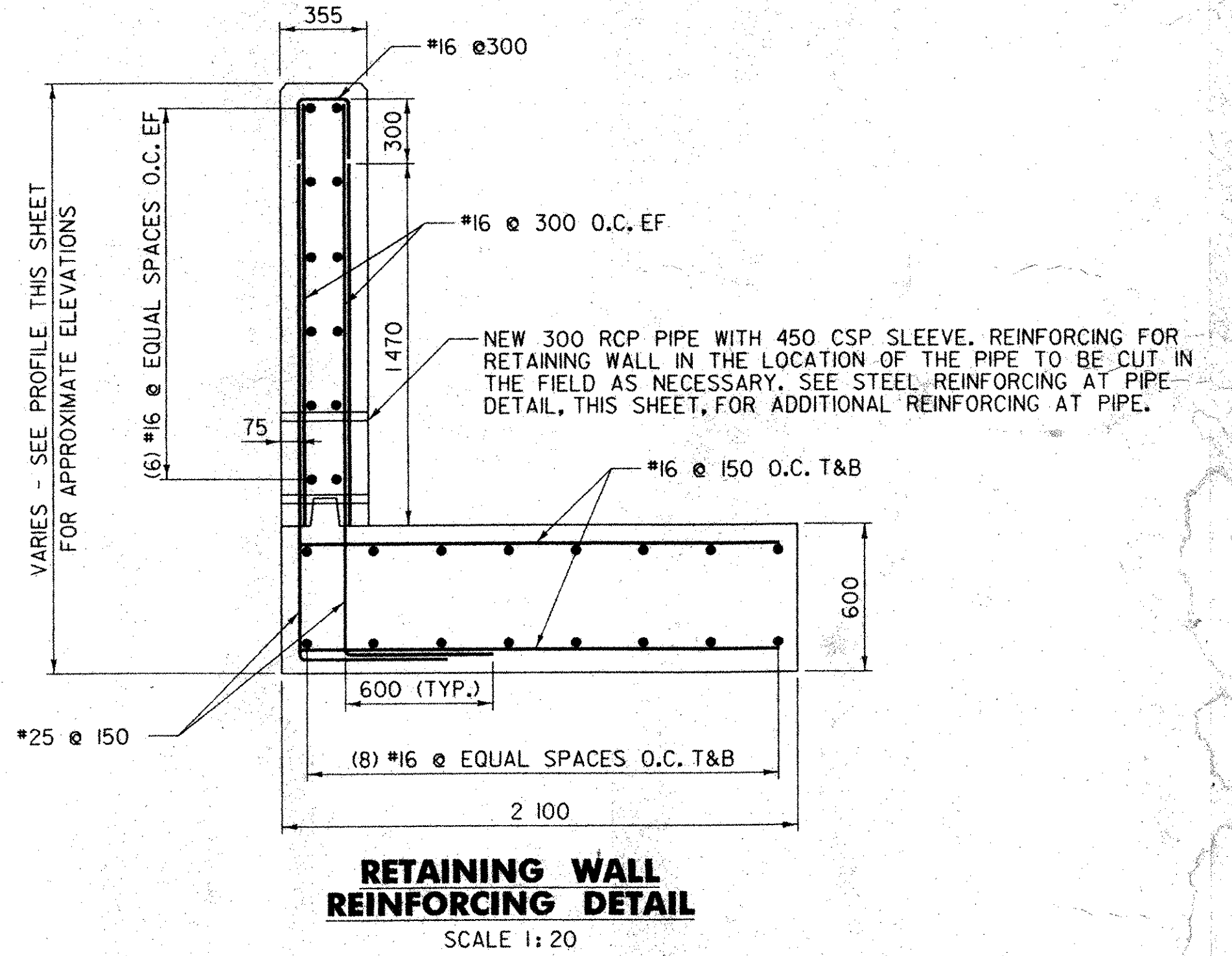

- LEGEND**
- EXISTING**
- EDGE OF PAVEMENT
  - EDGE OF BROOK
  - ⊗ TREE
  - UTILITY POLE
  - △ TIE POINT
- PROPOSED**
- ▬ CURB
  - ▬ CULVERT
  - CATCH BASIN

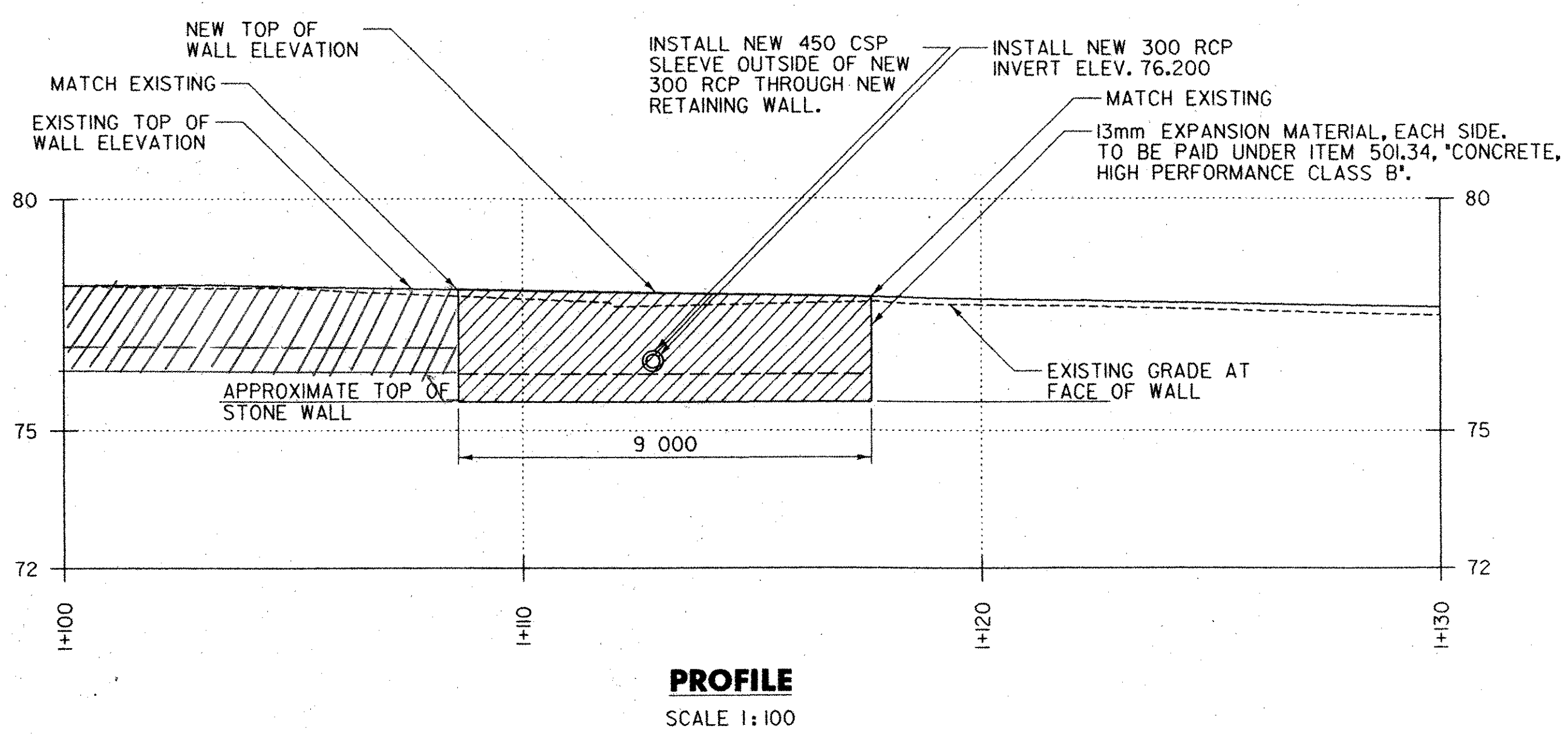
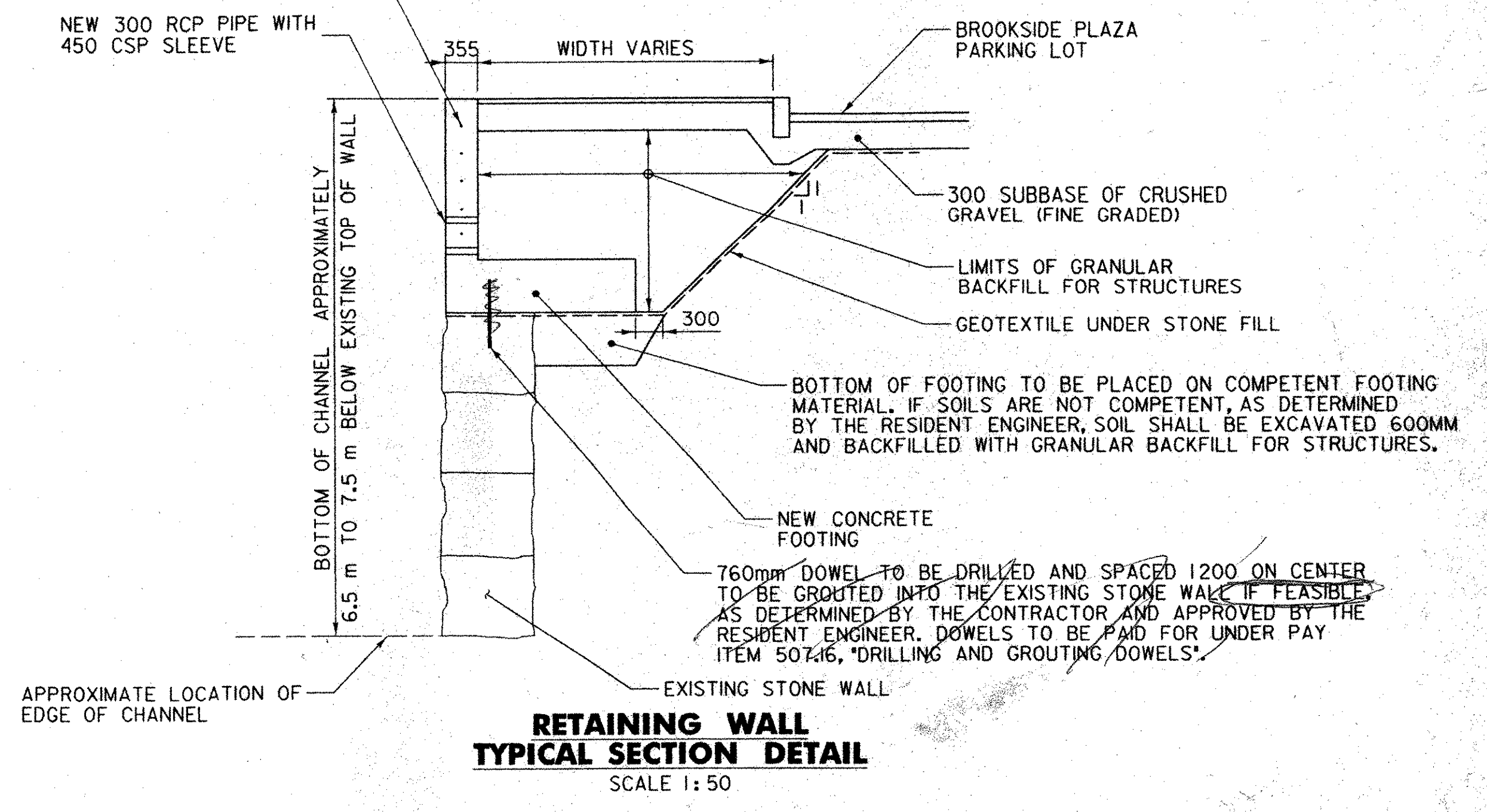
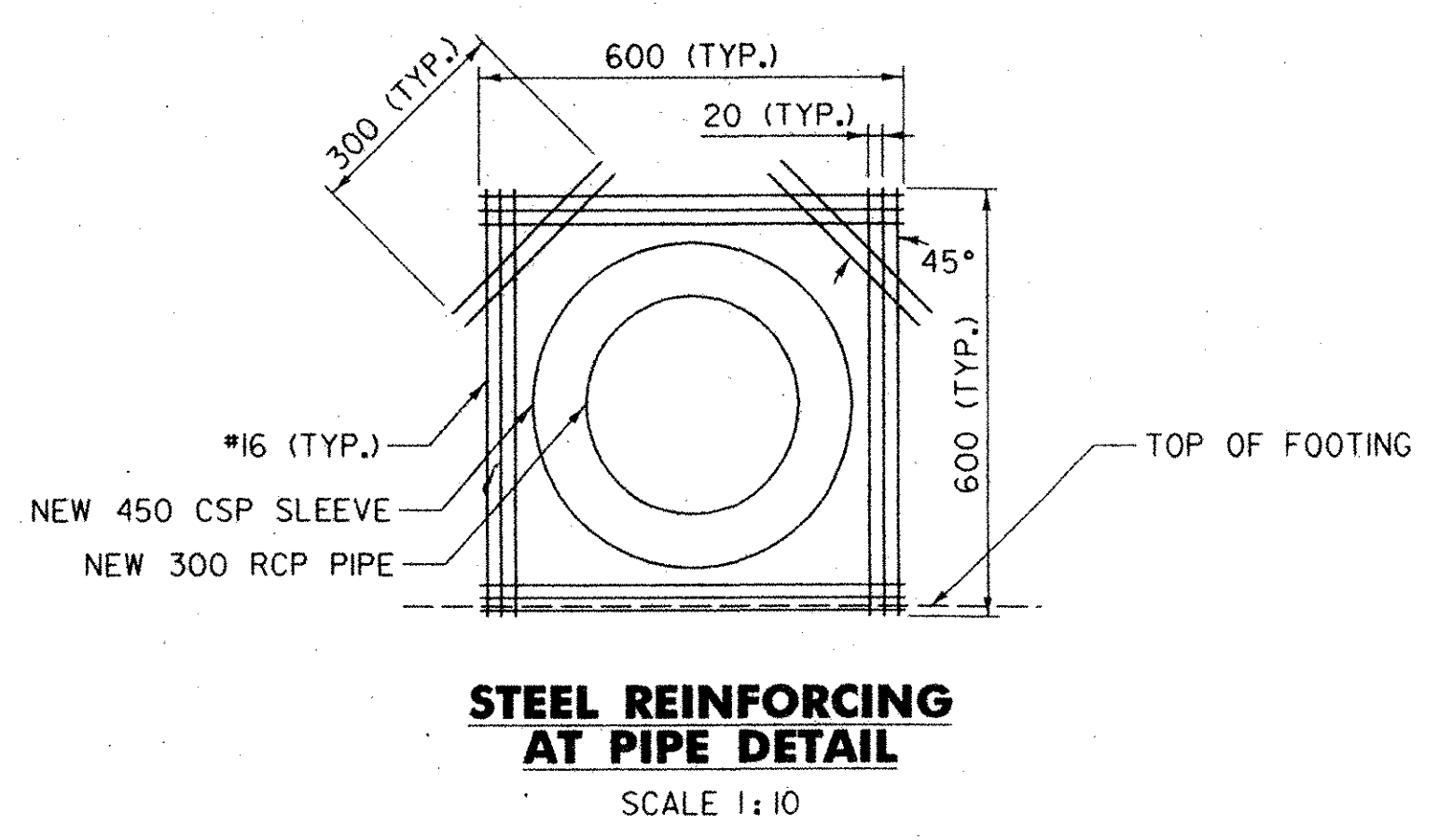

**NOTES**

1. THE EXISTING CONCRETE RETAINING WALL SECTION TO BE REMOVED SHALL BE PAID FOR BY PAY ITEM 203.16, 'SOLID ROCK EXCAVATION.'
2. CONCRETE FOOTING IS TO BE PLACED ON THE TOP OF EXISTING STONE WALL, WHICH IS TO REMAIN UNDISTURBED, EXCEPT FOR THE DRILLING AND GROUTING OF DOWELS.
3. TOP OF NEW CONCRETE WALL ELEVATION SHALL MATCH THE EXISTING TOP OF WALL.
4. STATIONS ARE GIVEN IN KILOMETERS, ELEVATIONS ARE GIVEN IN METERS AND DIMENSIONS ARE GIVEN IN MILLIMETERS.

DATUM

VERTICAL	NVD 88
HORIZONTAL	NAD 83

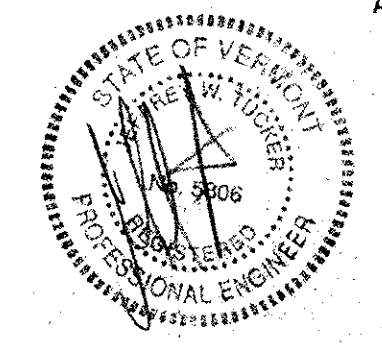

**DuBois & King Inc.**  
engineering planning management development

TOWN OF BRATTLEBORO  
BRATTLEBORO, VERMONT  
WHETSTONE BROOK PATHWAY PROJECT  
STP BIKE (27) S  
RETAINING WALL SHEET

DRAWN BY	SJD	DATE	FEB. 2004
CHECKED BY	JDA	PROJ. NO.	R16544
PROJ. ENG.	JDA	DRAW. NO.	1440
SHEET	12	OF	30

PLOTTED: 03/11/2004