

NOT IN CONTRACT

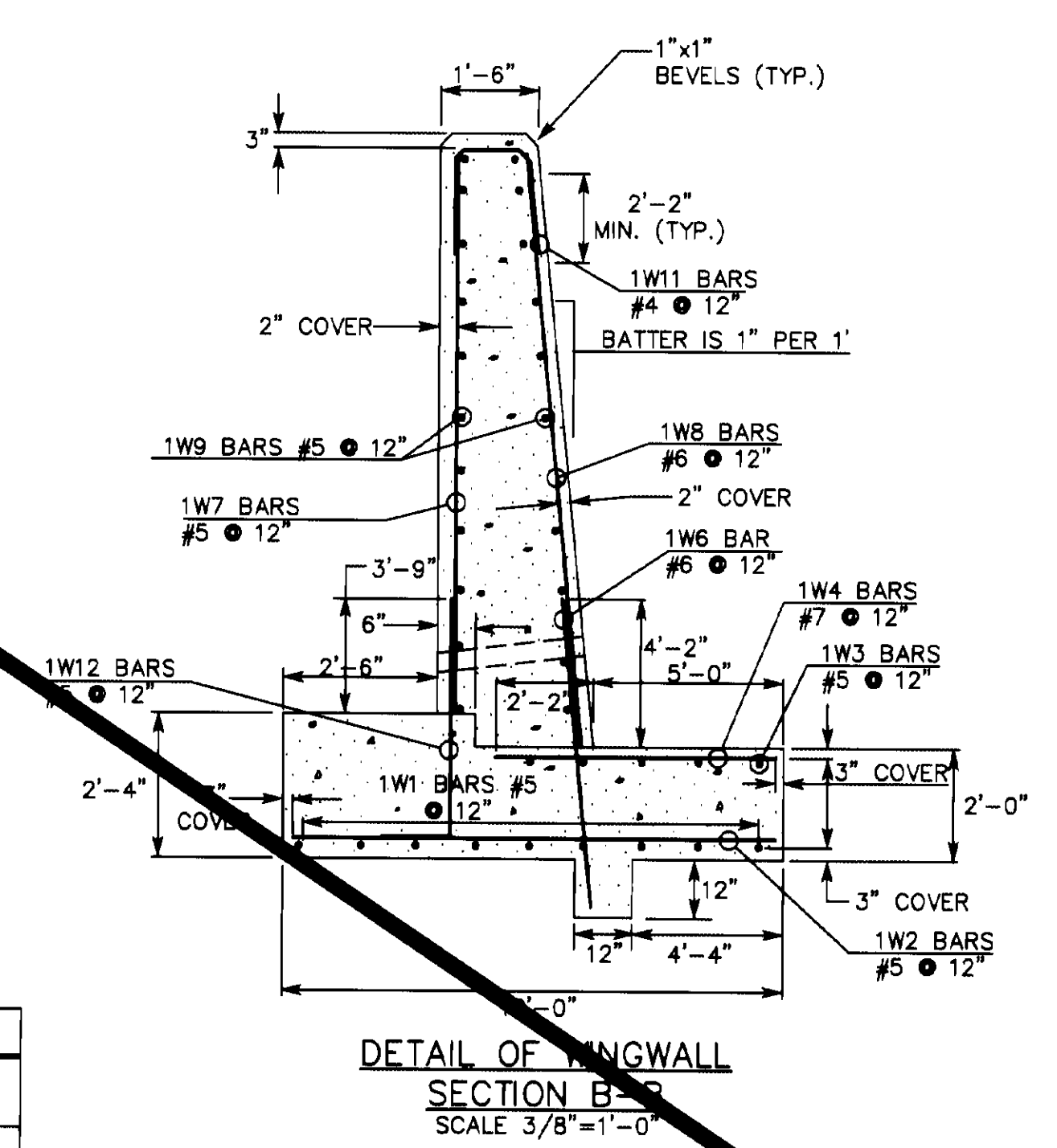
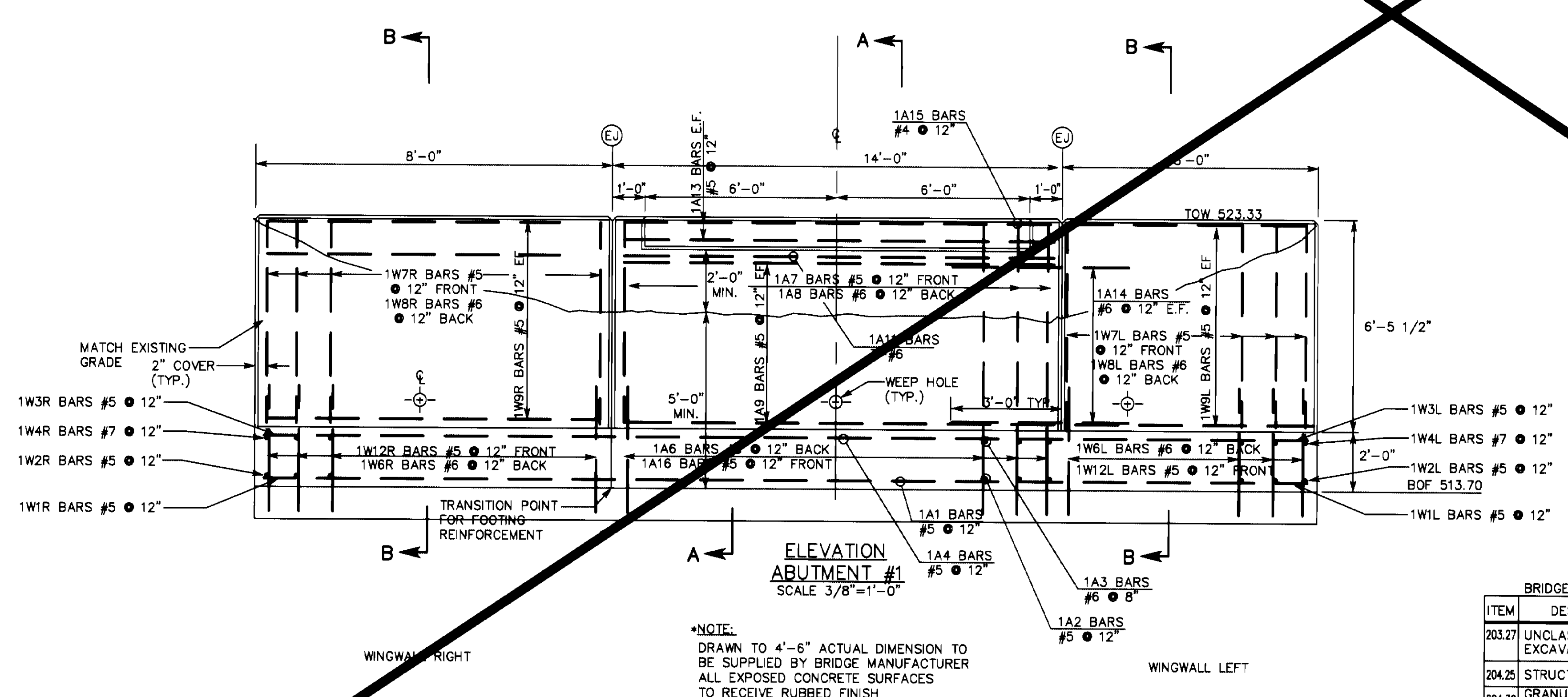
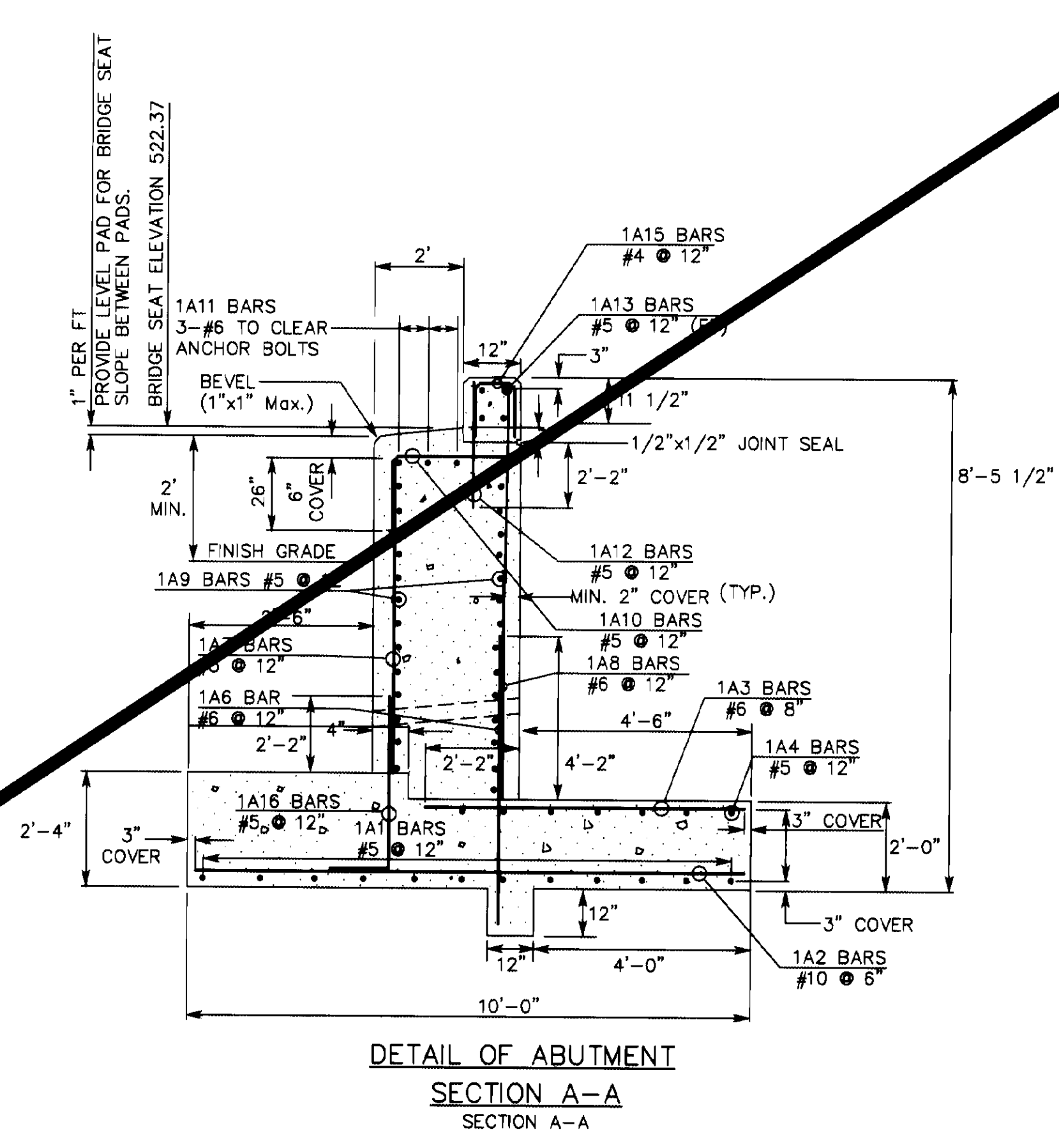

BRIDGE NO. 1 SUBSTRUCTURE ESTIMATED QUANTITIES

ITEM	DESCRIPTION	NET	ROUND	TOTAL	FINAL
203.27	UNCLASSIFIED CHANNEL EXCAVATION	55 C.Y.	67 C.Y.	8 C.Y.	130 C.Y.
204.25	STRUCTURE EXCAVATION	71 C.Y.	93 C.Y.	6 C.Y.	170 C.Y.
204.30	GRANULAR BACKFILL FOR STRUCTURES	42 C.Y.	36 C.Y.	14 C.Y.	160 C.Y.
501.25	CONCRETE, CLASS B	39 C.Y.	48 C.Y.	4 C.Y.	45 C.Y.
507.15	REINFORCING STEEL	3288 LB	3500 LB	62 LB	7000 LB
514.10	WATER REPELLENT	6 GAL.	6 GAL.		12 GAL.
524.20	JOINT SEALER, POLYURETHANE	0.2 GAL.	0.2 GAL.		0.4 GAL.
613.13	STONE FILL-TYPE IV	84 C.Y.	108 C.Y.	10 C.Y.	200 C.Y.

*NOTE:
DRAWN TO 4'-6" ACTUAL DIMENSION TO BE SUPPLIED BY BRIDGE MANUFACTURER
ALL EXPOSED CONCRETE SURFACES TO RECEIVE RUBBED FINISH

BRIDGE NO. 1
ABUTMENT NO. 1

FAX (802)-558-3829 P.E.A. BUS. (802)-558-5588

PINKHAM ENGINEERING ASSOCIATES, INC.
The Matrix Building, 431 Pine St., Burlington, VT 05401

SURVEYED BY PEA DATE
DRAWN BY JMM DATE
SQUAD LEADER DATE
DESIGN FILE NO. 6829DET3 DATE 9/25/96
PROJ. NAME WINOOSKI RIVER WEST BIKEWAY
PROJ. NO. 6829
SHEET 49 OF 132 SHEETS