

POWER GRADER RENTAL  
RR MM 37.207 - RR MM 36.639  
(GRADING OF EXISTING BALLAST)

~~GEOTEXTILE FOR ROADBED SUBGRADE SEPARATOR~~  
~~RR MM 37.207 - RR MM 36.639~~  
~~(PLACE UNDER AGGREGATE SURFACE COURSE 10' WIDTH)~~

AGGREGATE SURFACE COURSE  
RR MM 37.207 - RR MM 36.639

# LAKE MEMPHRAMAGOG

BRIDGE TRESTLE  
RR MM 36.747

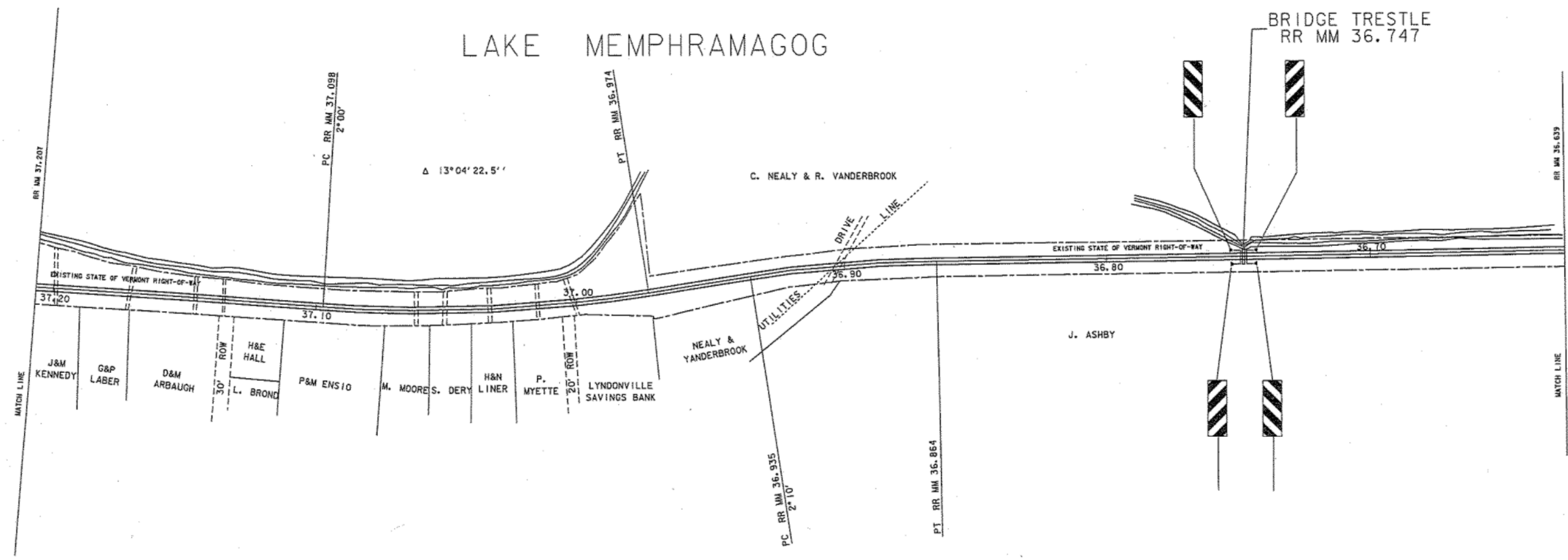

- NOTES:**
1. ALL WORK IS WITHIN EXISTING STATE OF VERMONT RIGHT-OF-WAY AND SHALL BE DONE WITHIN THE EXISTING RAILROAD BED UNLESS OTHERWISE NOTED ON PLANS OR AS DIRECTED BY THE ENGINEER
  2. WIDTH OF EXISTING RIGHT-OF-WAY IS 33' EACH SIDE OF CENTERLINE
  3. PROPERTY LINES ARE APPROXIMATE AND PROPERTY OWNERS MAY NOT BE ACCURATE

DATUM	N/A
VERTICAL	N/A
HORIZONTAL	N/A

PROJECT NAME/NUMBER: STATEWIDE STP NWRT(1)

SHEET 17 OF 20  
BEEBE SPUR RAIL TRAIL

FOR REFERENCE ONLY

PROJECT: BEEBE SPUR	PROJECT NO.: STP BIKE(19)S
DESIGN FILE NAME: ISRV04/LTF/BEEBE/BEEBE.DGN	PLOT DATE: 29-NOV-2004 15
IPARM FILE NAME: LAY04.I	SURVEY DATE:
SURVEYED BY:	DRAWN BY: MAGNAN
SQUAD LEADER: LEWIS	SHEET: 9 OF 20

PLAN NOT TO SCALE