

SEE PAGE 56A ATTACHED
PLAN
 PIER 1
 SCALE: 3/8" = 1'-0"

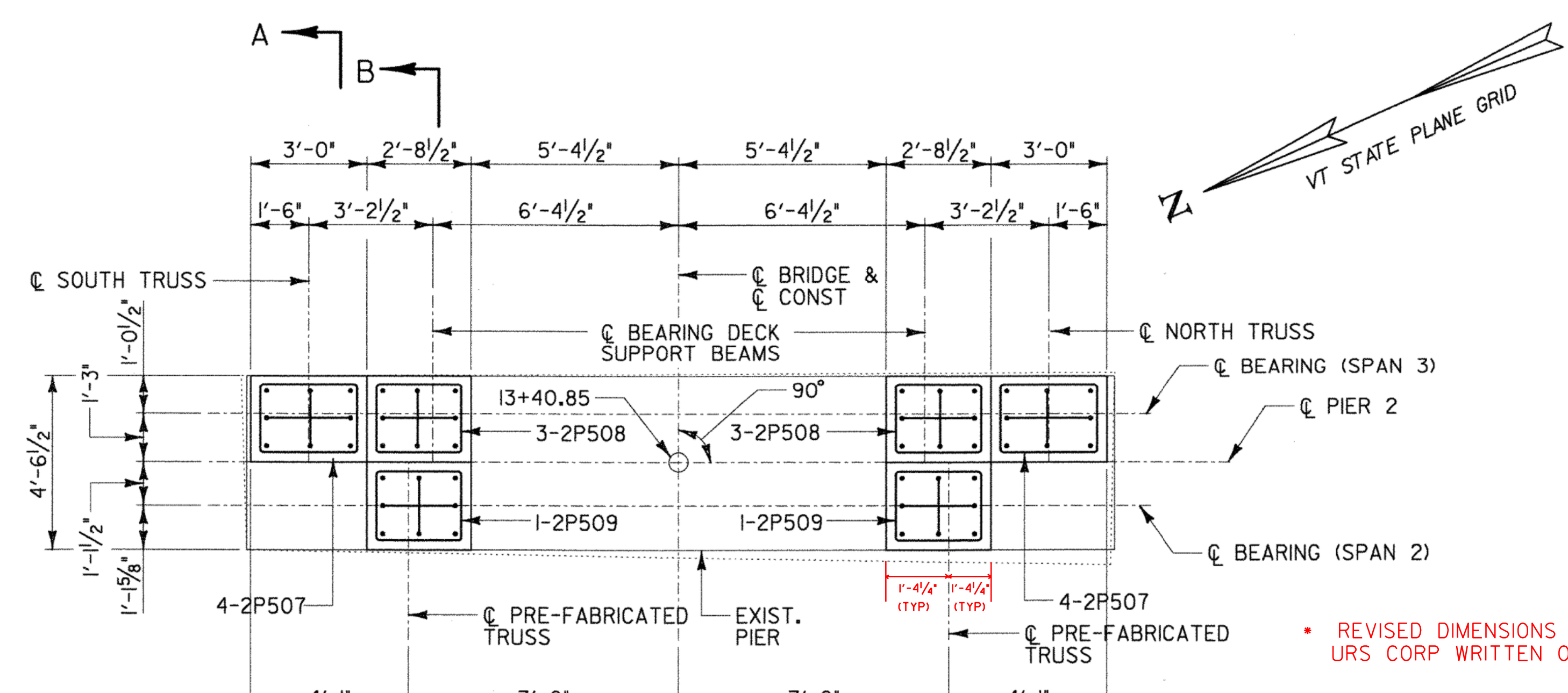

SEE PAGE 56A ATTACHED
PLAN
 PIER 2 (PIER 1 SIMILAR DIMENSIONS)
 SCALE: 3/8" = 1'-0"

REVISED DIMENSIONS AS PER URS CORP WRITTEN ORDER #8

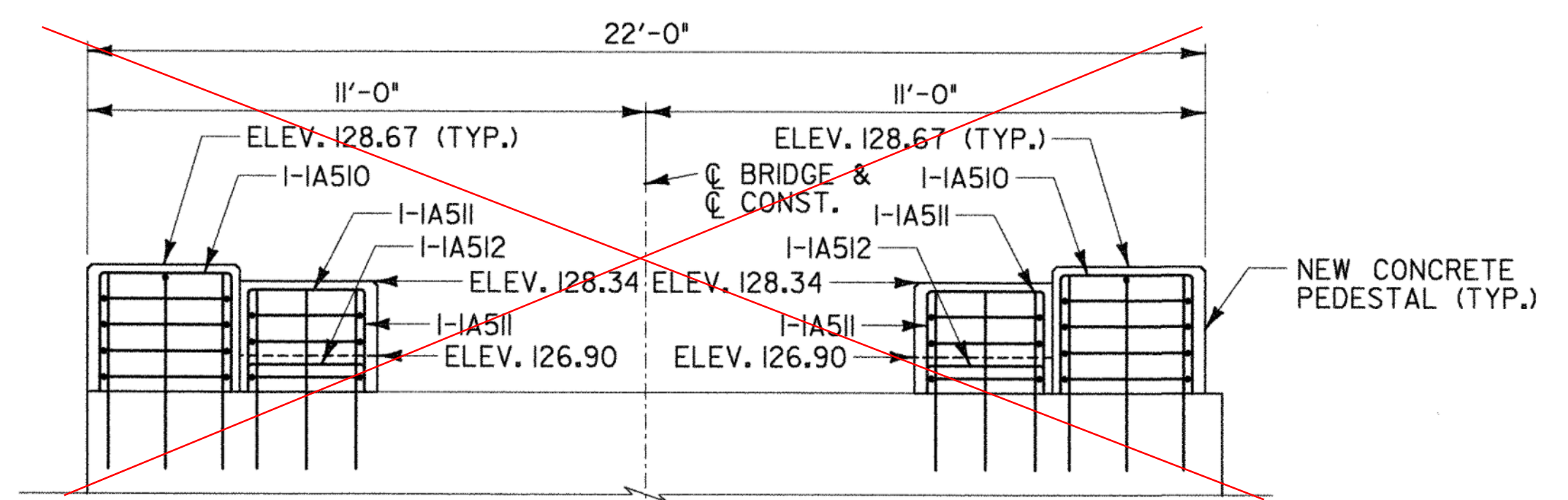

SEE PAGE 56B ATTACHED
ELEVATION
 PIER 1
 SCALE: 3/8" = 1'-0"

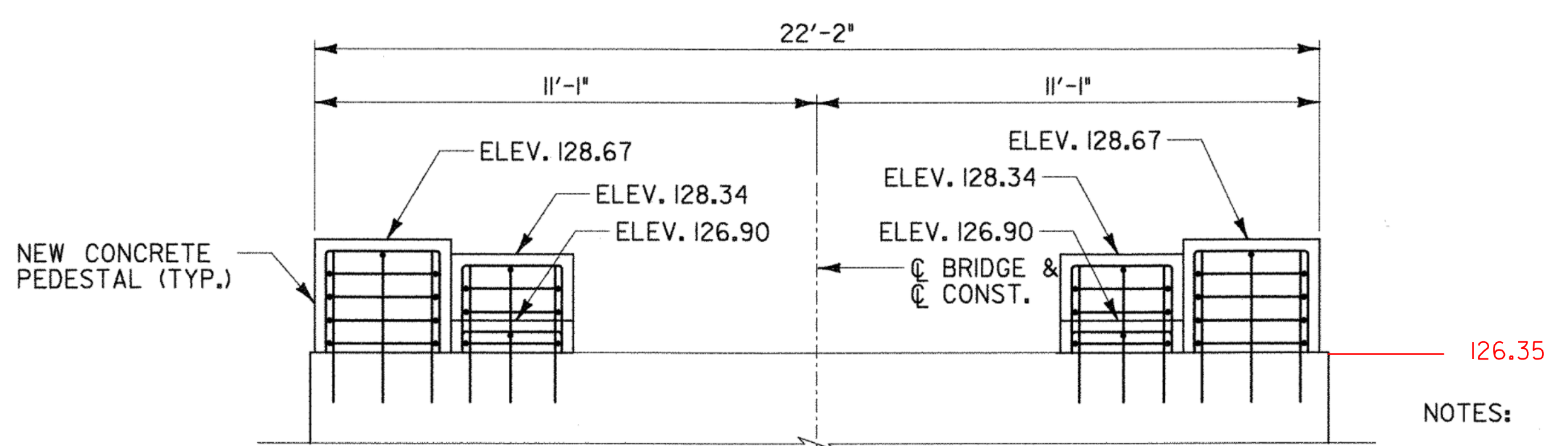

ELEVATION
 PIER 2
 SCALE: 3/8" = 1'-0"

- NOTES:
1. THE CONTRACTOR SHALL VERIFY THE ELEVATION OF THE CONCRETE PAD WITH THE PRE-FABRICATED TRUSS MANUFACTURER PRIOR TO CONSTRUCTION OF THE PAD.
 2. LOCATION OF L BEARING AND ANCHOR BOLTS FOR THE HISTORIC TRUSSES ARE SUBJECT TO FINAL ASSEMBLY OF THE TRUSSES AND THE ACTUAL ASSEMBLED LENGTH.
 3. ALL DOWELS SHALL BE INSTALLED WITH AN APPROVED ADHESIVE. EMBEDMENT DEPTH FOR DRILLED AND GROUTED DOWELS SHALL BE PER MANUFACTURER'S RECOMMENDATIONS. THE ULTIMATE TENSILE STRENGTH OF THE GROUTED DOWELS SHALL NOT BE LESS THAN THE YIELD STRENGTH.

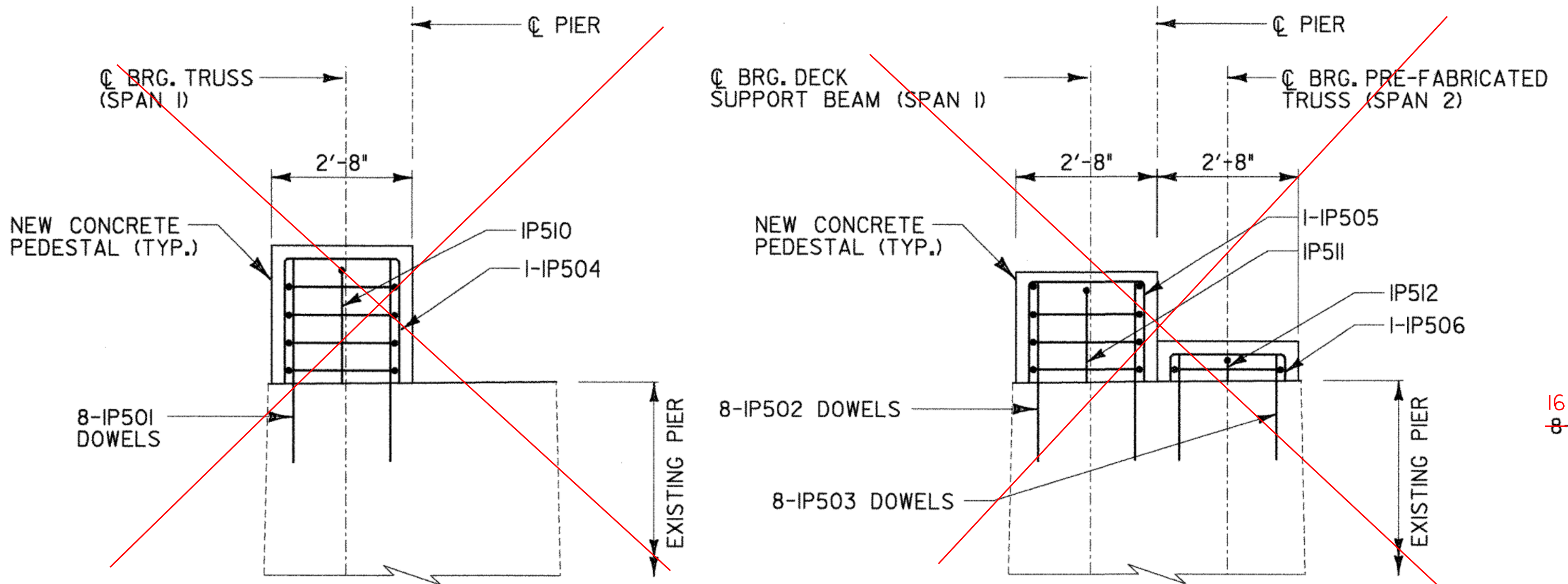

SECTION A-A
 PIER 1
 SCALE: 1/2" = 1'-0"
 SEE PAGE 56C ATTACHED

SECTION B-B
 PIER 1
 SCALE: 1/2" = 1'-0"
 SEE PAGE 56C ATTACHED

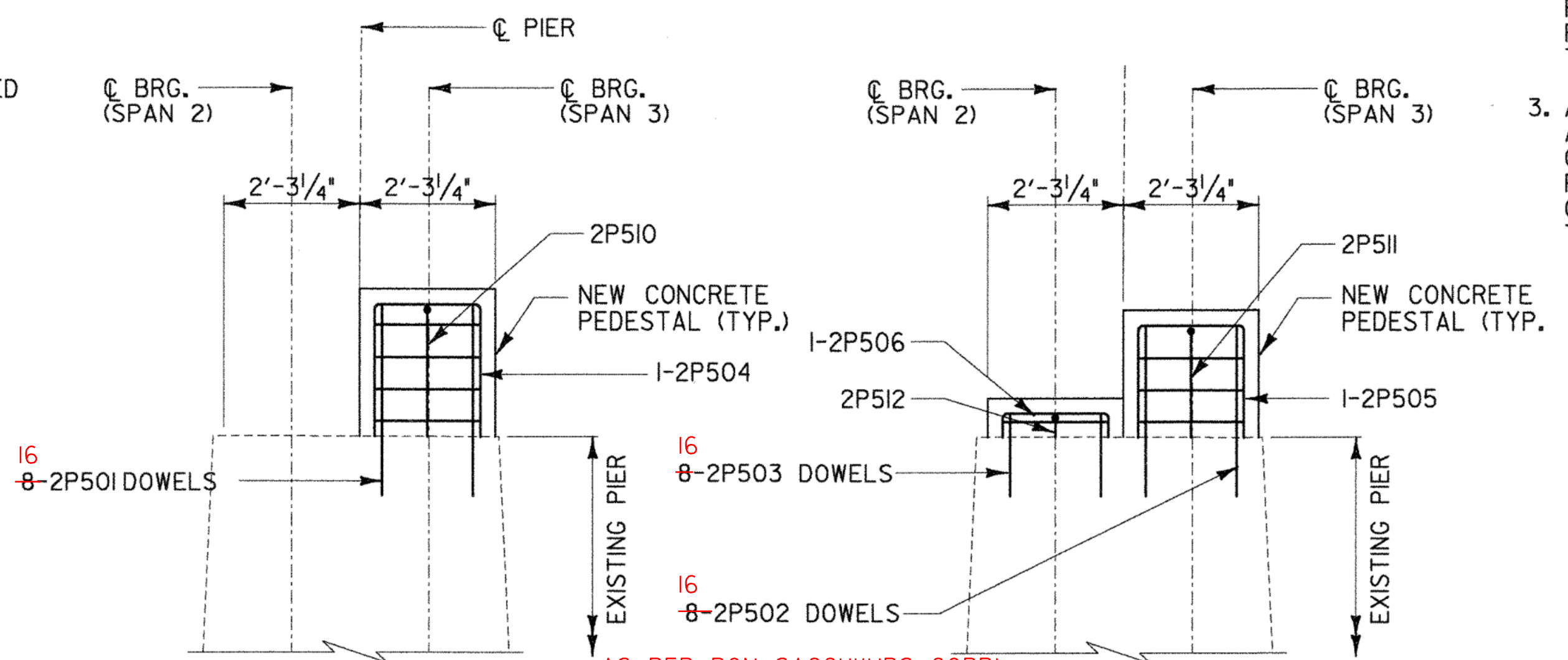

SECTION A-A
 PIER 2
 SCALE: 1/2" = 1'-0"

SECTION B-B
 PIER 2
 SCALE: 1/2" = 1'-0"

AS PER RON SACCHI(URS CORP) VIA PHONE CALL

STATE OF VERMONT
AGENCY OF TRANSPORTATION

Town Of	SWANTON	Bridge No.	18
Highway No.		Log Sta.	
RAIL TRAIL OVER MISSISQUOI RIVER			
PIERS 1 & 2 MODIFICATIONS			
Designed By	R. SACCHI	Drawn By	R. ROSS
Checked By	H. BUI	Date	1/23/08
		Bridge Design Supervisor	R. SACCHI
		Date	1/30/08
PROJECT	SWANTON	PROJECT NO.	STP ST MHTB(1)
I.G.C. Info.	ZD024PIER1.dgn		1/30/2008
Bridge Sheet No.	BR3	Sheet	56 of 63