

MATCHLINE STA. 5+75

MATCHLINE STA. 12+25

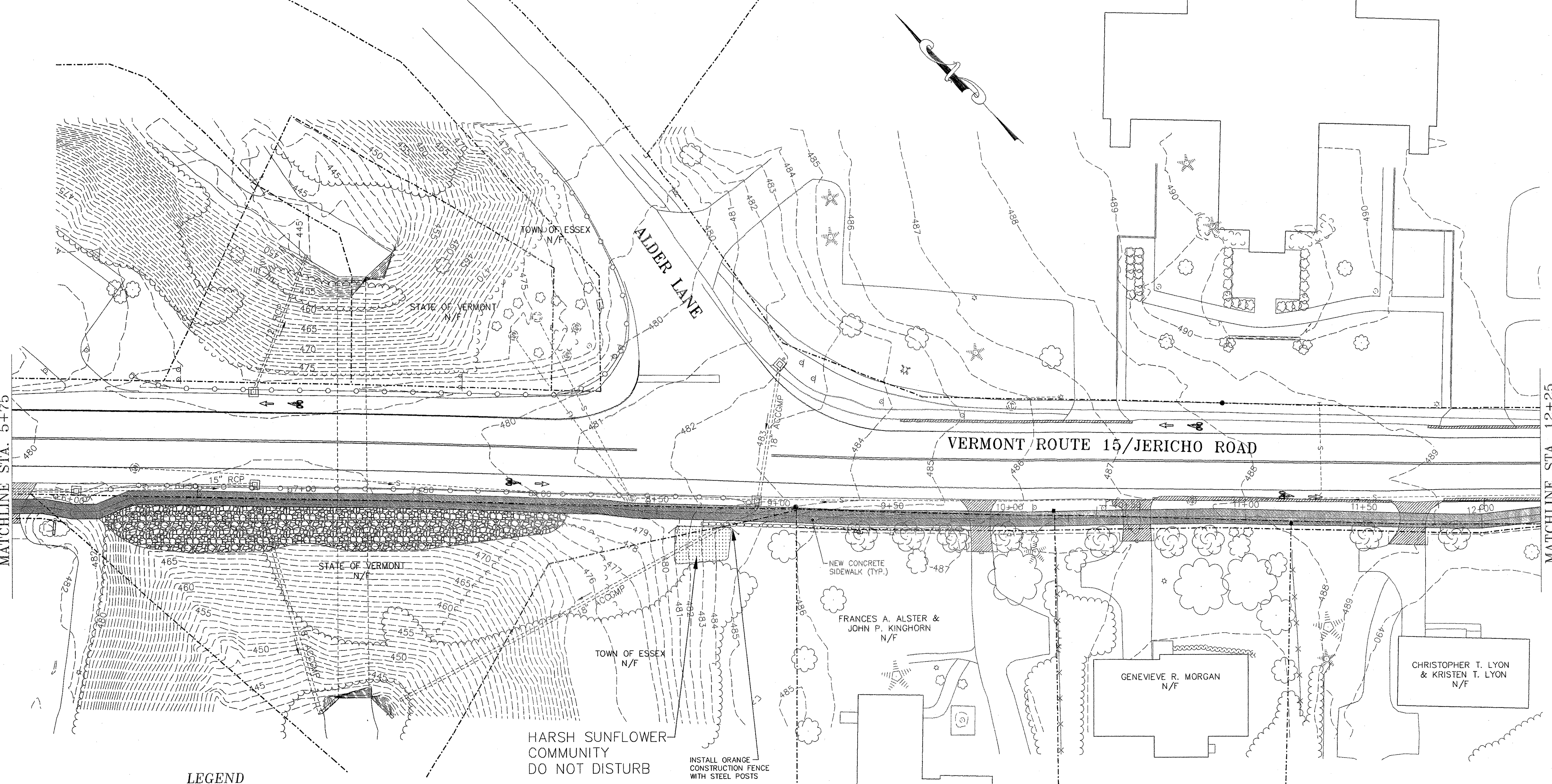

LEGEND

- CONCRETE MONUMENT FOUND
- IRON PIN FOUND
- ☆ EXISTING LIGHT POLE
- ⊕ EXISTING HYDRANT
- ⊙ EXISTING TELEPHONE MANHOLE
- ⊙-S EXISTING SEWER MH W/SEWER PIPE
- ⊙-S EXISTING MAILBOX
- ⊙-S EXISTING CB W/STORMWATER PIPE
- ⊙-S EXISTING SIGNS
- ⊙-S EXISTING WOOD RAIL FENCE
- ⊙-S EXISTING UTILITY POLE & GUY WIRE
- ⊙-S EXISTING TREES
- ⊙-S EXISTING TREE LINE
- ⊙-S EXISTING CONTOUR
- ⊙-S EXISTING WHITE LINE
- ⊙-S EXISTING ROAD CENTERLINE
- ⊙-S EXISTING FACE OF BUILDING
- ⊙ PROPOSED MAILBOX
- ⊙ PROPOSED DRAINAGE MANHOLE
- ⊙-S PROPOSED CB W/STORMWATER PIPE
- ⊙-S PROPOSED TREES
- ⊙-S PROPOSED TREE LINE
- ⊙-S PROPOSED WHITE LINE
- ⊙-S PROPOSED ROAD CENTERLINE
- ⊙-S PROPOSED PAVEMENT AND BASE
- ⊙-S PROPOSED SIDEWALK
- ⊙-S PROPERTY LINE
- ⊙-S SLOPE LIMIT (FILL)
- ⊙-S SLOPE LIMIT (CUT)
- ⊙-S FINISH GRADE ELEVATION
- ⊙-S LIMIT OF CONSTRUCTION
- N NEW SIGN OR POST
- S SALVAGED SIGN OR POST
- ⊙-S BIKEWAY SYMBOL PAVEMENT MARKINGS - DURABLE WHITE AND GRITTED SUITABLE FOR BIKES

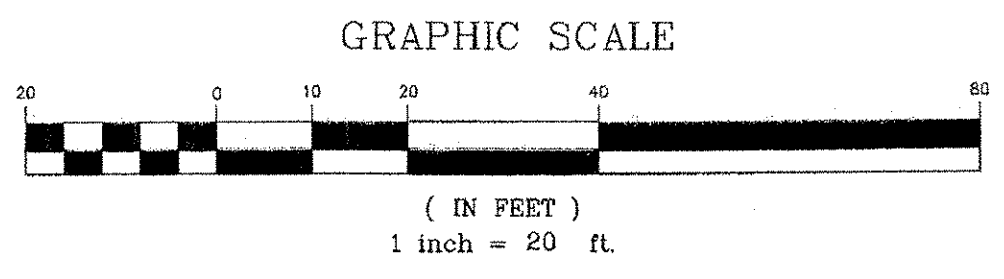

EROSION & SEDIMENT CONTROL PLANS

REVISIONS		# OF SHEETS
THESE PLANS WITH LATEST REVISIONS SHOULD ONLY BE USED FOR THE PURPOSE SHOWN BELOW:		
STP WALK (9) TOWN OF ESSEX ROUTE 15 IN ESSEX CENTER, VT		proj. no. 02-132
FINAL CONDITIONS		survey &O/OTHERS
STATION 5+75 TO 12+25		design DLH/LAL
		drawn DB
		checked LAL/DLH
		date 03/01/04
		scale 1" = 20'
		sht. no. 25K

DATUM

VERTICAL NAVD 1988

HORIZONTAL NAD 1983

L LAMOUREUX & DICKINSON
Consulting Engineers, Inc.
14 Morse Drive
Essex Junction, VT 05452
Tel: 802-878-4450