

ESSEX STP WALK (9)

ESSEX CENTER SIDEWALK ESSEX, VERMONT

LENGTH OF PROJECT IS 1,668 FEET = 0.32 MILES

THE PROJECT BEGINS IN ESSEX NEAR THE INTERSECTION OF VERMONT ROUTES 15 AND TOWN COMMONS ROAD, AND PROCEEDS SOUTHEASTERLY FOR A DISTANCE OF 1,668 FEET ALONG VERMONT ROUTE 15 AND SAND HILL ROAD.

WORK TO BE PERFORMED UNDER THIS PROJECT INCLUDES NEW CONCRETE SIDEWALK, CATCH BASINS, FENCING, ROADWAY WIDENING, NEW BASE, ASSOCIATED PAVEMENT MARKINGS, SIGNS, AND INCIDENTAL ITEMS.

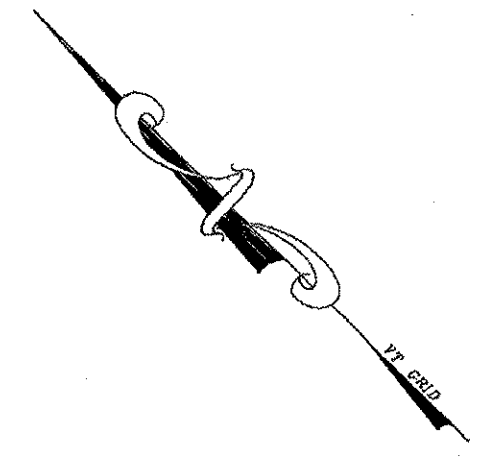
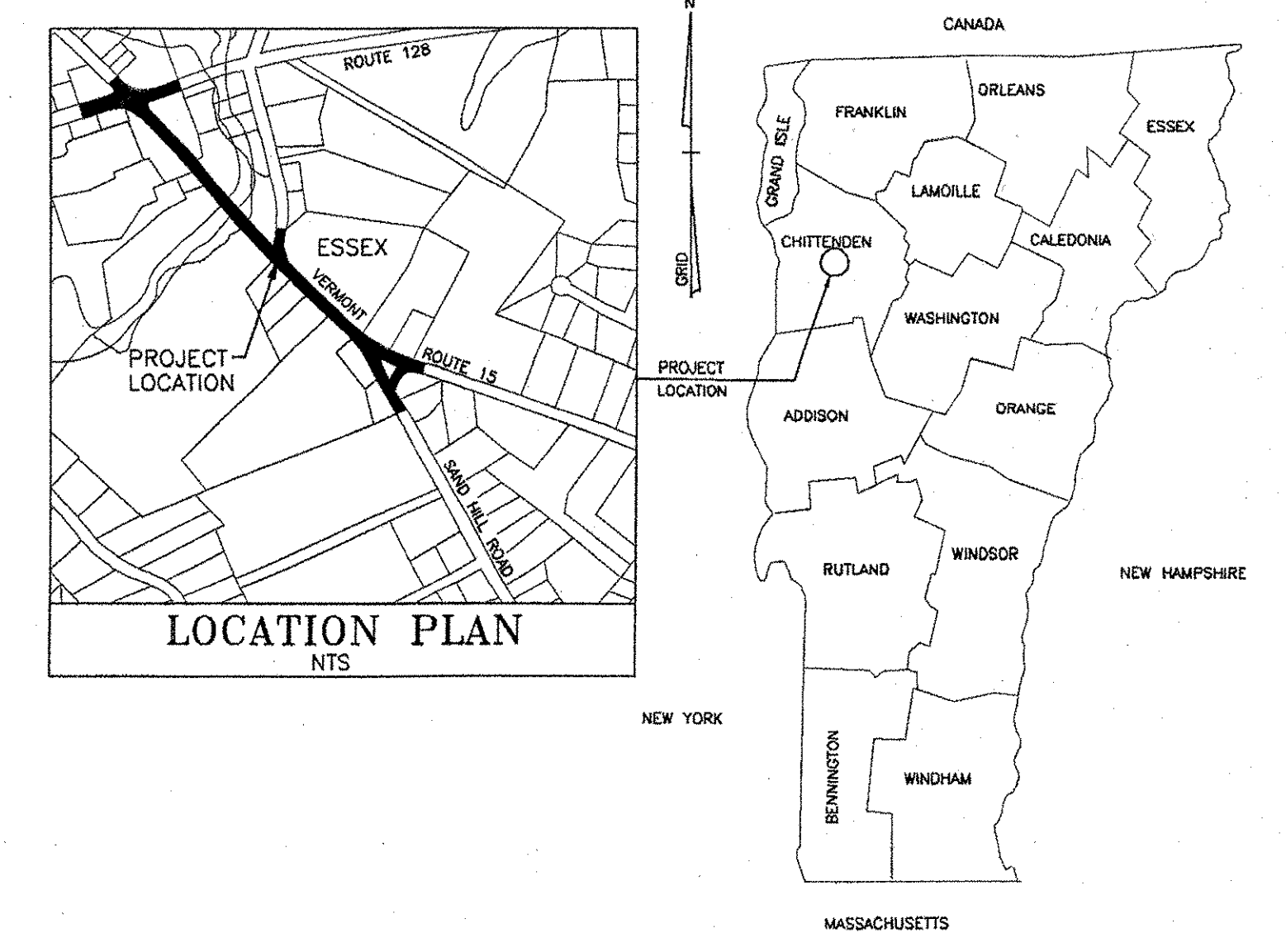

BEGIN PROJECT
STA. 0+92

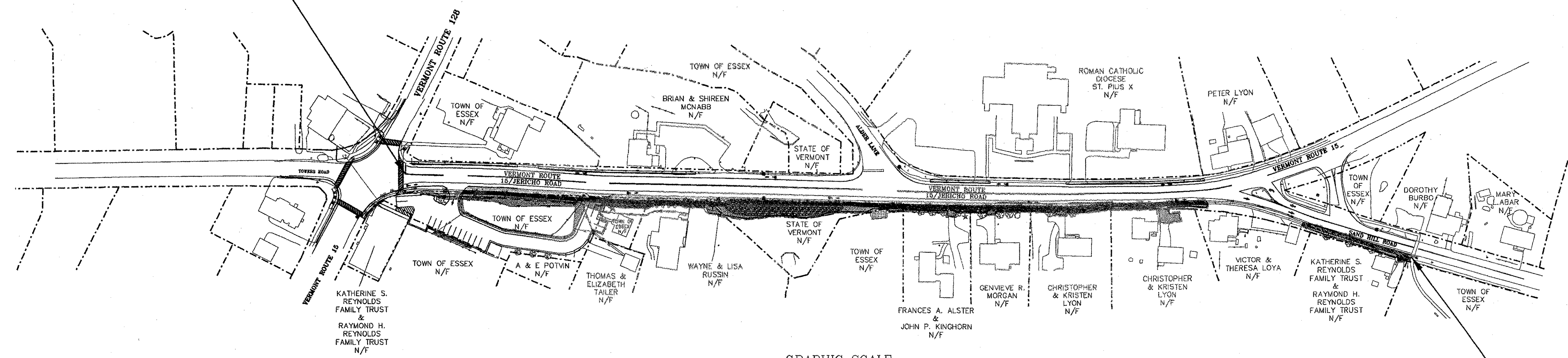

THE CONTRACTOR SHALL NOTIFY "DIGSAFE" AT 1-888-DIG-SAFE PRIOR TO ANY EXCAVATION.

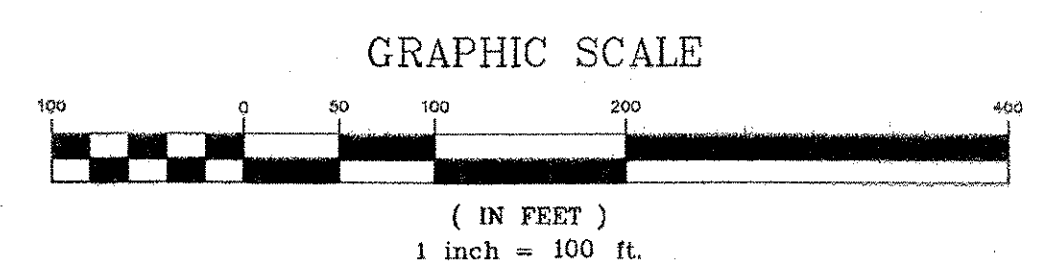

END PROJECT
STA. 17+60.43

INDEX OF SHEETS

SHEET #	TITLE	DATE	SHEET #	TITLE	DATE
1	TITLE SHEET		D-11	CATCH BASIN COVER	6-1-94R
2-4	DETAILS & SPECIFICATIONS		D-15	PRECAST REINFORCED CONCRETE CATCH BASIN W/CAST IRON GRATE	6-1-94R
5-6	QUANTITY SHEETS		E-100	CONSTRUCTION APPROACH SIGNS	1-2-04R
7	PLAN SHEET STA. 0+00 TO STA. 5+75		E-100A	SIDE ROAD CONSTRUCTION APPROACH SIGNS	1-2-04R
8	PLAN SHEET STA. 5+75 TO STA. 12+25		E-102	CONSTRUCTION SIGN DETAILS	6-30-03R
9	PLAN SHEET STA. 12+25 TO STA. 17+60.43		E-108	CONSTRUCTION ZONE LONGITUDINAL DROP OFFS	8-18-95R
10-17	CROSS SECTIONS		E-111	MINOR MAINTENANCE OPERATION	3-11-97R
18	PROJECT PROFILE		E-121	STANDARD SIGN PLACEMENT CONVENTIONAL ROAD	8-8-95R
19	CONSTRUCTION APPROACH SIGNING		E-123	GUIDE SIGN PLACEMENT MISC. DETAILS	3-16-04R
20-22	LANDSCAPING AND SIGNAGE SHEETS		E-131B	BICYCLE GUIDE SIGN DETAILS	5-30-03
23	SIGN SUMMARY SHEET		E-160	FLANGED CHANNEL STEEL SIGN POST	5-20-99R
24	SIGN DETAIL SHEET		E-162	TUBULAR ALUMINUM SIGN POST	5-20-99R
25A-25H	EPSC PLANS		E-191	PAVEMENT MARKING DETAILS	2-1-99R
25J-25L	EPSC PLANS		E-192	PAVEMENT MARKING DETAILS	10-12-00R
26-30	RIGHT OF WAY PLANS		E-193	PAVEMENT MARKING DETAILS	8-18-95
			E-194	BICYCLE PAVEMENT MARKINGS	3-15-05R
B-5	EMBANKMENT AND SLOPE STANDARDS	6-1-94R	F-2	CHAIN LINK FENCE	6-1-94R
C-1	CURBS	1-3-00R	G-1	GUARD RAIL	1-3-00R
C-2A	CONCRETE SIDEWALK	1-3-00R	G-1D	GUARD RAIL	1-3-00R
C-2B	CONCRETE SIDEWALK	1-3-00R	G-17A	MELT	9-27-02R
C-3A	SIDEWALK RAMPS	9-1-04R	G-17B	MELT	9-27-02R
D-1	CATCH BASIN	6-1-94R	J-3	MAILBOX SUPPORT DETAIL	8-7-95
D-6	CATCH BASIN	6-1-94R	T-1	TEMPORARY EROSION CONTROL DETAILS	6-1-94R
D-8	CATCH BASIN	1-3-00R	T-2	TEMPORARY EROSION CONTROL DETAILS	6-1-94R
D-9	CATCH BASIN	6-1-94R	EPSC-1	EROSION PREVENTION & SEDIMENT CONTROL DETAILS - SILT FENCE	5-12-04
			EPSC-2	EROSION PREVENTION & SEDIMENT CONTROL DETAILS - DROP INLET PROTECTION	5-11-04
			EPSC-3	EROSION PREVENTION & SEDIMENT CONTROL DETAILS - DITCH & SLOPE PREVENTION	5-11-04

NOTE:
THESE PLANS ARE SUBJECT TO SUCH ENGINEERING CHANGES AS MAY BE REQUIRED BY THE FEDERAL HIGHWAY ADMINISTRATION OR THE TOWN ENGINEER. CONSTRUCTION IS TO BE CARRIED ON IN ACCORDANCE WITH THESE PLANS AND THE VERMONT STANDARD SPECIFICATIONS FOR CONSTRUCTION DATED 2001, AS APPROVED BY THE FEDERAL HIGHWAY ADMINISTRATION ON JANUARY 4, 2001 FOR USE ON THIS PROJECT, INCLUDING ALL SUBSEQUENT REVISIONS AND SUCH REVISED SPECIFICATIONS AND SPECIAL PROVISIONS AS ARE INCORPORATED IN THESE PLANS.

FUNDING ASSISTANCE FOR THIS PROJECT IS BEING FURNISHED BY VTRANS AND FHWA

TOWN OF ESSEX
APPROVED _____ DATE _____
TOWN ENGINEER

DATUM
VERTICAL NAVD 1988
HORIZONTAL NAD 1983

#3

RECORD DRAWINGS 03-14-07
~~CONTRACT PLANS 10-20-05~~

DATE	REVISION	BY
12-19-05	REVISED FOR BIDDERS	BH/DH
10-20-05	REVISED FOR CONTRACT PLANS	BH/DH
09-09-05	REVISED FOR FINAL PLANS	BH/DB/DH

THESE PLANS WITH LATEST REVISIONS SHOULD ONLY BE USED FOR THE PURPOSE SHOWN BELOW:

STP WALK (9) TOWN OF ESSEX ROUTE 15 IN ESSEX CENTER, VT	# OF SHEETS proj. no. 02-132 survey L&D/OTHERS design DLH/LAL
OVERALL SITE PLAN	drawn DB checked LAL/DLH date 03/01/04
	scale 1" = 100' sht. no. 1

LD LAMOUREUX & DICKINSON
Consulting Engineers, Inc.
14 Morse Drive
Essex Junction, VT 05452
Tel: 802-878-4450