

TYPE III (Breakaway) BARRICADE MODIFIED
SEE STANDARD E-7A FOR DETAILS.
4' x 2' ARROW TO BE MOUNTED ON BARRICADE NEAREST TRAFFIC.
21 TYPE III (BREAKAWAY) BARRICADES NEEDED FOR TRANSITION OF TRAFFIC.

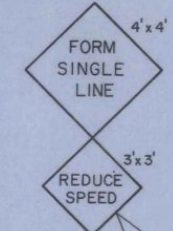

BARRICADE MATERIALS -
TYPE III BARRICADES ON THIS SHEET SHALL COMPLY WITH STANDARD SHEET E-7A.
ALL BARRICADES SHALL BE MAINTAINED IN A CLEAN AND LEGIBLE CONDITION SATISFACTORY TO THE ENGINEER. THEY SHALL BE COMPLETELY VISIBLE TO APPROACHING TRAFFIC AT ALL TIMES. THEY SHALL ALWAYS PRESENT A NEAT APPEARANCE. DAMAGED, DEFACED OR DIRTY BARRICADES SHALL BE REPAIRED, CLEANED OR REPLACED AS ORDERED BY THE ENGINEER.
SIGNS -
THE SIZES OF SIGNS SHALL BE AS INDICATED. THEY SHALL HAVE REFLECTORIZED ORANGE BACKGROUND WITH BLACK TEXT AND BORDER. SEE STANDARD SHEET E-10 FOR MATERIALS.

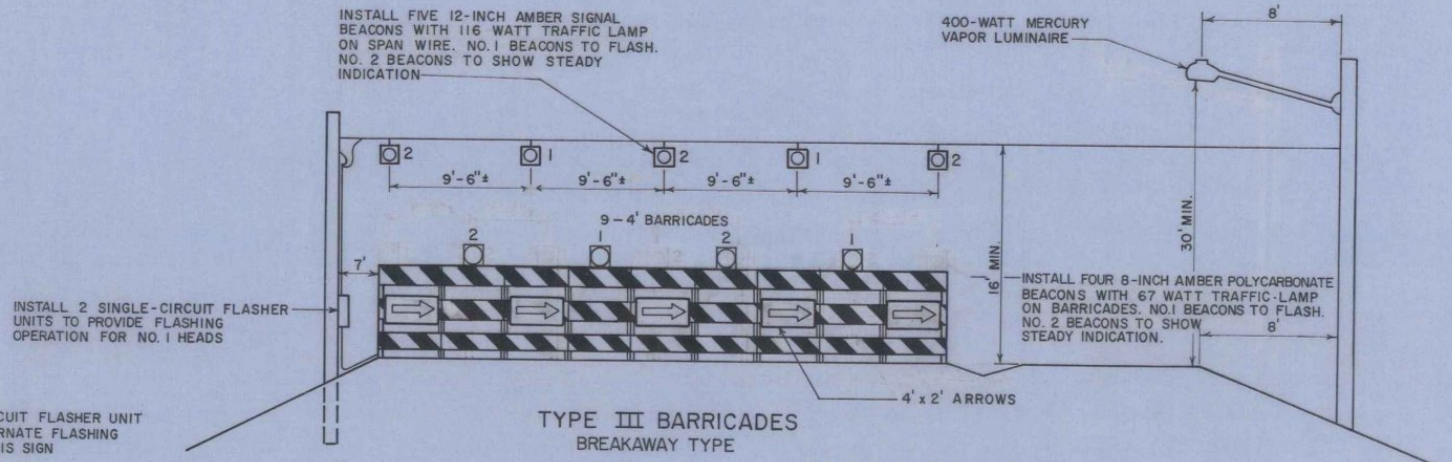
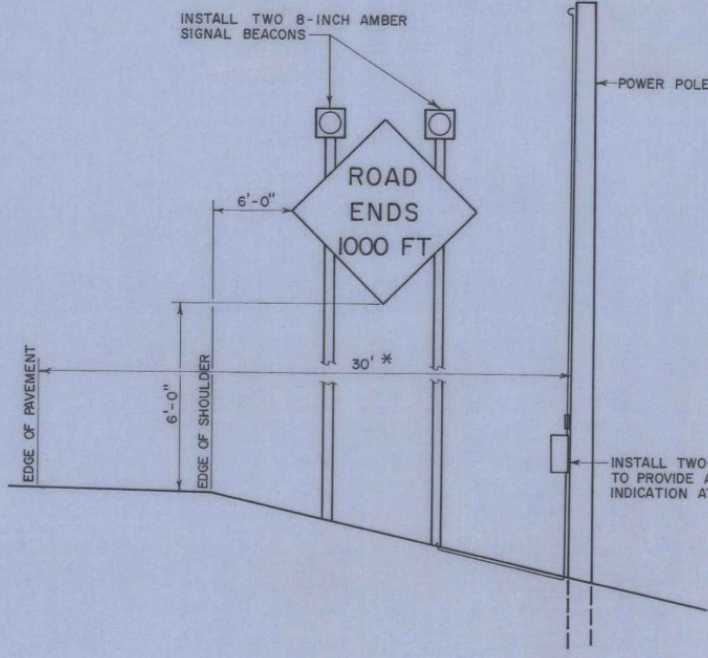
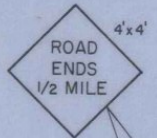
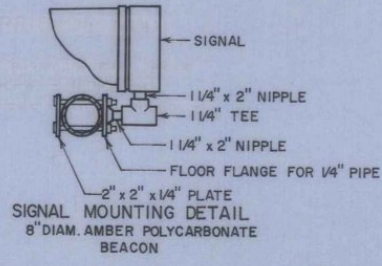
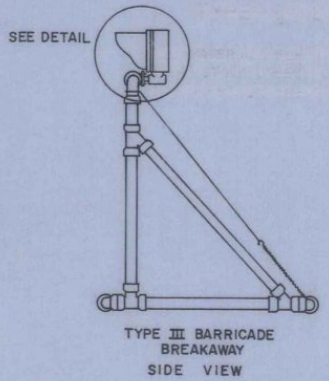
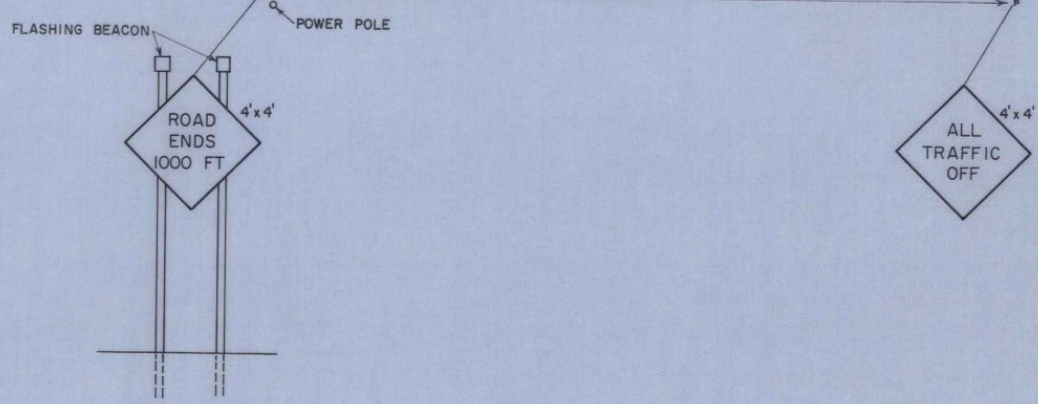
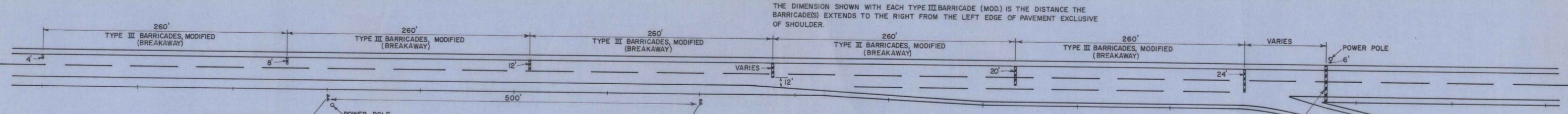
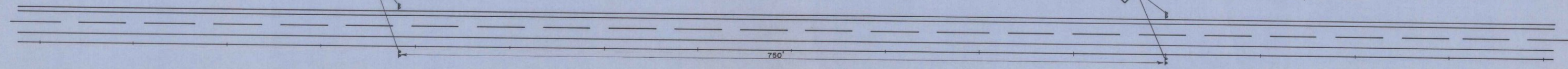

THE CONTRACTOR SHALL BE RESPONSIBLE FOR CONTACTING THE UTILITY COMPANY FOR INSTALLATION OF ALL POLES, SPAN WIRE, 400 WATT MERCURY VAPOR LUMINAIRE AND POWER SOURCE. ALL ELECTRICAL WORK SHALL BE DONE IN ACCORDANCE WITH THE REQUIREMENTS OF THE UTILITY COMPANY AND STANDARDS SET FORTH IN THE NATIONAL ELECTRICAL CODE.
IF POLES ARE TO BE INSTALLED TO CARRY THE POWER SOURCE TO THE ADVANCE BEACON INSTALLATION ON THE "ROAD ENDS 1000 FT" SIGN, THE POLES SHALL BE LOCATED A MINIMUM OF 30' FROM THE EDGE OF PAVEMENT; OR A SEPARATE POWER SOURCE SHALL BE PROVIDED AT THIS LOCATION. THE MAINTENANCE AND OPERATION OF THE BARRICADES, BEACONS, SIGNS, STREET LIGHT AND POWER SOURCE AND THE REMOVAL OF THE SAME SHALL BE THE RESPONSIBILITY OF THE STATE AFTER ACCEPTANCE OF THE PROJECT.
ALL MATERIALS WITH THE EXCEPTION OF THE POLES AND STREET LIGHT SHALL BECOME THE PROPERTY OF THE STATE OF VERMONT UPON ACCEPTANCE OF THE PROJECT.
THE BEACONS SHALL BE MOUNTED ON THE BARRICADES WITH A BRACKET OF A DESIGN APPROVED BY THE ENGINEER.
THE BEACONS TO BE USED OVERHEAD SHALL BE FURNISHED WITH HARDWARE FOR SPAN-WIRE MOUNTING. ALL FLASHING BEACONS, FLASHING MECHANISMS AND BEACON ACCESSORIES SHALL BE IN CONFORMANCE WITH STANDARD SPECIFICATION 752.07.
ALL ELECTRICAL FITTINGS SHALL BE OF ELECTRICAL CONDUIT AND BE ADEQUATELY GROUNDED.
A PERMIT AND INSPECTION ARE REQUIRED BY THE STATE ELECTRICAL INSPECTORS.

* IN LEDGE CUT SECTION DISTANCE FROM PAVEMENT TO POLE MAY BE MODIFIED TO NOT LESS THAN 25' FROM PAVEMENT TO POLE.

REVISIONS AND CORRECTIONS
MAY 23, 1975 - REVISIONS PER FHWA COMMENTS.
JUNE 8, 1977 - TYPE I BARRICADE REMOVED.
JUNE 27, 1977 - AMBER POLYCARBONATE BEACON ADDED.
JUNE 27, 1977 - REVISED TO INCLUDE ADDITIONAL ELECTRICAL REQUIREMENTS.

APPROVED
DATE April 4, 1975
E. H. Stickney
CHIEF ENGINEER
RO Munn
ASST. CHIEF ENGINEER
Leon E. Jones
HIGHWAY ENGINEER

TRAFFIC CONTROL DEVICES
FOR TEMPORARY TERMINATION
OF FREEWAY FACILITIES

VERMONT
DEPARTMENT
OF HIGHWAYS
STANDARD
E-41