

NOTES

LOCATION Bridge construction approach signs shall be located as detailed on this sheet or otherwise shown on the plans. They shall appear at each end of the project under construction, and on intersecting public highways. The exact placement of any sign will depend upon the alignment of the highway and the character of the roadsides. The location measurements on this sheet are intended to indicate the sequence to be followed, and the minimum spacing to be observed by the Engineer in determining exact locations.

DESIGN The designs of the signs and barricades shall conform with the details shown on this sheet and with the standards prescribed in the Manual on Uniform Traffic Control Devices prepared by National Joint Committee on Uniform Traffic Control Devices.

MATERIALS The signs shall be of metal, wood, plywood, hardboard or any other material satisfactory to the Engineer. No material shall be approved that will deteriorate by exposure to the weather during the required life of the sign. Barricades normally will be of wood or wood and metal construction.

REFLECTORIZING For reflectorizing sign backgrounds, either reflective sheeting or the direct process of glass beads on point will be acceptable. So-called reflective point may be used to stripe the barricades, but not for signs.

ILLUMINATION If desired by the contractor, and approved by the Engineer, a sign may be illuminated instead of reflectorized. The illumination may be provided by incandescent or fluorescent lamps, or by spotlights. Lamps shall be properly shielded to protect drivers from glare. Torches, lanterns, or existing street lighting are not acceptable for sign illumination. If the Engineer considers that a reflectorized sign is not adequate, he may order that it be illuminated.

INSTALLATION The signs and barricades shall be in place at the time the project officially commences. Each sign shall be erected in a neat and workmanlike manner on wood or metal posts set securely in the ground. The bottom of a sign shall be at least 5 feet above road level, and the nearest edge of a sign shall be at least 6 feet outside the shoulder point or 2 feet outside the guard rail, curbing or sidewalk. Posts and signs shall be braced or reinforced in back as necessary. The installation of signs and barricades shall be subject to the approval of the Engineer.

BARRICADES Depending on the nature of the requirements, barricades may be fixed or moveable. For fixed barricades, the horizontal rails shall be mounted on posts set firmly in the ground. Moveable barricades will be appropriate where the movement of equipment must be provided for. In any case, the Road Closed and Detour arrow signs, when used, must be effectively presented to traffic at all times.

MAINTENANCE Signs shall be maintained in a clean and legible condition satisfactory to the Engineer. They shall be completely visible to approaching traffic at all times. They shall be kept plumb and level, and always present a neat appearance. Damaged, defaced or dirty signs shall be repaired, cleaned or replaced as ordered by the Engineer.

GENERAL The cost of furnishing, erecting, maintaining, and removing all construction approach signs shall be born by the contractor without additional compensation. (See Standard Specifications, Division I, Section 7, Article 707 "Public Convenience and Safety.")

In all phases of construction approach signing, the requirements set forth in the Manual on Uniform Traffic Control Devices shall be met. (See Standard Specifications, Division I, Section 7, Article 708 "Barricades, Warning and Detour Signs.")

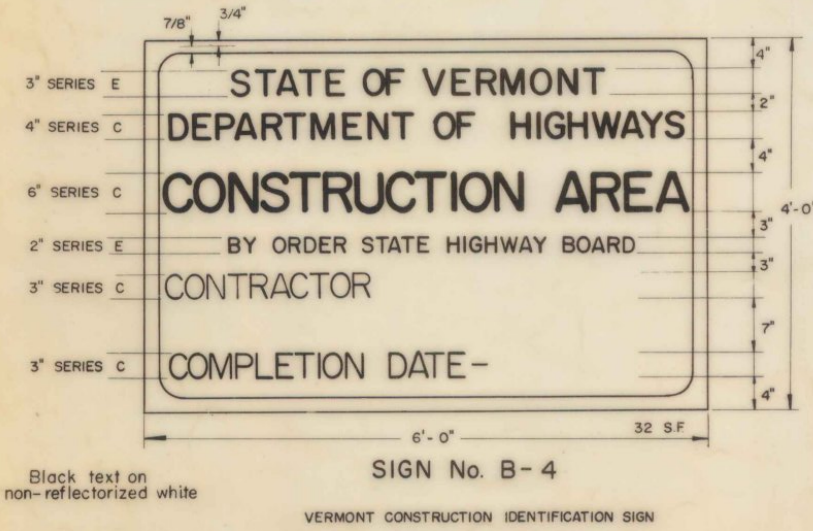
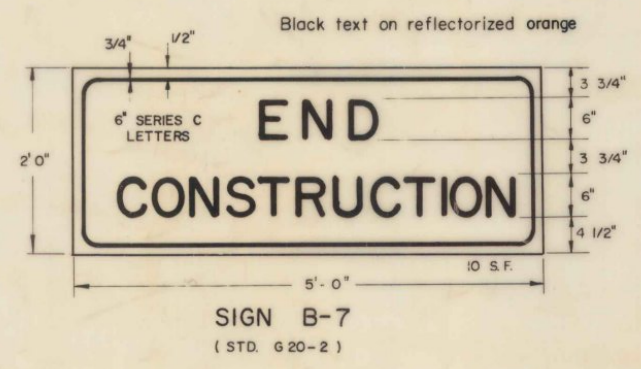
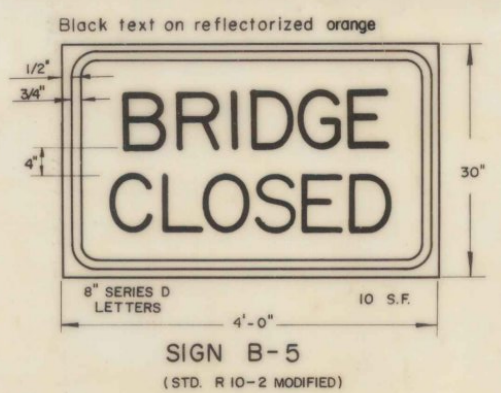
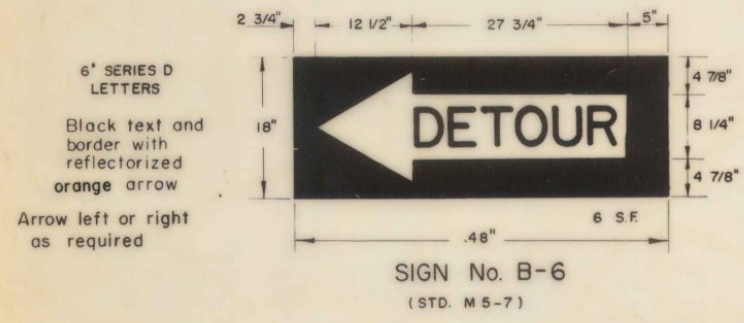

The bridge construction approach signs show on this sheet are intended for use in providing warning and information at isolated bridge projects, although they may be ordered by the Engineer at bridge work on a road construction project. When additional approach signs or other types of signing or control are necessary, the plans and/or the Special Provisions for that project will give the details of the signs and controls required.

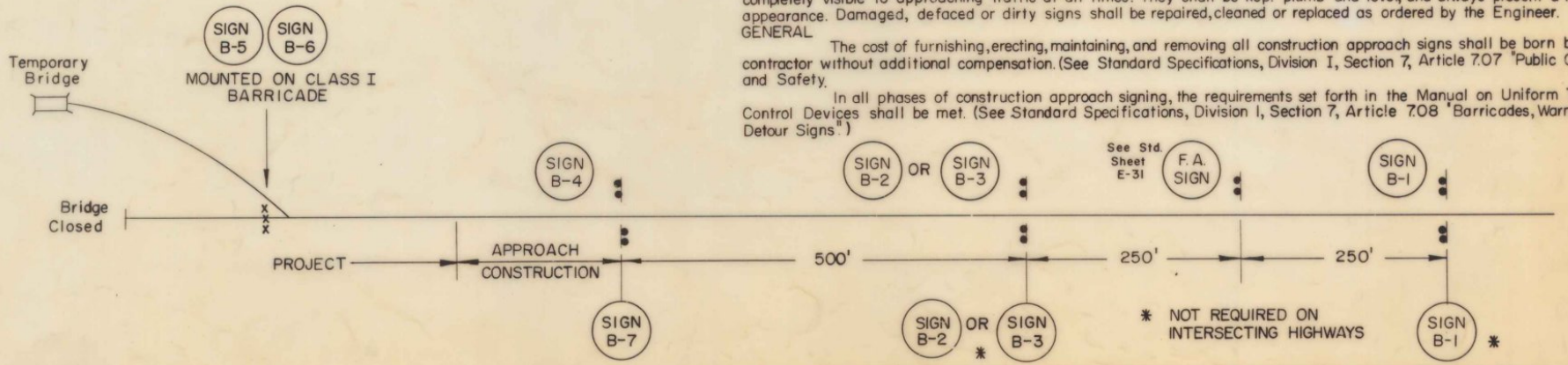

REVISIONS AND CORRECTIONS
May 6, 97 Colors revised to conform with the Manual on Uniform Traffic Control Devices, 97th edition

APPROVED
DATE
JAN 6, 1967
R.H. Crowl
CHIEF ENGINEER
E. Beck By
ASST. CHIEF ENGINEER
A.W. Coleman
TRAFFIC ENGINEER

TRAFFIC SIGNS
BRIDGE CONSTRUCTION
APPROACH SIGNS

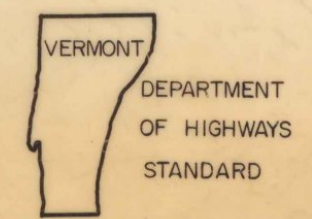

DEPARTMENT OF HIGHWAYS
STANDARD
E-33