

LEGEND

- Property now owned in fee simple.
- ▨ Property on which aviation easements are to be acquired by purchase or condemnation showing nature of obstructions, restricting heights of future structure as to growth, and establishing right of flight at low altitudes.

Point of Beginning of Landing Strip shown in & appears on plot of County records, 25-115 of the corner of old Mt. Zion House and 25-115-2-2 from intersection of 40° 15' 30" W 225.00' E and 71° 00' 00" N 225.00' E shown in said records.

PLAN SHOWING PROPERTY AND LOCATION FOR AVIATION EASEMENTS



LEGEND

- Town Line
- Limits of Property Lines
- Center Line of Landing Strip
- Limits of Landing Strip
- Limits of Approach Zone
- IP Iron Pipe

Notes:
Bearings shown are Magnetic unless otherwise noted. Dates shown on Plan are present or future unless information shown on this Plan pertaining to existing property lines is from data furnished by Village of St. Johnsbury, VT.



EXHIBIT A

VILLAGE OF ST. JOHNSBURY, VT.
BOARD OF VILLAGE TRUSTEES

ST. JOHNSBURY AIRPORT

PLAN TO ACCOMPANY
SPONSOR'S ASSURANCE AGREEMENT

DECEMBER 4, 1967

PREPARED BY TAY, SPOFFORD & THORNDIKE ENGINEERS, BOSTON-NEW YORK	DRAWN BY TH. D.F.M. CHK. W.T.F.B.	FILE NO. Os-5a
APPROVED: <i>[Signature]</i>	PLAN NO.	11

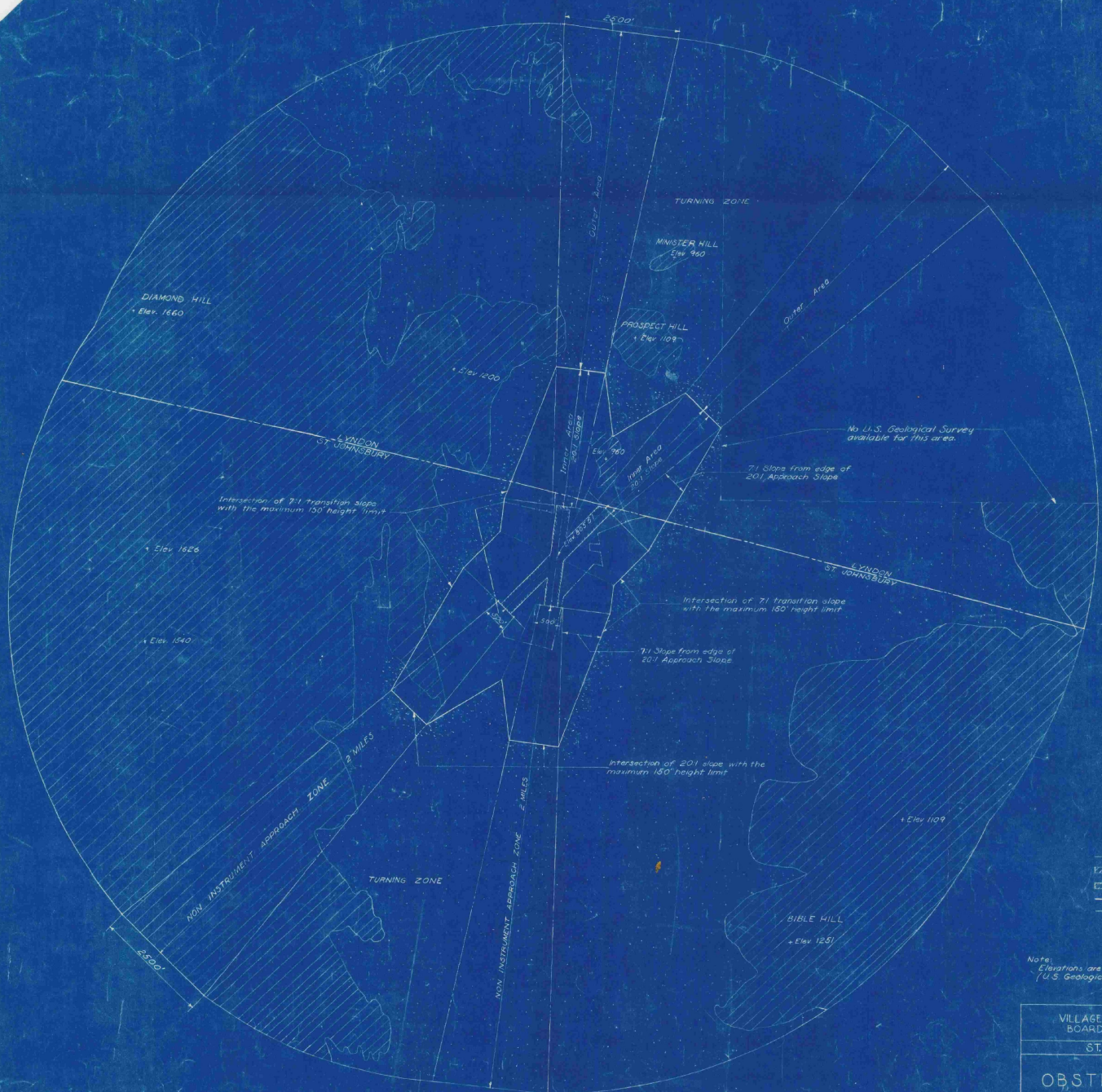

No U.S. Geological Survey available for this area.

Intersection of 7:1 transition slope with the maximum 150' height limit

Intersection of 7:1 transition slope with the maximum 150' height limit

Intersection of 20:1 slope with the maximum 150' height limit

LEGEND

- Property Line
- ▨ Area 150' Above Airport
- ▤ Landing Area
- Town Line
- Approach Zones

Note: Elevations are based on Mean Sea Level (U.S. Geological Survey)

EXHIBIT B

VILLAGE OF ST. JOHNSBURY, VT. BOARD OF VILLAGE TRUSTEES	
ST. JOHNSBURY AIRPORT	
OBSTRUCTION PLAN	
DECEMBER 4, 1947	
BY: G.F.W.	CHK: J.H.C.
BY: J.F.D.	CHK: S.B.T. JR.
APPROVED: <i>Edmund</i>	PLN: OS-5a
	12





LEGEND
 City or Town Lines
 Improved Roads
 US Highways
 State Highways
 C & G.S. Bench Mark

NOTES
 Elevation (Highest point in suitable landing area)
 Airline distance and direction from town miles
 Distance by road to Post Office



VICINITY MAP
 1 INCH = 10 MILES (APPROX.)

TOWN OF ST. JOHNSBURY VERMONT

INDEX TO CONTRACT DRAWING

ESTIMATED QUANTITIES OF MAJOR ITEMS

- | SHEET NO | TITLE |
|----------|----------------------------------|
| 1 | TITLE SHEET AND LOCATION MAP |
| 2 | MASTER PLAN INITIAL CONSTRUCTION |
| 3 | LAYOUT PLAN |
| 4 | CLEARING PLAN |
| 5 | |
| 6 | LANDING STRIP PLAN AND PROFILE |
| 7 | LANDING STRIP PLAN AND PROFILE |
| 8 | GRADING AND DRAINAGE PLAN |

Sheet 6 of 8, Landing Plan & Grading & Drainage plan
SW-NE Runway
Clear sections and details
Grading and drainage details

CONSTRUCTION PLANS FOR ST. JOHNSBURY AIRPORT

CIVIL AERONAUTICS ADMINISTRATION

APPROVED _____ DIRECTOR
 DATE _____ AIRPORT ENGINEERING SERVICE

APPROVED _____ SUPERINTENDENT
 DATE _____ AIRPORTS BRANCH

APPROVED _____ DISTRICT AIRPORT ENGINEER
 DATE _____

VERMONT AERONAUTICS COMMISSION

APPROVED _____ CHAIRMAN
 DATE _____

APPROVED _____ DIRECTOR
 DATE _____

APPROVED _____ ENGINEER
 DATE _____

ST. JOHNSBURY

APPROVED _____ CHAIRMAN
 DATE _____ BOARD OF SELECTMEN

APPROVED _____ CHAIRMAN AIRPORT COMMISSION
 DATE _____

PREPARED BY

FAY, SPOFFORD & THORNDIKE, ENGINEERS
 BOSTON - NEW YORK

APPROVED _____ PARTNER IN CHARGE
 DATE _____

APPROVED _____ AIRPORT ENGINEER
 DATE _____

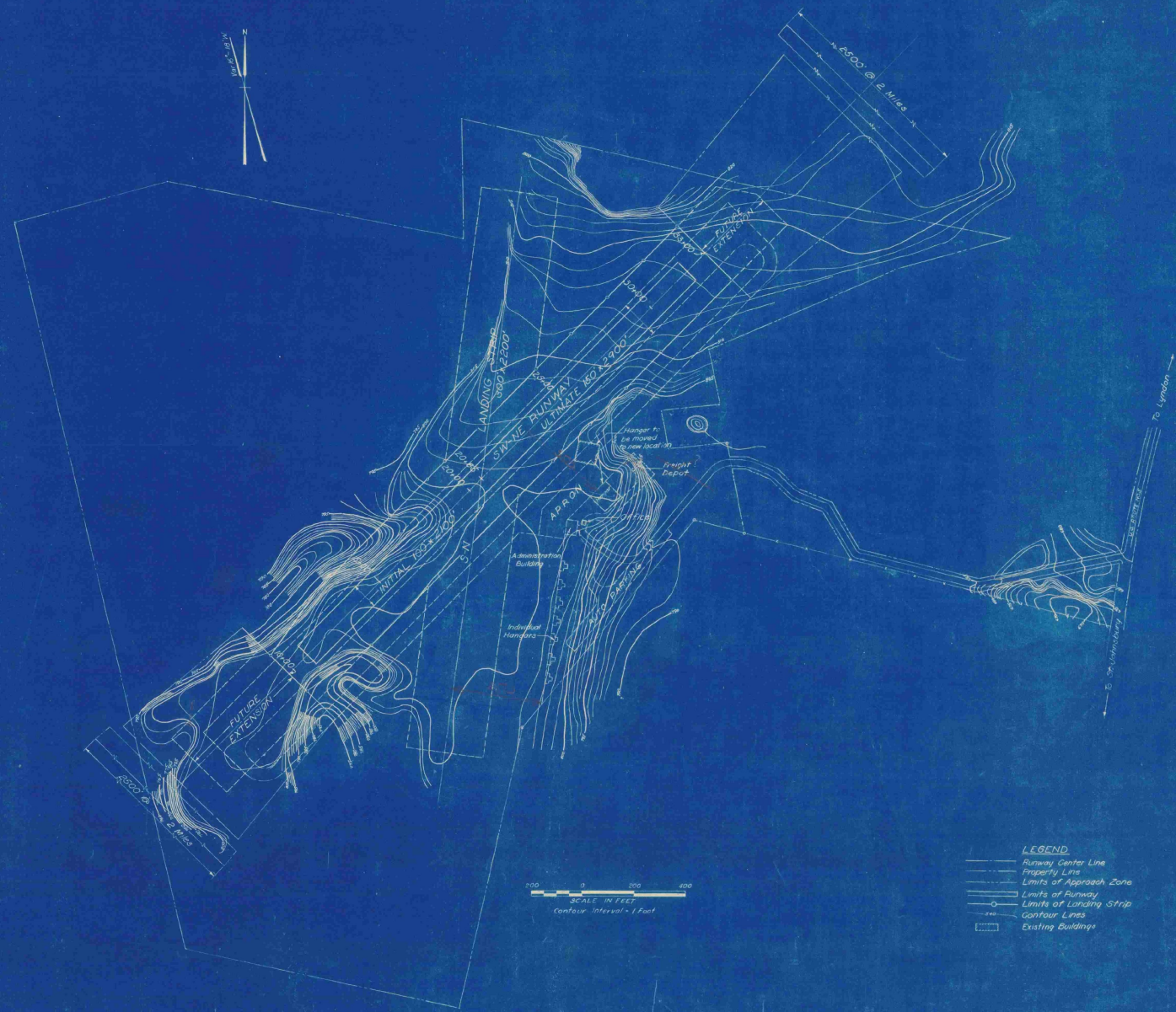

- LEGEND**
- Runway Center Line
 - Property Line
 - Limits of Approach Zone
 - Limits of Runway
 - Limits of Landing Strip
 - Contour Lines
 - ▭ Existing Buildings

Notes:
 Elevations are based on Mean Sea Level (U.S. Geological Survey)
 No official information as to wind directions or intensities.

TOWN OF ST. JOHNSBURY, VT.			
BOARD OF VILLAGE TRUSTEES			
ST. JOHNSBURY AIRPORT			
MASTER PLAN			
INITIAL CONSTRUCTION			
SCALE: AS NOTED		1947	
FAY, SPOFFORD & THORNDIKE, ENGINEERS, BOSTON-NEW YORK			
APPROVED	CHAIRMAN	JURIST	COMMISSIONER
FILE NO.	DATE	BY	NO.
			05-5d
APPROVED	PARTNER IN CHARGE	BY	NO.

CONTRACT DRAWING SHEET NO. OF

C.P.W.
 J.P.W.
 J.F.D.

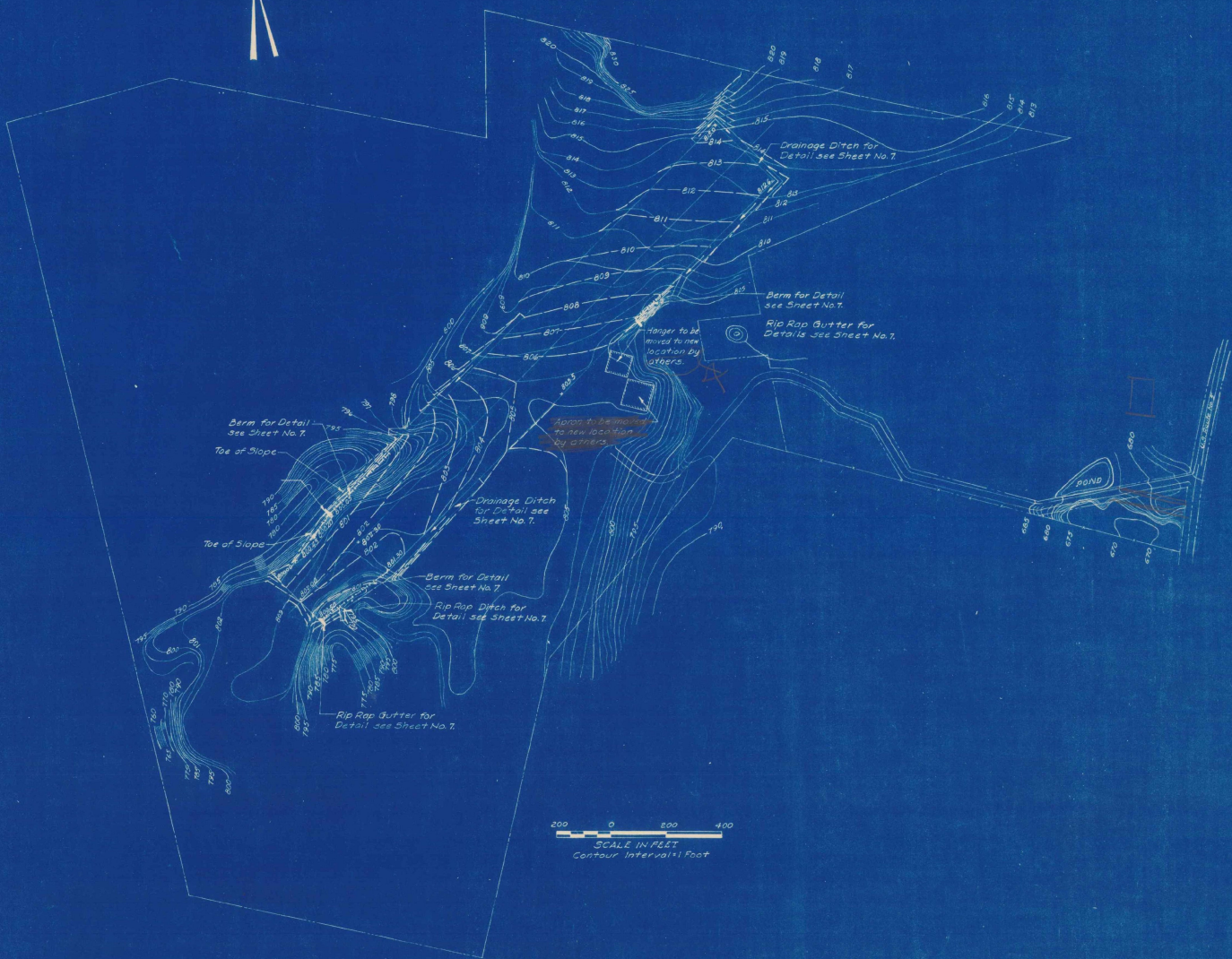

200 0 200 400
SCALE IN FEET
Contour Interval = 1 Foot

TOWN OF ST. JOHNSBURY, VT. BOARD OF VILLAGE TRUSTEES			
ST. JOHNSBURY AIRPORT			
FAY, SPOFFORD & THORNDIKE ENGINEERS, BOSTON-NEW YORK			
APPROVED	CHAIRMAN AIRPORT COMMISSION	FILE NO.	
APPROVED	PARTNER IN CHARGE	PLAN NO.	

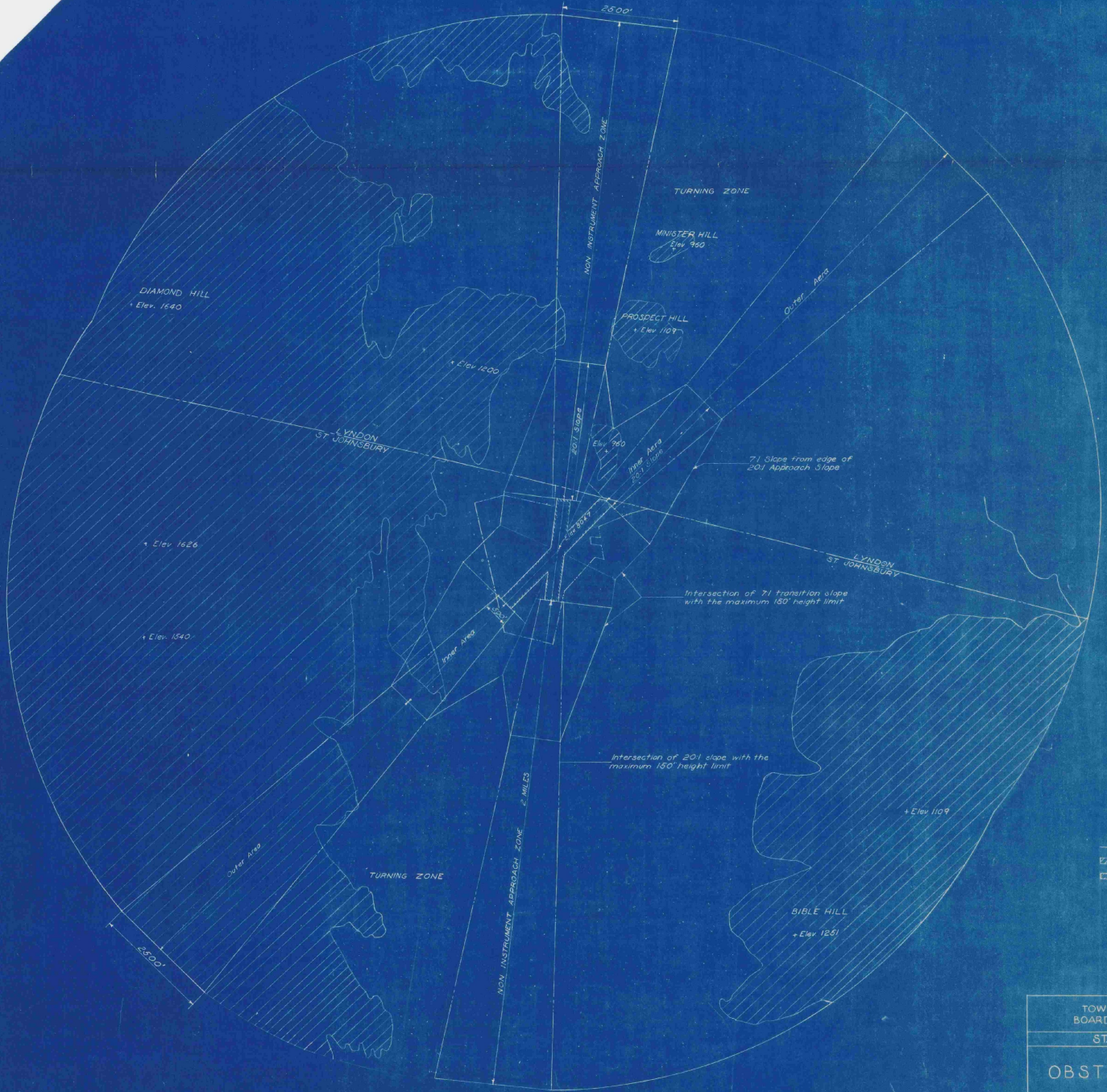

LEGEND

- Property Line
- ▨ Area 150' Above Airport
- ▩ Landing Area

EXHIBIT B

TOWN OF ST. JOHNSBURY VT
BOARD OF VILLAGE TRUSTEES

ST. JOHNSBURY AIRPORT

OBSTRUCTION PLAN

FAY SPOFFORD & THORNDIKE, ENGINEERS, BOSTON-NEW YORK

DES.	TS.	FILED
DR.	CHKD.	FILED
APPROVED		DATE



6B-3

55, 56, 57, 58, 59, 60, 61, 62, 63, 64, 65, 66, 67, 68, 69, 70, 71, 72, 73, 74, 75, 76, 77, 78, 79, 80, 81, 82, 83, 84, 85, 86, 87, 88, 89, 90, 91, 92, 93, 94, 95, 96, 97, 98, 99, 100