

# VERMONT AGENCY OF TRANSPORTATION

## EDWARD F. KNAPP STATE AIRPORT BERLIN, VERMONT

### LAYOUT PLAN

ALL WEATHER WIND ROSE

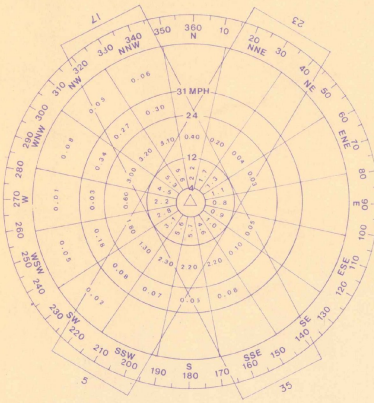

12 MPH CROSSWIND COVERAGE RWY 5-23 + 84.8%  
12 MPH CROSSWIND COVERAGE RWY 17-35 + 92.2%  
12 MPH CROSSWIND COVERAGE ALL RUNWAYS + 96.7%  
△ + 29.3% CALMS + 0-4 MPH  
NO. OF OBSERVATIONS 51,840, PERIOD 1949-1954

SOURCE: U. S. WEATHER BUREAU, E. F. KNAPP AIRPORT, BERLIN, VERMONT

IFR WIND ROSE

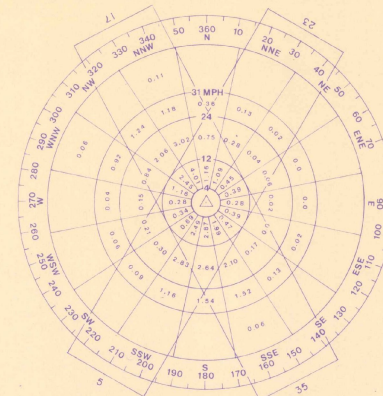

12 MPH CROSSWIND COVERAGE RWY 5-23 + 85.6%  
12 MPH CROSSWIND COVERAGE RWY 17-35 + 92.6%  
12 MPH CROSSWIND COVERAGE ALL RUNWAYS + 98.2%  
△ + 55.3% CALMS + 0-4 MPH  
NO. OF OBSERVATIONS 4,662, PERIOD 1950-1954

IFR WEATHER OCCURS 10.6% OF THE TIME

### LIST OF DRAWINGS

1. COVER SHEET
2. PROPOSED LAYOUT PLAN
3. TERMINAL AREA PLAN
4. PLAN & PROFILE RUNWAY 17-35
5. PLAN & PROFILE RUNWAY 5-23
6. AIRPORT SURFACES PART 77

### RUNWAY DATA

	R U N W A Y							
	5		23		17		35	
	EXISTING	ULTIMATE	EXISTING	ULTIMATE	EXISTING	ULTIMATE	EXISTING	ULTIMATE
EFFECTIVE GRADIENT (IN %)	0.79%	SAME	0.79%	SAME	1.46%	SAME	1.46%	SAME
RUNWAY DESIGNATION	BASIC	SAME	BASIC	SAME	PREC. INSTR.	SAME	NO. INSTRUMENT	SAME
APPROACH SURFACES	20-1	SAME	20-1	SAME	50-1	SAME	34-1	SAME
NAVIGATIONAL AIDS	NONE	SAME	NONE	SAME	ILS	—	—	VOR
VISUAL AIDS	—	REILS	—	VASI-2, REILS	MALSR	VASI-4	—	REILS
RUNWAY LIGHTING	—	MIRL	—	MIRL	MIRL	HIRL	MIRL	HIRL
RUNWAY MARKING	BASIC	SAME	BASIC	SAME	PREC. INSTR.	SAME	PREC. INSTR.	SAME
% WIND COVERAGE	ALL WEATHER 84.8% - IFR 85.6%				ALL WEATHER 92.2% - IFR 92.6%			
PAVEMENT STRENGTH	12,500 LBS.		12,500 LBS.		31,000 LBS.		31,000 LBS.	
GROSS AIRCRAFT WEIGHT-SINGLE WHEEL	12,500 LBS.		12,500 LBS.		31,000 LBS.		31,000 LBS.	

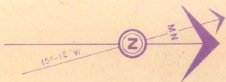

AIRPORT DATA	
AIRPORT ELEVATION	1165'
AIRPORT REFERENCE POINT COORDINATES (ARP)	N 44°-12'-14" W 72°-33'-47"
MEAN MAX. TEMP HOTTEST MONTH	79.9°F

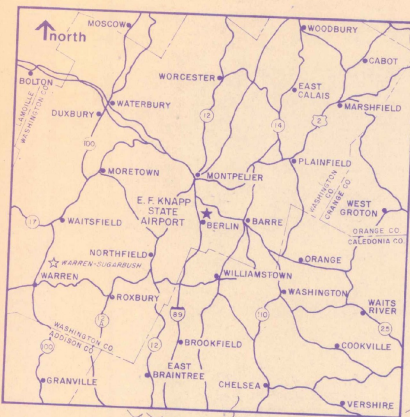

LOCATION MAP

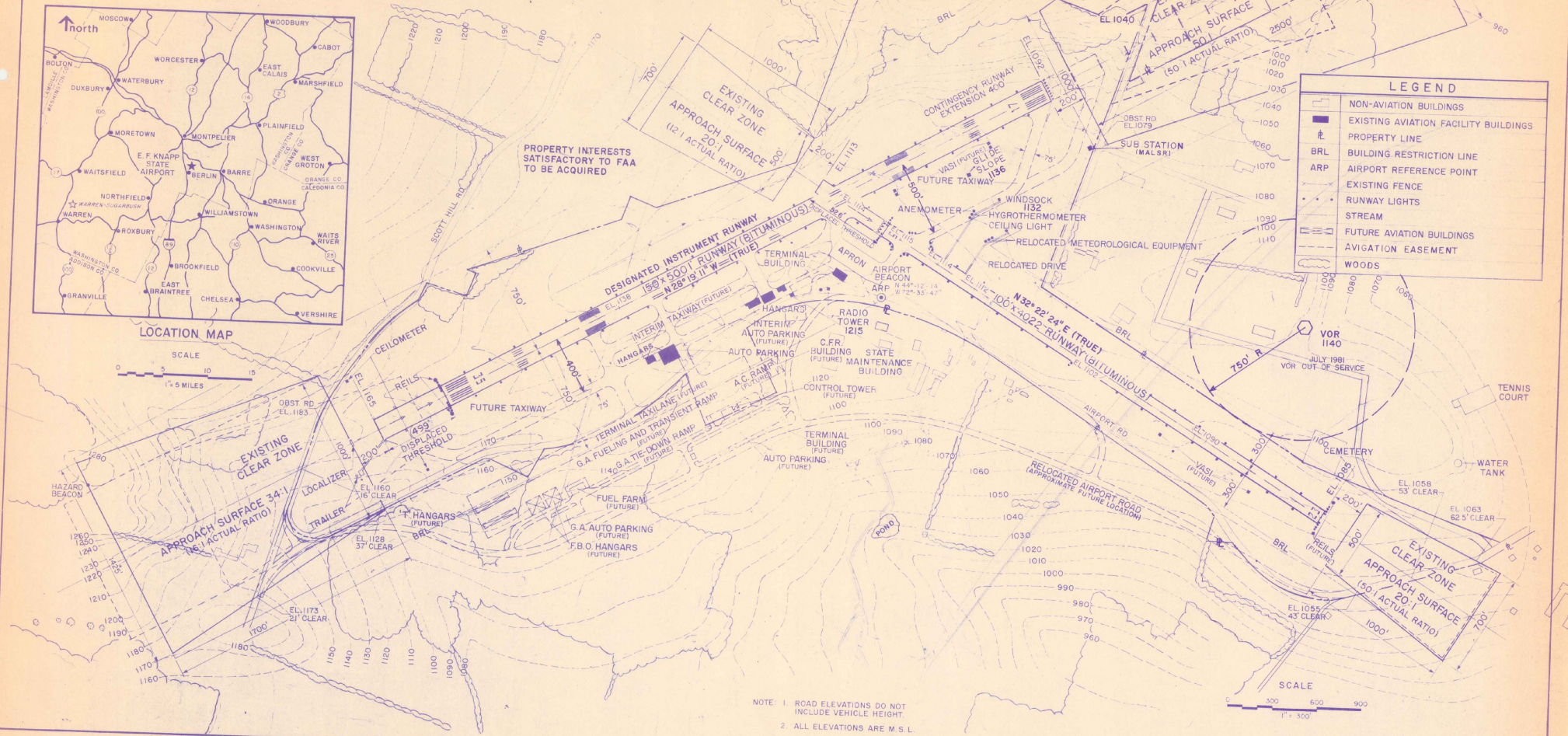
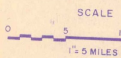

LEGEND	
[Symbol]	NON-AVIATION BUILDINGS
[Symbol]	EXISTING AVIATION FACILITY BUILDINGS
[Symbol]	PROPERTY LINE
[Symbol]	BRL BUILDING RESTRICTION LINE
[Symbol]	ARP AIRPORT REFERENCE POINT
[Symbol]	EXISTING FENCE
[Symbol]	RUNWAY LIGHTS
[Symbol]	STREAM
[Symbol]	FUTURE AVIATION BUILDINGS
[Symbol]	AVIGATION EASEMENT
[Symbol]	WOODS

NOTE: 1. ROAD ELEVATIONS DO NOT INCLUDE VEHICLE HEIGHT.  
2. ALL ELEVATIONS ARE M.S.L.

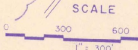

FEDERAL AVIATION ADMINISTRATION

Approved: \_\_\_\_\_  
 Chief of Airport Planning Branch

Approval Subject to Comments and Recommendations in Letter Dated \_\_\_\_\_

Date: \_\_\_\_\_

VERMONT AGENCY OF TRANSPORTATION

Approved: \_\_\_\_\_  
 Secretary of Transportation

Date: \_\_\_\_\_

Approved: \_\_\_\_\_  
 Director Engineering and Construction





Date: \_\_\_\_\_

EDWARD F. KNAPP STATE AIRPORT  
 Proposed Airport Layout Plan

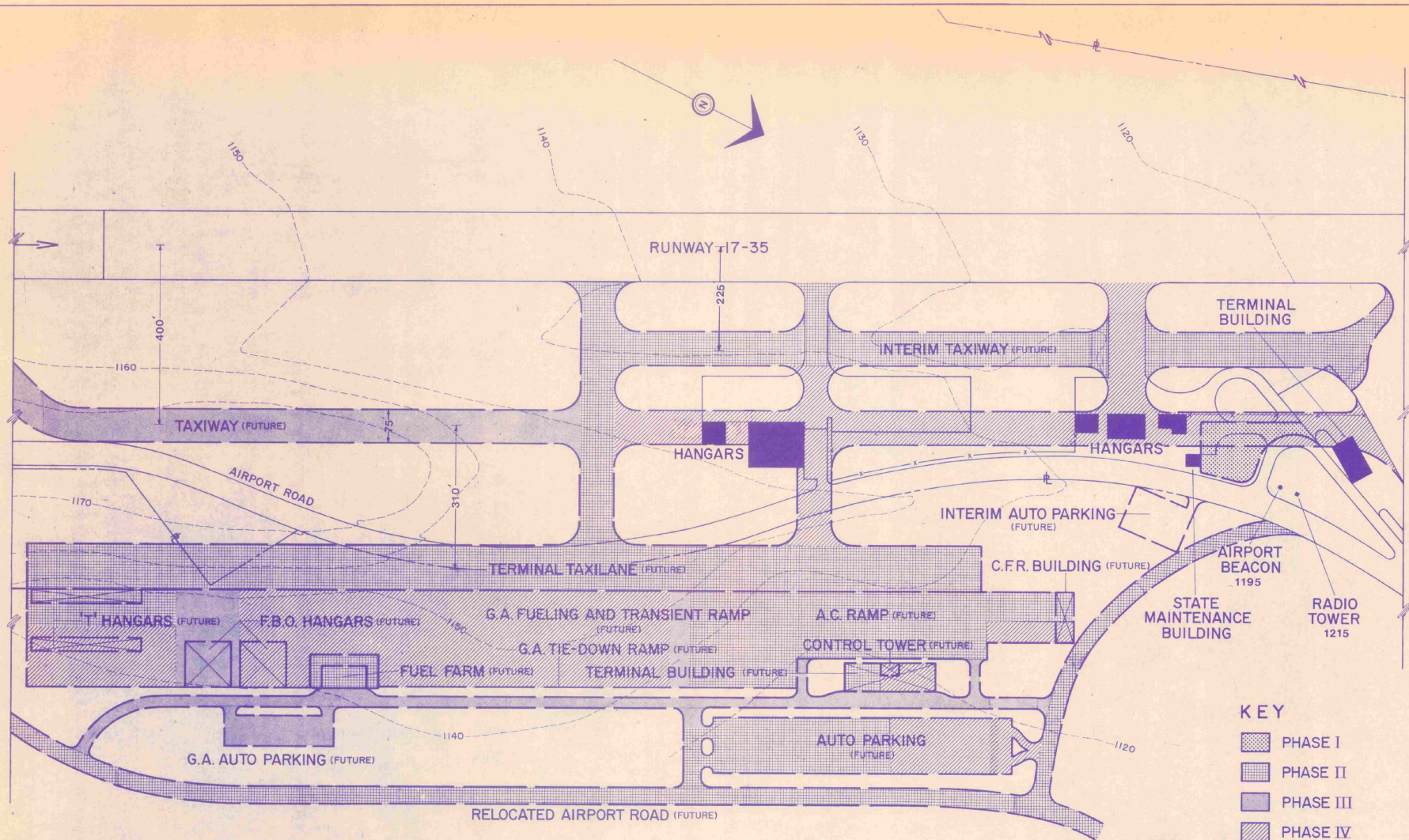
Date: Aug 1981

SHEET 2 OF 6



- KEY**
-  PHASE I
  -  PHASE II
  -  PHASE III
  -  PHASE IV

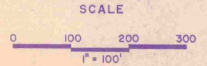

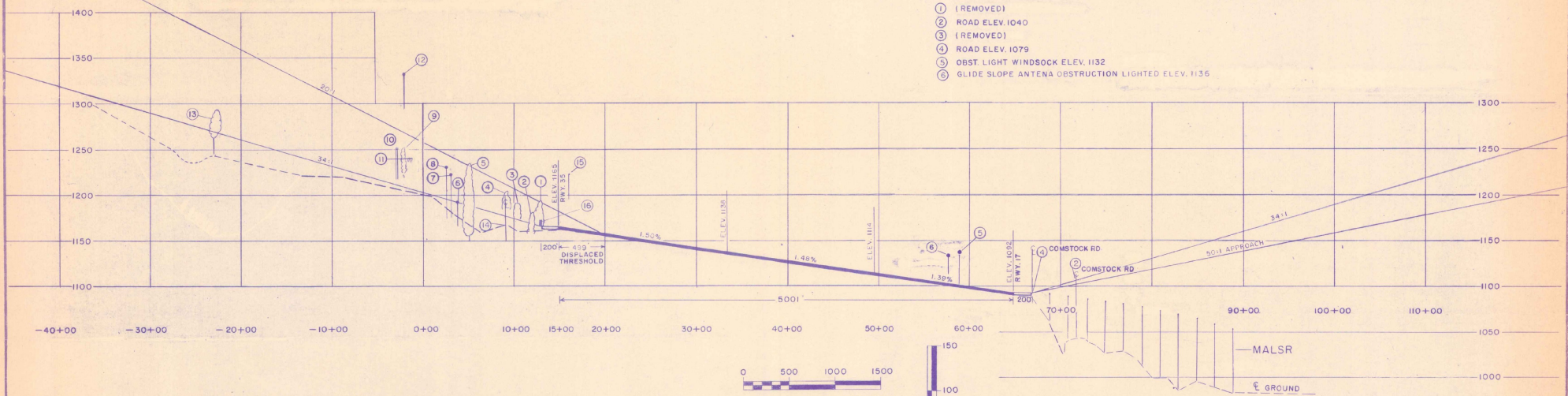
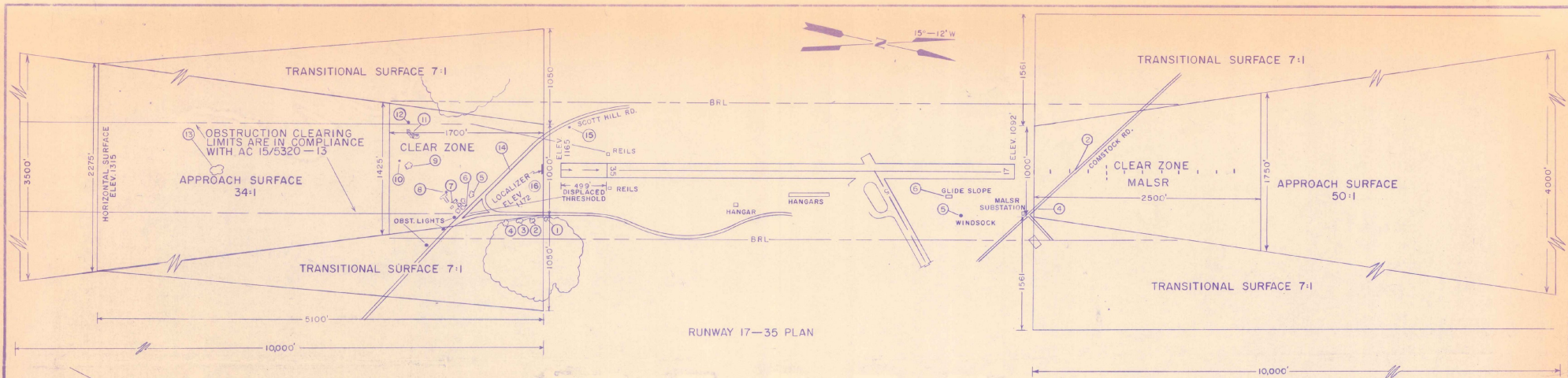

- ① (REMOVED)
- ② ROAD ELEV. 1040
- ③ (REMOVED)
- ④ ROAD ELEV. 1079
- ⑤ OBST. LIGHT WINDSOCK ELEV. 1132
- ⑥ GLIDE SLOPE ANTENNA OBSTRUCTION LIGHTED ELEV. 1136

- ① TREE ELEV. 1193
- ② TREE ELEV. 1181
- ③ TREE ELEV. 1192
- ④ TREES "CLUMP" ELEV. 1205
- ⑤ TREE ELEV. 1234
- ⑥ OBST. LIGHT POLE ELEV. 1193
- ⑦ OBST. LIGHT BARN ELEV. 1223
- ⑧ OBST. LIGHT BARN ELEV. 1231
- ⑨ TREE ELEV. 1255
- ⑩ UTILITY POLE ELEV. 1250
- ⑪ GROUND ELEV. 1234
- ⑫ HAZARD BEACON ELEV. 1333
- ⑬ TREE ELEV. 1290
- ⑭ ROAD ELEV. 1167
- ⑮ OBST. LIGHT POLE ELEV. 1223
- ⑯ OBST. LIGHTED LOCALIZER ANTENNA ELEV. 1172

NOTE 1 TOPOGRAPHICAL DATA SURVEYED BY THE V.A.O.T. IN OCT. 1978 AND JULY 1980  
 2 ROAD ELEVATIONS DO NOT INCLUDE VEHICLE HEIGHT  
 3 ALL ELEVATIONS ARE REFERENCED TO MEAN SEA LEVEL  
 4 DISPLACED THRESHOLD DETERMINED BY FAA AC 150/5320-13  
 5 FOR SUPPLEMENTAL OBSTRUCTION DATA SEE NATIONAL OCEAN SURVEY OBSTRUCTION CHART 522 AND SHEET 6 OF 6

EDWARD F. KNAPP STATE AIRPORT BERLIN, VERMONT			
<b>PLAN AND PROFILE RUNWAY 17-35 AND APPROACHES</b>			
REV.	DATE	DRW. BY	CHKD. BY
VERMONT AGENCY OF TRANSPORTATION PROJECT PLANNING DIVISION MONTPELIER, VERMONT			SCALE 1"=500' HORIZONTAL 1"=50' VERTICAL
DES. BY STEVENS		DRW. BY LAVIN	CHKD. BY LEACH
DATE AUG. 1981		SHEET 4 OF 6	
05602			



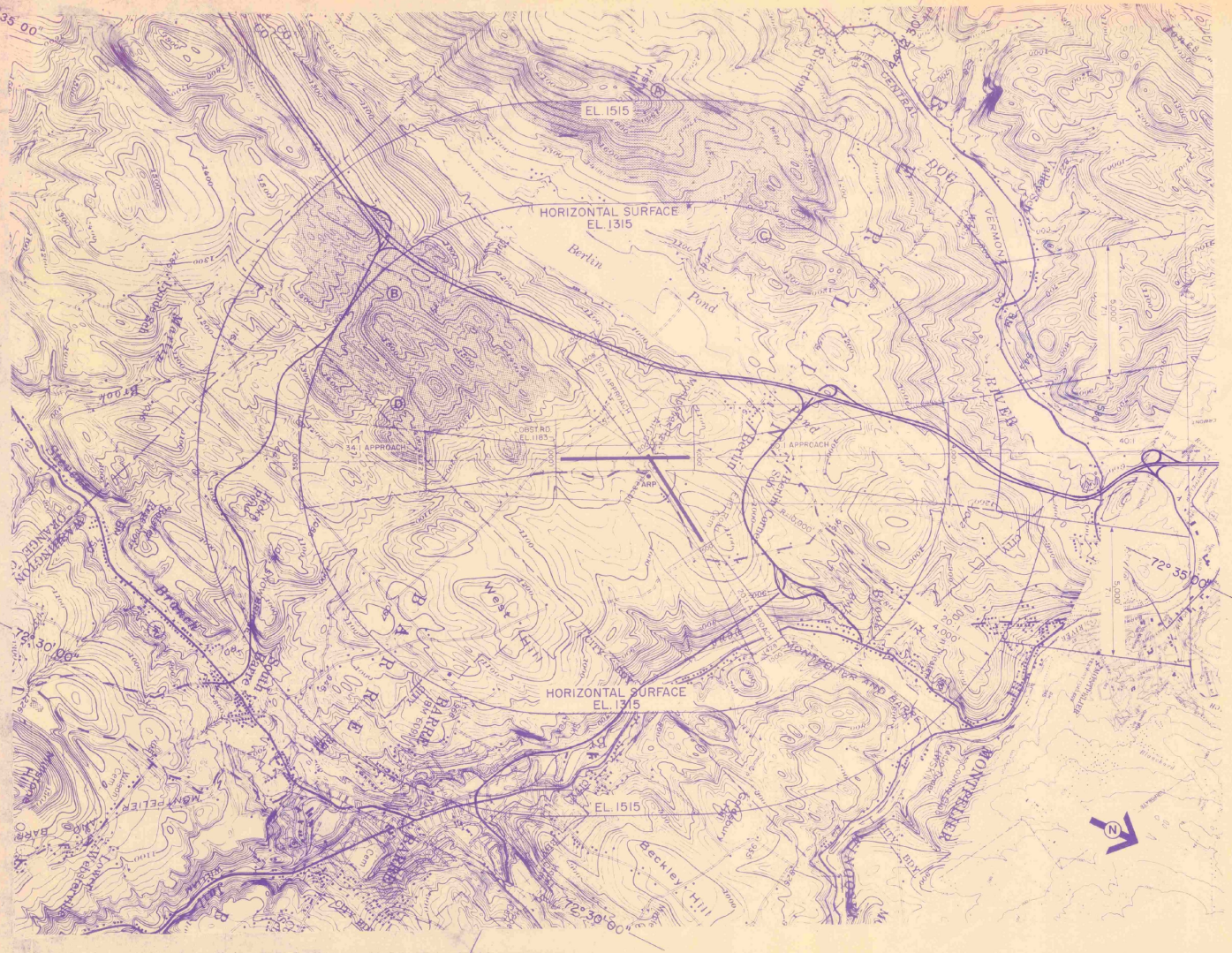

HILLS PENETRATING PART 77  
 NAVIGABLE AIRSPACE

44°12'30"

EDWARD F. KNAPP STATE AIRPORT  
 AIRPORT SURFACES-PART 77  
 GROUND OBSTRUCTION STUDY

SCALE: 1"=2000'

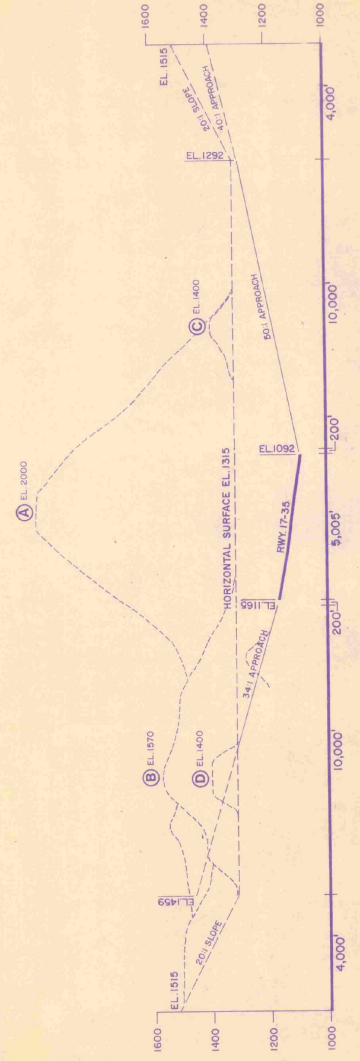

SCALE: HORIZ. 1"=2000'  
 VERT. 1"=200'