

- NOTES:
1. ALL GRSC SWEEPS SHALL HAVE GROUND CLAMPS AND BE CONNECTED TO A GROUND ROD VIA #6 SOLID BARE CU WIRE.
 2. CABLE MARKERS SHALL BE PLACED EVERY 200 FEET ALONG TRENCH AND AT ANY CHANGE IN DIRECTION.
 3. ALL TRENCHES SHALL BE FILLED IN LAYERS NOT EXCEEDING 6" AND EACH LAYER SHALL BE COMPACTED TO 95% OF MAXIMUM DENSITY. FILL SHALL BE OF STRUCTURAL NATURE ONLY.
 4. ALL INSULATED CABLE SHALL BE PROPERLY AND PERMANENTLY COLOR CODED AT EACH END PRIOR TO INSTALLATION.
 5. CONTRACTOR SHALL VERIFY THAT GROUND LUGS HAVE BEEN INSTALLED ON BOTH INTERIOR AND EXTERIOR OF JAQUITH CAN. IF CLAMPS DO NOT EXIST, CONTRACTOR SHALL BE RESPONSIBLE FOR INSTALLATION.
 6. CONTRACTOR SHALL FURNISH AND INSTALL BRASS IDENTIFICATION PLATES. THESE PLATES SHALL BE 8" X 8" WITH THREE ROWS OF CHARACTERS (2 FOR WORDS, 1 FOR DIRECTION ARROW), AND 1" LETTERING.
 7. CONTRACTOR SHALL DRILL 1 1/2" HOLE THROUGH THE BOTTOM OF JAQUITH CAN, AND SPRAY COLD GALV. ON CAN PRIOR TO INSTALLATION.
 8. INSTALL A 3"x3"x1' 3/4" CRUSHED STONE SUMP UNDER ALL JAQUITH CANS. THE CRUSHED STONE SHALL BE WRAPPED IN GEOTEXTILE FABRIC.

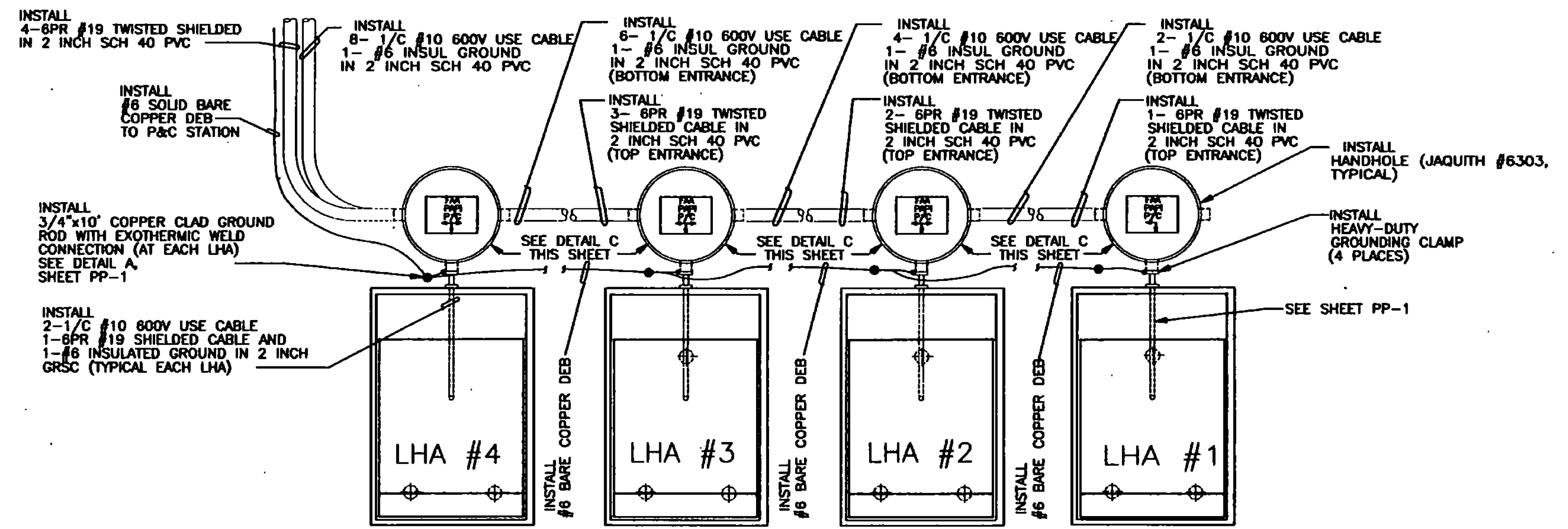
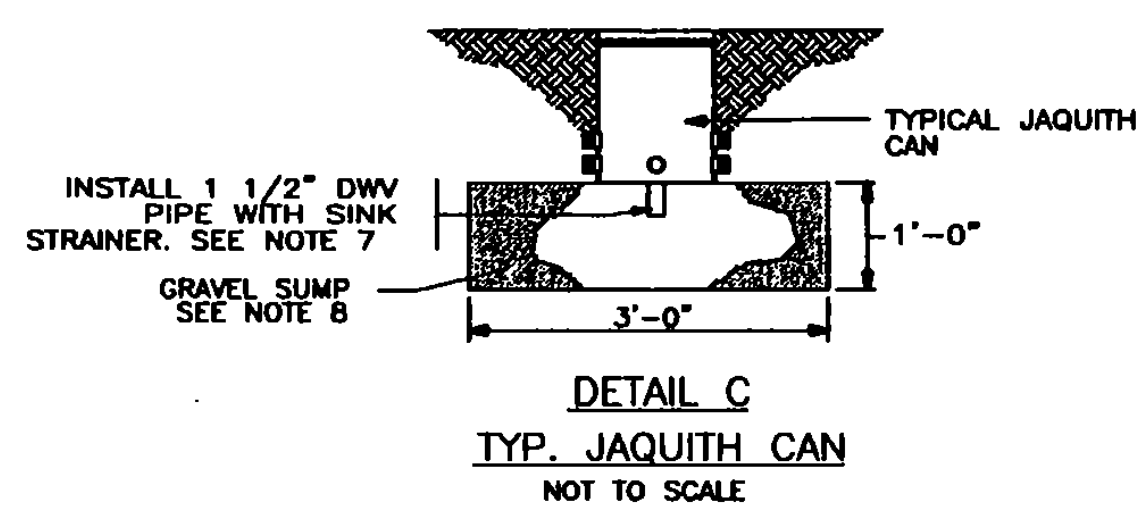
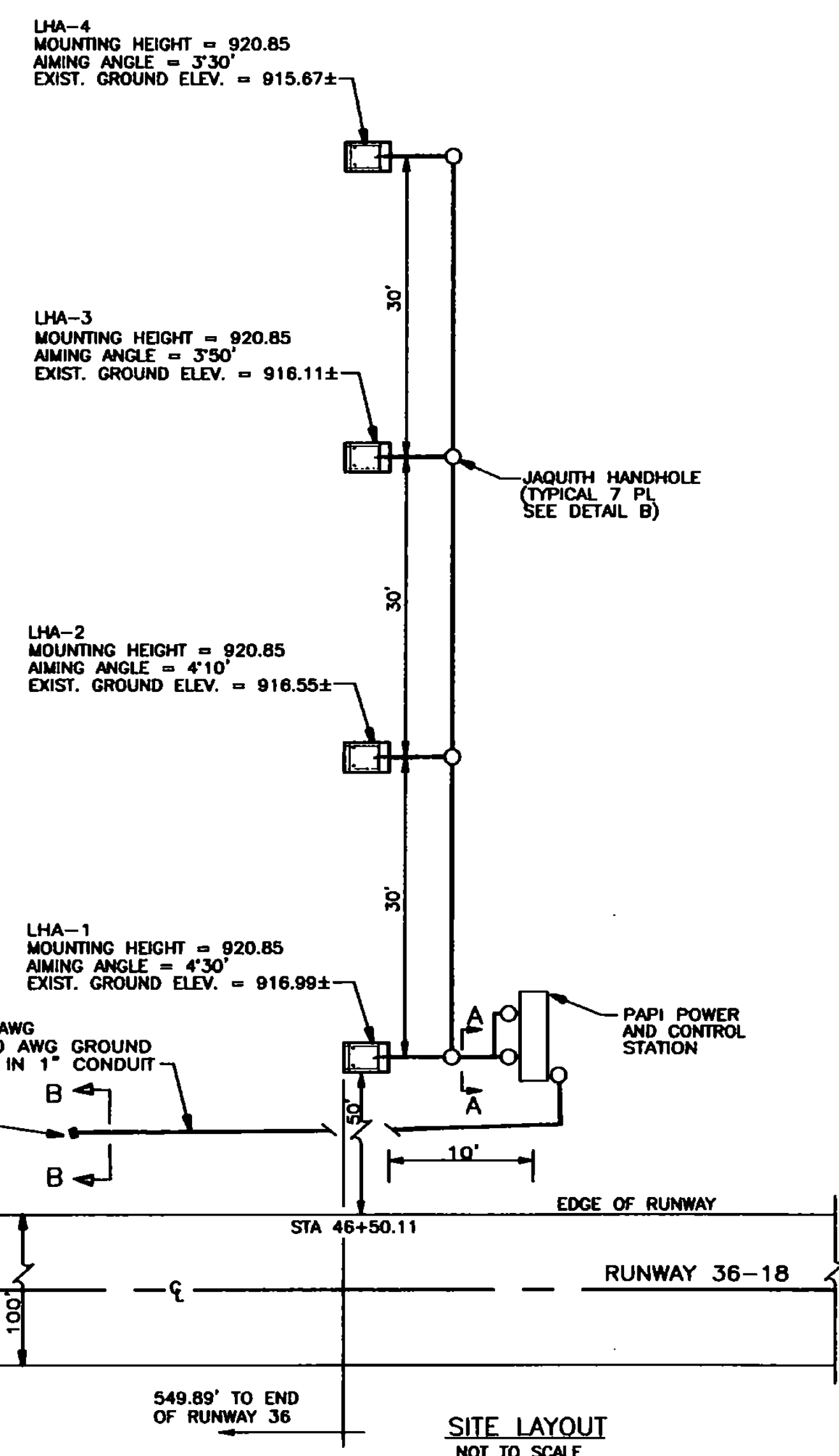
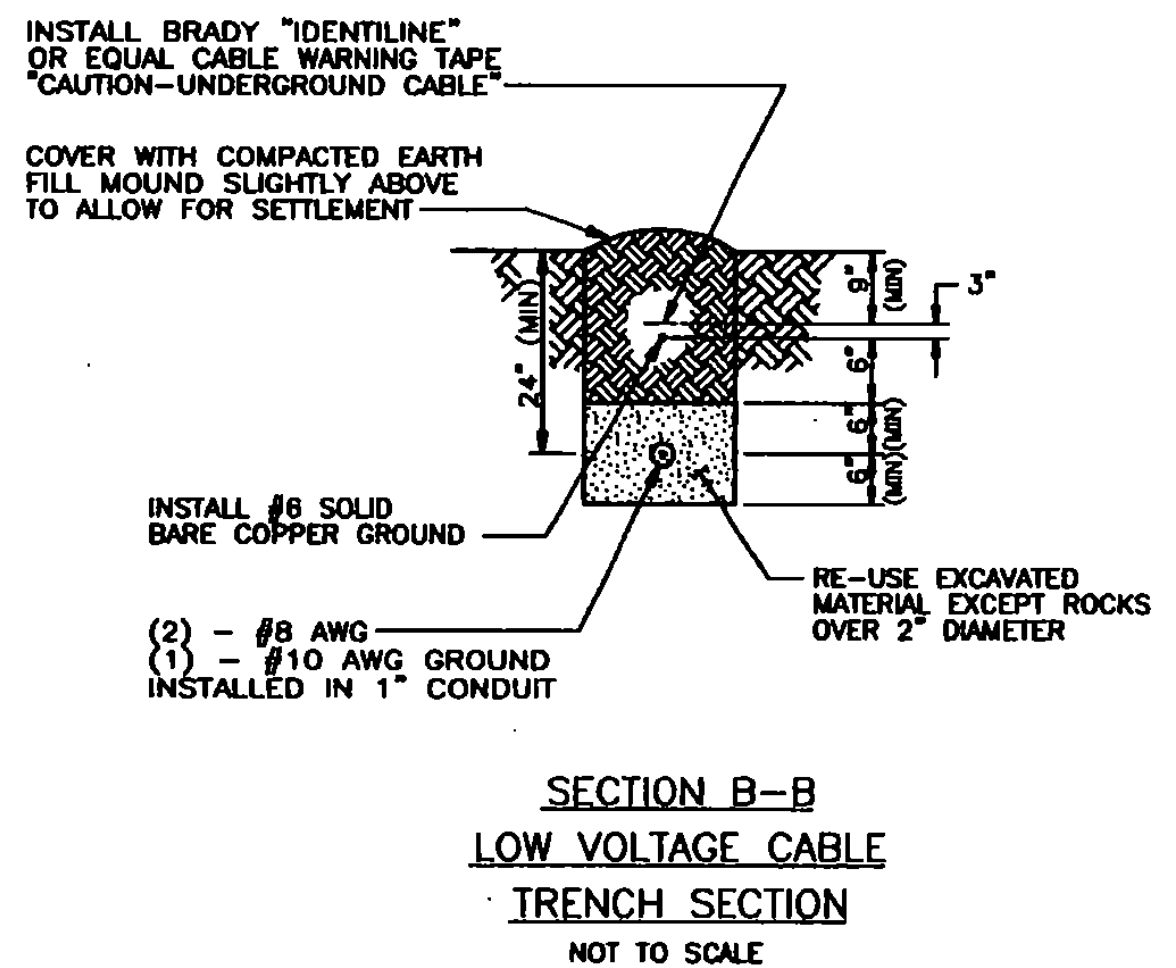

I:\15500F2\dwg\15500F20035.dwg F:\1 Feb 02 11:51:34 2001

NO.	DATE	REVISIONS	BY	CHK'D

DuBois & King
 engineering planning management development

VERMONT AGENCY OF TRANSPORTATION
 COVENTRY, VERMONT
 NEWPORT STATE AIRPORT
 RUNWAY 18-36 RECONSTRUCTION
 PAPI GENERAL INSTALLATION DETAILS

DESIGN BY JJP	DATE MAR. 2000
CHECKED BY JAA	PROJ. NO. N15500
PROJ. ENR. JAA	DRAW. NO. 1
SHEET PP-2	