

FOR GRADES & LAYOUT OF ROADS NORTH OF SITE WORK CONTRACT LIMIT LINE REFER TO DRAWINGS FOR RUTLAND STATE AIRPORT, DATED 8-15-83, PREPARED BY PINKHAM ENGINEERING ASSOC., INC., DRAWING 3 OF 44 FOR GRADES, AND DRAWING 15 OF 44 FOR ROAD LAYOUT.

GRANITE CURBING TO MATCH EXISTING

TYPE 'A' PAVER PLAN

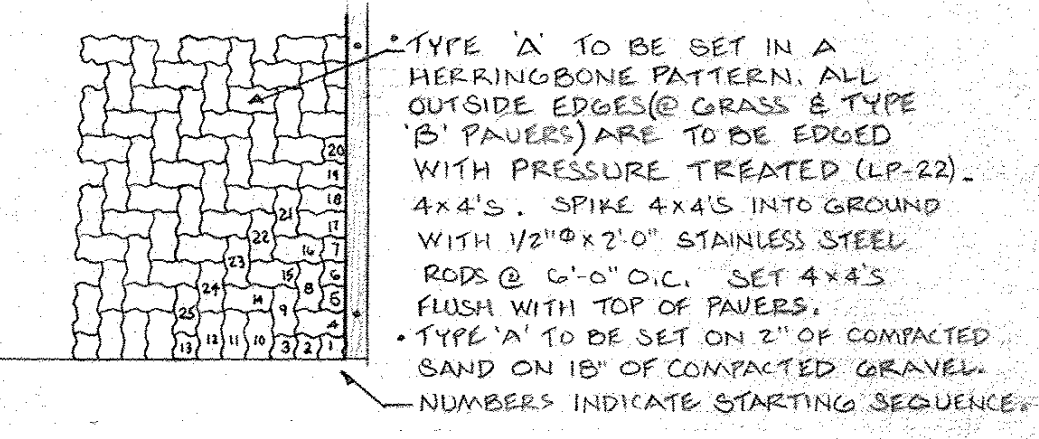

TYPE 'B' PAVER UNIT PLAN

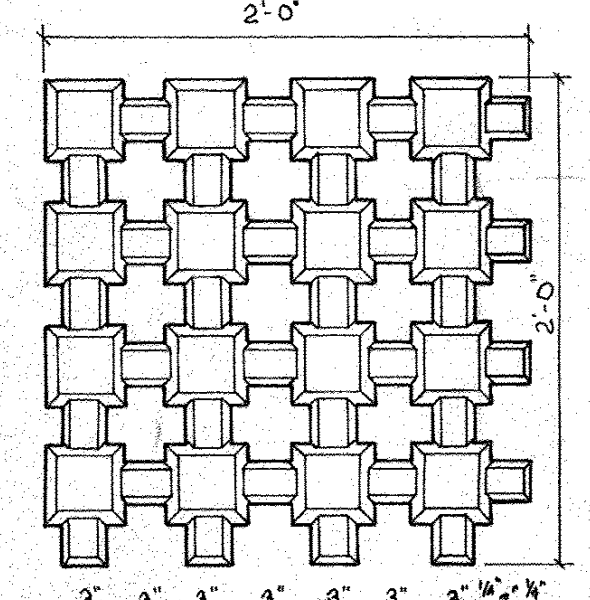

TYPE 'B' PAVER SECTION

TYPE 'B' TO BE SET ON 2" OF COMPACTED SAND ON 18" OF COMPACTED GRAVEL. FILL VOIDS IN PAVERS FLUSH WITH A MIXTURE OF TOPSOIL, LIME, FERTILIZER (10-20-20) AND PEAT MOSS. WATER WITH A MIST SPRAY TO SETTLE. ADD ADDITIONAL TOPSOIL MIX TO BRING THE TOPSOIL FLUSH WITH TOP OF THE PAVER. SEED AT SLIGHTLY LESS THAN NORMAL RATE, AND MULCH. WHEN GRASS IS 2 1/2" HIGH, CUT TO 1 3/4".

TYPE 'A' CONC. PAVER
SCALE: FULL SIZE

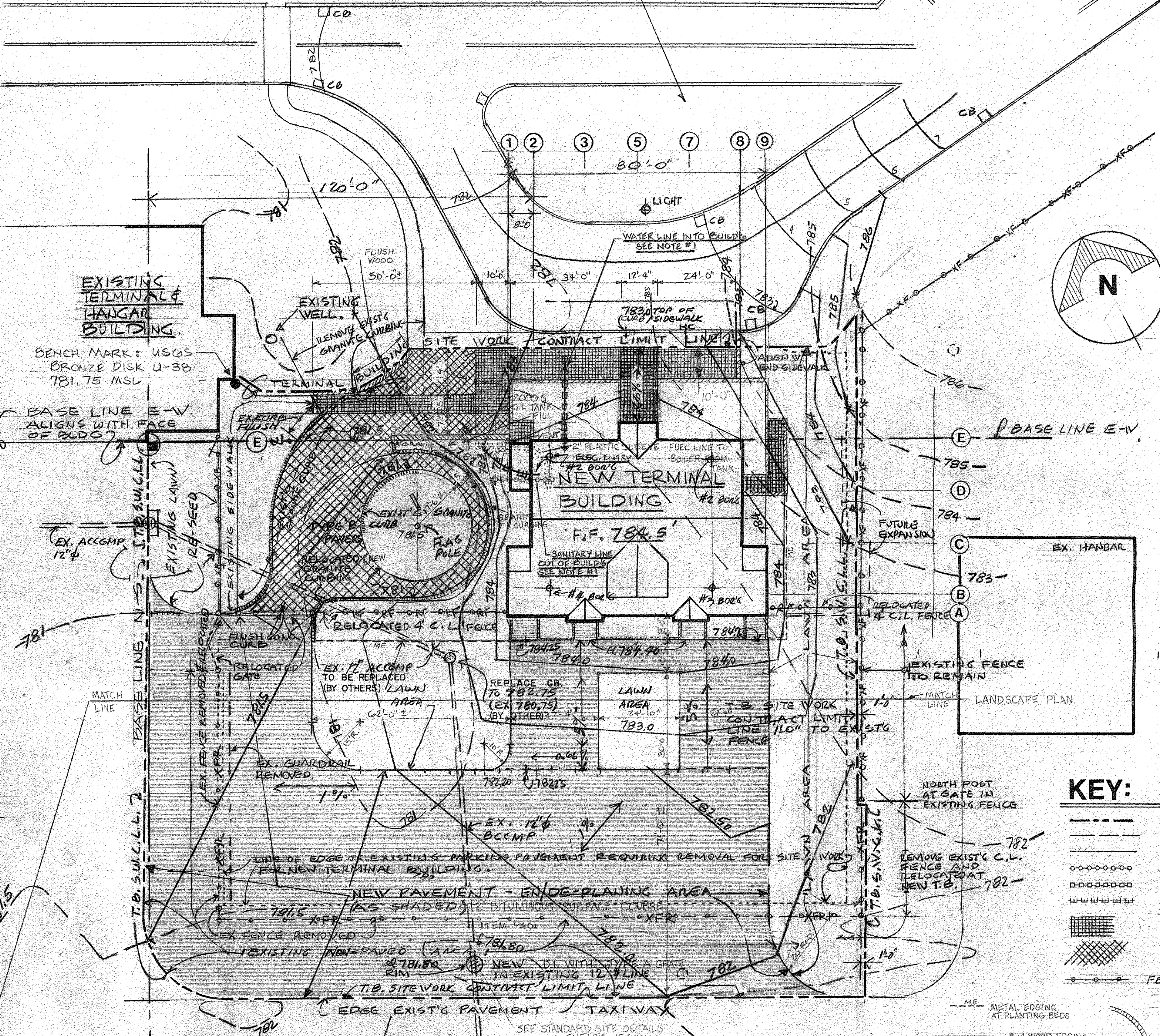

LANDSCAPE PLAN - Sc 1" = 20'0"

PLANTING LIST

NO.	PLANT	QUANTITY	INSTALLATION	REMARKS
1	P. PERIWINKLE	1650 PLANTS @ 9"Ø IN 5 BEDS	- VINCA MINOR	SIZE & REMARKS: C-CONTAINER B&B-BALL & BURLAP BARE ROOT
2	CJ - CREEPING JUNIPER	65 PLANTS @ 3"Ø - 2 BEDS	- JUNIPER HORIZONTALIS	6'-9" HT, 18"-24" SPREAD, 5 GAL. C
3	PJ - PROSTRATE COMMON JUNIPER	124 PLANTS - 3"Ø - 4 BEDS	- JUNIPER C. DEPRESSA	12'-15" HT, 24"-30" SP, 5 GAL. C
4	LB - LOW BUSH BLUEBERRY	120 PLANTS - 2'Ø IN 2 BEDS	- V. AUGUSTIFLORAE VIFIRM	6'-9" HT, 6" FIBER POT
5	CR - CAROLINA ROSE	56 PLANTS IN TWO BEDS	- ROSA CAROLINA	18"-24" HT, 2 GAL. C
6	VR - VIRGINIA ROSE	22 PLANTS IN 2 BEDS	- ROSA VIRGINIANA	24"-30" HT, 3 GAL. C
7	SB - SNOWBERRY	23 PLANTS @ 4'Ø - 11 ONE BED	- SYMPHORICARPUS ALBUS LAEVIS	3'-4" HT, 3 GAL. C/OR B&B

SITE LOCATION PLAN Sc 1" = 20'0"

BUILDING LOCATION, GRADES, SURFACE IMPROVEMENTS & DRAINAGE.
NOTE #1: SEE SITE UTILITIES PLAN (SU-1) FOR CONTINUATION OF BUILDING WATER SERVICE LINE & SANITARY LINE.
NOTE #2: DATA REGARDING EXISTING PARKING AREA, GRADES, & FENCES DEVELOPED FROM:
1) AS BUILT RUTLAND STATE AIRPORT PARKING LOT EXTENSION DRAWINGS DATED: 7-23-73, G.W. DAMICO, RESIDENT ENGINEER.
2) DRAWINGS PREPARED BY DUERESNE HENRY, RUTLAND STATE AIRPORT, CONTRACT 1 OF 2, PLAN & PROFILE SHEET 4 OF 13, AND GRADING, DRAINAGE DETAILS AND PROFILES SHEET 5 OF 13, DATED 9-12-77 & 9-8-77.

STATE OF VERMONT
DIVISION OF STATE BUILDINGS
AGENCY OF ADMINISTRATION
MONTPELIER, VERMONT

RUTLAND TERMINAL BUILDING AIR 23-2024
SITE PLAN & LANDSCAPING
RUTLAND STATE AIRPORT
CLARENDON, VERMONT

DATE: 6-8-84
SCALE: 1" = 20'-0"
DRAWN BY: PA
APPROVED BY: CA FOR DGB

REVISIONS: 6/29/84 S.A. MULHERN
DWG. NO. S-1
2 OF 19