

INDEX OF SHEETS

SHEET No	DESCRIPTION
1	TITLE PAGE
2	PLAN, PROFILE AND TYPICALS
3	PAINT DETAILS AND BEADING FORMULA
4	BLANK
5	QUANTITY SHEET
6	EARTHWORKS SHEET
7-9	CROSS SECTION SHEETS
10	STANDARD SHEET B-5 (2-4-71R)
11	STANDARD SHEET D-2 (10-30-85R)
12	STANDARD SHEET D-4 (10-30-85R)
13	STANDARD SHEET F-2 (2-1-71R)
13-A	STANDARD SHEET J-5 (12-19-72R)

STATE OF VERMONT
AGENCY OF TRANSPORTATION



PROPOSED IMPROVEMENT
BENNINGTON STATE AIRPORT
BENNINGTON, VERMONT

THIS PROJECT CONSISTS OF EXPANDING THE EXISTING AUTO PARKING LOT TO ACCOMMODATE APPROXIMATELY 36 ADDITIONAL SPACES. INCLUDED IN THIS PROJECT IS SUBSURFACE DRAINAGE, PAVEMENT MARKINGS, INADVERTANT ACCESS FENCING AND CONSTRUCTION OF A SHORT SECTION OF DRIVE ACCESS ONTO THE AIRPORT ACCESS ROAD. ALSO INCLUDED IN THIS PROJECT IS A 1 1/2" PAVEMENT OVERLAY SOUTH OF THE EXISTING "T" HANGARS, SOME LANDSCAPING AND LIGHTING.

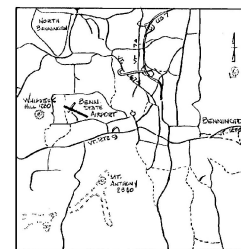

LOCATION MAP

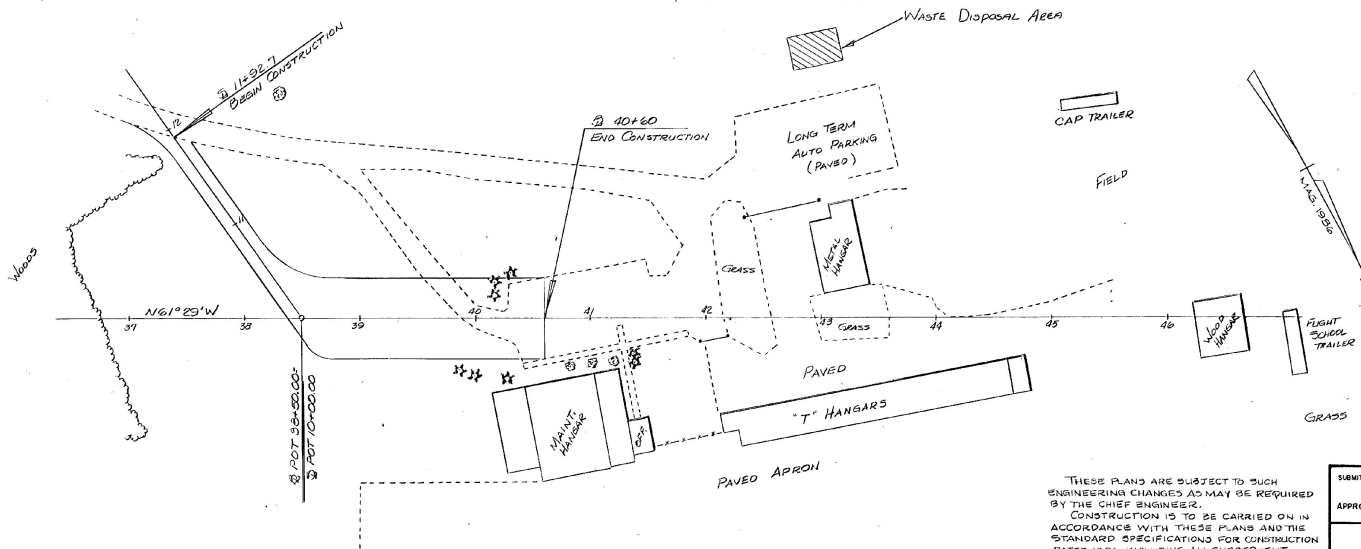
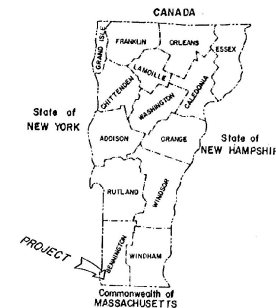

CONVENTIONAL SIGNS

COUNTY LINE	---
TOWN LINE	---
LIMITS OF ACCESS	---o---
POINT OF ACCESS	X
FENCE LINE	---x---
STONE WALL	-----
TRAVELED WAY	-----
GUARD RAIL	-----
RAILROAD	-----
SURVEY LINE	-----
CULVERT	-----
POWER POLE	o
TELEPHONE POLE	o
TREES	o x
CONTROL OF ACCESS	///
PROPERTY LINE	---
R.O.W TAKING LINE	---
SLOPE RIGHTS	o SR
TOP OF CUT	o
TOE OF SLOPE	o

DATUM

VERTICAL	_____
HORIZONTAL	_____

THESE PLANS ARE SUBJECT TO SUCH ENGINEERING CHANGES AS MAY BE REQUIRED BY THE CHIEF ENGINEER. CONSTRUCTION IS TO BE CARRIED ON IN ACCORDANCE WITH THESE PLANS AND THE STANDARD SPECIFICATIONS FOR CONSTRUCTION DATED 1956, INCLUDING ALL SUBSEQUENT REVISIONS AND SUCH REVISED SPECIFICATIONS AND SPECIAL PROVISIONS AS ARE INCORPORATED IN THESE PLANS.

SUBMITTED BY ORDER OF THE STATE TRANSPORTATION BOARD

APPROVED *Frank E. Miller* DATE *5-28-86*
DIRECTOR OF ENGINEERING AND CONSTRUCTION

DEPARTMENT OF TRANSPORTATION
FEDERAL HIGHWAY ADMINISTRATION

APPROVED _____ DATE _____
DIVISION ADMINISTRATOR

PROJECT AIR # 03-2051
BENNINGTON STATE AIRPORT
SHEET 1 OF 13 SHEETS

SEEDING FORMULA , ITEM 651.15
RURAL AREAS

% WT.	LBS./A.	NAME	PUR %	GERM %
3.33	2	CROWN VETCH	97	75
50.00	30	CREeping RED FESCUE	98	85
8.33	5	TIMOTHY	99	85
16.67	10	PERENNIAL RYE GRASS (VAR.PENNFINE)	95	85
8.34	5	ALFAFA (VAR. SARANAC)	99	85
8.33	5	BIRDSFOOT TREFoil (VAR.EMPIRE)	98	85
5.00	3	HIGHLAND BENT GRASS	92	85
100.00	80			

THE SEED MIXTURE SHALL NOT HAVE A WEED CONTENT EXCEEDING 0.40% BY WEIGHT AND SHALL BE FREE OF ALL NOXIOUS WEED SEED.

SEED- TO BE APPLIED PER SEEDING FORMULA AS DIRECTED BY THE ENGINEER.

FERTILIZER- FORMULA 10-20-10 TO BE USED WITH SEED, APPLIED AT THE RATE OF 500 LBS./ACRE. OR AS DIRECTED BY THE ENGINEER.

HAY MULCH- TO BE PLACED ON EARTH SLOPES AT THE RATE OF 2 TONS/ACRE. OR AS DIRECTED BY THE ENGINEER.

TOPSOIL- TO BE USED WITH SEED AS INDICATED ON THE PLANS, OR AS DIRECTED BY THE ENGINEER.

MARKER POSTS- TO BE PLACED AS DIRECTED BY THE ENGINEER.

SLOPE ROUNDING- ALL CUT SLOPES TO BE ROUNDED IN ACCORDANCE WITH STANDARD SHEET B-5.

PAY LIMITS OF SAND BORROW WHEN USED IN CONJUNCTION WITH UNDERDRAIN- SEE STANDARD SHEET D-2.

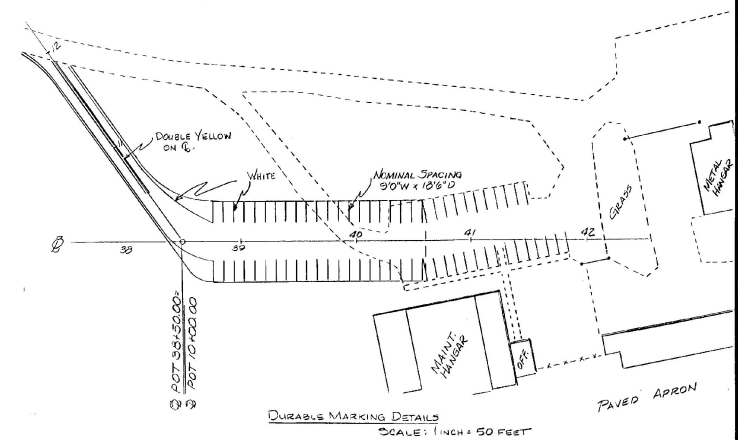

DATUM
VERTICAL _____
HORIZONTAL _____

SURVEYED BY R. MOREAU DATE 1986
DRAWN BY R. KERR DATE 1986
TRACED BY _____ DATE _____
BENNINGTON STATE AIRPORT
PROJ. AIR NO. 03-2051
SHEET 3 OF 13

DATE	BY	CHECKED	APPROVED

DATE	BY	CHECKED	APPROVED

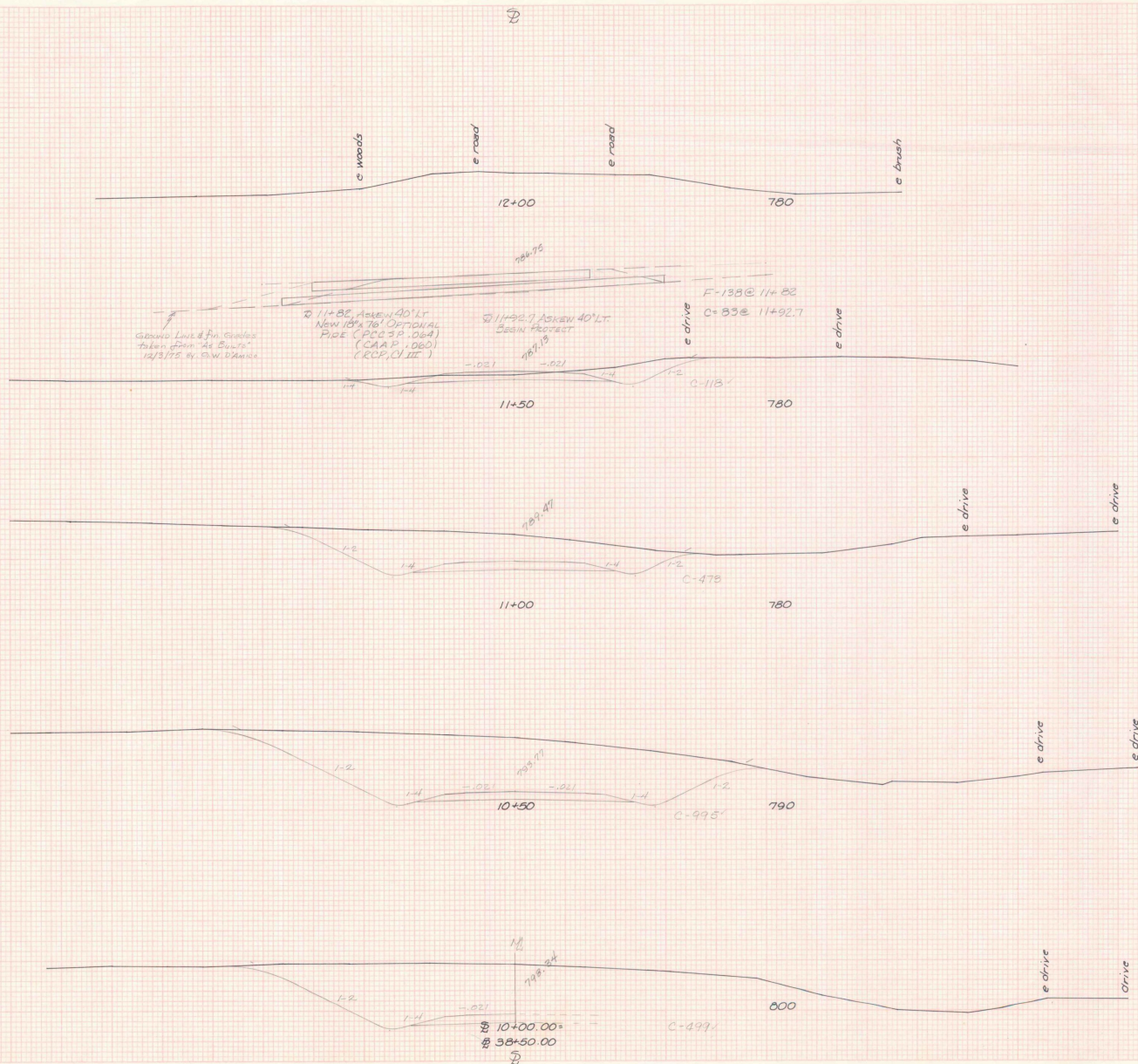

SCALE: 1 INCH = 10 FEET

DENNINGTON ST. AIRPORT
 AIR 03 - 2051
 PARKING LOT EXPANSION
 SECTIONS 10+0 - 12+0
 SURVEYED BY: R. MOREAU, 86
 DRAWN BY: R. KERR, 86

DATE	
BY	
CHECKED	
APPROVED	
REVISIONS	

DATE	
BY	
CHECKED	
APPROVED	
REVISIONS	

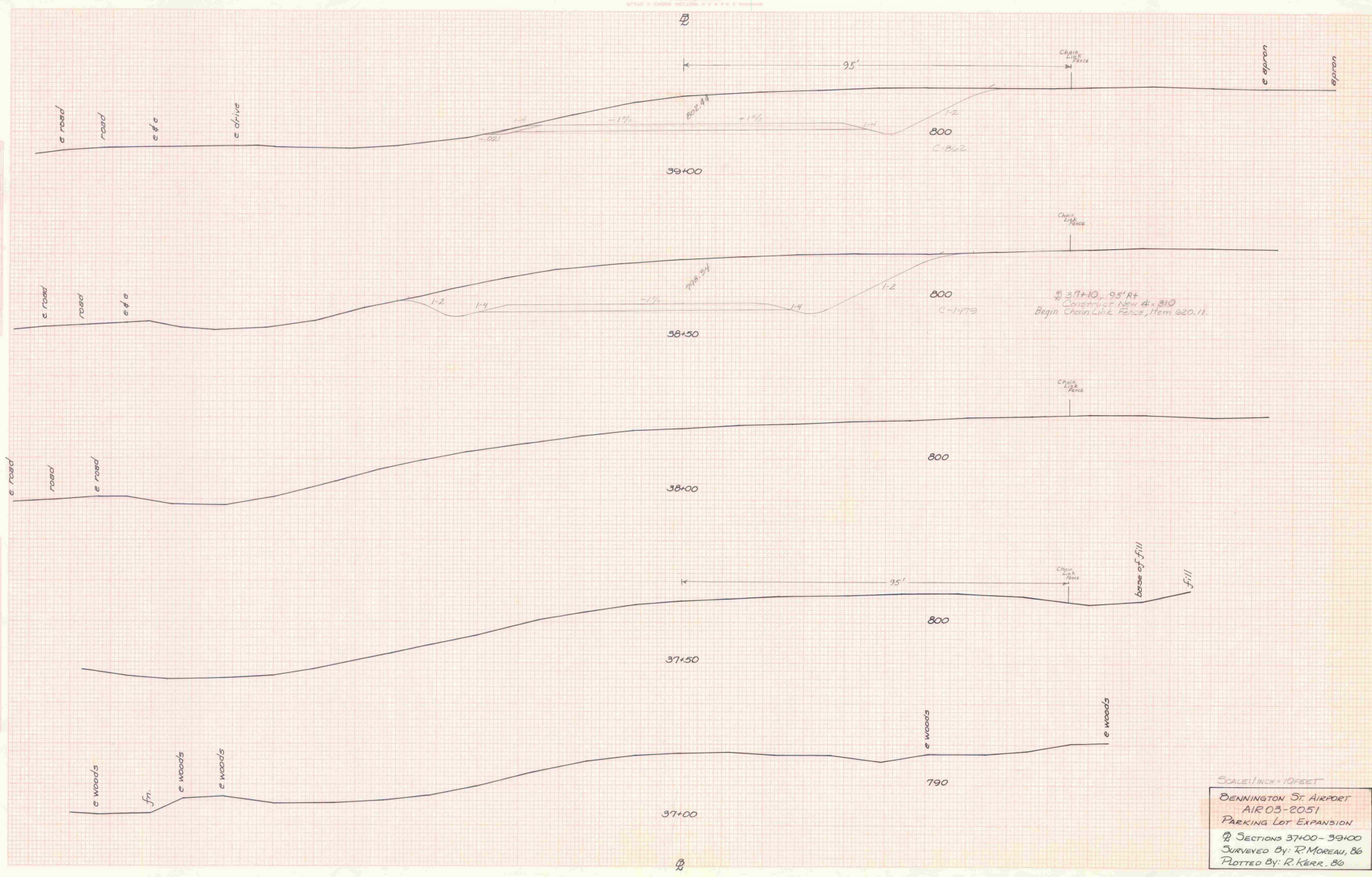

SCALE: 1" = 10 FEET
 BENNINGTON ST. AIRPORT
 AIR 03-2051
 PARKING LOT EXPANSION
 SECTIONS 37+00 - 39+00
 SURVEYED BY: R. MOREAU, 86
 PLOTTED BY: R. KERR, 80

DATE	
SCALE	
PROJECT	
DESIGNER	
CHECKER	
DATE	

DATE	
SCALE	
PROJECT	
DESIGNER	
CHECKER	
DATE	

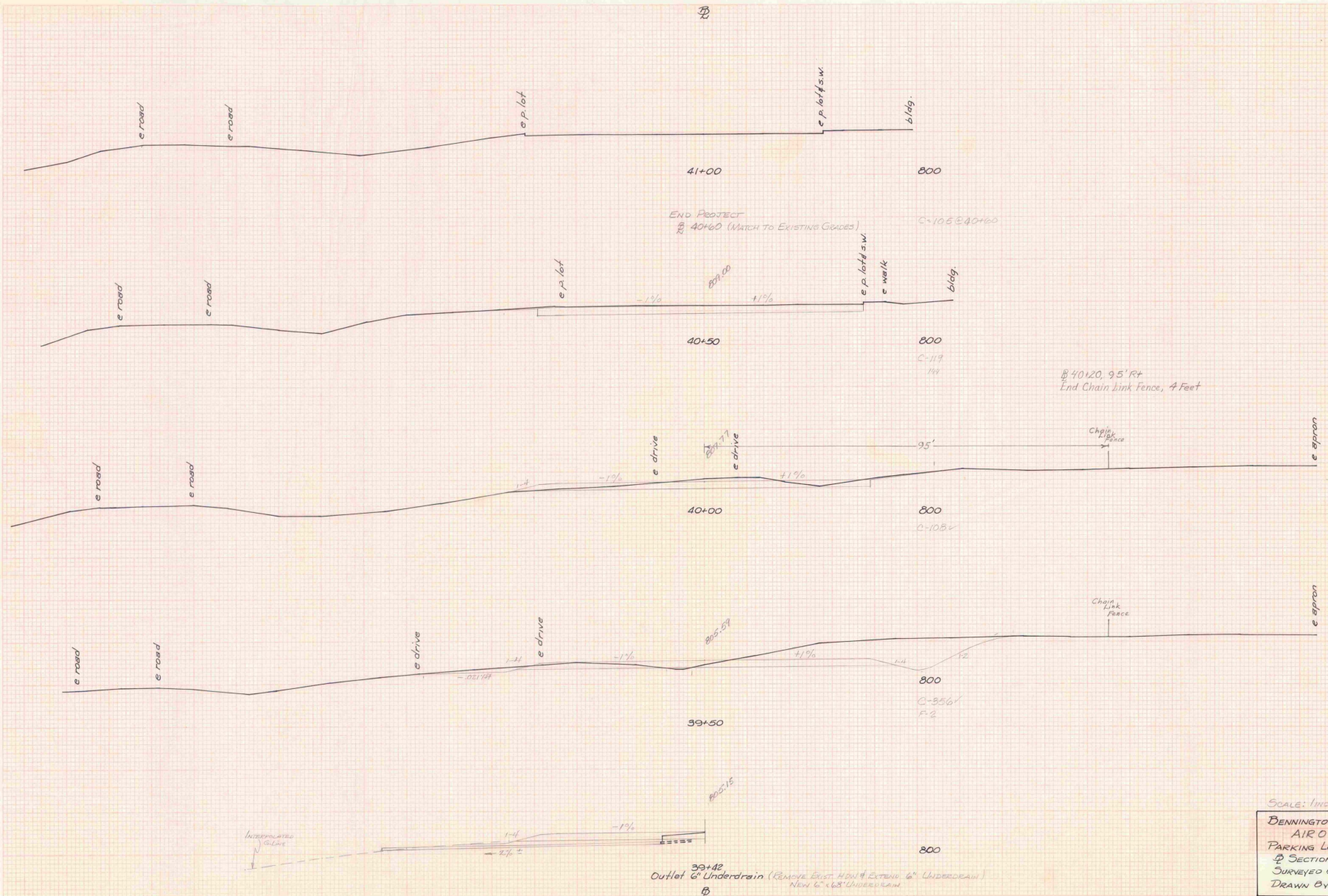

SCALE: 1 INCH = 10 FEET

DENNINGTON ST. AIRPORT
AIR 03-2051
PARKING LOT EXPANSION
SECTION 39+42-41+00
SURVEYED BY: R. MOSEAU, 86
DRAWN BY: R. KERR, 86