

NOTES:

1. ALL RUNWAY & THRESHOLD LIGHTS (MIRLS) AND TAXIWAY LIGHTS (MITLS) TO BE MEDIUM INTENSITY (8.8 AMP, 3 STEP).
2. EXISTING RUNWAY 1-19 MIRLS INCLUDING BASE AND CONDUIT (TO THE EXTENT POSSIBLE) TO BE REMOVED AND STORED ON THE AIRPORT AT THE DIRECTION OF THE ENGINEER.
3. ALL RUNWAY, THRESHOLD, & TAXIWAY LIGHTS AND CABLES TO BE PLACED 10' OFF EDGE OF PAVEMENT.
4. ALL RUNWAY AND TAXIWAY LIGHTS TO BE NUMBERED CONSECUTIVELY AS SHOWN.
5. MULTIPLE CONDUCTOR RUNS SHALL BE IN SAME CONDUIT AND/OR TRENCH WHERE POSSIBLE.
6. RUNWAY EDGE LIGHTS, TO BE L-801 (30W) QUARTZ (EITHER CLEAR LENS OR CLEAR/AMBER LENS). EXCEPT R45, R48 & R88 A TO BE IN PAVEMENT EDGE LIGHTS, L-880C (45W)
7. ALL TAXIWAY LIGHTS TO BE L-881T (30W) INCANDESCENT. (BLUE FILTER)
8. RUNWAY THRESHOLD LIGHTS TH1 THRU TH8 TO BE L-801 SE (120W) QUARTZ (RED/GREEN FILTER).
9. RUNWAY THRESHOLD LIGHTS TH38 THRU TH43 TO BE L-801 E (45W) QUARTZ (RED/GREEN FILTER)
10. CONCRETE BASES FOR EXISTING SIGNS TO BE REMOVED DURING CONSTRUCTION/ GRADING OF RUNWAY SAFETY AREAS.
11. R #118, #119, #147, #148 TO REMAIN IN PLACE.

NOTE:
 RUNWAY 1-19 WIRING CIRCUIT
 ...R12 - R13 - T015A - T015 - R14
 - DM #4 - R15...
 RUNWAY 13-31 WIRING CIRCUIT
 ...R118 - T04 - T03 - R119..."

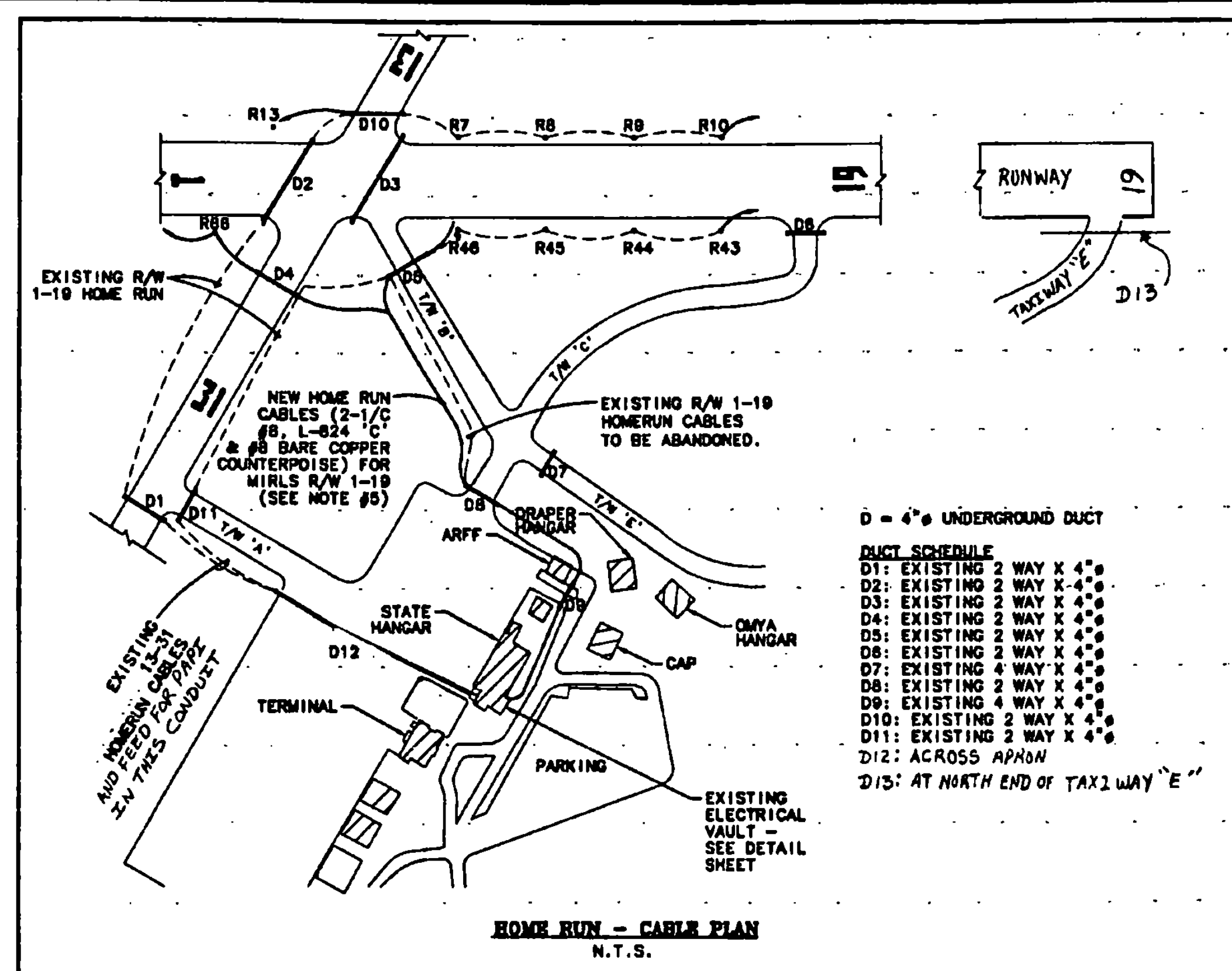

NOTE:
 RUNWAY 1-19 WIRING CIRCUIT
 ... R19 - R20 - DM #3 - R21 ..."

MATCH LINE SHEET 27

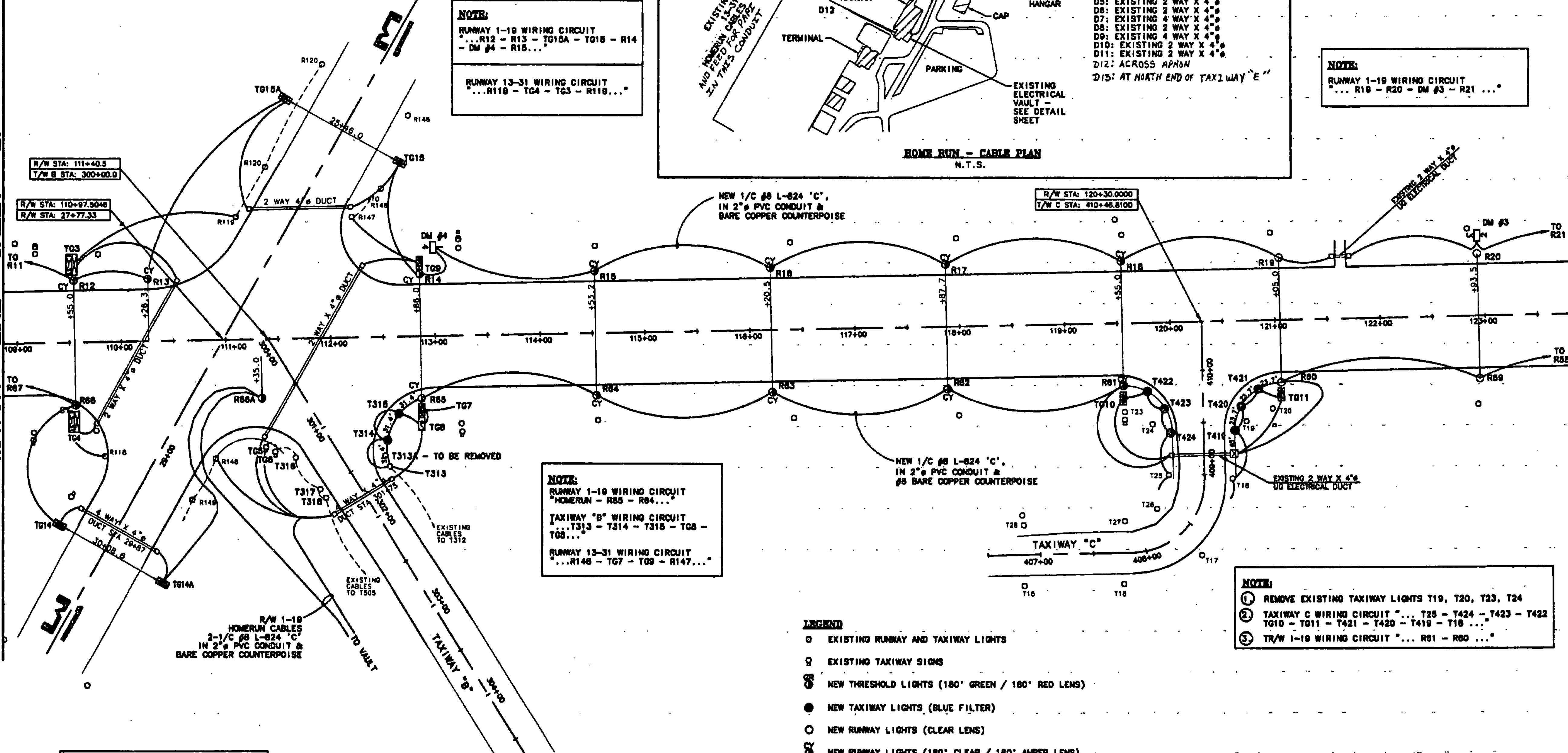

NOTE:
 RUNWAY 1-19 WIRING CIRCUIT
 "HOMERUN - R85 - R84..."
 TAXIWAY "B" WIRING CIRCUIT
 ...T313 - T314 - T318 - T08 - T08...
 RUNWAY 13-31 WIRING CIRCUIT
 ...R148 - T07 - T09 - R147..."

NOTE:
 ① REMOVE EXISTING TAXIWAY LIGHTS T19, T20, T23, T24
 ② TAXIWAY C WIRING CIRCUIT ... T25 - T424 - T423 - T422 T010 - T011 - T421 - T420 - T419 - T18 ...
 ③ TR/W 1-19 WIRING CIRCUIT ... R81 - R80 ..."

- LEGEND**
- EXISTING RUNWAY AND TAXIWAY LIGHTS
 - EXISTING TAXIWAY SIGNS
 - ⊕ NEW THRESHOLD LIGHTS (180° GREEN / 180° RED LENS)
 - NEW TAXIWAY LIGHTS (BLUE FILTER)
 - NEW RUNWAY LIGHTS (CLEAR LENS)
 - ⊕ NEW RUNWAY LIGHTS (180° CLEAR / 180° AMBER LENS)
 - ⊞ TO #1 RELOCATED TAXIWAY SIGN
 - ▬ UNDERGROUND CONCRETE ENCASED DUCT & MARKERS
 - ▲ 5/8" x 8" COPPERCLAD GROUND ROD
 - RELOCATED GOALS

NOTE:
 RUNWAY 1-19 WIRING CIRCUIT
 "VAULT R88A - T014A - T014 - R88..."

MATCH LINE SHEET 29

REV.	DATE	DESCRIPTION

Job No. 11V002148-0003
 Job No. 11V002148-0003

RUTLAND STATE AIRPORT
 CLARENDON, VERMONT

URS Greiner, Inc.
 3 MARCUS BOULEVARD
 ALBANY, NEW YORK

Designed by: C. D'Amico 2/97	Drawn by: B. McCulla 3/97	Checked by: C. D'Amico 5/97/07	Approved by: M. O'Connell 5/9/07
Scale: HOR. = 1" = 50' VERT. = NONE			
Date: 5/9/97			
Sheet 28 Of 63			
Sheet No. 28			