

SEE RFI #3 FOR EX. TOPSOIL THK.

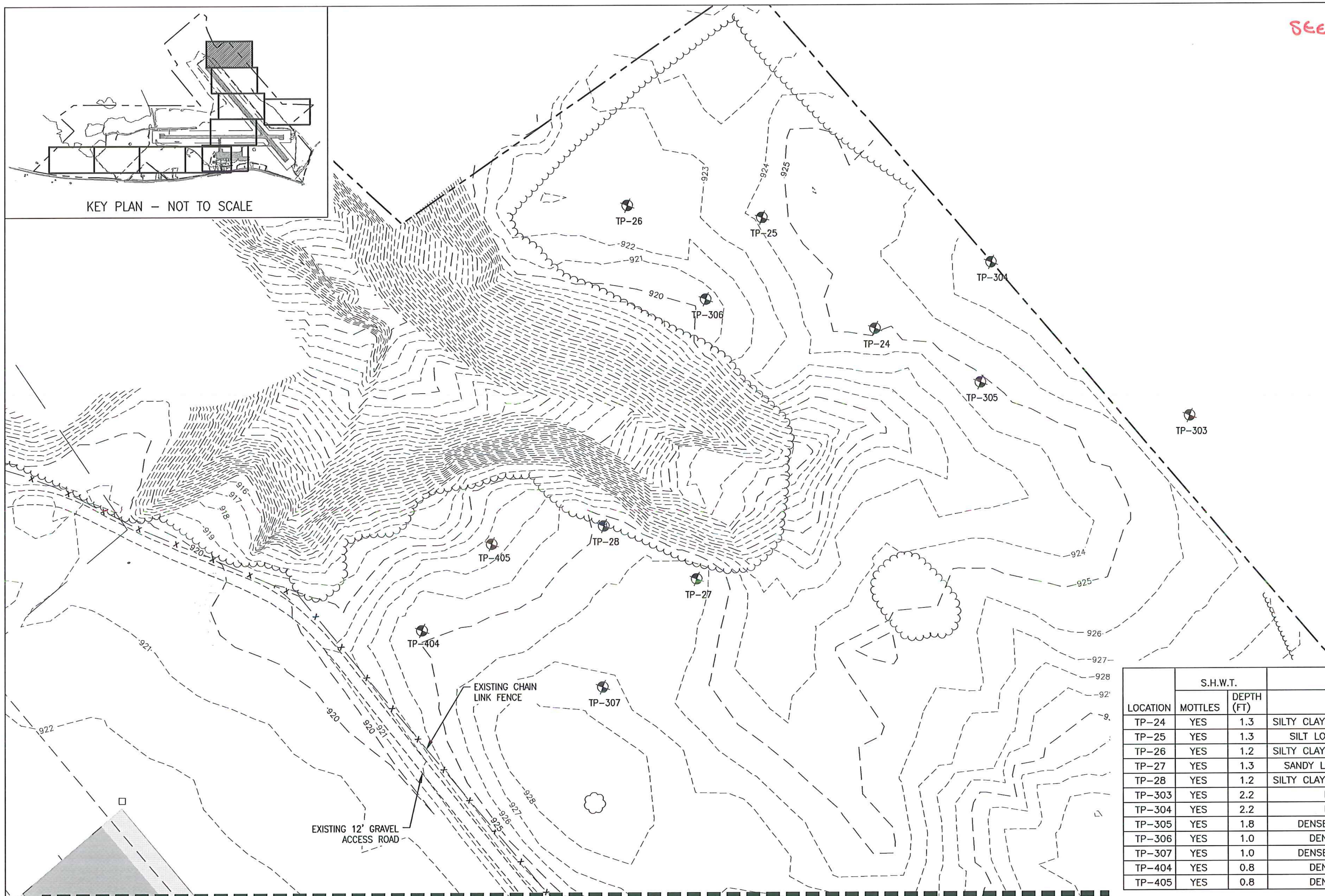

LOCATION	S.H.W.T.		IMPEDING SOILS (I)		BEDROCK	GROUND WATER	LIMITING CONDITION	
	MOTTLES	DEPTH (FT)	TYPE	DEPTH (FT)	DEPTH (FT)	DEPTH (FT)	DEPTH (FT)	TYPE
TP-24	YES	1.3	SILTY CLAY LOAM, FIRM MASSIVE	2.2	>4.5	>4.5	1.3	SWHT
TP-25	YES	1.3	SILT LOAM, FIRM MASSIVE	2.0	>7.0	>7.0	1.3	SWHT
TP-26	YES	1.2	SILTY CLAY LOAM, FIRM MASSIVE	1.8	>1.8	>1.8	1.2	SWHT
TP-27	YES	1.3	SANDY LOAM, FIRM MASSIVE	1.8	>7.0	>7.0	1.3	SWHT
TP-28	YES	1.2	SILTY CLAY LOAM, FIRM MASSIVE	1.8	>7.2	>7.2	1.2	SWHT
TP-303	YES	2.2	DENSE SILT	2.3	>3.5	>3.5	2.2	SWHT
TP-304	YES	2.2	DENSE SILT	2.3	>3.5	>3.5	2.2	SWHT
TP-305	YES	1.8	DENSE SILT AND CLAY	1.8	>4.0	>4.0	1.8	I, SWHT
TP-306	YES	1.0	DENSE SILT LOAM	1.2	>4.0	>4.0	1.0	SWHT
TP-307	YES	1.0	DENSE SILT AND CLAY	1.0	>2.0	>2.0	1.0	I, SWHT
TP-404	YES	0.8	DENSE SILT LOAM	0.8	>4.0	1.2	0.8	I, SWHT
TP-405	YES	0.8	DENSE SILT LOAM	0.8	>4.0	2.5	0.8	I, SWHT

SCHEDULE B - WASTEWATER SYSTEM - BID SET
VTRANS PROJECT #AV1157046-301
JUNE 2016

IT IS A VIOLATION OF LAW FOR ANY PERSON, UNLESS THEY ARE ACTING UNDER THE DIRECT DIRECTION OF A LICENSED PROFESSIONAL ENGINEER, ARCHITECT, LANDSCAPE ARCHITECT, OR LAND SURVEYOR, TO ALTER AN ITEM IN ANY WAY. IF AN ITEM BEARING THE STAMP OF A LICENSED PROFESSIONAL IS ALTERED, THE ALTERING ENGINEER, ARCHITECT, LANDSCAPE ARCHITECT, OR LAND SURVEYOR SHALL STAMP THE DOCUMENT AND INCLUDE THE NOTATION "ALTERED BY" FOLLOWED BY THEIR SIGNATURE, THE DATE OF SUCH ALTERATION, AND A SPECIFIC DESCRIPTION OF THE ALTERATION.

REV	DATE	DESCRIPTION	BY
5	5/3/15	COLD WEATHER MODIFICATIONS	BMB
4	4/29/15	PERMITTING MODIFICATIONS	SKI
3	1/30/15	WW SYSTEM MODIFICATIONS	BMB
2	8/5/14	ANR COMMENTS	TCB
1	4/18/14	ADD 400-SERIES TEST PITS	CH

NEWPORT STATE AIRPORT
COVENTRY, VERMONT
NEWPORT WASTEWATER

SITE 2 - TEST PIT LOCATION PLAN 2

SCALE: 1" = 50'	DESIGN: TCB	TP2-02 18 OF 36
DRAWN: TCB	PROJECT: 17958.01	
CHECKED: BLS	DATE: JUNE, 2014	

- LEGEND:**
- TEST PIT
 - EXISTING CONTOUR
 - PROPERTY LINE
 - WETLAND
 - TREE LINE

MATCHLINE SHEET TP2-01

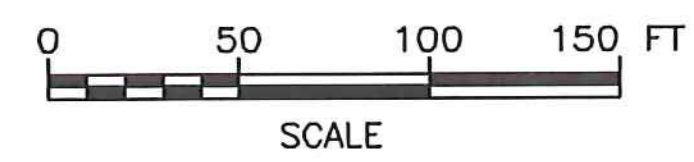

McFarland Johnson
53 REGIONAL DRIVE
CONCORD, NH 03301