

LEGEND:

- NEW SIGN
- A8 NEW TAXIWAY EDGE LIGHT WITH BLUE LENS
- EXISTING RUNWAY LIGHT
- R5-18 NEW RUNWAY LIGHT ON R5 CIRCUIT
- (R/G) HALF RED LENS/HALF GREEN LENS
- (W/W) WHITE LENS BOTH SIDES
- EHH CONCRETE ENCASED DUCT WITH ELECTRIC HAND HOLES
- 1TS ONE NEW 1/C, #8, 5KV, L-824 TYPE C CABLE, DIRECT BURIED IN TURF
- TN TAXIWAY NORTH CIRCUIT
- TS TAXIWAY SOUTH CIRCUIT
- TE TAXIWAY EAST CIRCUIT
- R17 RUNWAY 17-35 CIRCUIT
- R5 RUNWAY 5-23 CIRCUIT

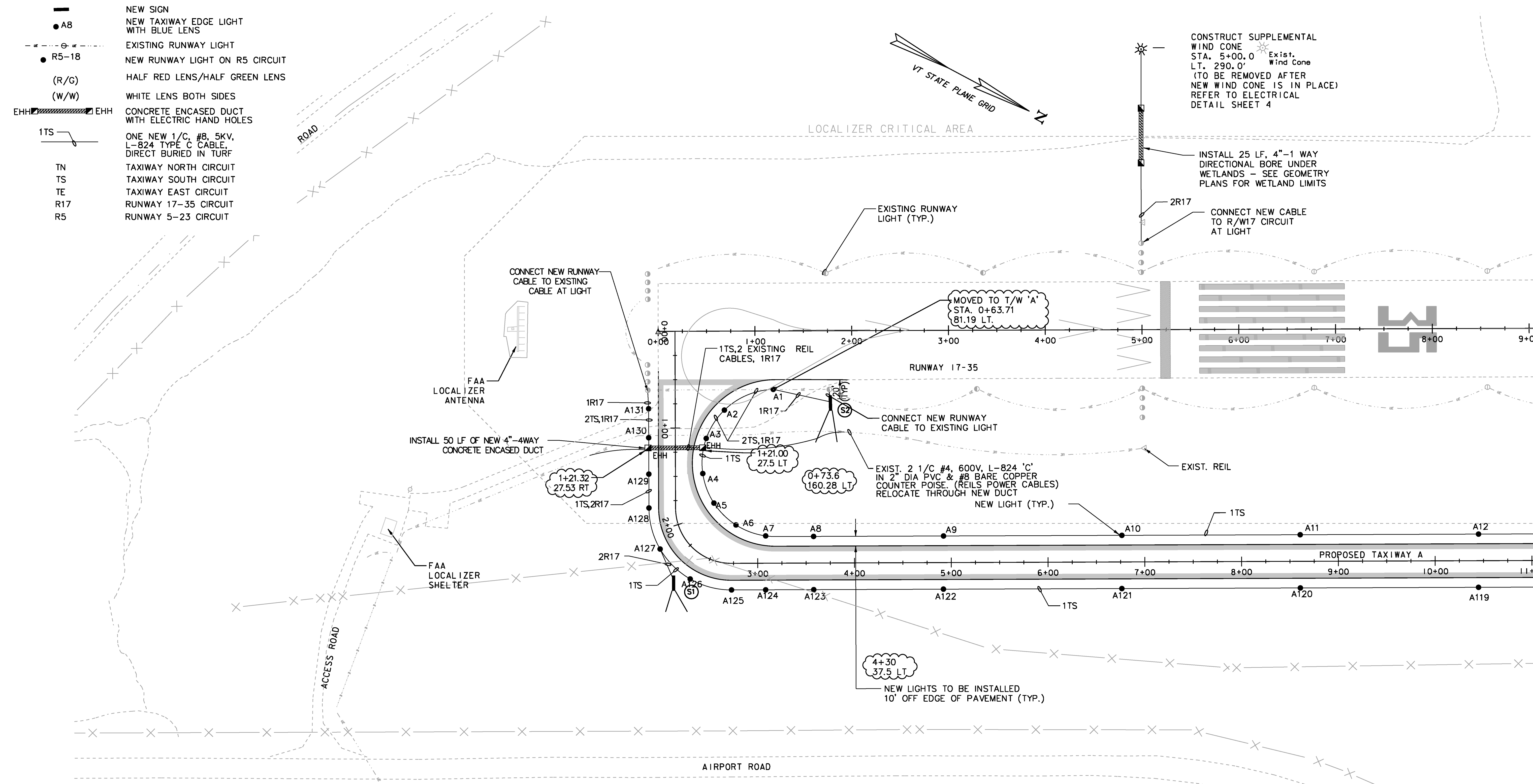

SEE ELECTRICAL SHT 2

LIGHT NO.	STATION	OFFSET	CIRCUIT	LIGHT NO.	STATION	OFFSET	CIRCUIT
A1	STA: 0+60.81	OFFSET: -101.72	TS	A120	STA: 6+61.20	OFFSET: 27.50	TS
A2	STA: 0+80.81	OFFSET: -50.79	TS	A121	STA: 6+76.22	OFFSET: 27.50	TS
A3	STA: 1+10.34	OFFSET: -32.13	TS	A122	STA: 4+91.37	OFFSET: 27.50	TS
A4	STA: 1+37.18	OFFSET: -28.25	TS	A123	STA: 6+57.16	OFFSET: 27.50	TS
A5	STA: 1+69.76	OFFSET: -39.64	TS	A124	STA: 6+07.15	OFFSET: 27.50	TS
A6	STA: 2+89.22	OFFSET: -39.65	TS	A125	STA: 2+69.83	OFFSET: 27.50	TS
A7	STA: 3+09.83	OFFSET: -28.24	TS	A126	STA: 2+11.37	OFFSET: 27.50	TS
A8	STA: 3+38.10	OFFSET: -27.50	TS	A127	STA: 2+11.39	OFFSET: 27.50	TS
A9	STA: 4+91.30	OFFSET: -27.50	TS	A128	STA: 1+84.50	OFFSET: 27.50	TS
A10	STA: 6+76.39	OFFSET: -27.50	TS	A129	STA: 1+48.22	OFFSET: 27.50	TS
A11	STA: 6+58.84	OFFSET: -27.50	TS	A130	STA: 1+10.32	OFFSET: 27.50	TS
A12	STA: 10+99.24	OFFSET: -27.50	TS	A131	STA: 0+30.20	OFFSET: 27.50	TS
A119	STA: 10+44.47	OFFSET: 27.50	TS				

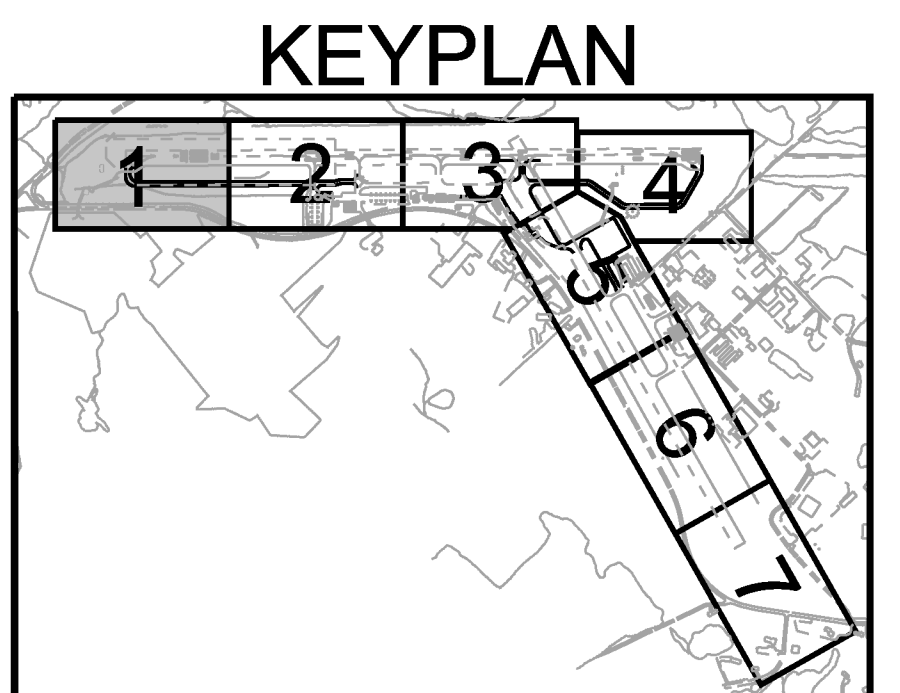

NOTE:

1. PROPOSED GEOMETRY SHOWN FOR GUIDANCE ONLY. SEE GEOMETRY SHEETS 1-7.
2. ALL CABLES ARE DIRECT BURIED UNLESS OTHERWISE NOTED.

0 50 100
SCALE IN FEET

Hoyle, Tanner & Associates, Inc.

150 Dow Street
Manchester, NH 03101-1227
Tel 603-669-5555
Fax 603-669-4168
Web Page: www.hoyletanner.com
Hoyle Tanner & Associates © 2008

PROJECT NAME: E. F. KNAPP STATE AIRPORT
A.I.P. 3-50-0001-011-2009
PROJECT NUMBER: BERLIN AIR 04-3216

FILE NAME: z05h378sht_e1.dgn
PROJECT LEADER: S. FORTNEY
DESIGNED BY: S. BOUCHARD
ELECTRICAL SHT 1

PLOT DATE: 11/22/2011
DRAWN BY: D. STANDISH
CHECKED BY: J. DOWNAR
SHEET 97 OF 173