

CURVE C6:	CURVE C7:	CURVE C8:	CURVE C9:	CURVE C10:	CURVE C11:	CURVE C12:
PI= 42+21.63 PC= 41+97.98 PT= 42+43.80 DELTA= 35°00'00" R= 75.00 T= 23.65 L= 45.81	PI= 45+86.84 PC= 45+63.19 PT= 46+09.01 DELTA= 35°00'00" R= 75.00 T= 23.65 L= 45.81	PI= 50+78.33 PC= 50+35.04 PT= 51+13.56 DELTA= 59°58'54" R= 75.00 T= 43.29 L= 78.52	PI= 54+08.47 PC= 53+88.37 PT= 54+27.65 DELTA= 30°00'11" R= 75.00 T= 20.10 L= 39.27	PI= 0+66.09 PC= 0+54.33 PT= 0+77.15 DELTA= 34°24'35" R= 38.00 T= 11.77 L= 22.82	PI= 1+91.73 PC= 1+37.33 PT= 2+30.51 DELTA= 74°09'02" R= 72.00 T= 54.40 L= 93.18	PI= 3+27.51 PC= 2+89.56 PT= 3+59.41 DELTA= 55°35'16" R= 72.00 T= 37.95 L= 69.85

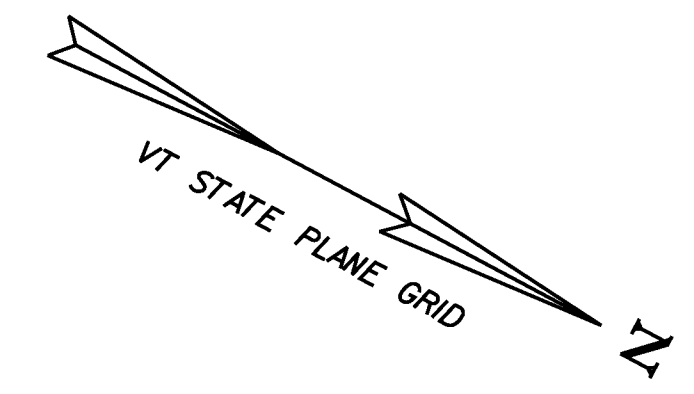

SEE GEOMETRY SHT 3

SEE GEOMETRY SHT 5

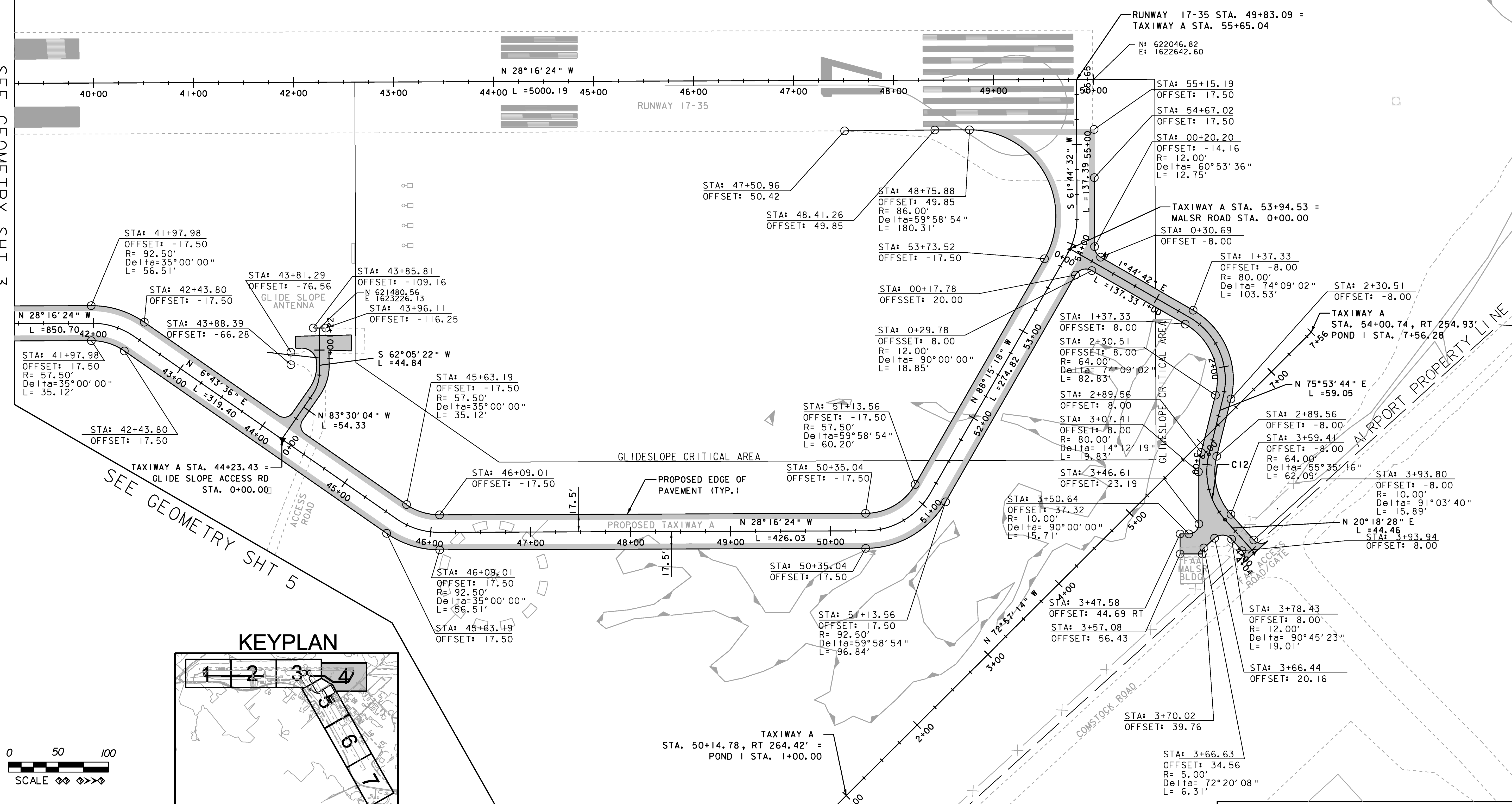
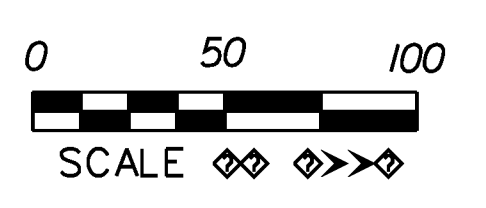
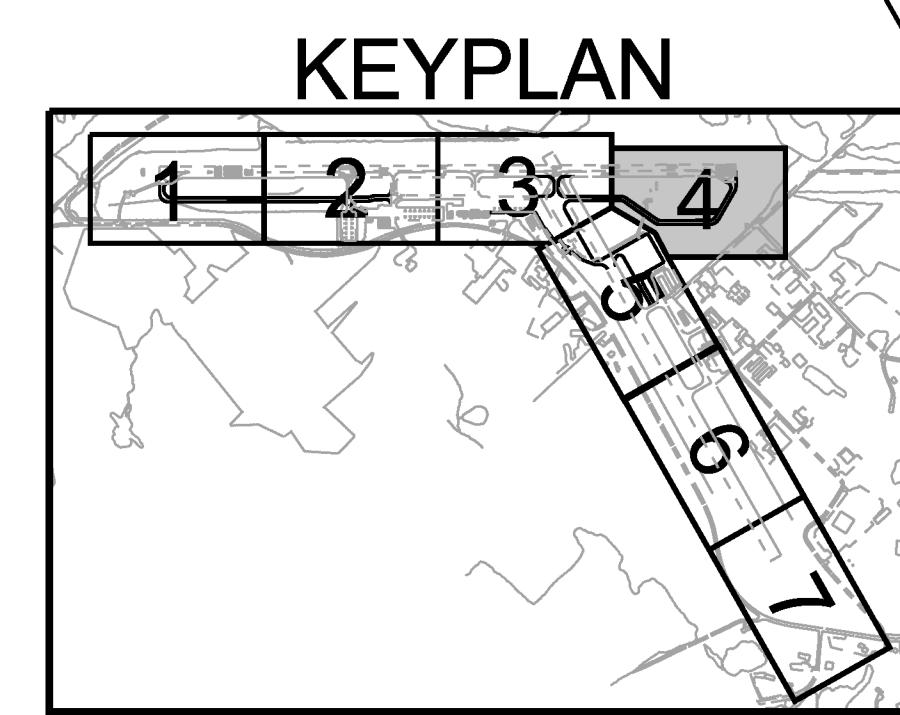

Hoyle, Tanner & Associates, Inc.
 150 Dow Street
 Manchester, NH 03101-1227
 Tel 603-669-5555
 Fax 603-669-4168
 Web Page: www.hoyletanner.com
 Hoyle, Tanner & Associates © 2008

PROJECT NAME: E. F. KNAPP STATE AIRPORT
 A.I.P. 3-50-0001-011-2009
 PROJECT NUMBER: BERLIN AIR 04-3216
 FILE NAME: 302803_sht_geom.dgn
 PROJECT LEADER: S. FORTNEY
 DESIGNED BY: S. BOUCHARD
 GEOMETRY SHT 4
 PLOT DATE: 11/22/2011
 DRAWN BY: D. STANDISH
 CHECKED BY: J. DOWNAR
 SHEET 69 OF 173