

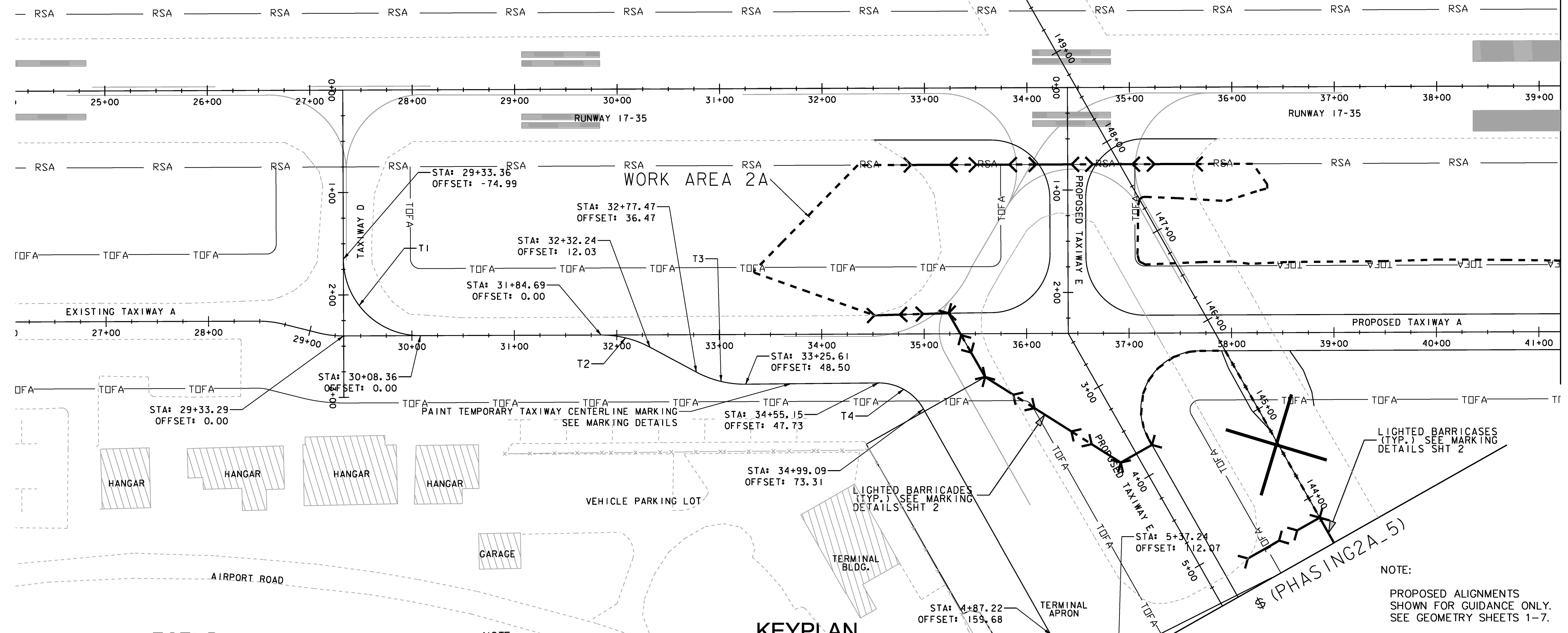

MARKING DATA

T1 R = 75.0' L = 117.80' Tan = 75.0' Delta = 89°59'30"	T3 R = 100.0' L = 50.15' Tan = 25.6' Delta = 28°44'03"	T5 R = 50.0' L = 76.20' Tan = 47.7' Delta = 87°20'12"
T2 R = 100.0' L = 49.50' Tan = 25.3' Delta = 28°23'30"	T4 R = 50.0' L = 53.30' Tan = 29.5' Delta = 61°07'07"	

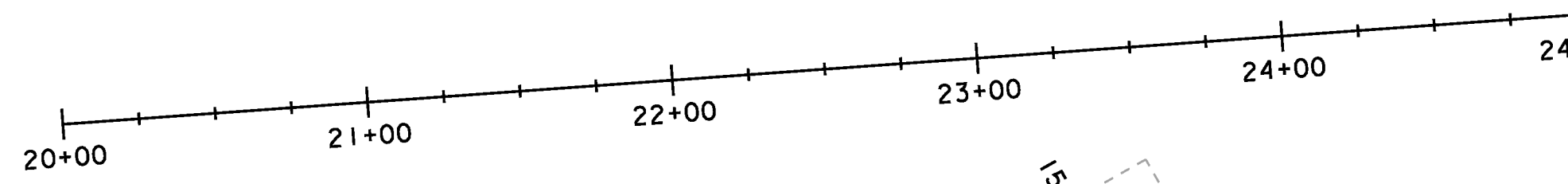
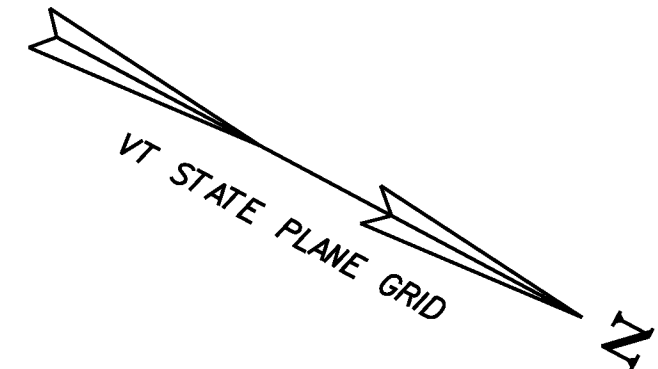

\$ (PHASING2A-4)

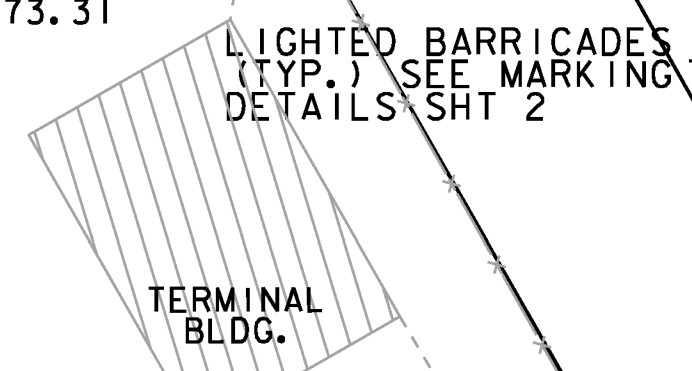
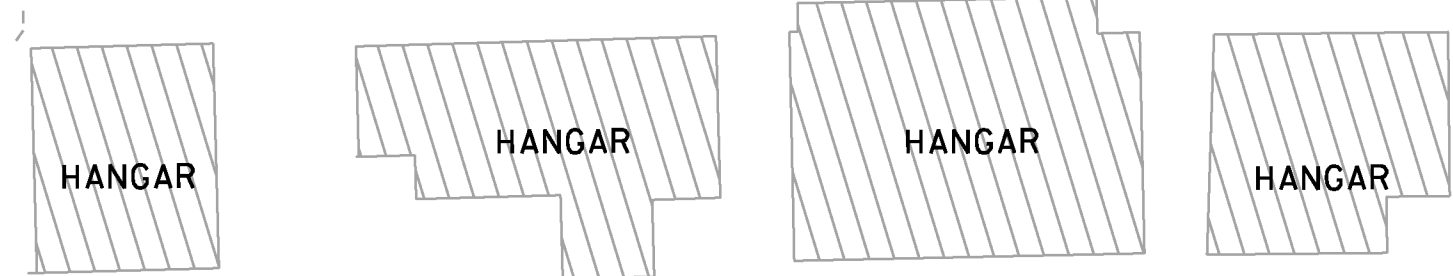

LEGEND

- | | | | |
|--|----------------------------------|--|------------------------------|
| | WORK AREA | | PROPOSED CB |
| | PROPOSED PAVEMENT | | PROPOSED DRAIN PIPE |
| | EXISTING WETLANDS SYMBOL | | PROPOSED UNDERDRAIN CLEANOUT |
| | EXISTING DRAIN PIPE | | PROPOSED UNDERDRAIN |
| | EXISTING UNDERDRAIN | | SLOPE LIMITS |
| | EXISTING CB | | LIGHTED BARRICADE |
| | STABILIZED CONSTRUCTION ENTRANCE | | RIP RAP |

NOTE: PROPOSED ALIGNMENTS SHOWN FOR GUIDANCE ONLY. SEE GEOMETRY SHEETS 1-7.

WORK AREA 2B SAFETY PLAN SHEETS 1, 2, 4, 5, 6 AND 7 NOT USED

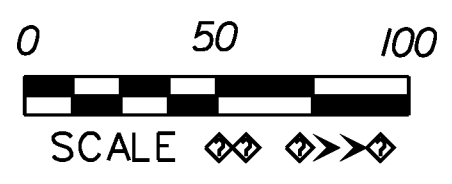

KEYPLAN

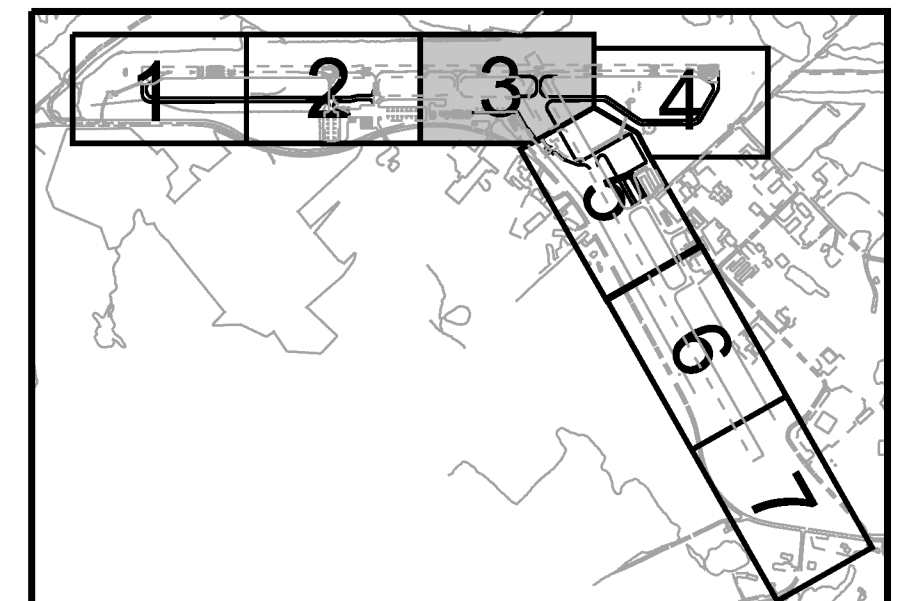

NOTE:
PROPOSED ALIGNMENTS SHOWN FOR GUIDANCE ONLY. SEE GEOMETRY SHEETS 1-7.
WORK AREA 2A SAFETY PLAN SHEETS 1, 2, 6 AND 7 NOT USED

WORK AREA 2A

PROJECT NAME: E. F. KNAPP STATE AIRPORT
A.I.P. 3-50-0001-011-2009
PROJECT NUMBER: BERLIN AIR 04-3216
FILE NAME: z05h378sh_t.ph.dgn
PROJECT LEADER: S. FORTNEY
DESIGNED BY: S. BOUCHARD
WORK AREA 2A SHT 3
PLOT DATE: 11/22/2011
DRAWN BY: D. STANDISH
CHECKED BY: J. DOWNAR
SHEET 14 OF 173

Hoyle, Tanner & Associates, Inc.
150 Dow Street
Manchester, NH 03101-1227
Tel 603-669-5555
Fax 603-669-4168
Web Page: www.hoyletanner.com
Hoyle, Tanner & Associates © 2008