

PHASING 1\_1

PHASING 1\_3

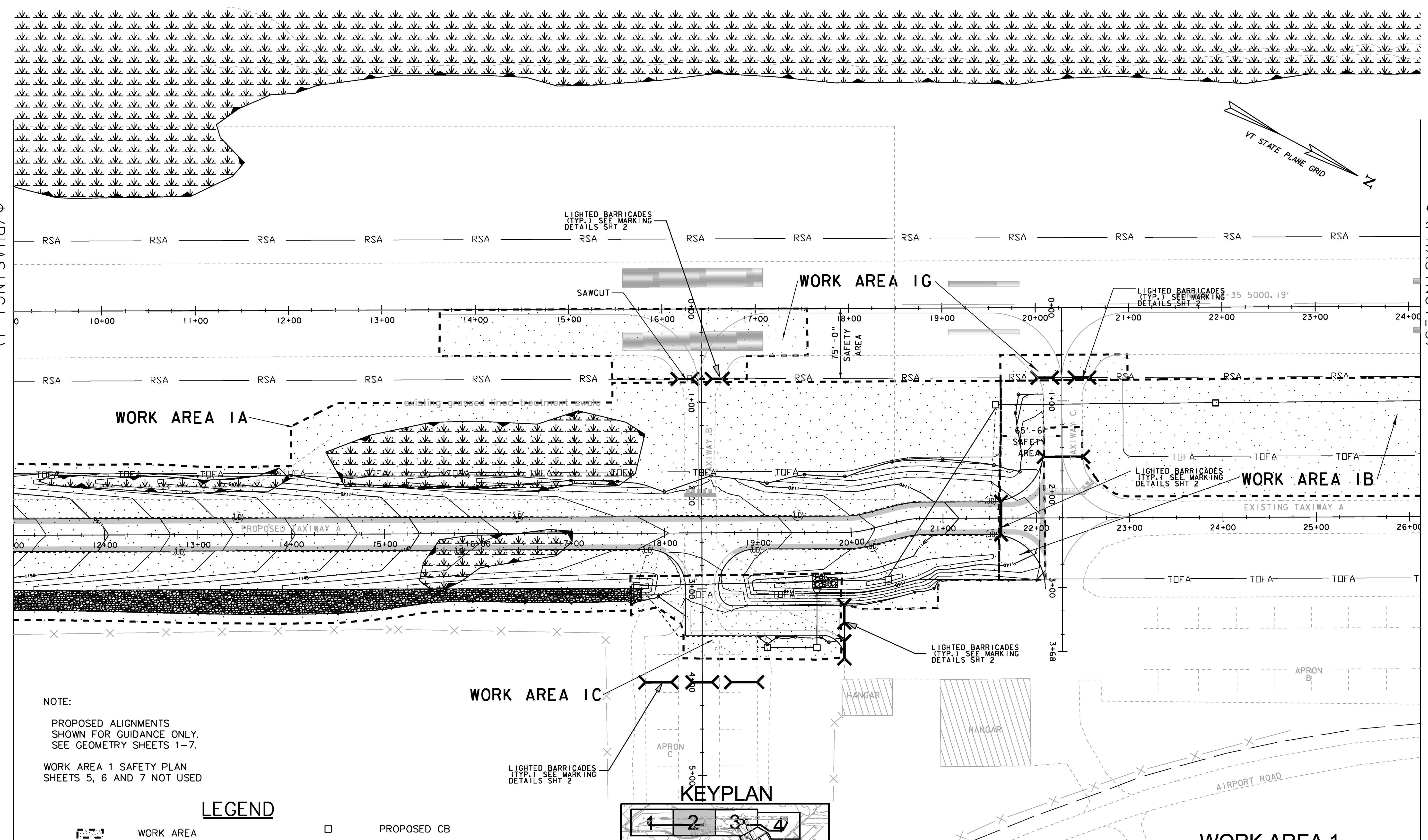

NOTE:  
 PROPOSED ALIGNMENTS  
 SHOWN FOR GUIDANCE ONLY.  
 SEE GEOMETRY SHEETS 1-7.  
 WORK AREA 1 SAFETY PLAN  
 SHEETS 5, 6 AND 7 NOT USED

**LEGEND**

- |  |                                  |  |                              |
|--|----------------------------------|--|------------------------------|
|  | WORK AREA                        |  | PROPOSED CB                  |
|  | PROPOSED PAVEMENT                |  | PROPOSED DRAIN PIPE          |
|  | EXISTING WETLANDS SYMBOL         |  | PROPOSED UNDERDRAIN CLEANOUT |
|  | EXISTING DRAIN PIPE              |  | PROPOSED UNDERDRAIN          |
|  | EXISTING UNDERDRAIN              |  | SLOPE LIMITS                 |
|  | EXISTING CB                      |  | LIGHTED BARRICADE            |
|  | STABILIZED CONSTRUCTION ENTRANCE |  | RIP RAP                      |

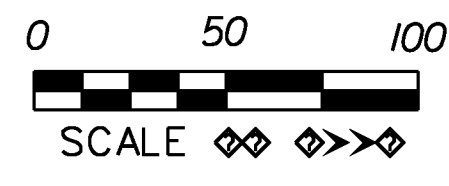
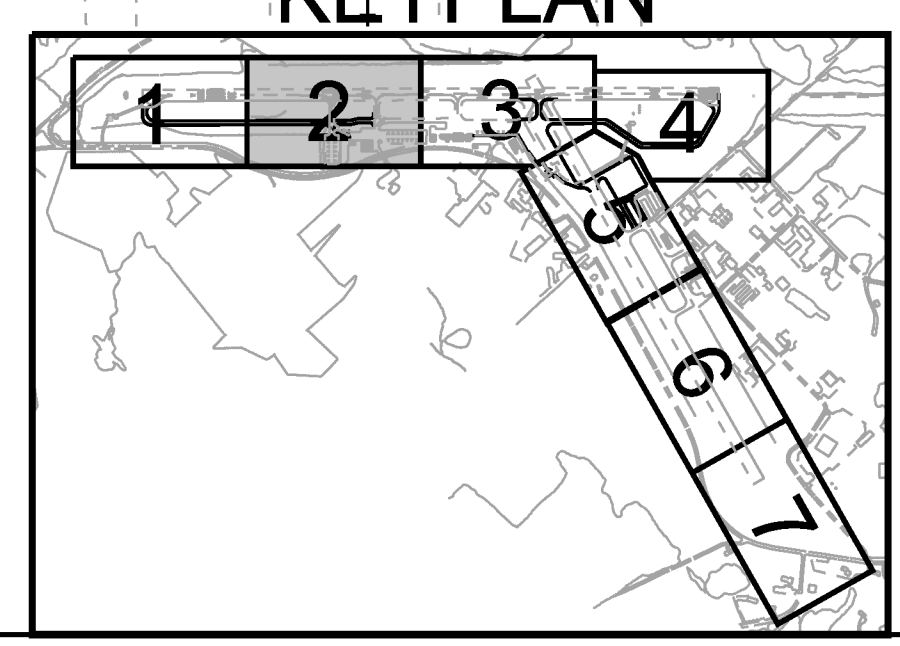

**Hoyle, Tanner & Associates, Inc.**  
 150 Dow Street  
 Manchester, NH 03101-1227  
 Tel 603-669-5555  
 Fax 603-669-4168  
 Web Page: [www.hoyletanner.com](http://www.hoyletanner.com)  
Hoyle Tanner & Associates © 2008

**WORK AREA 1**

PROJECT NAME: E. F. KNAPP STATE AIRPORT  
 A.I.P. 3-50-0001-011-2009  
 PROJECT NUMBER: BERLIN AIR 04-3216

FILE NAME: z05h378sht.ph.dgn  
 PROJECT LEADER: S. FORTNEY  
 DESIGNED BY: S. BOUCHARD  
 WORK AREA 1 SHT 2

PLOT DATE: 11/22/2011  
 DRAWN BY: D. STANDISH  
 CHECKED BY: J. DOWNAR  
 SHEET 10 OF 173