

LEGEND

- EXISTING EDGE OF PAVEMENT
- TREE LINE
- EXISTING BUILDING
- AREA OF PAVEMENT REMOVAL AND RECONSTRUCTION
- AREA OF NEW APRON & TAXIWAY
- CONTRACTOR STAGING AREA
- LIMITS OF PROPOSED TIEDOWN APRON
- EXISTING FENCE
- EXISTING UNDERGROUND ELECTRIC LINE
- ROTATING BEACON
- EXISTING TIEDOWNS
- EXISTING TAXIWAY LIGHT
- EXISTING REFLECTOR
- EXISTING POWER POLE
- EXISTING GUY WIRE
- EXISTING CATCH BASIN
- EXISTING STORM DRAIN MANHOLE
- HVCTHL POINT

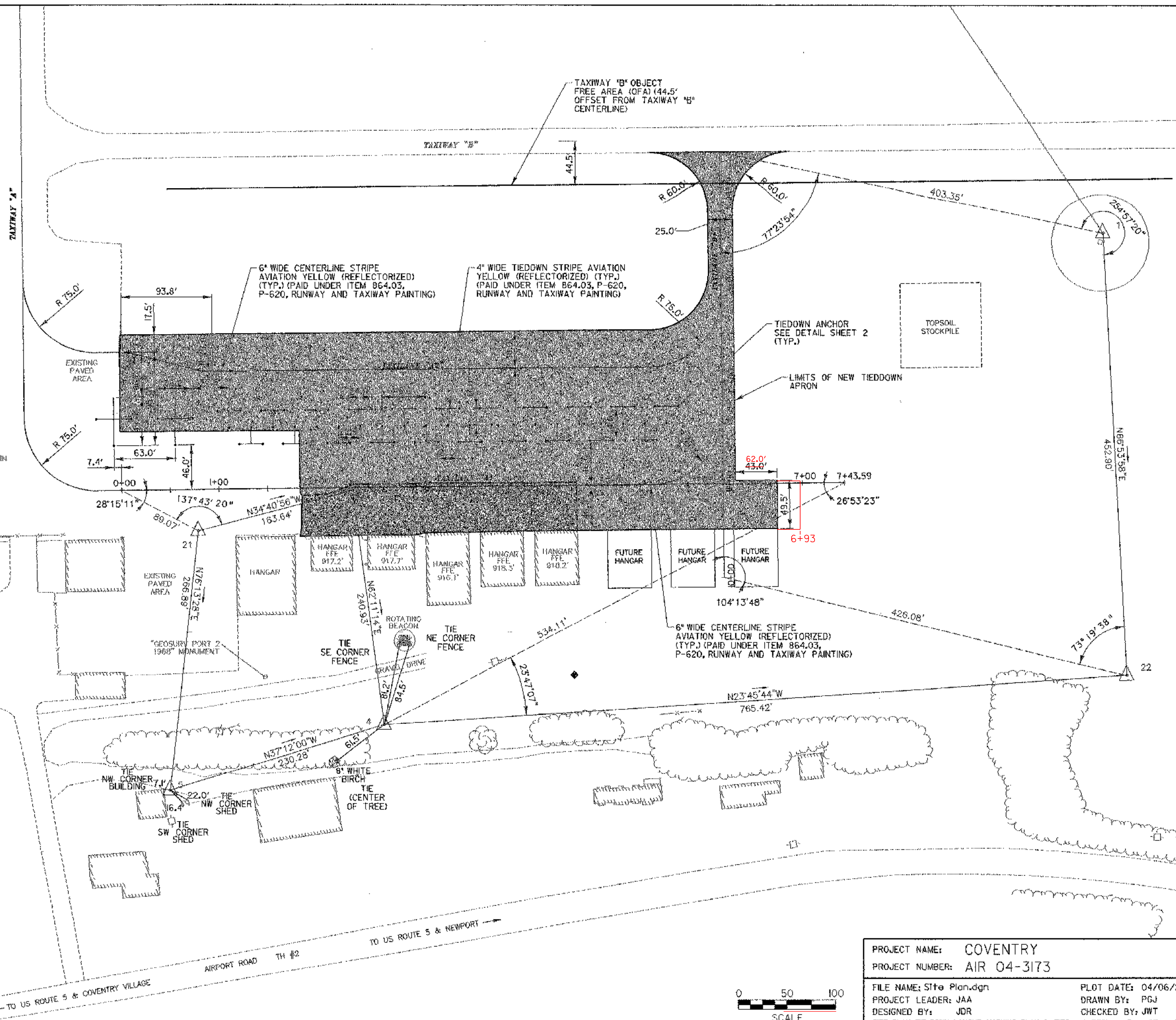

- CONSTRUCTION STAKING NOTES:**
1. PRIOR TO THE START OF CONSTRUCTION, THE CONTRACTOR SHALL LOCATE AND PROTECT ALL HORIZONTAL AND VERTICAL CONTROL POINTS TO BE USED FOR CONSTRUCTION SURVEYING.
 2. SURVEY CONTROL HAS BEEN SET AS SHOWN:
- | CONTROL POINT | NORTHING | EASTING | ELEVATION |
|---------------|-----------|------------|-----------|
| 1 | 871723.54 | 1711107.66 | 923.02 |
| 2 | 870897.34 | 1710505.69 | 921.78 |
| 3 | 871088.29 | 1711619.56 | 917.61 |
| 4 | 871200.70 | 1711832.66 | 913.18 |
| 5 | 871017.27 | 1711971.89 | 909.77 |
| 21 | 870953.72 | 1711712.68 | 916.39 |
| 22 | 871901.23 | 1711524.24 | 911.70 |
3. CONTRACTOR TO VERIFY ELEVATIONS OF ALL CONTROL POINTS AND NOTIFY THE ENGINEER OF ANY DISCREPANCIES.

DATUM

| | |
|------------|---------|
| VERTICAL | NAVD 88 |
| HORIZONTAL | NAD 83 |

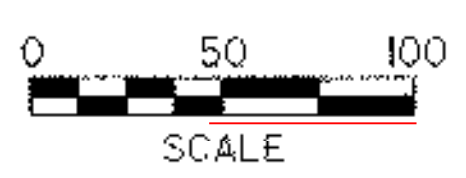

PROJECT NAME: COVENTRY
 PROJECT NUMBER: AIR 04-3173

FILE NAME: Site Plan.dgn
 PROJECT LEADER: JAA
 DESIGNED BY: JDR

PLOT DATE: 04/06/2005
 DRAWN BY: PGJ
 CHECKED BY: JWT

SHEET 6 OF 22