

FENCE NOTES:

- WHERE NEW FENCE IS INSTALLED ALONG AN ADJOINING PROPERTY LINE, THE FENCE WILL BE PLACED AT LEAST 4 FEET INSIDE THE AIRPORT PROPERTY. SEE SHEET 13 FOR THE METES AND BOUNDS DESCRIPTION OF THE AIRPORT PROPERTY. WHERE A NEW FENCE IS INSTALLED OUTSIDE WETLAND LIMITS, THE SITE SHALL BE CLEARED AND GRUBBED TO A WIDTH OF 8 FEET. WHERE FENCE IS INSTALLED WITHIN WETLAND LIMITS, THE SITE WILL BE CLEARED ONLY CLEARING AND GRUBBING TO BE PERFORMED IN ACCORDANCE WITH SECTION 201 "CLEARING" STUMPS SHALL NOT EXCEED 3 INCHES ABOVE THE ADJACENT GROUND SURFACE.
- THE FENCE CONTRACTOR WILL BE RESPONSIBLE FOR ENSURING THAT THE FENCE IS LOCATED ON AIRPORT PROPERTY. LAYOUT TO BE PROVIDED BY A LICENSED LAND SURVEYOR.
- FENCE START AND TERMINATION WILL BE AS DIRECTED BY THE ENGINEER.
- FENCE SHALL BE PLACED A MINIMUM OF 40 FEET FROM THE CENTER OF AIRPORT ROAD.
- FENCE TO BE PLACED BENEATH RUNWAY ELEVATION, WHERE FENCE IS SHOWN WITHIN THE RUNWAY SAFETY AREA OR RUNWAY PRIMARY SURFACE.
- NO MOTORIZED VEHICLES WILL BE ALLOWED WITHIN WETLANDS. ALL EXCAVATION OF FENCE POST HOLES WILL HAVE TO BE HAND EXCAVATED AND EXCAVATED MATERIAL TO BE DEPOSITED OUTSIDE WETLAND AREAS.
- UNDERGROUND CABLES EXTEND BETWEEN THE FAA CONTROL BUILDING AND THE ODALS/MALSIR INSTALLATION
- SEE ADDITIONAL FENCE NOTES ON SHEET 7
- COORDINATE FENCE LOCATION WITHIN TERMINAL AREA WITH AIRPORT MANAGEMENT
- 8' CHAINLINK FENCE AND GATE BETWEEN POINTS A & B, B & C AND C & D TO BE VINYL CLAD (GREEN)
- SIGNS TO BE SECURELY FASTENED TO AIRFIELD SIDE OF FENCE FACING OUTWARD. SIGNS TO BE APPROXIMATELY FIVE FEET ABOVE GROUND LEVEL PLACED AT 200 FEET INTERVALS.

- AIRPORT BUILDINGS**
- COLUMBIA AVIATION HANGAR
 - AIRPORT TERMINAL BUILDING
 - STATE STORAGE HANGAR
 - ARFF HANGAR
 - CAP HANGAR
 - DRAPER HANGAR
 - OMYA HANGAR
 - CIVIL AIR PATROL

INSTALL NEW 40LF x 24" DIA. CPEP IN DRAINAGE DITCH APPROX. 300' RT. FROM R/W I-19 CENTERLINE. BACKFILL WITH WASTE MATERIAL FROM PROJECT B. SEE DETAIL 12

- GATE NOTES:**
- COORDINATE PLACEMENT OF 12 FOOT DRIVE GATE AT FAA CONTROL BUILDING WITH FAA TEL: (802-951-6704)
 - EXISTING DRIVE GATES TO BE REMOVED AND STOCKPILED ON AIRPORT, AS DIRECTED BY THE ENGINEER.
 - INSTALL NEW RADIO CONTROLLED AUTOMATED SLIDE GATES WITH CARD READER AND FREE EXIT LOOP AT THE LOCATIONS SHOWN. CARD READER TO BE COMPATIBLE WITH EXISTING AIRPORT FENCE CONTROL SYSTEM. CARD READER TO BE MANUFACTURED BY SECURITY ASD, OR EQUAL. CONTRACTOR TO SUPPLY 25 CARDS FOR USE WITH CARD READER.
 - GATE OPENER TO USE 1 HP, 240V, 1PHASE MOTOR.
 - INSTALL NEW WIRING FOR MOTOR AND CARD READER IN 1/2" PVC (UNDERGROUND) TO COLUMBIA AVIATION HANGAR. INSTALL NEW WIRING, BREAKERS, AND ELECTRICAL HARDWARE, WHERE REQUIRED INSIDE HANGAR.
 - THE CONTRACTOR SHALL MAINTAIN ELECTRICAL CONTINUITY AT ALL GATE CROSSINGS. A # 2 AWC BARE COPPER CABLE TO BE INSTALLED 24 INCHES BELOW GRADE AT GATES. PAYMENT IS INCIDENTAL TO THE GATE, ITEM # 620.17 SEE DETAIL F ON SHEET 12.
 - REFER TO GATE SCHEDULE ON THIS SHEET

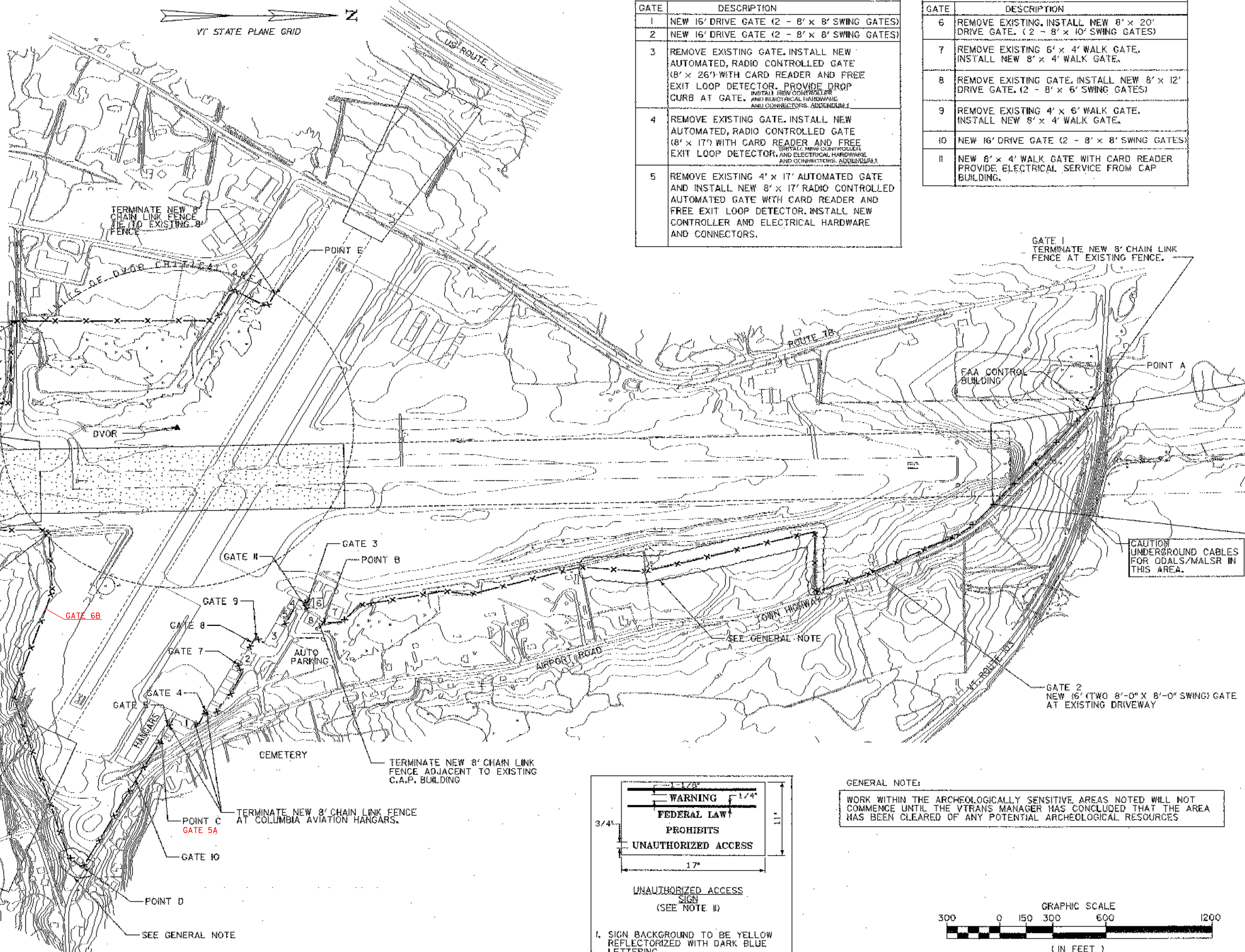

AIRPORT GATE SCHEDULE	
GATE	DESCRIPTION
1	NEW 16' DRIVE GATE (2 - 8' x 8' SWING GATES)
2	NEW 16' DRIVE GATE (2 - 8' x 8' SWING GATES)
3	REMOVE EXISTING GATE. INSTALL NEW AUTOMATED, RADIO CONTROLLED GATE (8' x 26') WITH CARD READER AND FREE EXIT LOOP DETECTOR. PROVIDE DROP CURB AT GATE. <small>INSTALL NEW CONTROLLER AND ELECTRICAL HARDWARE AND CONNECTORS. ADDENDUM 1.</small>
4	REMOVE EXISTING GATE. INSTALL NEW AUTOMATED, RADIO CONTROLLED GATE (8' x 17') WITH CARD READER AND FREE EXIT LOOP DETECTOR. <small>INSTALL NEW CONTROLLER AND ELECTRICAL HARDWARE AND CONNECTORS. ADDENDUM 1.</small>
5	REMOVE EXISTING 4' x 17' AUTOMATED GATE AND INSTALL NEW 8' x 17' RADIO CONTROLLED AUTOMATED GATE WITH CARD READER AND FREE EXIT LOOP DETECTOR. <small>INSTALL NEW CONTROLLER AND ELECTRICAL HARDWARE AND CONNECTORS.</small>

AIRPORT GATE SCHEDULE	
GATE	DESCRIPTION
6	REMOVE EXISTING. INSTALL NEW 8' x 20' DRIVE GATE. (2 - 8' x 10' SWING GATES)
7	REMOVE EXISTING 5' x 4' WALK GATE. INSTALL NEW 8' x 4' WALK GATE.
8	REMOVE EXISTING GATE. INSTALL NEW 8' x 12' DRIVE GATE. (2 - 8' x 6' SWING GATES)
9	REMOVE EXISTING 4' x 6' WALK GATE. INSTALL NEW 8' x 4' WALK GATE.
10	NEW 16' DRIVE GATE (2 - 8' x 8' SWING GATES)
11	NEW 8' x 4' WALK GATE WITH CARD READER. PROVIDE ELECTRICAL SERVICE FROM CAP BUILDING.

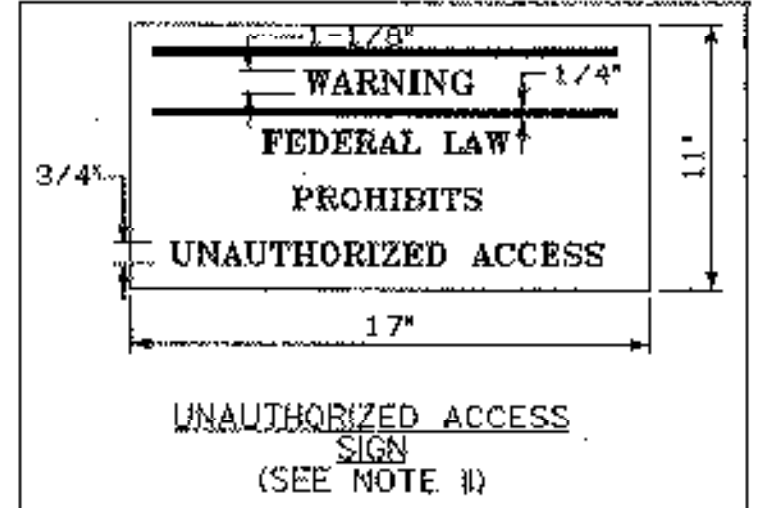

- SIGN BACKGROUND TO BE YELLOW REFLECTORIZED WITH DARK BLUE LETTERING
- SIGNS TO BE PLACED AT 200' (MAX.) INTERVALS 5' ABOVE THE GROUND LEVEL
- ATTACH SIGNS TO INSIDE OF FENCE FACING OUT.

GENERAL NOTE:
 WORK WITHIN THE ARCHEOLOGICALLY SENSITIVE AREAS NOTED WILL NOT COMMENCE UNTIL THE VTRANS MANAGER HAS CONCLUDED THAT THE AREA HAS BEEN CLEARED OF ANY POTENTIAL ARCHEOLOGICAL RESOURCES

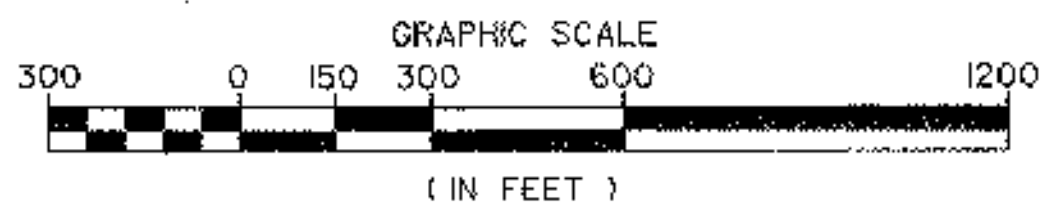

URS
 28 CORPORATE DRIVE
 CLIFTON PARK, NEW YORK

<p>RUTLAND STATE AIRPORT CLARENDON, VERMONT</p>	<p>PROPOSED FENCE PLAN</p>
<p>DESIGNED BY: R.P.D. DRAWN BY: R.P.D. CHECKED BY: G.W.D. APPROVED BY: G.R.D.</p>	<p>DESCRIPTION: _____ REV. DATE: _____ JOB NO.: 38397036 FILE NO.: 38397036/06</p>
<p>Scale: AS SHOWN</p> <p>Date: MARCH, 2005</p> <p>Sheet 6 of 13</p> <p>Sheet No. 6</p>	