

NOTES

- 1) TAXIWAY GUIDANCE SIGN LOCATIONS:
PERPENDICULAR DISTANCE = 10'-20' FROM DEFINED TAXIWAY EDGE TO NEAR SIDE OF SIGN.
- 2) SEE SHEET 8 FOR TAXIWAY GUIDANCE SIGN DETAIL
- 3) SEE DETAIL 1, SHEET 5 FOR TYPICAL RUNWAY/TAXIWAY HOLDING POSITION MARKINGS

KEYNOTES:

- (A) (2) 1/2" #8, 5KV, L-824C DIRECT BURIED CABLE AND
- (1) #8 COUNTERPOISE TO NEW L8-67B HANDHOLD

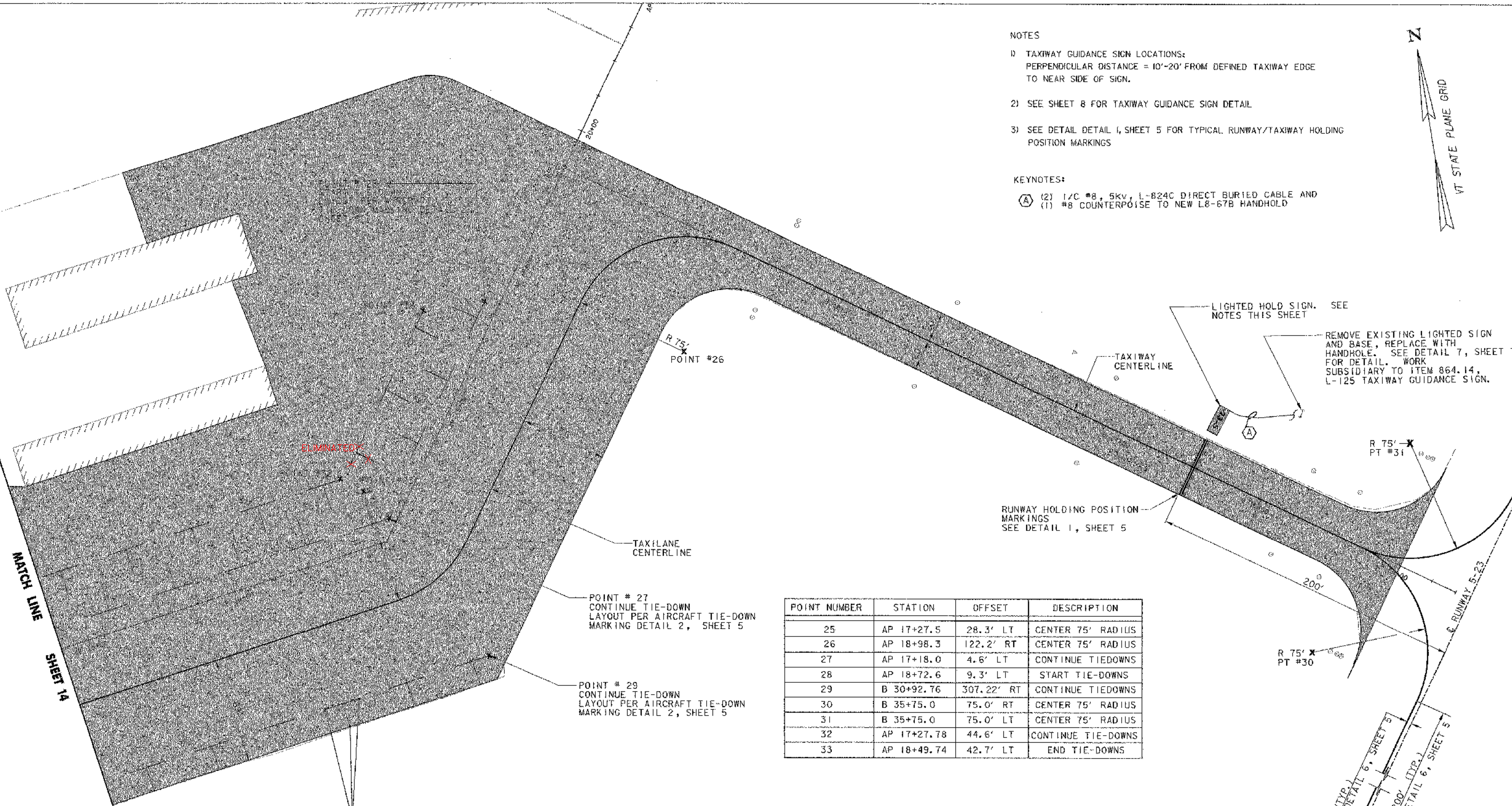

POINT NUMBER	STATION	OFFSET	DESCRIPTION
25	AP 17+27.5	28.3' LT	CENTER 75' RADIUS
26	AP 18+98.3	122.2' RT	CENTER 75' RADIUS
27	AP 17+18.0	4.6' LT	CONTINUE TIEDOWNS
28	AP 18+72.6	9.3' LT	START TIE-DOWNS
29	B 30+92.76	307.22' RT	CONTINUE TIEDOWNS
30	B 35+75.0	75.0' RT	CENTER 75' RADIUS
31	B 35+75.0	75.0' LT	CENTER 75' RADIUS
32	AP 17+27.78	44.6' LT	CONTINUE TIE-DOWNS
33	AP 18+49.74	42.7' LT	END TIE-DOWNS

PAVEMENT MARKINGS

- TAXIWAY CENTER LINE 6" SOLID YELLOW
- FUELING AREA 6" YELLOW DASHED LINE
- TIE-DOWNS 6" SOLID YELLOW LINE (BETWEEN ANCHORS)
- HOLD LINES 2-12" SOLID YELLOW
2-12" YELLOW DASHED (SEE DETAIL)

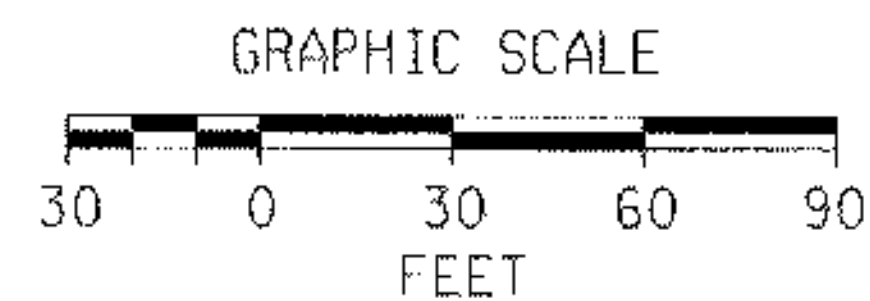

PROJECT NAME: SPRINGFIELD AIR
PROJECT NUMBER: 04-3161

FILE NAME: stripe2.ptf
PROJECT LEADER: JBL
DESIGNED BY: MCS

PLOT DATE: 05/21/2003
DRAWN BY: TPL
CHECKED BY: MCS
SHEET 15 OF 17

STRIPING & TIEDOWN PLAN