

TYPICAL CONSTRUCTION BARRICADE
NOT TO SCALE

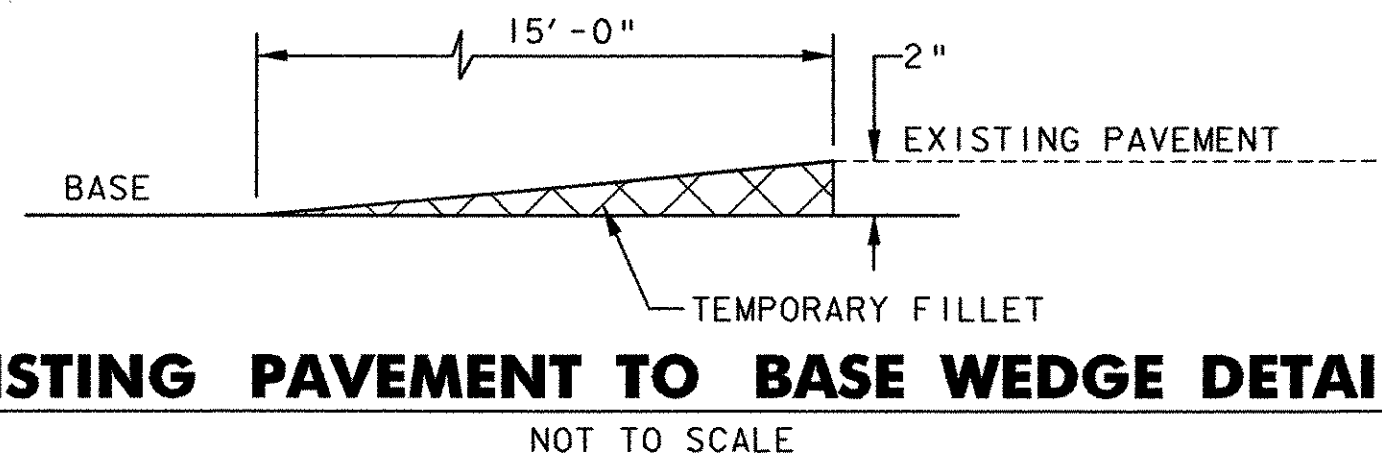

EXISTING PAVEMENT TO BASE WEDGE DETAIL
NOT TO SCALE

CONSTRUCTION PHASING					
PHASE	DESCRIPTION OF WORK	BARRICADE LOCATIONS	DURATION	COMMENTS	EROSION PREVENTION (EP) & SEDIMENT CONTROL (SC)
I	1) SEE EP & SC NOTES 1&2 2) REMOVE TIEDOWNS 3) RECYCLE PAVEMENT AND BASE COURSE; REGRADE SEE EP & SC NOTE 3 4) CONST. DRAINAGE 5) CONST. ELECTRICAL CONDUIT/ DUCT BANK 6) PAVE BINDER COURSE 7) INSTALL NEW TIEDOWNS	1) ON PHASE I/IA LINE 2) ACROSS APRON AT STA. 14+75+/- (PHASE I/II LINE)	45 CALENDAR DAYS	1) TAXIWAY "B" IS CLOSED 2) LIMITED ACCESS TO T-HANGARS 3) TAXIWAY "A" IS OPEN	1) INSTALL VEHICLE TRACKING PAD AS SHOWN ON SHEET 13. 2) INSTALL STONE CHECK DAMS AND SILT FENCE AS SHOWN ON SHEET 13, FOR PHASE I AND PHASE IA AREAS. 3) INSTALL ROCK BARRIER INLET PROTECTION IMMEDIATELY AFTER EXPOSING SUBBASE (FOR INLETS IN PAVED SECTIONS) OR IMMEDIATELY UPON COMPLETION OF INLET CONSTRUCTION (FOR NEW STRUCTURES). MAINTAIN ROCK BARRIER INLET PROTECTION UNTIL PERMANENT COVER (PAVEMENT OR GRASS) IS ESTABLISHED. 4) APPLY TEMP. TURF ESTAB. TO ALL DISTURBED AREAS WITHIN 24 HOURS TO LIMITS OF SOIL DISTURBANCE, FOR ALL PHASE I AND PHASE IA AREAS.
IA	1) RECYCLE PAVEMENT AND BASE COURSE; REGRADE 2) PAVE BINDER COURSE 3) SEE EP & SC NOTE 4 4) APPLY PERMANENT TURF ESTABLISHMENT W/4" TOPSOIL	1) ON PHASE I/IA LINE 2) TAXIWAY "B" AT RUNWAY 5-23	3 WORKING DAYS (72 HOURS)	1) TAXIWAY "A" IS OPEN 2) TAXIWAY "B" IS CLOSED 3) ACCESS TO ALL HANGARS IS NORMAL 4) RUNWAY 5-23 IS CLOSED	5) INSTALL SILT FENCE AS SHOWN ON SHEET 12 FOR PHASE II, PHASE III AND PHASE IIIA AREAS. 6) INSTALL ROCK BARRIER INLET PROTECTION IMMEDIATELY AFTER EXPOSING SUBBASE (FOR INLETS IN PAVED SECTIONS) OR IMMEDIATELY UPON COMPLETION OF INLET CONSTRUCTION (FOR NEW STRUCTURES). MAINTAIN ROCK BARRIER INLET PROTECTION UNTIL PERMANENT COVER (PAVEMENT OR GRASS) IS ESTABLISHED. 7) APPLY TEMP. TURF ESTAB. TO ALL DISTURBED AREAS WITHIN 24 HOURS TO LIMITS OF SOIL DISTURBANCE, FOR ALL PHASE II AND PHASE III AREAS. 8) APPLY TEMP. TURF ESTAB. TO ALL DISTURBED AREAS WITHIN 24 HOURS TO LIMITS OF SOIL DISTURBANCE, FOR ALL PHASE IIIA AREAS. 9) REMOVE VEHICLE TRACKING PAD. RESTORE ACCESS ROAD TO ORIGINAL SURFACE. TOPSOIL, SEED & MULCH ANY EXPOSED SOIL. 10) REMOVE ALL REMAINING TEMPORARY EP & CS MEASURES UPON PROJECT COMPLETION OF FINAL SITE STABILIZATION AS APPROVED BY THE ENGINEER, WHICHEVER OCCURS LAST, AND SEED AND MULCH ANY AREAS DISTURBED BY THE REMOVAL OF THE TEMPORARY MEASURES.
II	1) SEE EP & SC NOTE 5 2) REMOVE TIEDOWNS 3) RECYCLE PAVEMENT AND BASE COURSE; REGRADE SEE EP & SC NOTE 6 4) CONST. DRAINAGE 5) CONST. ELECTRICAL CONDUIT/ DUCT BANK 6) PAVE BINDER COURSE 7) INSTALL NEW TIEDOWNS	1) ACROSS RAMP AT STA. 14+75+/- (PHASE I/II LINE) 2) ON PHASE II/III LINE	45 CALENDAR DAYS	1) TAXIWAY "B" IS OPEN 2) TAXIWAY "A" IS OPEN 3) FOR FUEL AND MAINTENANCE HANGAR ONLY 3) NORMAL ACCESS TO T-HANGARS 4) LIMITED ACCESS TO OTHER HANGARS	
III	1) RECYCLE PAVEMENT AND BASE COURSE; REGRADE 2) PAVE BINDER COURSE 3) SEE EP & SC NOTE 7	1) ON PHASE IIIA/III LINE 2) PHASE II/III LINE	3 WORKING DAYS (72 HOURS)	1) TAXIWAY "A" IS CLOSED 2) TAXIWAY "B" IS OPEN 3) ACCESS TO ALL HANGARS IS NORMAL 4) LIMITED ACCESS TO FUEL	
IIIA	1) RECYCLE PAVEMENT AND BASE COURSE; REGRADE 2) PAVE BINDER COURSE 3) SEE EP & SC NOTE 8 4) SEE EP & SC NOTES 9 & 10 5) APPLY PERMANENT TURF ESTABLISHMENT W/4" TOPSOIL	1) ON PHASE IIIA/III LINE 2) TAXIWAY "A" AT RUNWAY 11-29	3 WORKING DAYS (72 HOURS)	1) TAXIWAY "A" IS CLOSED 2) TAXIWAY "B" IS OPEN 3) ACCESS TO ALL HANGARS IS NORMAL 4) RUNWAY 11-29 IS CLOSED	

UPON COMPLETION OF ALL PHASES LISTED ABOVE, PAVE TOP COURSE ON TAXIWAY "A", TAXIWAY "B", AND ENTIRE APRON. MAINTAIN ONE TAXIWAY OPEN AT ALL TIMES AND LIMITED, CONTROLLED TRAFFIC ON ENTIRE RAMP DURING TOP COURSE PAVING OPERATIONS WITH PRIORITY ACCESS TO FUEL PUMPS.

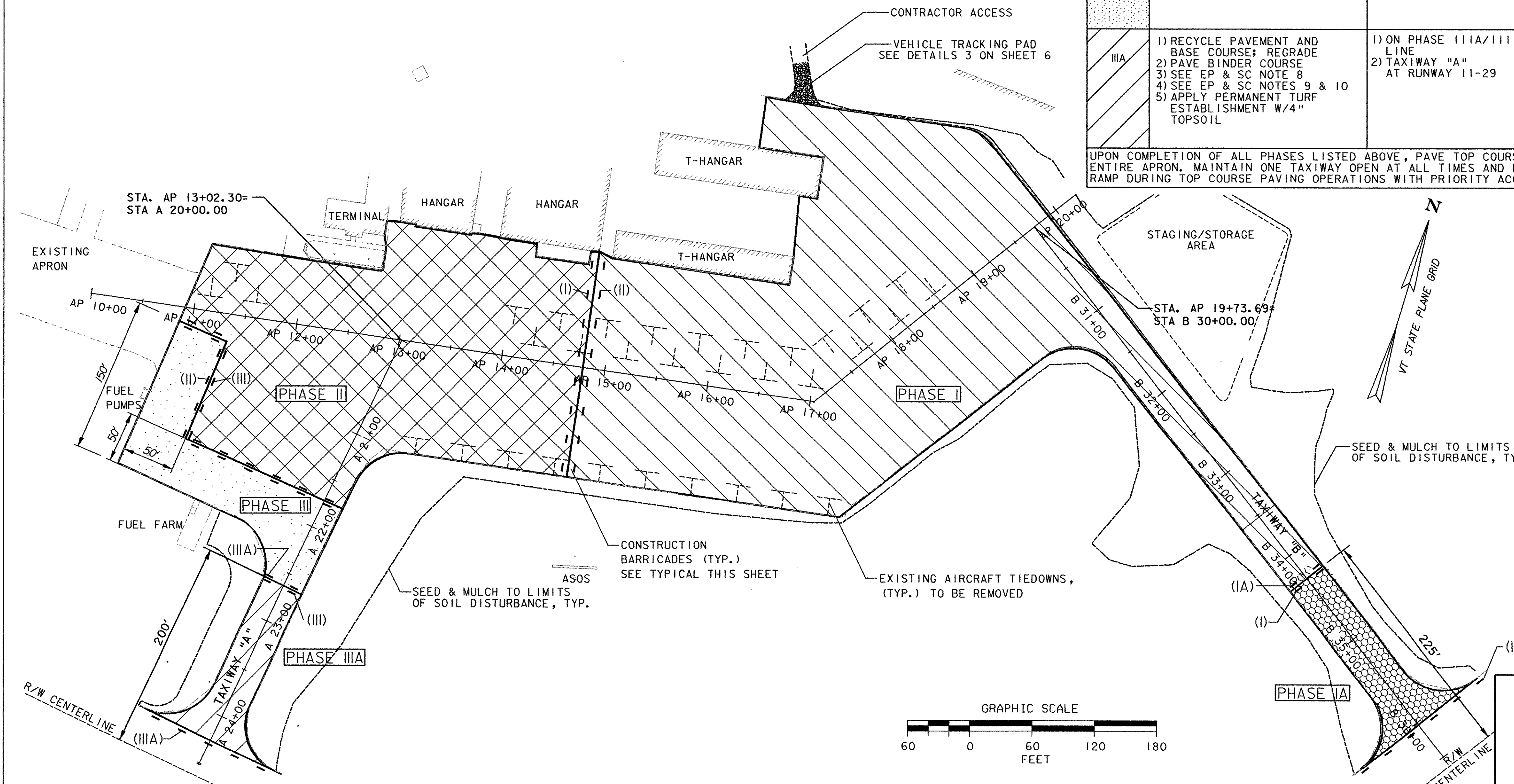

EROSION PREVENTION AND SEDIMENT CONTROL NOTES

- 1) REFERENCE SUPPLEMENTAL SPECIFICATION "SOIL EROSION AND SEDIMENT CONTROL" AND SPECIFICATION 652-EROSION CONTROL FOR INSPECTION AND MAINTENANCE REQUIREMENTS FOR EROSION PREVENTION AND SEDIMENT CONTROL MEASURES.
- 2) AN ON-SITE COORDINATOR WILL BE IDENTIFIED AS DEFINED IN THE VTRANS SECTION 652 EROSION CONTROL SPECIFICATION.
- 3) PHASING AS PROPOSED ON THIS PLAN DICTATED BY OPERATIONAL REQUIREMENTS DURING CONSTRUCTION ALTERATIONS FOR CONSTRUCTION PURPOSES MUST BE APPROVED BY AIRPORT MANAGER.

NOTES REGARDING RUNWAY CLOSURE FOR RUNWAY HOLD LINES AND SIGNS:

- 1) THE CONTRACTOR SHALL COORDINATE WITH THE HARTNESS AIRPORT MANAGER BEFORE COMMENCING WITH THE INSTALLATION OF THE TAXIWAY GUIDANCE SIGNS AND MARKINGS. VAOT PERSONNEL MAY BE AVAILABLE TO MONITOR AIR TRAFFIC DURING THIS WORK, WHICH WOULD ENABLE ONE RUNWAY TO REMAIN OPEN. IF VAOT PERSONNEL ARE NOT ABLE TO MONITOR AIR TRAFFIC, BOTH RUNWAYS WILL NEED TO BE CLOSED.
- 2) IF IT IS NECESSARY TO CLOSE BOTH RUNWAYS TO COMPLETE THIS WORK, THE FOLLOWING CONDITIONS SHALL APPLY:
 - THIS WORK SHALL BE COMPLETED DURING PHASES IA OR IIIA.
 - THE CLOSURE TIME FOR BOTH RUNWAYS SHALL NOT EXCEED 3 WORKING DAYS.
 - THE CLOSURE OF BOTH RUNWAYS SHALL NOT OCCUR ON A WEEKEND.

CONSTRUCTION PHASING NOTES

PRIOR TO BEGINNING EACH PHASE OF WORK, THE CONTRACTOR SHALL REQUEST THAT THE AIRPORT ISSUE A NOTAM TO CLOSE THE APPROPRIATE SECTION OF THE AIRFIELD. ONCE THE WORK AREA HAS BEEN CLOSED TO AIR TRAFFIC, THE CONTRACTOR SHALL INSTALL CONSTRUCTION BARRICADES AS INDICATED ON THE PHASING PLAN. UPON COMPLETION OF CONSTRUCTION ACTIVITIES WITHIN EACH PHASE, THE BARRICADES SHALL BE REMOVED, THE WORK AREA SHALL BE INSPECTED AND ACCEPTED BY THE ENGINEER, AND THE NOTAM CANCELED PRIOR TO COMMENCING THE NEXT PHASE.

DH Dufresne-Henry	PROJECT NAME: SPRINGFIELD AIR	PLOT DATE: 05/21/2003
	PROJECT NUMBER: 04-3161	DRAWN BY: TPL
	FILE NAME: phase.dgn	CHECKED BY: MCS
	PROJECT LEADER: JBL DESIGNED BY: MCS	SHEET 11 OF 17

CONST. PHASING AND NOTES