

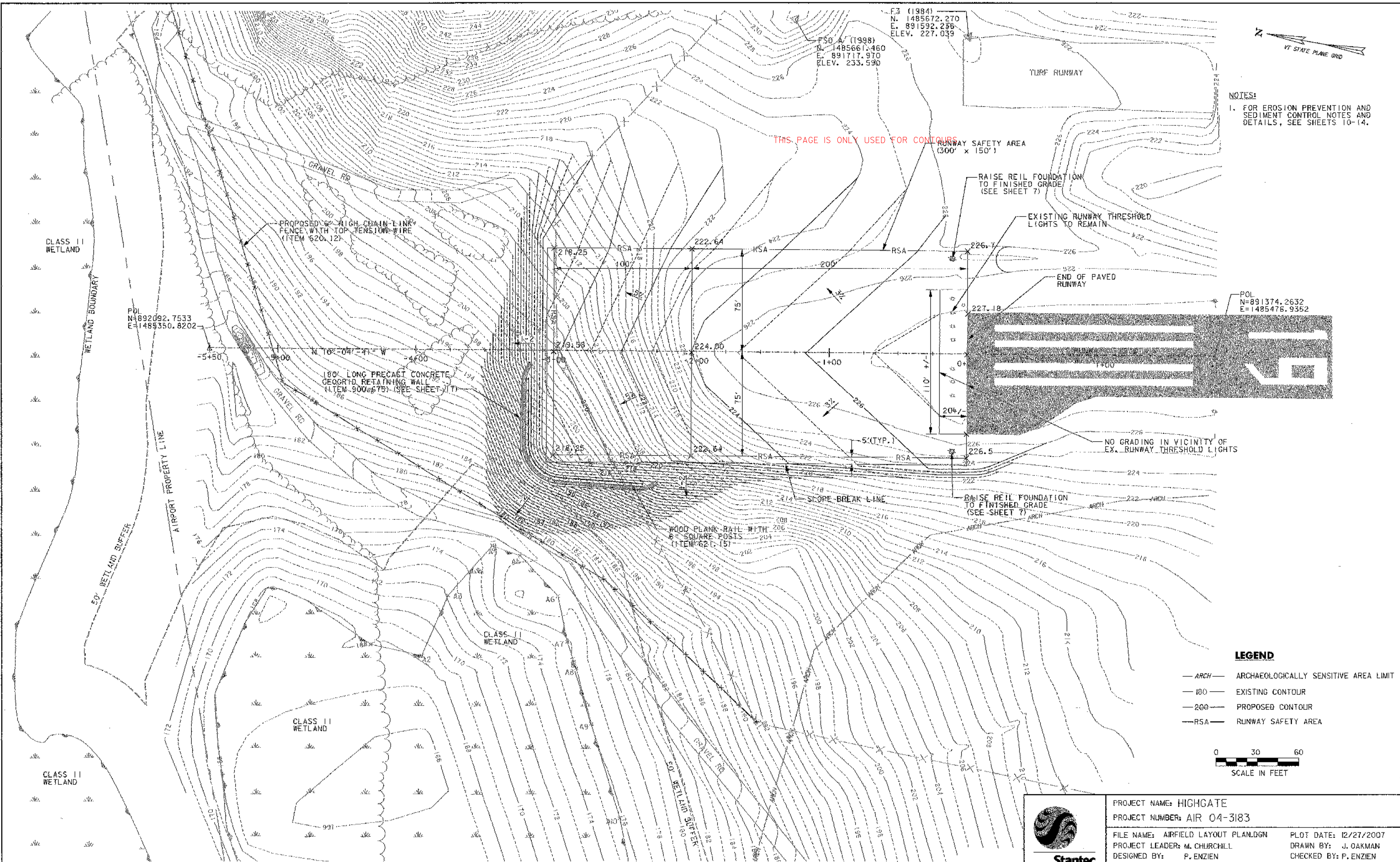

NOTES:
 1. FOR EROSION PREVENTION AND SEDIMENT CONTROL NOTES AND DETAILS, SEE SHEETS 10-14.

THIS PAGE IS ONLY USED FOR CONTOURS



POL
 N=891374.2632
 E=1485476.9352

POL
 N=892092.7533
 E=1489350.8202

FSO A (1988)
 N=1485661.460
 E=891717.970
 ELEV. 233.590

F3 (1984)
 N=1485672.270
 E=891592.236
 ELEV. 227.039

- LEGEND**
- ARCH — ARCHAEOLOGICALLY SENSITIVE AREA LIMIT
 - 100 — EXISTING CONTOUR
 - 200 — PROPOSED CONTOUR
 - RSA — RUNWAY SAFETY AREA

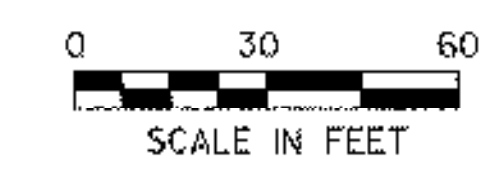

PROJECT NAME: HIGHGATE
 PROJECT NUMBER: AIR 04-3183
 FILE NAME: AIRFIELD LAYOUT PLAN.DGN
 PROJECT LEADER: M. CHURCHILL
 DESIGNED BY: P. ENZIEN
 AIRFIELD LAYOUT PLAN

PLOT DATE: 12/27/2007
 DRAWN BY: J. OAKMAN
 CHECKED BY: P. ENZIEN
 SHEET 16 OF 27