

PLOTTING PARAMETERS:  
 Plot Date: 12/26/2007 10:58 AM  
 Plot Path: C:\Users\jchurchill\Documents\122607\122607.dwg  
 Plot Scale: 1:1  
 Plot Style: Standard.ctb  
 Plot Size: 36" x 48"

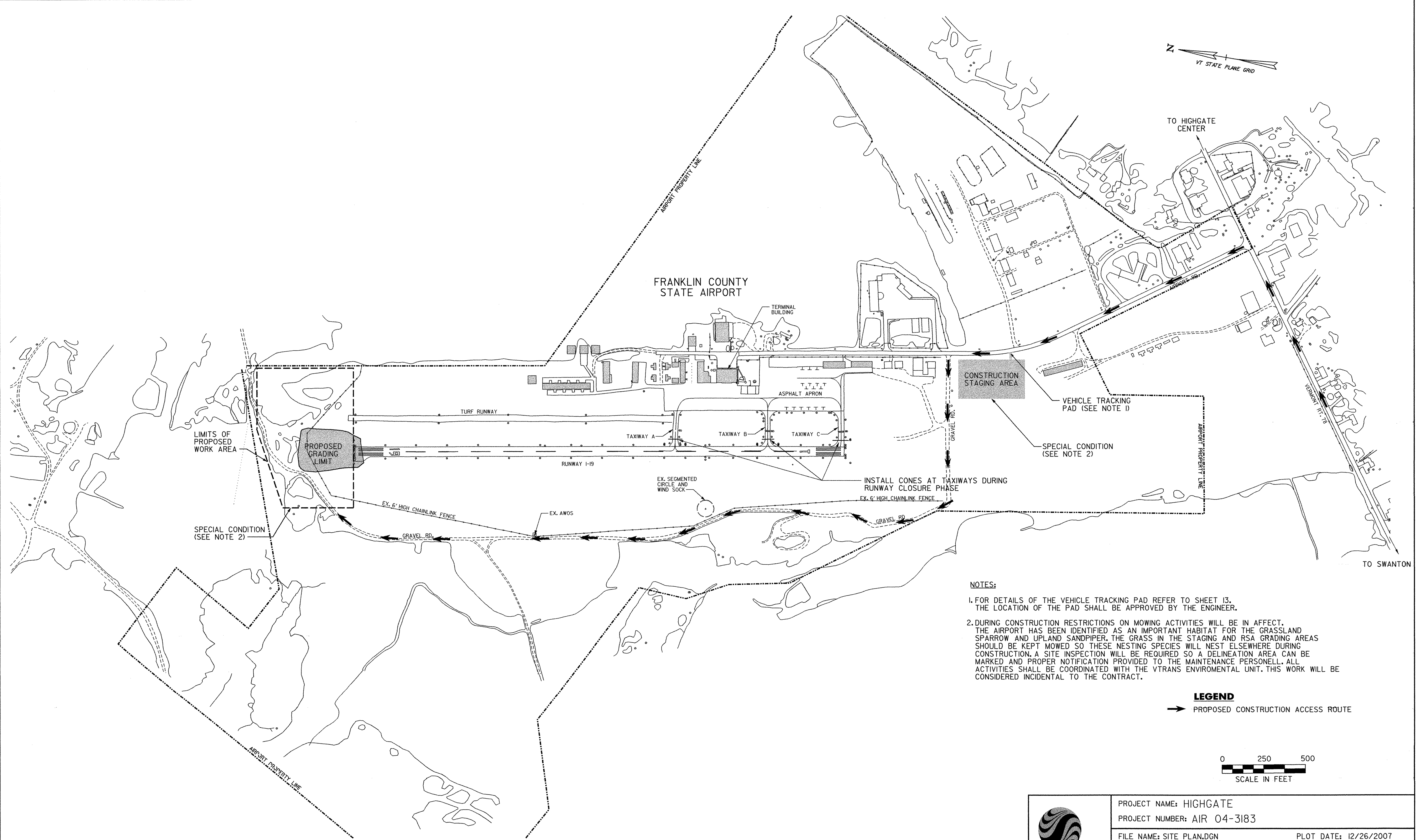

TO HIGHGATE CENTER

TO SWANTON

- NOTES:**
- FOR DETAILS OF THE VEHICLE TRACKING PAD REFER TO SHEET 13. THE LOCATION OF THE PAD SHALL BE APPROVED BY THE ENGINEER.
  - DURING CONSTRUCTION RESTRICTIONS ON MOWING ACTIVITIES WILL BE IN AFFECT. THE AIRPORT HAS BEEN IDENTIFIED AS AN IMPORTANT HABITAT FOR THE GRASSLAND SPARROW AND UPLAND SANDPIPER. THE GRASS IN THE STAGING AND RSA GRADING AREAS SHOULD BE KEPT MOWED SO THESE NESTING SPECIES WILL NEST ELSEWHERE DURING CONSTRUCTION. A SITE INSPECTION WILL BE REQUIRED SO A DELINEATION AREA CAN BE MARKED AND PROPER NOTIFICATION PROVIDED TO THE MAINTENANCE PERSONNEL. ALL ACTIVITIES SHALL BE COORDINATED WITH THE VTRANS ENVIRONMENTAL UNIT. THIS WORK WILL BE CONSIDERED INCIDENTAL TO THE CONTRACT.

**LEGEND**  
 PROPOSED CONSTRUCTION ACCESS ROUTE

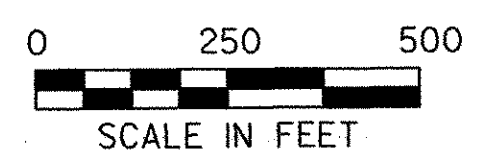

	PROJECT NAME: HIGHGATE	PLOT DATE: 12/26/2007
	PROJECT NUMBER: AIR 04-3183	DRAWN BY: J. OAKMAN
	FILE NAME: SITE PLAN.DGN	CHECKED BY: P. ENZIEN
	PROJECT LEADER: M. CHURCHILL	SHEET 8 OF 27
DESIGNED BY: P. ENZIEN	<b>SITE PLAN</b>	