



| | | |
|------|---------|-----------------------|
| REV. | DATE | DESCRIPTION |
| 1 | 8/15/03 | REVISE FENCE LOCATION |

Job No. F200002046.00
File No. F200260046.00

RUTLAND STATE AIRPORT
CLARENCEN, VERMONT

FENCE PLAN

URS
1 NORTHWAY LN.
LATHAM, NEW YORK

| | | | |
|---------------------|------------------|--------------------|---------------------|
| Designed by: G.W.D. | Drawn by: M.C.M. | Checked by: M.A.C. | Approved by: G.W.D. |
| Scale: 1" = 300' | | | |
| Date: MAR., 2003 | | | |
| Sheet 3 OF 8 | | | |
| Sheet No. 3 | | | |

LEGEND
-X-X- NEW CHAIN LINK FENCE

NOTE 9
INSTALL 8' CHAIN LINK FENCE, GENERALLY 4' EAST OF THE WOODS LINE, IN THE AREA SHOWN.

VT STATE PLANE GRID

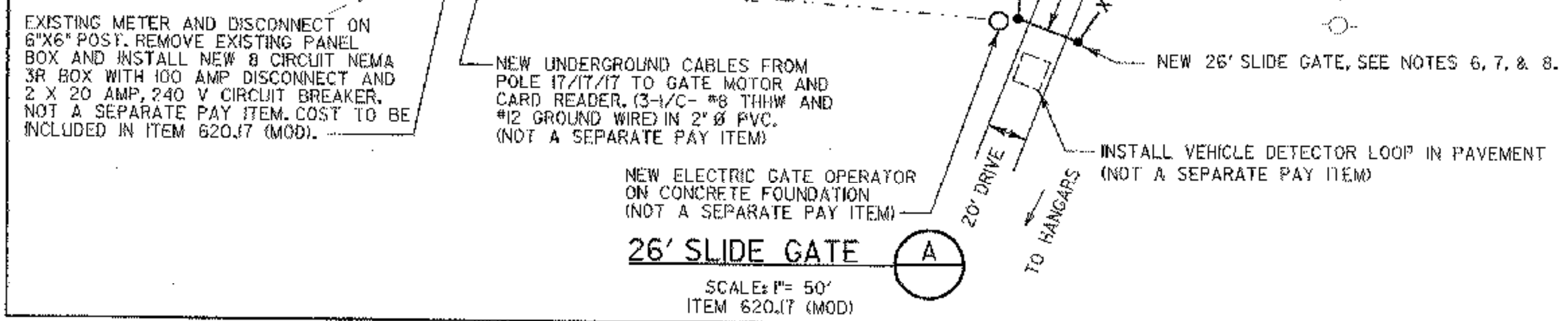
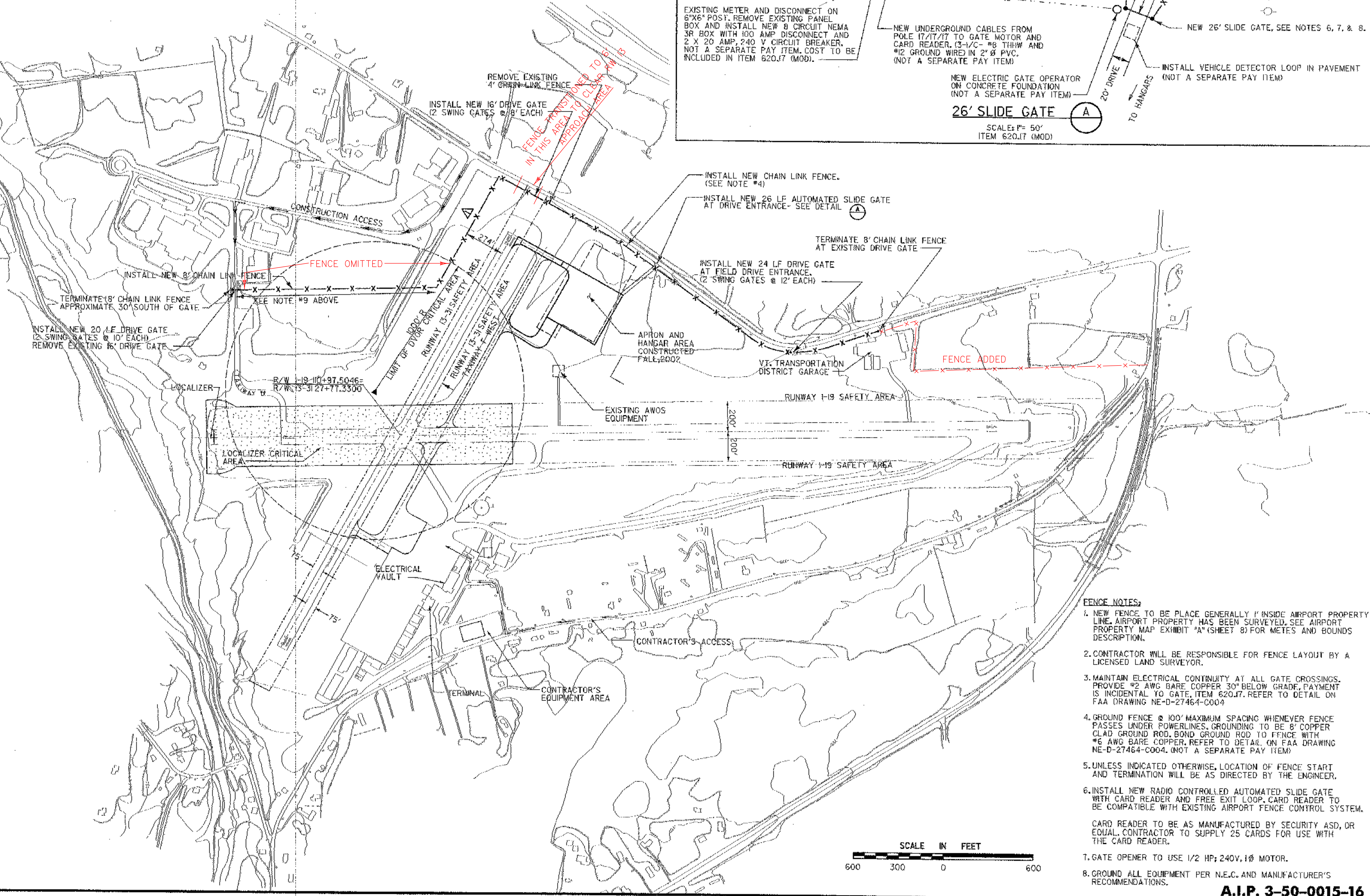

- FENCE NOTES:**
1. NEW FENCE TO BE PLACE GENERALLY 1' INSIDE AIRPORT PROPERTY LINE. AIRPORT PROPERTY HAS BEEN SURVEYED. SEE AIRPORT PROPERTY MAP EXHIBIT "A" (SHEET 8) FOR METES AND BOUNDS DESCRIPTION.
 2. CONTRACTOR WILL BE RESPONSIBLE FOR FENCE LAYOUT BY A LICENSED LAND SURVEYOR.
 3. MAINTAIN ELECTRICAL CONTINUITY AT ALL GATE CROSSINGS. PROVIDE #2 AWG BARE COPPER 30" BELOW GRADE. PAYMENT IS INCIDENTAL TO GATE. ITEM 620.I7. REFER TO DETAIL ON FAA DRAWING NE-D-27464-C004.
 4. GROUND FENCE @ 100' MAXIMUM SPACING WHENEVER FENCE PASSES UNDER POWERLINES. GROUNDING TO BE 8' COPPER CLAD GROUND ROD. BOND GROUND ROD TO FENCE WITH #6 AWG BARE COPPER. REFER TO DETAIL ON FAA DRAWING NE-D-27464-C004. (NOT A SEPARATE PAY ITEM)
 5. UNLESS INDICATED OTHERWISE, LOCATION OF FENCE START AND TERMINATION WILL BE AS DIRECTED BY THE ENGINEER.
 6. INSTALL NEW RADIO CONTROLLED AUTOMATED SLIDE GATE WITH CARD READER AND FREE EXIT LOOP. CARD READER TO BE COMPATIBLE WITH EXISTING AIRPORT FENCE CONTROL SYSTEM. CARD READER TO BE AS MANUFACTURED BY SECURITY ASD, OR EQUAL. CONTRACTOR TO SUPPLY 25 CARDS FOR USE WITH THE CARD READER.
 7. GATE OPENER TO USE 1/2 HP; 240V, 1Ø MOTOR.
 8. GROUND ALL EQUIPMENT PER N.E.C. AND MANUFACTURER'S RECOMMENDATIONS.

A.I.P. 3-50-0015-16