

REV.	DATE	DESCRIPTION

Job No. F200002046.00
File No. F202046000E37

RUTLAND STATE AIRPORT
CLARENDON, VERMONT

TAXIWAY IMPROVEMENTS
WASTE AREA LAYOUT

URS
1 NORTHWAY LN.
LATHAM, NEW YORK

Designed by: G.W.D.
Drawn by: R.P.D.
Checked by: M.K.C.
Approved by: G.W.D.

Scale:
Date: FEB., 2003
Sheet 37 OF 40
Sheet No. **37**

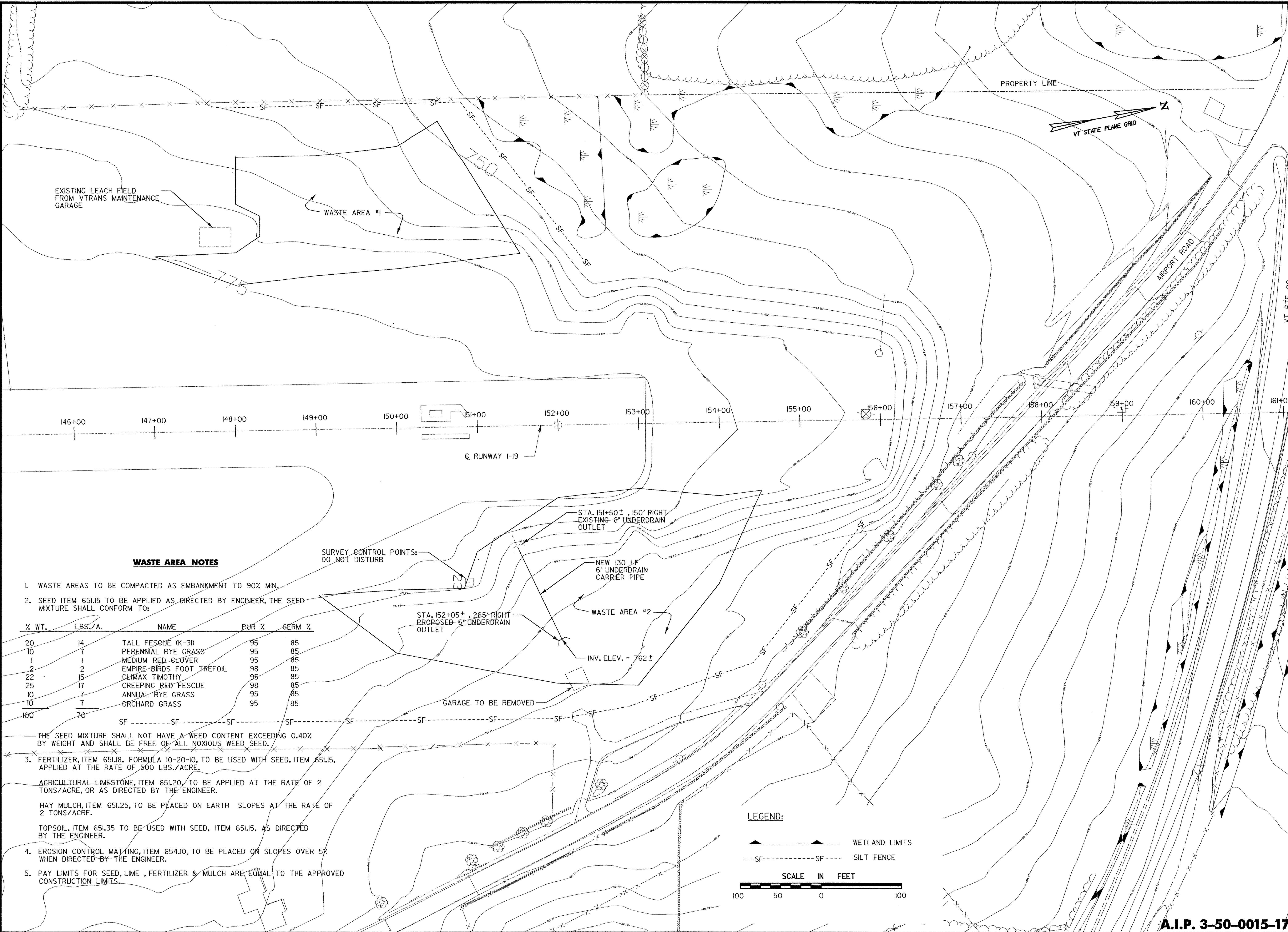

WASTE AREA NOTES

1. WASTE AREAS TO BE COMPACTED AS EMBANKMENT TO 90% MIN.
2. SEED ITEM 65LJ5 TO BE APPLIED AS DIRECTED BY ENGINEER, THE SEED MIXTURE SHALL CONFORM TO:

% WT.	LBS./A.	NAME	PUR %	GERM %
20	14	TALL FESCUE (K-3)	95	85
10	7	PERENNIAL RYE GRASS	95	85
1	1	MEDIUM RED CLOVER	95	85
2	2	EMPIRE BIRDS FOOT TREFLOIL	98	85
22	15	CLIMAX TIMOTHY	95	85
25	17	CREEPING RED FESCUE	98	85
10	7	ANNUAL RYE GRASS	95	85
10	7	ORCHARD GRASS	95	85
100	70	SF		

THE SEED MIXTURE SHALL NOT HAVE A WEED CONTENT EXCEEDING 0.40% BY WEIGHT AND SHALL BE FREE OF ALL NOXIOUS WEED SEED.

3. FERTILIZER, ITEM 65L18, FORMULA 10-20-10, TO BE USED WITH SEED, ITEM 65LJ5, APPLIED AT THE RATE OF 500 LBS./ACRE.
AGRICULTURAL LIMESTONE, ITEM 65L20, TO BE APPLIED AT THE RATE OF 2 TONS/ACRE, OR AS DIRECTED BY THE ENGINEER.
HAY MULCH, ITEM 65L25, TO BE PLACED ON EARTH SLOPES AT THE RATE OF 2 TONS/ACRE.
TOPSOIL, ITEM 65L35 TO BE USED WITH SEED, ITEM 65LJ5, AS DIRECTED BY THE ENGINEER.
4. EROSION CONTROL MATTING, ITEM 654J0, TO BE PLACED ON SLOPES OVER 5% WHEN DIRECTED BY THE ENGINEER.
5. PAY LIMITS FOR SEED, LIME, FERTILIZER & MULCH ARE EQUAL TO THE APPROVED CONSTRUCTION LIMITS.

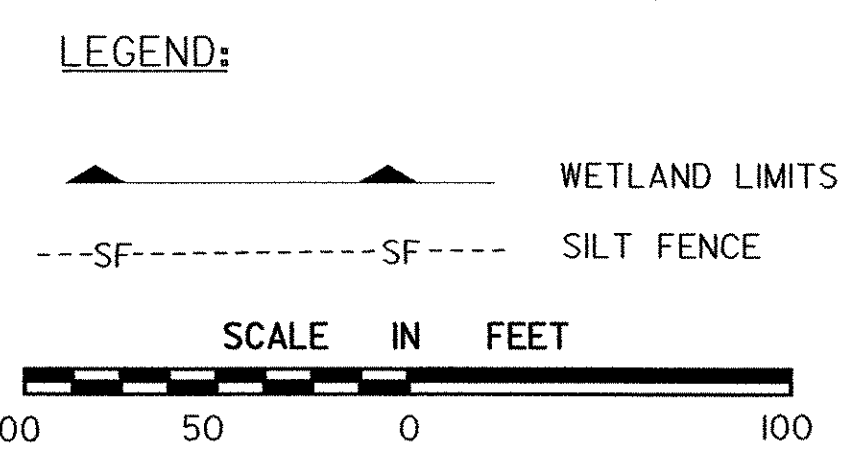

A.I.P. 3-50-0015-17

P:\ACTIV\Shelb\1\OCT2002\F202046000E37.dgn