



Route Log and Progress Chart

DRAFT

Please Note: Errors and Omissions May Exist.
Contact the VTrans Mapping Section with questions or concerns.

DISTRICT	TOWN	ROUTE
9	AVERILL	VT-114

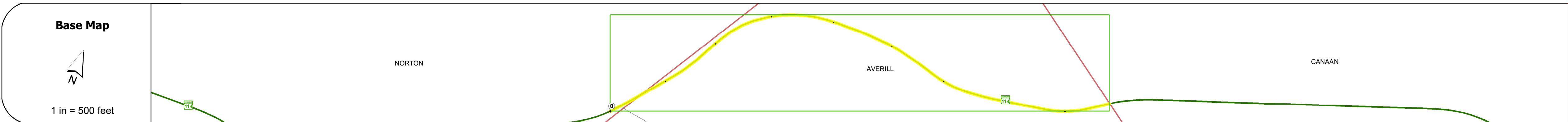
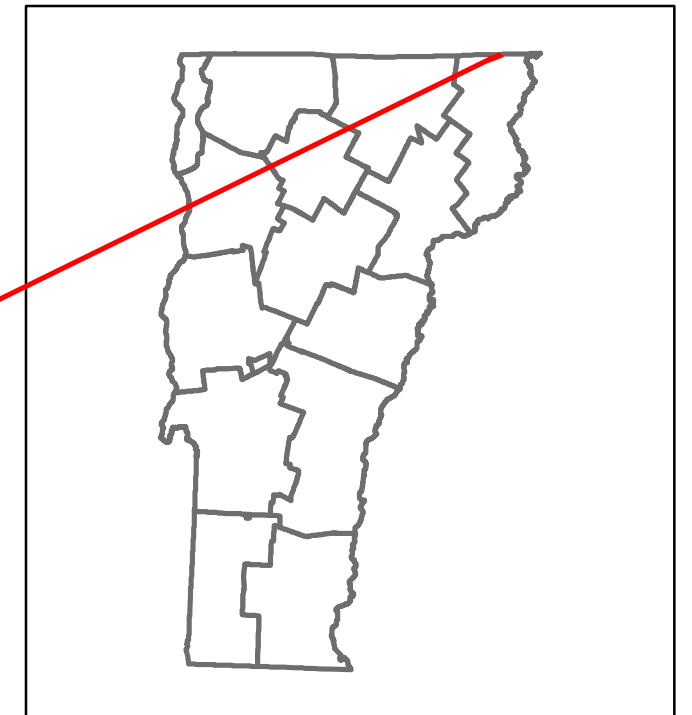

STRUCTURE DESCRIPTIONS

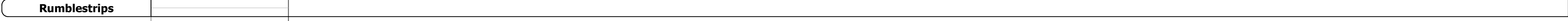
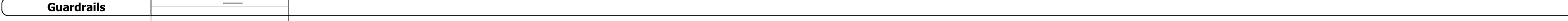
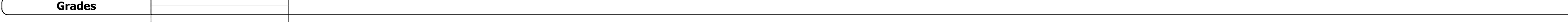
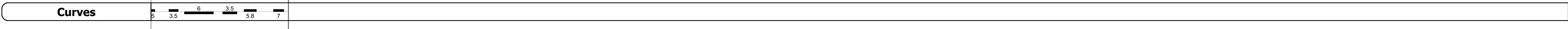
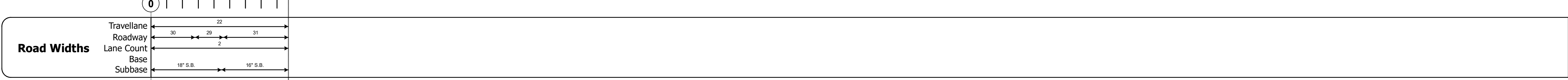

Maintenance Garage: District 9 - GMP Maintenance Brighton Garage

Speed Zone: 20

Functional Class: 5

National Highway System

Limited Access Highway

Customer Service Level: Local Connector

Traffic Counters

AAADT	2022	615
	2021	577
	2020	509
	2019	601
	2018	600

Crash Locations	(Incomplete) 2023	
	2022	
	2021	
	2020	
	2019	

Historic Projects Unknown, Retreatment, Resurface, Bituminous Mix, Skiny Mix, Bituminous Seal, Bituminous Concrete, Cold Plane and Concrete, Reclaimed Base and Bituminous Concrete, Surface Treated Gravel, Plant Mix, Bituminous Concrete	Functional Class 1 - Interstate System, 2 - Other Freeways and Expressways, 3 - Principal Arterial, 4 - Minor Arterial, 5 - Major Collector, 6 - Minor Collector	Curves Left (degrees), Right (degrees), Grades (percent) grade up, (percent) grade down	Traffic Counters Continuous (CTC), Weigh-In-Motion (WIM), Short-Term, Scheduled, Short-Term, Unscheduled (counter ID)	Crash Locations Fatal, Injury, Property Damage Only, Unknown Crash Type, High Crash Locations (HCL's) Sections (& Intersections)	Mileage by Functional Class By Sheet 0320 5 - Major Collector 0.872	Mileage by Town By Sheet AVERILL - V114-0501 0.872 of 0.872	DISTRICT 9	TOWN AVERILL	Date: 09/23/23	ROUTE VT-114 ETE mileage: 41.756 to 42.628
					Page Total Mileage: 0.872 mi	Page Total Mileage: 0.872 mi	1 of 1 TWN mileage: 0.0 to 0.872			

For More Information Contact - Vermont Agency of Transportation, Policy, Planning and Intermodal Development Division - Mapping Section, 219 North Main Street, Barre, VT 05641 Telephone: 802-828-2600.