



Route Log and Progress Chart

DRAFT

Please Note: Errors and Omissions May Exist.
Contact the VTrans Mapping Section with questions or concerns.

DISTRICT	TOWN	ROUTE
6	ORANGE	VT-110

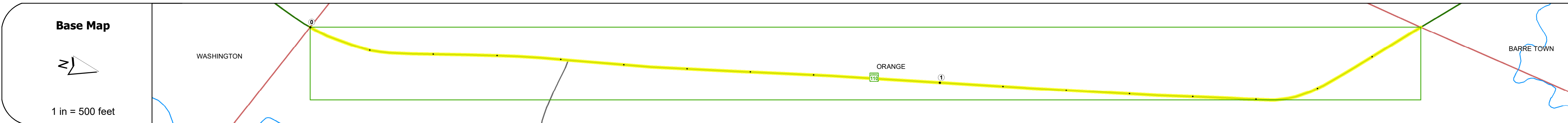
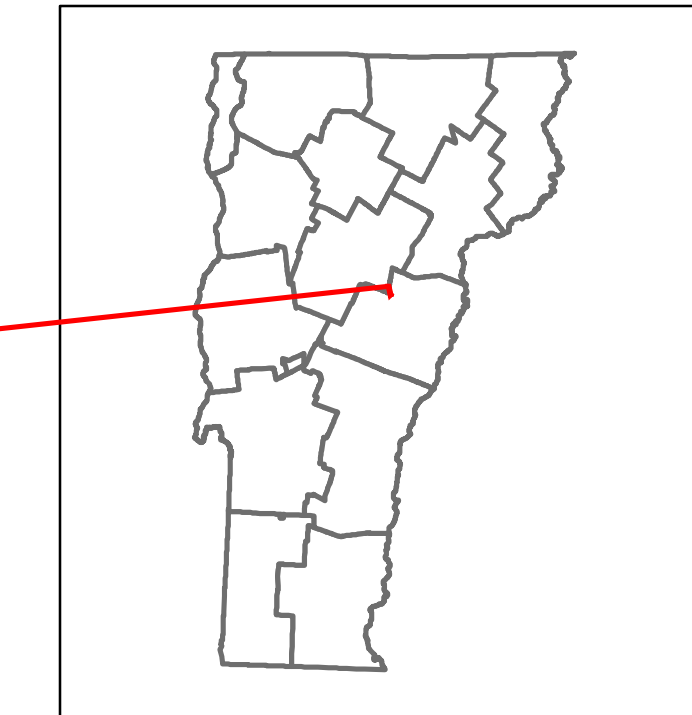

STRUCTURE DESCRIPTIONS

Road Widths	Travellane: 27, 26, 28 Roadway: 2 Lane Count: 2 Base: 12' S.B. Subbase: 12' S.B.
-------------	--

Curves	3, 5, 6
--------	---------

Grades	5.3
--------	-----

Guardrails	
------------	--

Rumblestrips	
--------------	--

Historic Projects	<ul style="list-style-type: none"> 2020: STP FPAV(37) 1999: STP 8744(1)S 1989: HMA 2022 1983: RS 0109(A) 1977: Unknown 1934: NRS 141
-------------------	--

Maintenance Garage	District 6 - DMF Maintenance No. Montpelier Garage
--------------------	--

Speed Zone	
------------	--

Functional Class	5
------------------	---

National Highway System	
-------------------------	--

Limited Access Highway	
------------------------	--

Customer Service Level	Local Connector
------------------------	-----------------

Traffic Counters	N126
------------------	------

AADT	<table border="1"> <tr> <td>2022</td> <td>1816</td> <td>1936</td> </tr> <tr> <td>2021</td> <td>1991</td> <td>1991</td> </tr> <tr> <td>2020</td> <td>1757</td> <td>1776</td> </tr> <tr> <td>2019</td> <td>2074</td> <td>2097</td> </tr> <tr> <td>2018</td> <td>2100</td> <td>2100</td> </tr> </table>	2022	1816	1936	2021	1991	1991	2020	1757	1776	2019	2074	2097	2018	2100	2100
2022	1816	1936														
2021	1991	1991														
2020	1757	1776														
2019	2074	2097														
2018	2100	2100														

Crash Locations	<table border="1"> <tr> <td>(Incomplete) 2023</td> <td></td> <td></td> </tr> <tr> <td>2022</td> <td>□</td> <td></td> </tr> <tr> <td>2021</td> <td>□</td> <td>□</td> </tr> <tr> <td>2020</td> <td>□</td> <td></td> </tr> <tr> <td>2019</td> <td>□</td> <td>□</td> </tr> </table>	(Incomplete) 2023			2022	□		2021	□	□	2020	□		2019	□	□
(Incomplete) 2023																
2022	□															
2021	□	□														
2020	□															
2019	□	□														

Historic Projects Unknown, Bituminous Concrete, Retreatment, Resurface, Bituminous Mix, Skiny Mix, Bituminous Seal, Surface Treated Gravel, Cold Plane and Plant Mix, Reclaimed Base and Bituminous Concrete, Concrete, Gravel	Functional Class 1- Interstate System, 2- Other Freeways and Expressways, 3- Principal Arterial, 4- Minor Arterial, 5- Major Collector, 6- Minor Collector	Curves Left (degrees), Right (degrees), Grades (percent) grade up, (percent) grade down	Traffic Counters Continuous (CTC), Weigh-In-Motion (WIM), Short-Term, Scheduled, Short-Term, Unscheduled (counter ID)	Crash Locations Fatal, Injury, Property Damage Only, Unknown Crash Type, High Crash Locations (HCL's) Sections (& Intersections)	Mileage by Functional Class By Sheet 0169 5 - Major Collector 1.790	Mileage by Town By Sheet ORANGE - V110-0908 1.79 of 1.79	DISTRICT 6	TOWN ORANGE	Date: 09/23/23	ROUTE VT-110 ETE mileage: 24.239 to 26.029
Page Total Mileage: 1.790 mi						Page Total Mileage: 1.79 mi				

For More Information Contact - Vermont Agency of Transportation, Policy, Planning and Intermodal Development Division - Mapping Section, 219 North Main Street, Barre, VT 05641 Telephone: 802-828-2600.