



Route Log and Progress Chart

DRAFT

Please Note: Errors and Omissions May Exist.
Contact the VTrans Mapping Section with questions or concerns.

DISTRICT	TOWN	ROUTE
8	FAIRFIELD	VT-36

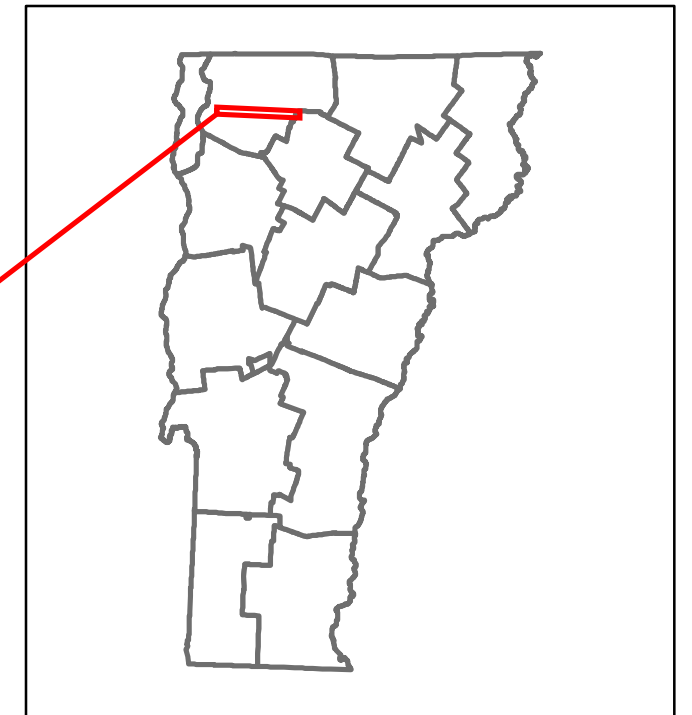

Base Map

1 in = 0.9 miles

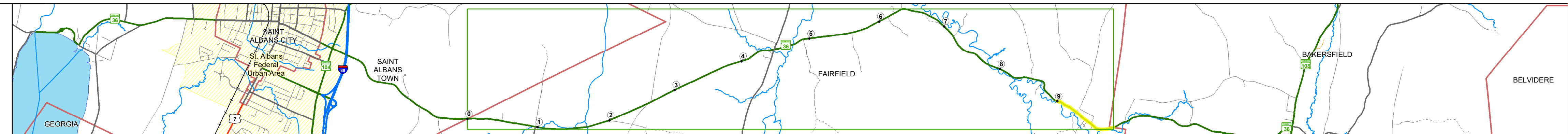

Stick Diagram

- Town Center
- Intersecting State Routes (excl. ramps/approaches)
- Other Intersecting Highways, Ramps, Approaches
- Railroad Crossings
- Primary Structures
- Secondary Structures
- Divided State Highway
- State Highway
- Divided Town Highway
- Town Highway
- Streams (Hydraulic Structure)
- Town Boundary
- District Boundaries
- State/Town Highway Change
- Divided Highway Limits
- Ghost Section Boundary
- Federal Urban Area Limits

Scale: 1 INCH = 2,000 FEET

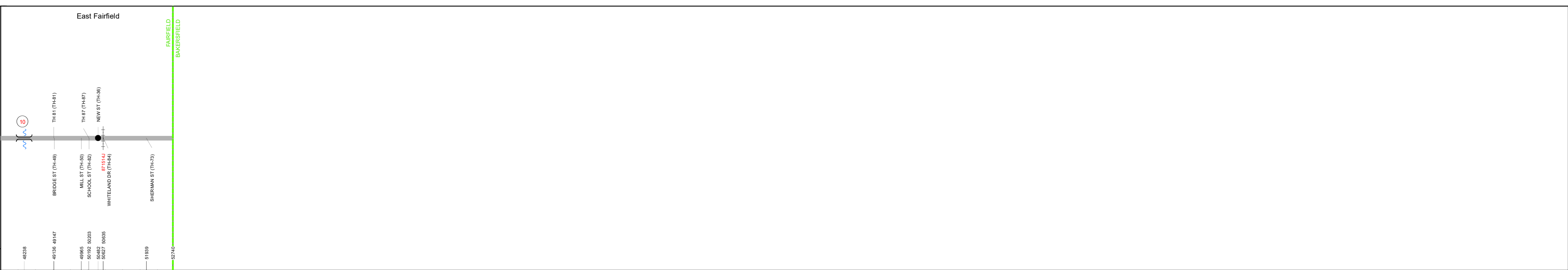

STRUCTURE DESCRIPTIONS

Bridge 10:
Slab - 1926
Structure No. 300298001006051
Length: 17'
Width: 27.0'
Under Clearance: 6.0'
Weight Limit: 0
Facility Carried: VT36
Structure Type: CONCRETE SLAB
Features Intersected: BROOK
Surface: Bituminous
Inspection Date: 11/2022
Maintenance: State

Road Widths	Travellane: 20
Roadway	24
Lane Count	2
Base	
Subbase	

Curves	12, 5, 11, 22, 9, 4
---------------	---------------------

Grades	
---------------	--

Guardrails	
-------------------	--

Rumblestrips	
---------------------	--

Historic Projects	<ul style="list-style-type: none"> 2001: STP 212W(1)S 1988: HMA 2866 1982: HMA 2310 1973: Unknown 1950: S 53(3) 1956: S 53(3)
--------------------------	---

Maintenance Garage	District 8 - DMF Maintenance St Albans Garage
---------------------------	---

Speed Zone	35
-------------------	----

Functional Class	5
-------------------------	---

National Highway System	
--------------------------------	--

Limited Access Highway	
-------------------------------	--

Customer Service Level	Local Connector
-------------------------------	-----------------

Traffic Counters	
-------------------------	--

AADT	2022: 1874
	2021: 1709
	2020: 1508
	2019: 1780
	2018: 1800 to 1600

Crash Locations	<ul style="list-style-type: none"> (Incomplete) 2023: HCL Section 2022: No. 87 2021: [] 2020: [] 2019: []
------------------------	---

<p>Historic Projects</p> <ul style="list-style-type: none"> Unknown Retreatment Resurface Bituminous Mix Skinny Mix Bituminous Seal 	<p>Functional Class</p> <ul style="list-style-type: none"> 1 - Interstate System 2 - Other Freeways and Expressways 3 - Principal Arterial 4 - Minor Arterial 5 - Major Collector 6 - Minor Collector 	<p>Curves</p> <ul style="list-style-type: none"> Left (degrees) Right (degrees) 	<p>Grades</p> <ul style="list-style-type: none"> Left (percent) grade up Right (percent) grade down 	<p>Traffic Counters</p> <ul style="list-style-type: none"> Continuous (CTC) Weight-In-Motion (WIM) Short-Term, Scheduled Short-Term, Unscheduled 	<p>Crash Locations</p> <ul style="list-style-type: none"> Fatal Injury Property Damage Only Unknown Crash Type 	<p>Mileage by Functional Class By Sheet</p> <p>0298 5 - Major Collector 0.989</p>	<p>Mileage by Town By Sheet</p> <p>FAIRFIELD - V036-0605 0.989 of 9.989</p>	<p>DISTRICT</p> <p>8</p>	<p>TOWN</p> <p>FAIRFIELD</p>	<p>Date: 09/22/23</p>	<p>ROUTE</p> <p>VT-36</p> <p>ETE mileage: 15.707 to 16.696</p>
<p>Indicated plans available - http://vtransmap01.aot.state.vt.us/p/dcr/DWebstore/</p>						<p>Page Total Mileage: 0.989 mi</p>	<p>Page Total Mileage: 0.989 mi</p>	<p>2 of 2</p> <p>TWN mileage: 9.0 to 9.989</p>			

For More Information Contact - Vermont Agency of Transportation, Policy, Planning and Intermodal Development Division - Mapping Section, 219 North Main Street, Barre, VT 05641 Telephone: 802-828-2600.