

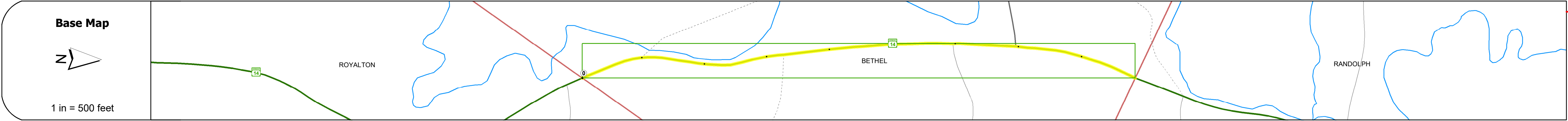

Route Log and Progress Chart

**DRAFT**  
Please Note: Errors and Omissions May Exist.  
Contact the VTrans Mapping Section with questions or concerns.

DISTRICT	TOWN	ROUTE
4	BETHEL	VT-14

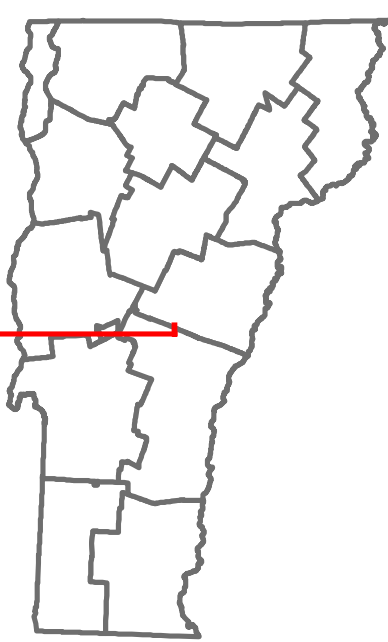

Road Widths	Travellane Roadway Lane Count Base Subbase
-------------	--

Curves	7 9
--------	--------

Grades	
--------	--

Guardrails	
------------	--

Rumblestrips	
--------------	--

Historic Projects	<div>1983: STP 9320(1)S</div> <div>1983: RS 0147(9)</div> <div>1976: Unknown</div> <div>1980: ST</div> <div>1927: FAP 80-B</div>
-------------------	--

Maintenance Garage	District 4 - DMF Maintenance Royalton Garage
--------------------	--

Speed Zone	
------------	--

Functional Class	5
------------------	---

National Highway System	
-------------------------	--

Limited Access Highway	
------------------------	--

Customer Service Level	Local Connector
------------------------	-----------------

Traffic Counters	
------------------	--

AADT	2024 2023 2022 2021 2020
------	--------------------------------------

Crash Locations	(Incomplete) 2025 2024 2023 2022 2021
-----------------	---

STRUCTURE DESCRIPTIONS

Unknown

Retreatment

Resurface

Bituminous Mix

Skinny Mix

Bituminous Seal

Bituminous Concrete

Cold Plane and Bituminous Concrete

Concrete

Surface Treated Gravel

Plant Mix

Reclaimed Base and Bituminous Concrete

1 - Interstate System

2 - Other Freeways and Expressways

3 - Principal Arterial

4 - Minor Arterial

5 - Major Collector

6 - Minor Collector

Speed Zones

25 30 35 40 45 50 55 60 65

Curves

Grades

Road Widths

Traffic Counters

AADT

Crash Locations

High Crash Locations (HCL's)

Mileage by Functional Class By Sheet

Mileage by Town By Sheet

DISTRICT

TOWN

Date: 11/22/25

ROUTE

4

BETHEL

1 of 1

ETE mileage: 24.521 to 25.411

0147

5 - Major Collector

0.890

BETHEL - V014-1404

0.89 of 0.89

Page Total Mileage: 0.890 mi

Page Total Mileage: 0.89 mi

For More Information Contact - Vermont Agency of Transportation, Policy, Planning and Intermodal Development Division - Mapping Section, 219 North Main Street, Barre, VT 05641 Telephone: 802-828-2600.