

DISTRICT	TOWN	ROUTE
7	GROTON	US-302

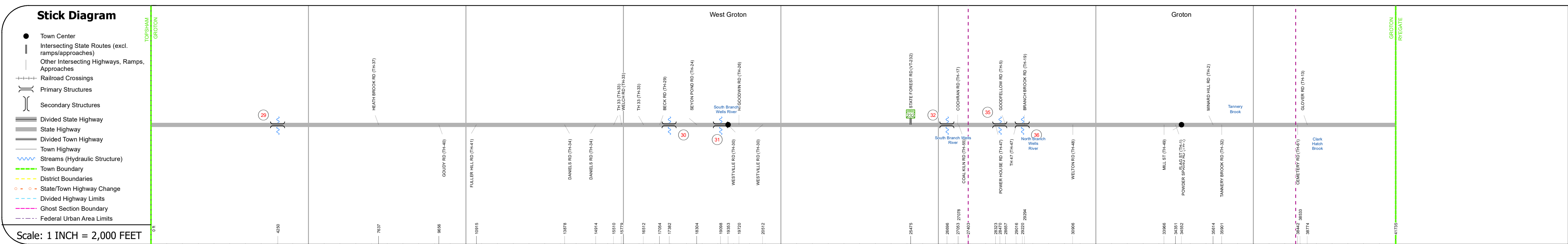
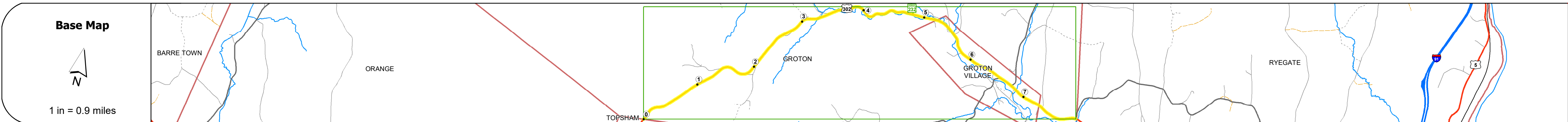
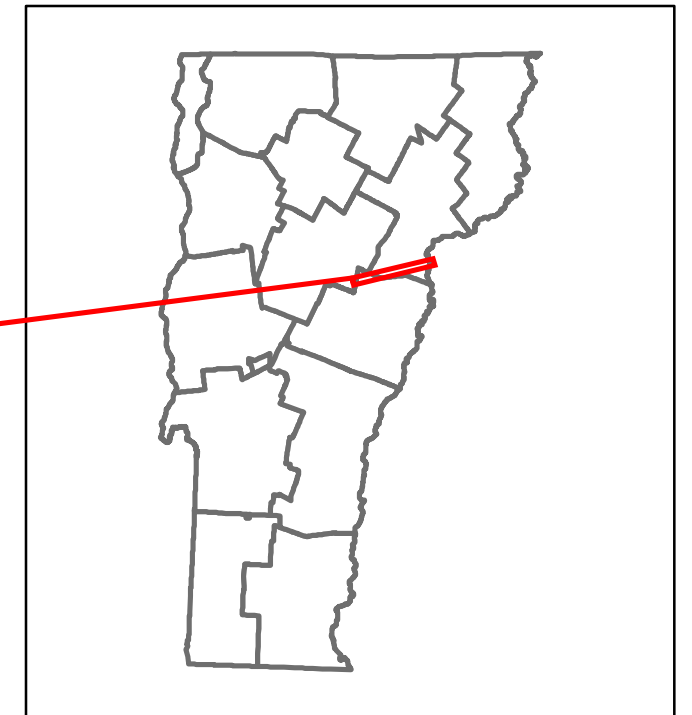

Road Widths	Travellane, Roadway, Lane Count, Base, Subbase	12" - 18" S.B., 18" - 24" S.B., 24" Cr. Gravel, 3" P.M., 24" Cr. Gravel, 12" - 18" S.B., 12" S.B., 24" Crushed Stone
Curves		4, 7, 5, 3, 7, 5, 3, 4, 3, 9, 16, 18, 10, 16, 14, 5, 2.8, 8, 6, 4, 11, 4, 2.5, 4.5, 5.5
Grades		-7.4, -8.4, -6.9, -8.0, -5.7, -7.7, -8.0, -5.2A, -8.1A, -5.8A, -5.9A, -3.2, -3.9A, -5.5A, -6.4, -7.0, +5.4, -3.1A
Guardrails		
Rumblestrips		
Historic Projects		1995 STP 9431(1)S, 1984 HMA 2526, 1980 ROS 026-1(16), 1976 TGF 026-1(15), 1971 Unknown, 1973 Unknown, 1980 F BR F 026-1(20), 1982 FR 026-1(25)S, 1991 BR F 026-1(27)S, 2020 STP CULV(72), 1995 STP 9432(1)S, 2010 STP SURF(16), 1998 STP F 026-1(30)
Maintenance Garage		District 7 - DMF Maintenance Newbury Garage
Speed Zone		40, 30, 35
Functional Class		4
National Highway System		
Limited Access Highway		
Customer Service Level		Regional Corridor
Traffic Counters		C120, C121
AADT	2022, 2021, 2020, 2019, 2018	1598, 1530, 1350, 1504, 1600, 1587, 1574, 1534, 1811, 2000, 2078, 2062, 1820, 2149, 2400, 2325, 2752, 2429, 2868, 2900, 2900
Crash Locations	(Incomplete) 2023, 2022, 2021, 2020, 2019	HCL Section No. 335, HCL Section No. 648

STRUCTURE DESCRIPTIONS

Bridge 29:
Culvert - 1937
Structure No. 300026002903041
Length: 9'
Under Clearance: 6.0'
Weight Limit: 0
Facility Carried: US302
Structure Type: RC BOX
Features Intersected: BROOK
Inspection Date: 11/2020
Maintenance: State

Bridge 30:
Culvert - 1934
Structure No. 300026003003041
Length: 9'
Under Clearance: 7.0'
Weight Limit: 0
Facility Carried: US302
Structure Type: RC BOX
Features Intersected: BROOK
Inspection Date: 10/2020
Maintenance: State

Bridge 31:
Stringer/multi-beam or girder - 1980
Structure No. 200026003103042
Length: 60'
Height: 100.0'
Width: 33.0'
Weight Limit: 0
Facility Carried: US 00302 ML
Structure Type: ROLLED BEAM
Features Intersected: SOUTH BRANCH WELLS RIVER
Surface: Bituminous
Inspection Date: 7/2021
Maintenance/Ownership: State

Bridge 32:
Stringer/multi-beam or girder - 1990
Structure No. 200026003203042
Length: 64'
Height: 100.0'
Width: 39.0'
Weight Limit: 0
Facility Carried: US 00302 ML
Structure Type: ROLLED BEAM
Features Intersected: SOUTH BRANCH WELLS RIVER
Surface: Bituminous
Inspection Date: 7/2021
Maintenance/Ownership: State

Bridge 35:
Stringer/multi-beam or girder - 1980
Structure No. 200026003503042
Length: 120'
Height: 100.0'
Width: 40.0'
Weight Limit: 0
Facility Carried: US 00302 ML
Structure Type: WELDED PLATE GIRDER
Features Intersected: WELLS RIVER
Surface: Bituminous
Inspection Date: 7/2021
Maintenance/Ownership: State

Bridge 36:
Tie Beam - 1925
Structure No. 200026003603042
Length: 25'
Height: 100.0'
Width: 27.0'
Weight Limit: 0
Facility Carried: US 00302 ML
Structure Type: T-BEAM WIDEN W SLAB
Features Intersected: NORTH BRANCH WELLS RIVER
Surface: Bituminous
Inspection Date: 7/2021
Maintenance/Ownership: State

Historic Projects <ul style="list-style-type: none"> Unknown Retreatment Resurface Bituminous Mix Skinny Mix Bituminous Seal 	Functional Class <ul style="list-style-type: none"> 1 - Interstate System 2 - Other Freeways and Expressways 3 - Principal Arterial 4 - Minor Arterial 5 - Major Collector 6 - Minor Collector 	Curves <ul style="list-style-type: none"> Left Right 	Grades <ul style="list-style-type: none"> Special grade up Special grade down 	Traffic Counters <ul style="list-style-type: none"> Continuous (CTC) Weigh-In-Motion (WIM) Short-Term, Scheduled Short-Term, Unscheduled 	Crash Locations <ul style="list-style-type: none"> Fatal Injury Property Damage Only Unknown Crash Type 	Mileage by Functional Class By Sheet 026-1 4 - Minor Arterial 7.904	Mileage by Town By Sheet GROTON - U302-0304 7.904 of 7.904	DISTRICT 7	TOWN GROTON	Date: 09/27/23	ROUTE US-302 ETE mileage: 19.103 to 27.007
Speed Zones 25, 30, 35, 40, 45, 50, 55, 60, 65						Page Total Mileage: 7.904 mi		Page Total Mileage: 7.904 mi		1 of 1 TWN mileage: 0.0 to 7.904	