



Route Log and Progress Chart

DRAFT

Please Note: Errors and Omissions May Exist.
Contact the VTrans Mapping Section with questions or concerns.

DISTRICT	TOWN	ROUTE
4	HARTFORD	US-5

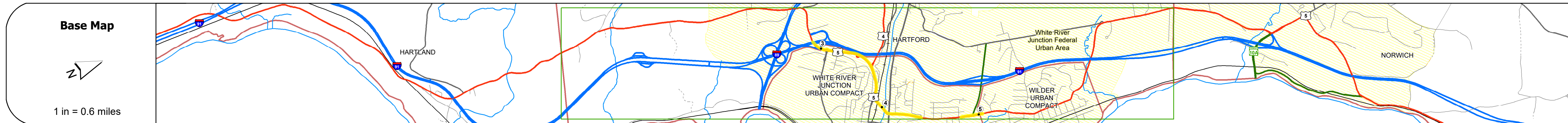
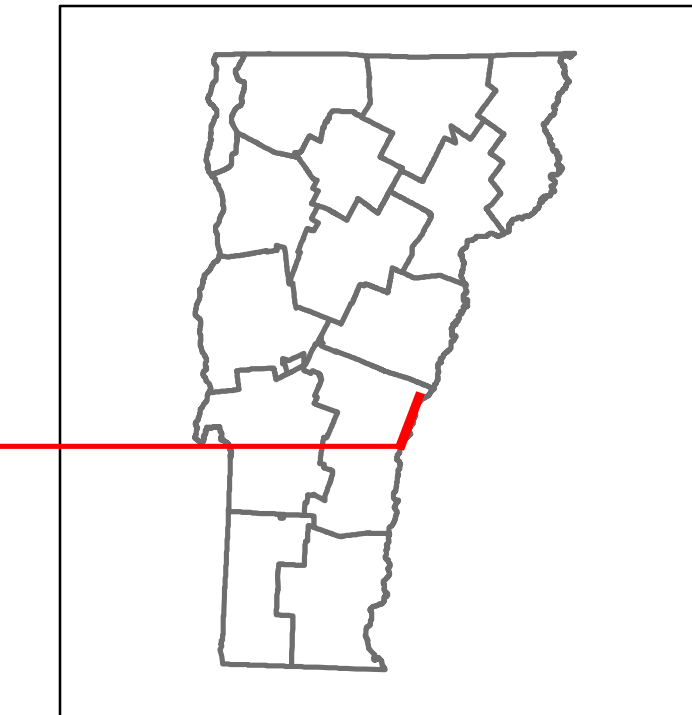

Stick Diagram

- Town Center
- Intersecting State Routes (excl. ramps/approaches)
- Other Intersecting Highways, Ramps, Approaches
- Railroad Crossings
- Primary Structures
- Secondary Structures
- ▬ Divided State Highway
- ▬ State Highway
- ▬ Divided Town Highway
- ▬ Town Highway
- ▬ Streams (Hydraulic Structure)
- ▬ Town Boundary
- ▬ District Boundaries
- ▬ State/Town Highway Change
- ▬ Divided Highway Limits
- ▬ Ghost Section Boundary
- ▬ Federal Urban Area Limits

Scale: 1 INCH = 2,000 FEET

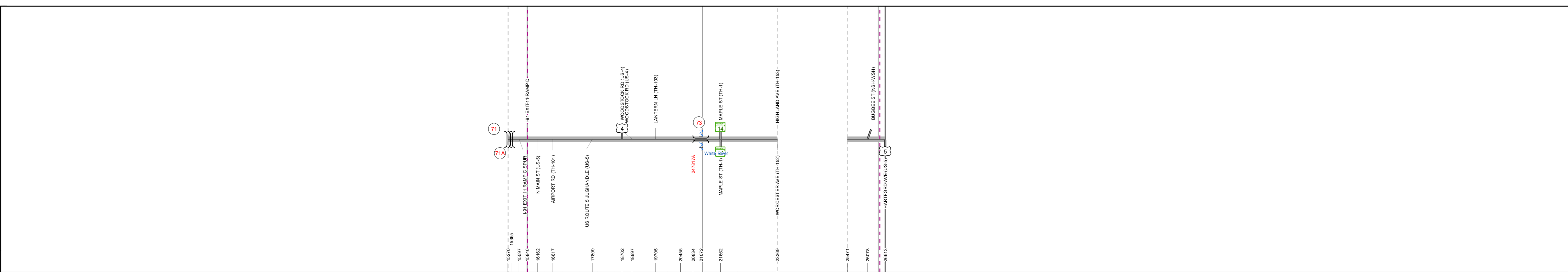

STRUCTURE DESCRIPTIONS

Unknown 71:
Unknown
Structure No. 200091043S14082
Structure Type: Unknown

Unknown 71A:
Unknown
Structure No. 200091043N14082
Structure Type: Unknown

Bridge 73:
Stringer/multi-beam or girder - 1968
Structure No. 200113007314082
Length: 979'
Height: 100.0'
Width: 57.0'
Under Clearance: 23.0'
Weight Limit: 0
Facility Carried: US 05 ML
Structure Type: 6 SP CONT WLD GIRDER
Features Intersected: US 5 OVER WHI R + NECRR
Surface: Bituminous
Inspection Date: 7/2021
Maintenance/Ownership: State

Road Widths	Travellane	Roadway	Lane Count	Base	Subbase
	15	24	24	24	24
	16	28	28	28	28
	17	28	28	28	28
	18	28	28	28	28
	19	28	28	28	28
	20	28	28	28	28
	21	28	28	28	28
	22	28	28	28	28

Curves	Station	Radius
	15+00	8
	17+00	7
	18+00	10
	19+00	8
	20+00	5
	21+00	4
	22+00	17.5

Grades	Station	Grade (%)
	15+00	0.0
	16+00	0.0
	17+00	0.0
	18+00	0.0
	19+00	0.0
	20+00	0.0
	21+00	0.0
	22+00	0.0

Guardrails	Station	Type
	15+00	H
	16+00	H
	17+00	H
	18+00	H
	19+00	H
	20+00	H
	21+00	H
	22+00	H

Rumblestrips	Station	Type
	15+00	
	16+00	
	17+00	
	18+00	
	19+00	
	20+00	
	21+00	
	22+00	

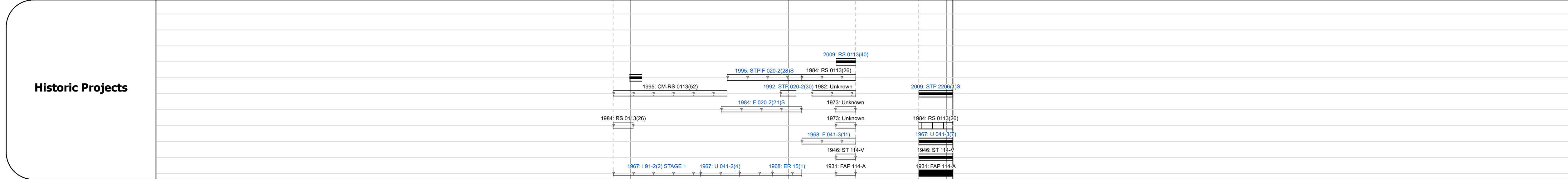

Maintenance Garage	Station	Garage Name
	18+00	District 4 - DMF Maintenance White River Garage

Speed Zone	Station	Speed Limit (mph)
	15+00	55
	16+00	55
	17+00	55
	18+00	55
	19+00	55
	20+00	55
	21+00	55
	22+00	55

Functional Class	Station	Class
	15+00	5 - Major Collector
	16+00	4 - Minor Arterial
	17+00	5 - Major Collector
	18+00	5 - Major Collector
	19+00	5 - Major Collector
	20+00	5 - Major Collector
	21+00	5 - Major Collector
	22+00	5 - Major Collector

National Highway System	Station	Status
	15+00	Partial
	16+00	Partial
	17+00	Partial
	18+00	Partial
	19+00	Partial
	20+00	Partial
	21+00	Partial
	22+00	Partial

Limited Access Highway	Station	Status
	15+00	None
	16+00	None
	17+00	None
	18+00	None
	19+00	None
	20+00	None
	21+00	None
	22+00	None

Customer Service Level	Station	Level
	15+00	Arterial Highway
	16+00	Regional/Corridor/Local Connector
	17+00	Regional/Corridor/Local Connector
	18+00	Regional/Corridor/Local Connector
	19+00	Regional/Corridor/Local Connector
	20+00	Regional/Corridor/Local Connector
	21+00	Regional/Corridor/Local Connector
	22+00	Local Connector

Traffic Counters	Station	Counter ID
	15+00	37223725
	16+00	63775674
	17+00	26914583
	18+00	69155589

AADT	Year	Station	Value
	2022	15+00	37223725
	2021	15+00	63775674
	2020	15+00	26914583
	2019	15+00	69155589
	2018	15+00	69155589

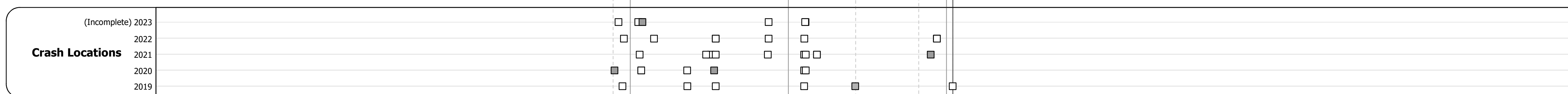

Historic Projects Unknown, Bituminous Concrete, Retreatment, Resurface, Bituminous Mix, Skiny Mix, Bituminous Seal, Surface Treated Gravel, Plant Mix, Reclaimed Base and Bituminous Concrete	Functional Class 1- Interstate System, 2- Other Freeways and Expressways, 3- Principal Arterial, 4- Minor Arterial, 5- Major Collector, 6- Minor Collector	Curves Left (degrees), Right (degrees), Grades (percent) grade up, (percent) grade down	Traffic Counters Continuous (CTC), Weigh-In-Motion (WIM), Short-Term, Scheduled, Short-Term, Unscheduled (counter ID)	Crash Locations Fatal, Injury, Property Damage Only, Unknown Crash Type, High Crash Locations (HCL's)	Mileage by Functional Class By Sheet 020-2 4 - Minor Arterial, 0113 5 - Major Collector, 0.560, 1.190	Mileage by Town By Sheet HARTFORD - U005-1408S, 1.75 of 1.75	DISTRICT 4	TOWN HARTFORD	Date: 09/27/23	ROUTE US-5
					Speed Zones 25, 30, 35, 40, 45, 50, 55, 60, 65	Page Total Mileage: 1.750 mi				