



Route Log and Progress Chart

DRAFT

Please Note: Errors and Omissions May Exist.
Contact the VTrans Mapping Section with questions or concerns.

DISTRICT	TOWN	ROUTE
5	SOUTH BURLINGTON	Urb-5206

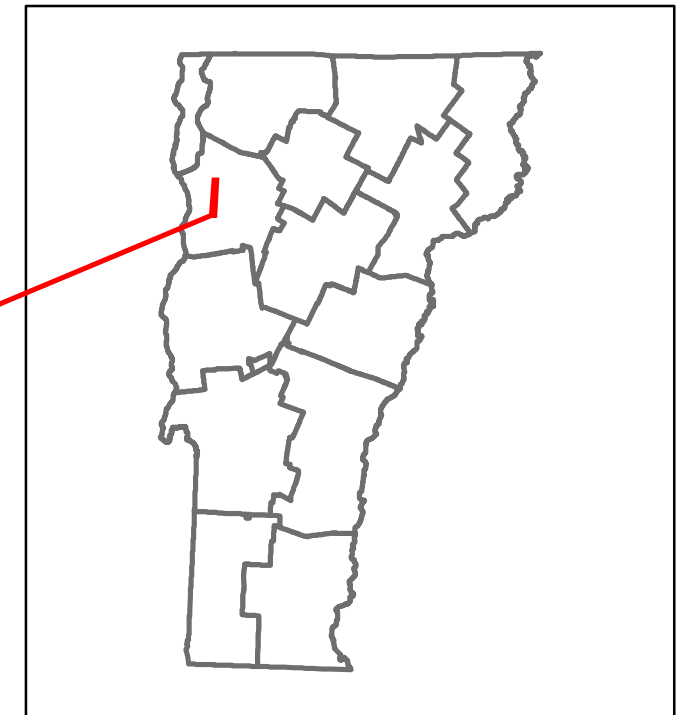

Urb-5206

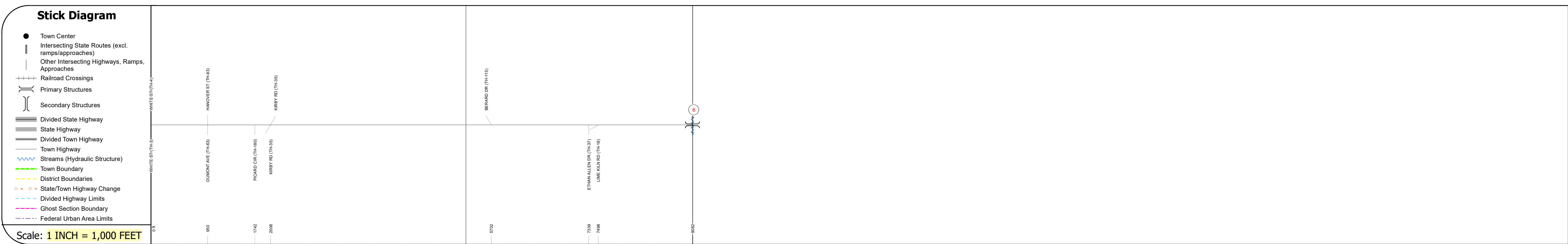
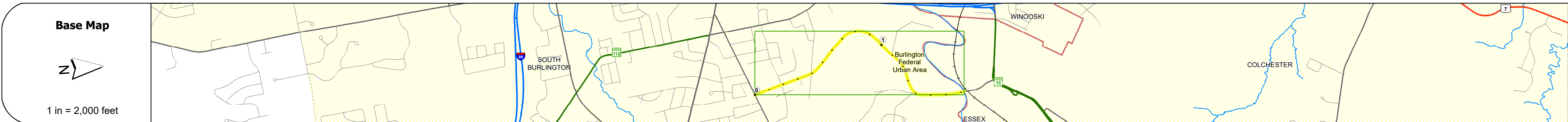

STRUCTURE DESCRIPTIONS	
Bridge 6:	Arch - deck - 2006
Structure No:	205206000604142
Length:	298'
Height:	100.0'
Width:	40.0'
Under Clearance:	24.0'
Weight Limit:	0
Facility Carried:	LIME KILN RD TH4
Structure Type:	OPEN SPAN CONC ARCH
Features Intersected:	WINOOSKI RIVER + NECRR
Surface:	Bituminous
Inspection Date:	7/2022
Maintenance/Ownership:	City/Municipal

Road Widths	Travellane	Roadway	Lane Count	Base	Subbase
	30	22	2	26	34

Curves	4.4
--------	-----

Grades

Guardrails

Rumblestrips



Maintenance Garage

Speed Zone

Functional Class	4
------------------	---

National Highway System

Limited Access Highway

Customer Service Level

Traffic Counters	D331
------------------	------

AA DT	2022	6642
	2021	6583
	2020	5872
	2019	7135
	2018	7500

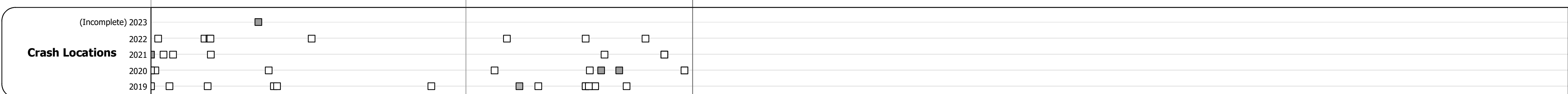

Historic Projects Unknown, Retreatment, Resurface, Bituminous Mix, Skiny Mix, Bituminous Seal, Bituminous Concrete, Cold Plane and Reclaimed Base and Bituminous Concrete, Surface Treated Gravel, Plant Mix, Reclaimed Base and Bituminous Concrete	Functional Class 1 - Interstate System, 2 - Other Freeways and Expressways, 3 - Principal Arterial, 4 - Minor Arterial, 5 - Major Collector, 6 - Minor Collector	Curves Left, Right, Grades (up/down), Road Widths (ft)	Traffic Counters Continuous (CTC), Weigh-In-Motion (WIM), Short-Term, Scheduled, Short-Term, Unscheduled	Crash Locations Fatal, Injury, Property Damage Only, Unknown Crash Type, High Crash Locations (HCL's)	Mileage by Functional Class By Sheet 5206 4 - minor Arterial 1.720	Mileage by Town By Sheet SOUTH BURLINGTON - 552060414 1.72 of 1.72	DISTRICT 5	TOWN SOUTH BURLINGTON	Date: 09/28/23	ROUTE Urb-5206
					Page Total Mileage: 1.720 mi	Page Total Mileage: 1.72 mi	1 of 1 TWN mileage: 0.0 to 1.72	ETE mileage: 0.0 to 1.72		

For More Information Contact - Vermont Agency of Transportation, Policy, Planning and Intermodal Development Division - Mapping Section, 219 North Main Street, Barre, VT 05641 Telephone: 802-828-2600.