



Route Log and Progress Chart

DRAFT

Please Note: Errors and Omissions May Exist.
Contact the VTrans Mapping Section with questions or concerns.

DISTRICT	TOWN	ROUTE
9	DERBY	Min-0822

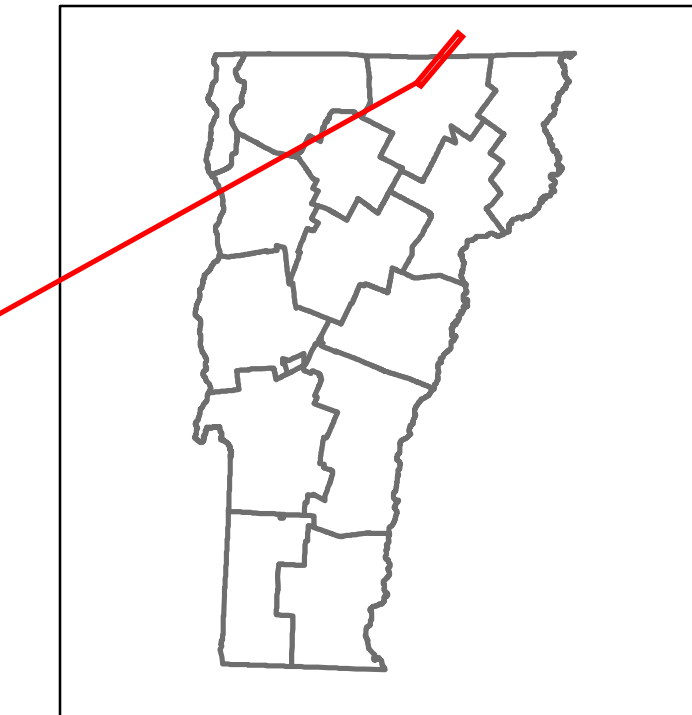

Min-0822

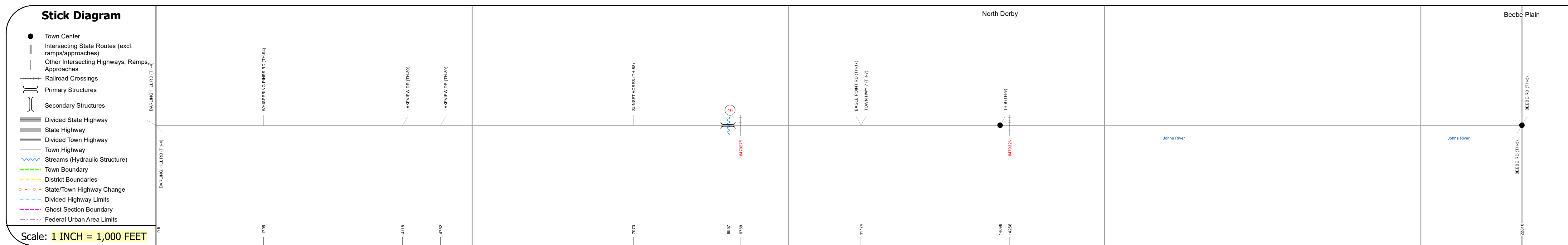
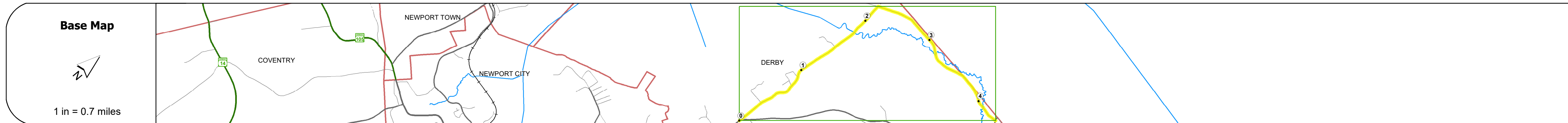

STRUCTURE DESCRIPTIONS	
Bridge 19:	
Slab - 2021	
Structure No. 101007001910071	
Length: 54'	
Height: 100.0'	
Width: 27.0'	
Weight Limit: 0	
Facility Carried: C2006	
Structure Type: PRESTRESS CONC SLAB	
Features Intersected: JOHNS RIVER	
Surface: Bituminous	
Inspection Date: 10/2022	
Maintenance/Ownership: Town	

0	1	2	3	4
Road Widths				
Travellane				
Roadway				
Lane Count				
Base				
Subbase				
Curves				
Grades				
Guardrails				
Rumblestrips				
Historic Projects				
Maintenance Garage				
Speed Zone				
Functional Class				
National Highway System				
Limited Access Highway				
Customer Service Level				
Traffic Counters				
AAADT				
2022				
2021				
2020				
2019				
2018				
Crash Locations				
(Incomplete) 2023				
2022				
2021				
2020				
2019				

Historic Projects Unknown, Bituminous Concrete, Retreatment, Resurface, Bituminous Mix, Skiny Mix, Bituminous Seal Surface Treated Gravel, Cold Plane and Bituminous Concrete, Reclaimed Base and Bituminous Concrete, Plant Mix	Functional Class 1- Interstate System, 2- Other Freeways and Expressways, 3- Principal Arterial, 4- Minor Arterial, 5- Major Collector, 6- Minor Collector	Curves Left, Right, Grades (degrees), Left, Right, grade up, grade down	Traffic Counters Continuous (CTC), Weigh-In-Motion (WIM), Short-Term, Scheduled, Short-Term, Unscheduled	Crash Locations Fatal, Injury, Property Damage Only, Unknown Crash Type, High Crash Locations (HCL's)	Mileage by Functional Class By Sheet 0822 6 - minor collector 4.320	Mileage by Town By Sheet DERBY - S08221007 4.32 of 4.32	DISTRICT 9	TOWN DERBY	Date: 09/27/23	ROUTE Min-0822
					Page Total Mileage: 4.320 mi	Page Total Mileage: 4.32 mi	1 of 1 TWN mileage: 0.0 to 4.32	ETE mileage: 0.0 to 4.32		

For More Information Contact - Vermont Agency of Transportation, Policy, Planning and Intermodal Development Division - Mapping Section, 219 North Main Street, Barre, VT 05641 Telephone: 802-828-2600.