



Route Log and Progress Chart

DRAFT

Please Note: Errors and Omissions May Exist.
Contact the VTrans Mapping Section with questions or concerns.

DISTRICT	TOWN	ROUTE
9	GLOVER	Min-0776

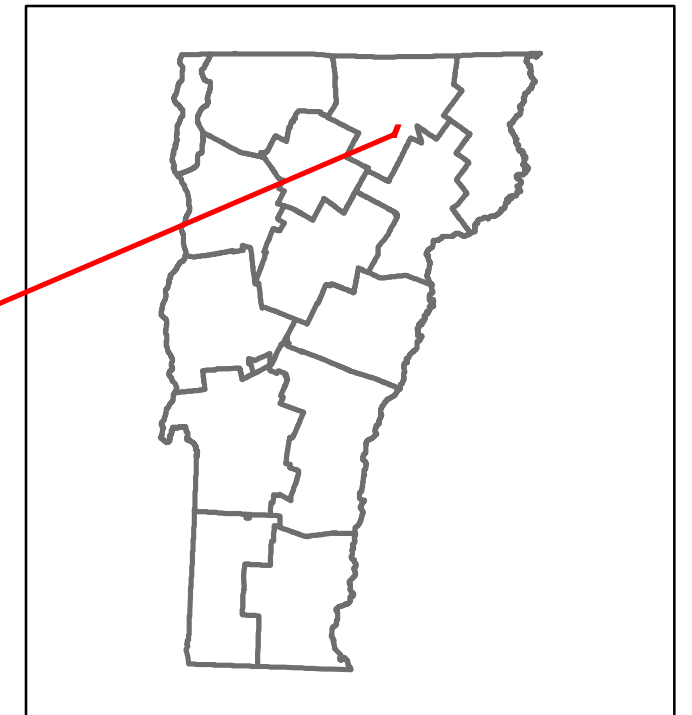

Min-0776

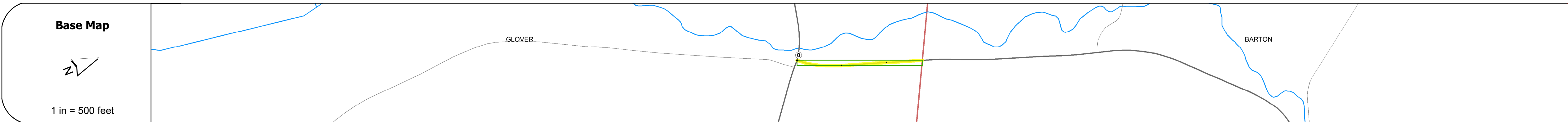

Road Widths	Travellane: 22
Roadway	22
Lane Count	2
Base	
Subbase	

Curves	
---------------	--

Grades	
---------------	--

Guardrails	
-------------------	--

Rumblestrips	
---------------------	--

Historic Projects	
--------------------------	--

Maintenance Garage	
---------------------------	--

Speed Zone	
-------------------	--

Functional Class	6
-------------------------	---

National Highway System	
--------------------------------	--

Limited Access Highway	
-------------------------------	--

Customer Service Level	
-------------------------------	--

Traffic Counters	
-------------------------	--

AAADT	2022	
	2021	
	2020	
	2019	
	2018	

Crash Locations	(Incomplete) 2023	
	2022	
	2021	
	2020	
	2019	

STRUCTURE DESCRIPTIONS	

Historic Projects Unknown, Retreatment, Resurface, Bituminous Mix, Skippy Mix, Bituminous Seal, Concrete, Surface Treated Gravel, Plant Mix, Reclaimed Base and Bituminous Concrete	Functional Class 1- Interstate System, 2- Other, 3- Principal Arterial, 4- Minor Arterial, 5- Major Collector, 6- Minor Collector	Curves Left, Right, Grades (degrees), Left, Right, grade up, grade down	Traffic Counters Continuous (CTC), Weigh-In-Motion (WIM), Short-Term, Scheduled, Short-Term, Unscheduled	Crash Locations Fatal, Injury, Property Damage Only, Unknown Crash Type, High Crash Locations (HCL's)	Mileage by Functional Class By Sheet 0776 6 - minor collector 0.280	Mileage by Town By Sheet GLOVER - S07761008 0.28 of 0.28	DISTRICT 9	TOWN GLOVER	Date: 09/27/23	ROUTE Min-0776
					Page Total Mileage: 0.280 mi	Page Total Mileage: 0.28 mi	1 of 1 TWN mileage: 0.0 to 0.28	ETE mileage: 0.0 to 0.28		

For More Information Contact - Vermont Agency of Transportation, Policy, Planning and Intermodal Development Division - Mapping Section, 219 North Main Street, Barre, VT 05641 Telephone: 802-828-2600.