



Route Log and Progress Chart

DRAFT

Please Note: Errors and Omissions May Exist.
Contact the VTrans Mapping Section with questions or concerns.

DISTRICT	TOWN	ROUTE
6	STOWE	Min-0746

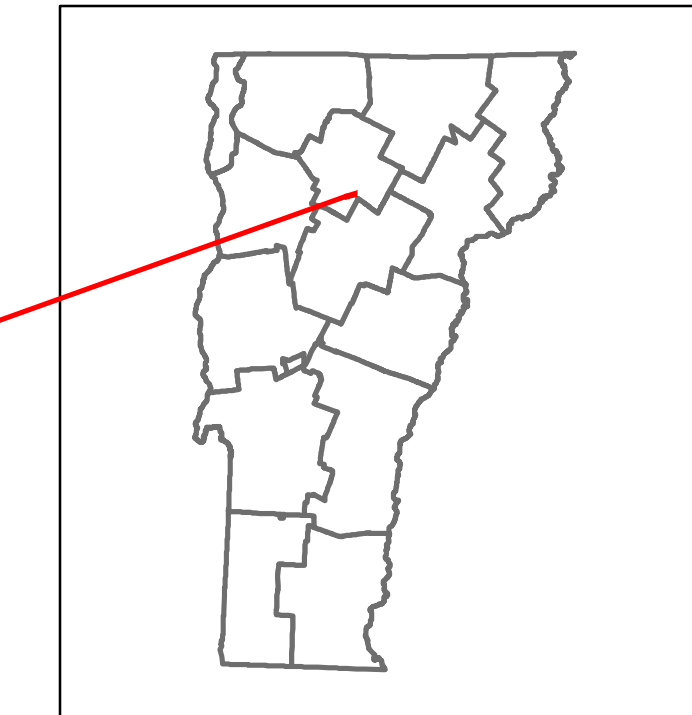

Min-0746

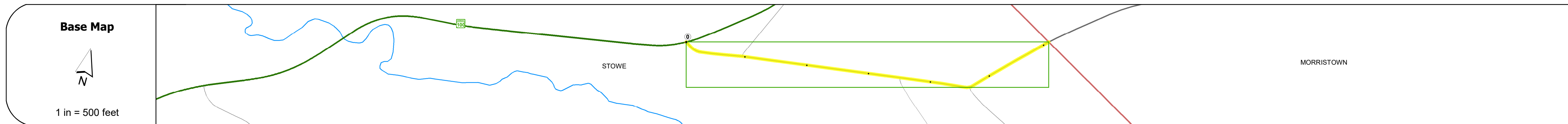

Road Widths	Travellane	Roadway	Lane Count	Base	Subbase
	22	22	2		

Curves	-
---------------	---

Grades	
---------------	--

Guardrails	
-------------------	--

Rumblestrips	
---------------------	--

Historic Projects	2017: Town Project
--------------------------	--------------------

Maintenance Garage	
---------------------------	--

Speed Zone	
-------------------	--

Functional Class	6
-------------------------	---

National Highway System	
--------------------------------	--

Limited Access Highway	
-------------------------------	--

Customer Service Level	
-------------------------------	--

Traffic Counters	
-------------------------	--

AADT	2022	
	2021	
	2020	
	2019	
	2018	

Crash Locations	(Incomplete) 2023	
	2022	
	2021	
	2020	
	2019	

STRUCTURE DESCRIPTIONS	

Historic Projects Unknown, Retreatment, Resurface, Bituminous Mix, Skiny Mix, Bituminous Seal Bituminous Concrete, Cold Plane and Bituminous Concrete, Concrete, Surface Treated Gravel, Plant Mix, Reclaimed Base and Bituminous Concrete	Functional Class 1- Interstate System, 2- Other, 3- Principal Arterial, 4- Minor Arterial, 5- Major Collector, 6- Minor Collector	Curves Left, Right, Grades (degrees), Left, Right, grade up, grade down	Traffic Counters Continuous (CTC), Weigh-In-Motion (WIM), Short-Term, Scheduled, Short-Term, Unscheduled	Crash Locations Fatal, Injury, Property Damage Only, Unknown Crash Type High Crash Locations (HCL's) Sections (& Intersections) HCL No. 201 - 300 (21 - 30) 1 - 100 (1 - 10), 301 - 400 (31 - 40), 401 - 800 (41 - 113)	Mileage by Functional Class By Sheet 0746 6 - minor collector 0.610	Mileage by Town By Sheet STOWE - S07460808 0.61 of 0.61	DISTRICT 6	TOWN STOWE	Date: 09/27/23	ROUTE Min-0746 ETE mileage: 0.0 to 0.61
					Page Total Mileage: 0.610 mi		Page Total Mileage: 0.61 mi		1 of 1 TWN mileage: 0.0 to 0.61	

For More Information Contact - Vermont Agency of Transportation, Policy, Planning and Intermodal Development Division - Mapping Section, 219 North Main Street, Barre, VT 05641 Telephone: 802-828-2600.