



# Route Log and Progress Chart

**DRAFT**

Please Note: Errors and Omissions May Exist.  
Contact the VTrans Mapping Section with questions or concerns.

DISTRICT	TOWN	ROUTE
3	BRIDPORT	Min-0638

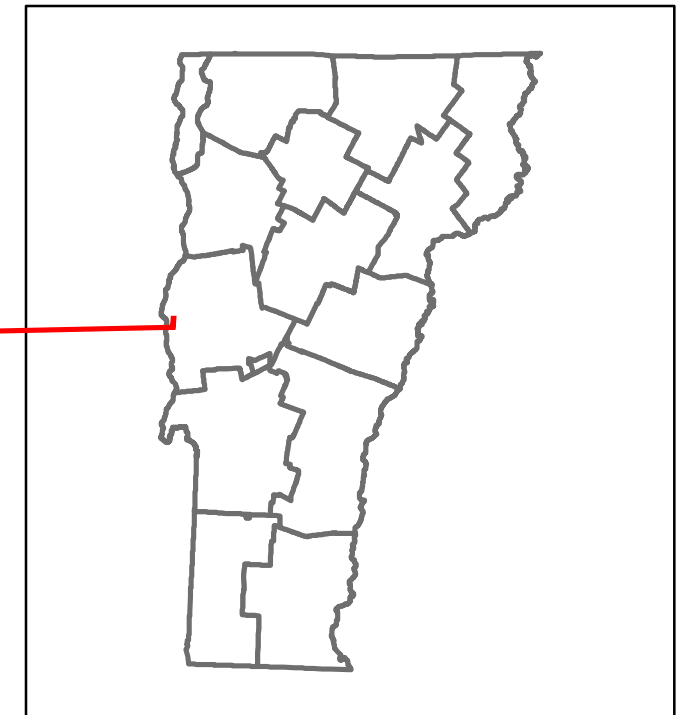

Min-0638

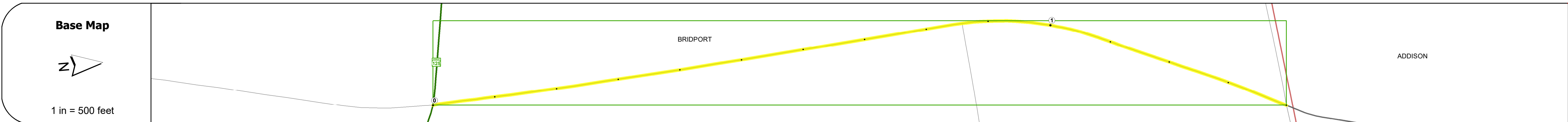

## STRUCTURE DESCRIPTIONS

Road Widths	Travellane	Roadway	Lane Count	Base	Subbase
	20	22	2		

Curves	
--------	--

Grades	
--------	--

Guardrails	
------------	--

Rumblestrips	
--------------	--

Historic Projects	
-------------------	--

Maintenance Garage	
--------------------	--

Speed Zone	
------------	--

Functional Class	6
------------------	---

National Highway System	
-------------------------	--

Limited Access Highway	
------------------------	--

Customer Service Level	
------------------------	--

Traffic Counters	
------------------	--

AAADT	2022	
	2021	
	2020	
	2019	
	2018	

Crash Locations	(Incomplete) 2023	
	2022	
	2021	
	2020	
	2019	

<b>Historic Projects</b> Unknown, Retreatment, Resurface, Bituminous Mix, Skiny Mix, Bituminous Seal Bituminous Concrete, Cold Plane and Bituminous Concrete, Concrete, Gravel, Plant Mix, Reclaimed Base and Bituminous Concrete, Surface Treated Gravel	<b>Functional Class</b> 1- Interstate System, 2- Other Freeways and Expressways, 3- Principal Arterial, 4- Minor Arterial, 5- Major Collector, 6- Minor Collector	<b>Curves</b> Left, Right, Grades (degrees), Left, Right, grade up, grade down	<b>Traffic Counters</b> Continuous (CTC), Weigh-In-Motion (WIM), Short-Term, Scheduled, Short-Term, Unscheduled	<b>Crash Locations</b> Fatal, Injury, Property Damage Only, Unknown Crash Type, High Crash Locations (HCL's)	<b>Mileage by Functional Class By Sheet</b> 0638 6 - minor collector 1.400	<b>Mileage by Town By Sheet</b> BRIDPORT - S06380102 1.4 of 1.4	<b>DISTRICT</b> 3	<b>TOWN</b> BRIDPORT	<b>Date:</b> 09/25/23	<b>ROUTE</b> Min-0638
					<b>Page Total Mileage:</b> 1.400 mi	<b>Page Total Mileage:</b> 1.4 mi	<b>1 of 1</b> TWN mileage: 0.0 to 1.4 ETE mileage: 0.0 to 1.4			

For More Information Contact - Vermont Agency of Transportation, Policy, Planning and Intermodal Development Division - Mapping Section, 219 North Main Street, Barre, VT 05641 Telephone: 802-828-2600.