



Route Log and Progress Chart

DRAFT

Please Note: Errors and Omissions May Exist.
Contact the VTrans Mapping Section with questions or concerns.

DISTRICT	TOWN	ROUTE
1	PAWLET	Min-0564

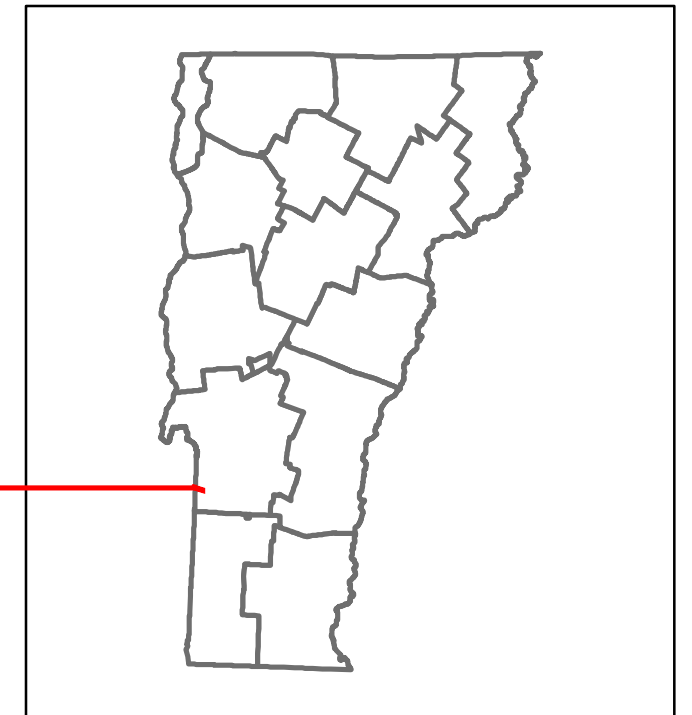

Min-0564

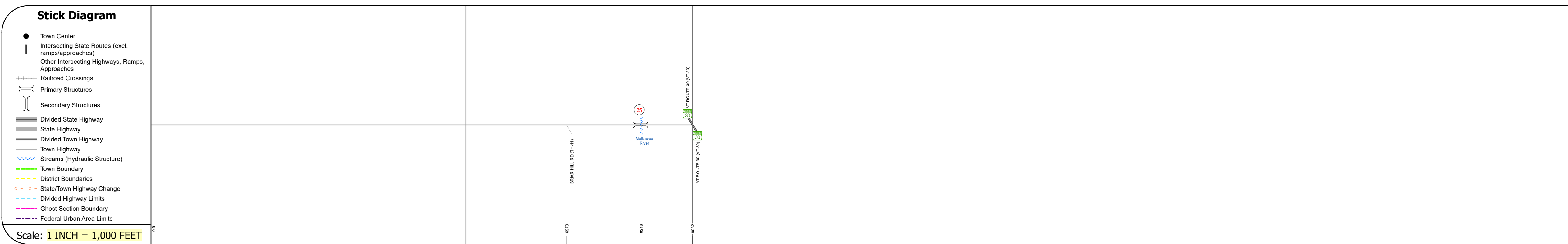
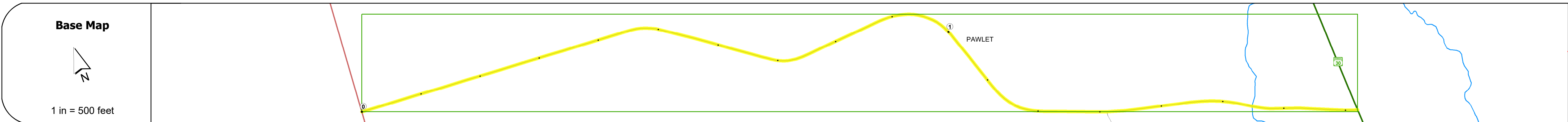

STRUCTURE DESCRIPTIONS	
Bridge 25:	Stringer/multi-beam or girder - 1933
	Structure No: 101114002511141
	Length: 64'
	Height: 100.0'
	Width: 27.0'
	Weight Limit: 0
	Facility Carried: C2002
	Structure Type: ROLLED BEAM
	Features Intersected: METTAWEE RIVER
	Surface: Bituminous
	Inspection Date: 9/2022
	Maintenance/Ownership: Town

Road Widths	Travellane	22
	Roadway	22
	Lane Count	2
	Base	
	Subbase	
Curves		
Grades		
Guardrails		
Rumblestrips		
Historic Projects		
Maintenance Garage		
Speed Zone		
Functional Class	6	
National Highway System		
Limited Access Highway		
Customer Service Level		
Traffic Counters		
ADT	2022	
	2021	
	2020	
	2019	
	2018	
Crash Locations	(Incomplete) 2023	
	2022	
	2021	
	2020	
	2019	

Historic Projects Unknown, Bituminous Concrete, Retreatment, Bituminous Macadam, Resurface, Cold Plane and Bituminous Concrete, Bituminous Mix, Concrete, Skippy Mix, Bituminous Seal, Gravel, Surface Treated Gravel, Plant Mix, Reclaimed Base and Bituminous Concrete	Functional Class 1- Interstate System, 2- Other Freeways and Expressways, 3- Principal Arterial, 4- Minor Arterial, 5- Major Collector, 6- Minor Collector	Curves Left, Right, Grades (degrees), Left grade up, Right grade down	Traffic Counters Continuous (CTC), Weigh-In-Motion (WIM), Short-Term, Scheduled, Short-Term, Unscheduled	Crash Locations Fatal, Injury, Property Damage Only, Unknown Crash Type, High Crash Locations (HCL's)	Mileage by Functional Class By Sheet 0564 6 - minor collector 1.720	Mileage by Town By Sheet PAWLET - S05641114 1.72 of 1.72	DISTRICT 1	TOWN PAWLET	Date: 09/25/23	ROUTE Min-0564
					ADT 25, 30, 35, 40, 45, 50, 55, 60, 65	Page Total Mileage: 1.720 mi	Page Total Mileage: 1.72 mi	1 of 1 TWN mileage: 0.0 to 1.72	ETE mileage: 0.0 to 1.72	

For More Information Contact - Vermont Agency of Transportation, Policy, Planning and Intermodal Development Division - Mapping Section, 219 North Main Street, Barre, VT 05641 Telephone: 802-828-2600.