



# Route Log and Progress Chart

**DRAFT**

Please Note: Errors and Omissions May Exist.  
Contact the VTrans Mapping Section with questions or concerns.

DISTRICT	TOWN	ROUTE
6	PLAINFIELD	Maj-0339

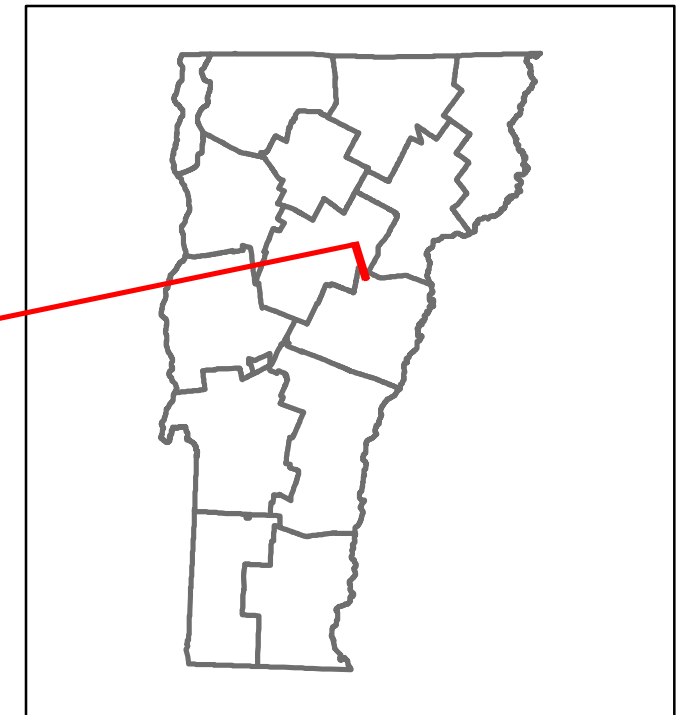

**Maj-0339**

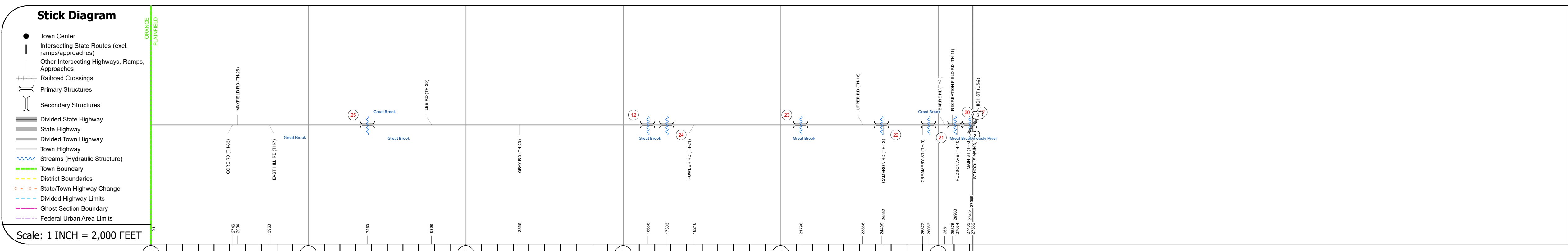

## STRUCTURE DESCRIPTIONS

**Bridge 25:**  
Tee Beam - 1925  
Structure No. 101214002512141  
Length: 28'  
Height: 100.0'  
Width: 18.0'  
Weight Limit: 0  
Facility Carried: C2002  
Structure Type: CONCRETE T-BEAM  
Features Intersected: GREAT BROOK  
Surface: Gravel  
Inspection Date: 8/2021  
Maintenance/Ownership: Town

**Bridge 12:**  
Slab - 1991  
Structure No. 101214001212141  
Length: 28'  
Height: 100.0'  
Width: 25.0'  
Weight Limit: 0  
Facility Carried: C2002  
Structure Type: CONCRETE SLAB  
Features Intersected: GREAT BROOK  
Surface: Gravel  
Inspection Date: 8/2021  
Maintenance/Ownership: Town

**Bridge 24:**  
Tee Beam - 1929  
Structure No. 101214002412141  
Length: 28'  
Height: 100.0'  
Width: 22.0'  
Weight Limit: 0  
Facility Carried: C2002  
Structure Type: CONCRETE T-BEAM  
Features Intersected: GREAT BROOK  
Surface: Gravel  
Inspection Date: 8/2021  
Maintenance/Ownership: Town

**Bridge 23:**  
Slab - 1991  
Structure No. 101214002312141  
Length: 51'  
Height: 100.0'  
Width: 26.0'  
Weight Limit: 0  
Facility Carried: C2002  
Structure Type: PRESTRESS CONC SLAB  
Features Intersected: GREAT BROOK  
Surface: Bituminous  
Inspection Date: 8/2021  
Maintenance/Ownership: Town

**Bridge 22:**  
Tee Beam - 1929  
Structure No. 101214002212141  
Length: 44'  
Height: 100.0'  
Width: 20.0'  
Weight Limit: 0  
Facility Carried: C2002  
Structure Type: CONCRETE T-BEAM  
Features Intersected: GREAT BROOK  
Surface: Bituminous  
Inspection Date: 8/2021  
Maintenance/Ownership: Town

**Bridge 21:**  
Tee Beam - 1920  
Structure No. 101214002112141  
Length: 28'  
Height: 100.0'  
Width: 20.0'  
Weight Limit: 0  
Facility Carried: C2002  
Structure Type: CONCRETE T-BEAM  
Features Intersected: GREAT BROOK  
Surface: Bituminous  
Inspection Date: 8/2021  
Maintenance/Ownership: Town

**Bridge 20:**  
Tee Beam - 1929  
Structure No. 101214002012141  
Length: 33'  
Height: 100.0'  
Width: 26.0'  
Weight Limit: 0  
Facility Carried: C2001  
Structure Type: CONCRETE T-BEAM  
Features Intersected: GREAT BROOK  
Surface: Bituminous  
Inspection Date: 8/2021  
Maintenance/Ownership: Town

**Bridge 27:**  
Tee Beam - 1927  
Structure No. 101214002712141  
Length: 62'  
Height: 100.0'  
Width: 30.0'  
Weight Limit: 0  
Facility Carried: C2001  
Structure Type: CONCRETE T-BEAM  
Features Intersected: WINOOSKI RIVER  
Surface: Bituminous  
Inspection Date: 11/2022  
Maintenance/Ownership: Town

<b>Road Widths</b>	Travellane	22
Roadway		24
Lane Count		2
Base		
Subbase		
<b>Curves</b>		
<b>Grades</b>		
<b>Guardrails</b>		
<b>Rumblestrips</b>		
<b>Historic Projects</b>		
<b>Maintenance Garage</b>		
<b>Speed Zone</b>		
<b>Functional Class</b>	5	
<b>National Highway System</b>		
<b>Limited Access Highway</b>		
<b>Customer Service Level</b>		
<b>Traffic Counters</b>		
<b>AADT</b>	2022	280
	2021	278
	2020	245
	2020	2280
	2019	289
	2018	
<b>Crash Locations</b>	(Incomplete) 2023	
	2022	
	2021	
	2020	
	2019	

<b>Historic Projects</b> Unknown, Bituminous Concrete, Retreatment, Bituminous Macadam, Resurface, Cold Plane and Bituminous Concrete, Bituminous Mix, Reclaimed Base and Bituminous Concrete, Skippy Mix, Concrete, Bituminous Seal, Gravel, Surface Treated Gravel, Plant Mix, Reclaimed Base and Bituminous Concrete	<b>Functional Class</b> 1 - Interstate System, 2 - Other Freeways and Expressways, 3 - Principal Arterial, 4 - Minor Arterial, 5 - Major Collector, 6 - Minor Collector	<b>Curves</b> Left, Right, Grades (degrees), Left grade up, Right grade down	<b>Traffic Counters</b> Continuous (CTC), Weigh-In-Motion (WIM), Short-Term, Scheduled, Short-Term, Unscheduled (counter ID)	<b>Crash Locations</b> Fatal, Injury, Property Damage Only, Unknown Crash Type, High Crash Locations (HCL's) Sections (& Intersections)	<b>Mileage by Functional Class By Sheet</b> 0339 5 - Major collector 5.220	<b>Mileage by Town By Sheet</b> PLAINFIELD - S03391214 5.22 of 5.22	<b>DISTRICT</b> 6	<b>TOWN</b> PLAINFIELD	<b>Date:</b> 09/26/23	<b>ROUTE</b> Maj-0339 ETE mileage: 4.95 to 10.17
<b>Speed Zones</b> 25, 30, 35, 40, 45, 50, 55, 60, 65						<b>Page Total Mileage: 5.220 mi</b>		<b>Page Total Mileage: 5.22 mi</b>		

For More Information Contact - Vermont Agency of Transportation, Policy, Planning and Intermodal Development Division - Mapping Section, 219 North Main Street, Barre, VT 05641 Telephone: 802-828-2600.