



# Route Log and Progress Chart

**DRAFT**

Please Note: Errors and Omissions May Exist.  
Contact the VTrans Mapping Section with questions or concerns.

DISTRICT	TOWN	ROUTE
9	DERBY	Maj-0319

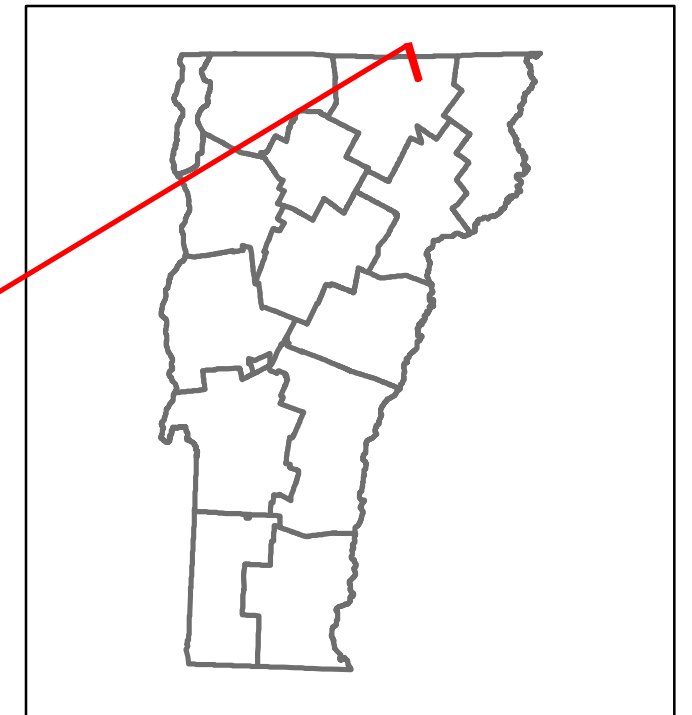

**Maj-0319**

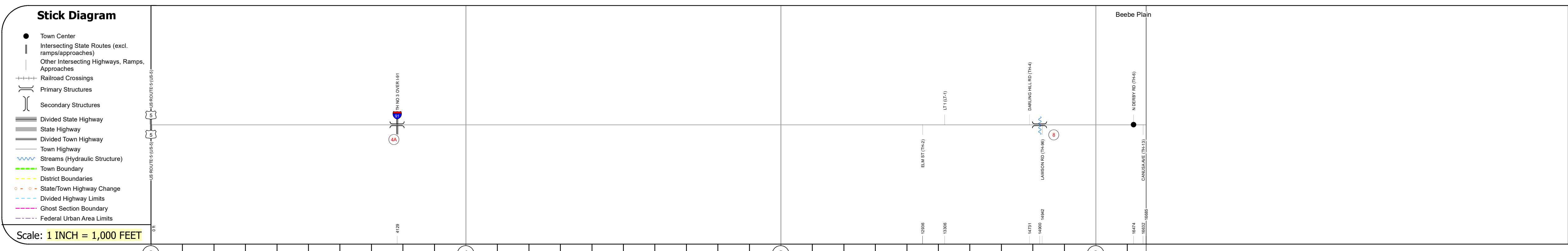
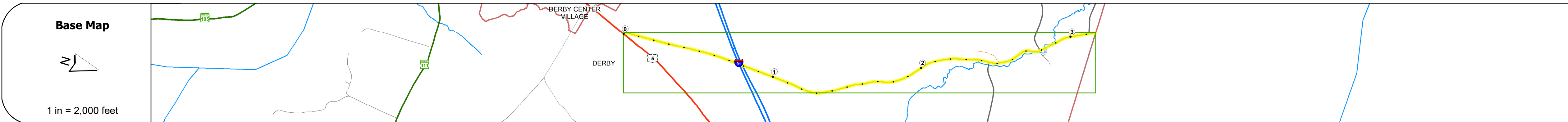

### STRUCTURE DESCRIPTIONS

**Bridge 4A:**  
Stringer/multi-beam or girder - 1963  
Structure No: 200319004A10072  
Length: 344'  
Height: 100.0'  
Width: 30.0'  
Under Clearance: 17.0'  
Weight Limit: 0  
Facility Carried: TR 03 FAS 319  
Structure Type: 5 SPAN ROLLED BEAM  
Features Intersected: TH NO 3 OVER I 91  
Surface: Bituminous  
Inspection Date: 5/2022  
Maintenance/Ownership: State

**Bridge 8:**  
Slab - 1989  
Structure No: 101007000810071  
Length: 26'  
Height: 100.0'  
Width: 34.0'  
Weight Limit: 0  
Facility Carried: C2003 BYPASS  
Structure Type: CONCRETE SLAB  
Features Intersected: JOHNS RIVER  
Surface: Bituminous  
Inspection Date: 10/2022  
Maintenance/Ownership: Town

<b>Road Widths</b>	Travellane	20
	Roadway	20
	Lane Count	2
	Base	
	Subbase	

<b>Curves</b>	
---------------	--

<b>Grades</b>	
---------------	--

<b>Guardrails</b>	
-------------------	--

<b>Rumblestrips</b>	
---------------------	--

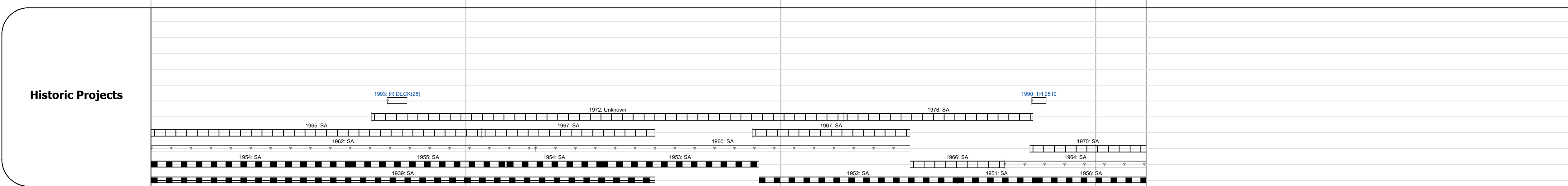

<b>Maintenance Garage</b>	
---------------------------	--

<b>Speed Zone</b>	
-------------------	--

<b>Functional Class</b>	5
-------------------------	---

<b>National Highway System</b>	
--------------------------------	--

<b>Limited Access Highway</b>	
-------------------------------	--

<b>Customer Service Level</b>	
-------------------------------	--

<b>Traffic Counters</b>	
-------------------------	--

<b>AADT</b>	2022	755	960	960
	2021	749	1074	867
	2020	661	948	765
	2019	780	1119	903
	2018	780	1100	900

<b>Crash Locations</b>	(Incomplete) 2023	
	2022	
	2021	
	2020	
	2019	

<b>Historic Projects</b> Unknown, Retreatment, Resurface, Bituminous Mix, Skiny Mix, Bituminous Seal Bituminous Concrete, Cold Plane and Bituminous Concrete, Concrete, Surface Treated Gravel, Plant Mix, Reclaimed Base and Bituminous Concrete	<b>Functional Class</b> 1- Interstate System, 2- Other Freeways and Expressways, 3- Principal Arterial, 4- Minor Arterial, 5- Major Collector, 6- Minor Collector	<b>Curves</b> Left, Right, Grades (degrees), Left, Right, grade up, grade down	<b>Traffic Counters</b> Continuous (CTC), Weigh-In-Motion (WIM), Short-Term, Scheduled, Short-Term, Unscheduled	<b>Crash Locations</b> Fatal, Injury, Property Damage Only, Unknown Crash Type, High Crash Locations (HCL's)	<b>Mileage by Functional Class By Sheet</b> 0319 5 - Major collector 3.160	<b>Mileage by Town By Sheet</b> DERBY - S03191007 3.16 of 3.16	<b>DISTRICT</b> 9	<b>TOWN</b> DERBY	<b>Date:</b> 09/25/23	<b>ROUTE</b> Maj-0319
					<b>Page Total Mileage:</b> 3.160 mi	<b>Page Total Mileage:</b> 3.16 mi	<b>1 of 1</b> TWN mileage: 0.0 to 3.16	<b>ETE mileage:</b> 0.0 to 3.16		

For More Information Contact - Vermont Agency of Transportation, Policy, Planning and Intermodal Development Division - Mapping Section, 219 North Main Street, Barre, VT 05641 Telephone: 802-828-2600.