



# Route Log and Progress Chart

**DRAFT**

Please Note: Errors and Omissions May Exist.  
Contact the VTrans Mapping Section with questions or concerns.

DISTRICT	TOWN	ROUTE
8	ALBURGH	Maj-0293

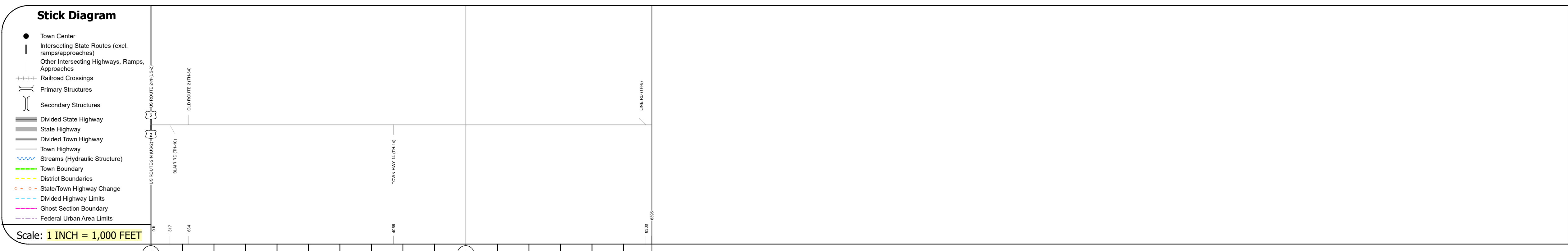
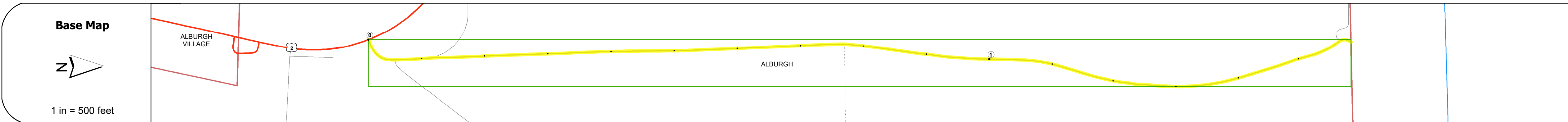
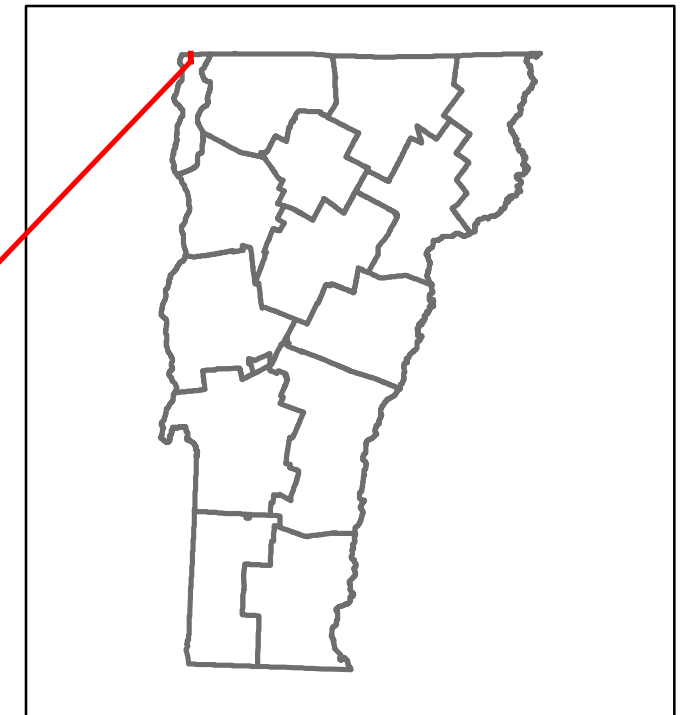

Travellane	Roadway	Lane Count	Base	Subbase
24	24	2		

<b>Curves</b>	31
---------------	----

<b>Grades</b>	
---------------	--

<b>Guardrails</b>	
-------------------	--

<b>Rumblestrips</b>	
---------------------	--



<b>Maintenance Garage</b>	
---------------------------	--

<b>Speed Zone</b>	
-------------------	--

<b>Functional Class</b>	5
-------------------------	---

<b>National Highway System</b>	
--------------------------------	--

<b>Limited Access Highway</b>	
-------------------------------	--

<b>Customer Service Level</b>	
-------------------------------	--

<b>Traffic Counters</b>	
-------------------------	--

<b>AAADT</b>	2022	338
	2021	335
	2020	296
	2019	349
	2018	350

<b>Crash Locations</b>	(Incomplete) 2023	
	2022	
	2021	
	2020	
	2019	

## STRUCTURE DESCRIPTIONS

--

<b>Historic Projects</b> Unknown, Retreatment, Resurface, Bituminous Mix, Skiny Mix, Bituminous Seal Bituminous Concrete, Cold Plane and Bituminous Concrete, Reclaimed Base and Bituminous Concrete, Surface Treated Gravel, Plant Mix	<b>Functional Class</b> 1- Interstate System, 2- Other, 3- Principal Arterial, 4- Minor Arterial, 5- Major Collector, 6- Minor Collector	<b>Curves</b> Left, Right, Grades (degrees), Left, Right, grade up, grade down	<b>Traffic Counters</b> Continuous (CTC), Weigh-In-Motion (WIM), Short-Term, Scheduled, Short-Term, Unscheduled	<b>Crash Locations</b> Fatal, Injury, Property Damage Only, Unknown Crash Type <b>High Crash Locations (HCL's)</b> Sections (& Intersections)	<b>Mileage by Functional Class By Sheet</b> 0293 5 - Major collector 1.590	<b>Mileage by Town By Sheet</b> ALBURGH - S02930701 1.59 of 1.59	<b>DISTRICT</b> 8	<b>TOWN</b> ALBURGH	<b>Date:</b> 09/25/23	<b>ROUTE</b> Maj-0293
					<b>Page Total Mileage:</b> 1.590 mi	<b>Page Total Mileage:</b> 1.59 mi	<b>1 of 1</b> TWN mileage: 0.0 to 1.59	ETE mileage: 0.0 to 1.59		

For More Information Contact - Vermont Agency of Transportation, Policy, Planning and Intermodal Development Division - Mapping Section, 219 North Main Street, Barre, VT 05641 Telephone: 802-828-2600.