



Route Log and Progress Chart

DRAFT

Please Note: Errors and Omissions May Exist.
Contact the VTrans Mapping Section with questions or concerns.

DISTRICT	TOWN	ROUTE
7	LYNDON	Maj-0261

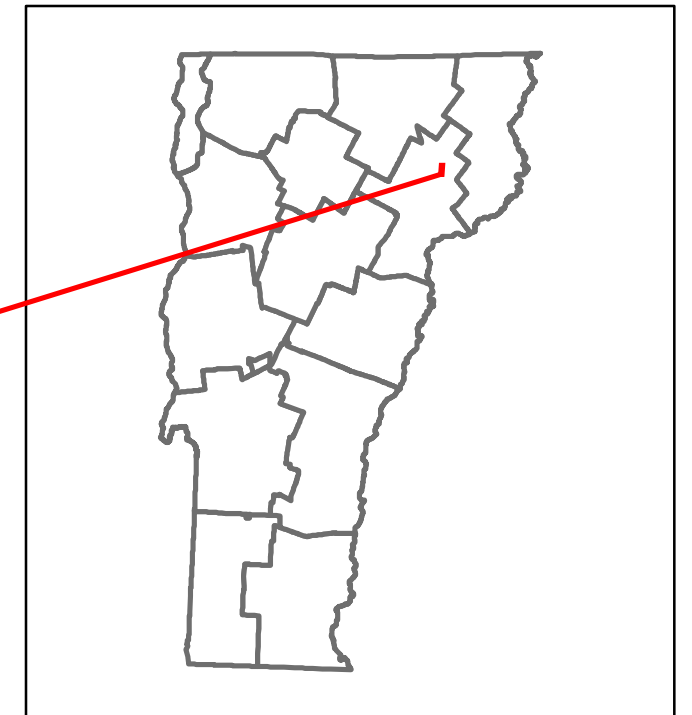

Maj-0261

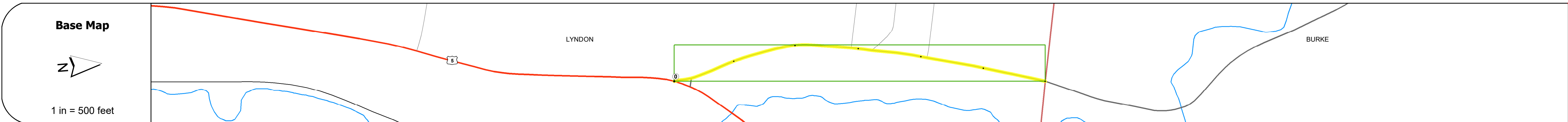

STRUCTURE DESCRIPTIONS

Road Widths	Travellane: 20 Roadway: 20 Lane Count: 2 Base: Subbase:
-------------	---

Curves	
--------	--

Grades	
--------	--

Guardrails	
------------	--

Rumblestrips	
--------------	--

Historic Projects	
-------------------	--

Maintenance Garage	
--------------------	--

Speed Zone	
------------	--

Functional Class	5
------------------	---

National Highway System	
-------------------------	--

Limited Access Highway	
------------------------	--

Customer Service Level	
------------------------	--

Traffic Counters	
------------------	--

AAADT	2022: 886 2021: 879 2020: 776 2019: 916 2018: 920
-------	---

Crash Locations	(Incomplete) 2023 2022 2021 2020 2019
-----------------	---

Historic Projects Unknown, Bituminous Concrete, Retreatment, Resurface, Bituminous Mix, Skiny Mix, Bituminous Seal, Surface Treated Gravel, Plant Mix, Reclaimed Base and Bituminous Concrete, Concrete	Functional Class 1- Interstate System, 2- Other, 3- Principal Arterial, 4- Minor Arterial, 5- Major Collector, 6- Minor Collector	Curves Left, Right, Grades (degrees), Left, Right, grade up, grade down	Traffic Counters Continuous (CTC), Weigh-In-Motion (WIM), Short-Term, Scheduled, Short-Term, Unscheduled	Crash Locations Fatal, Injury, Property Damage Only, Unknown Crash Type, High Crash Locations (HCL's)	Mileage by Functional Class By Sheet 0261 5 - Major collector 0.600	Mileage by Town By Sheet LYNDON - S02610307 0.6 of 0.6	DISTRICT 7	TOWN LYNDON	Date: 09/25/23	ROUTE Maj-0261 ETE mileage: 0.0 to 0.6
Page Total Mileage: 0.600 mi						Page Total Mileage: 0.6 mi				

For More Information Contact - Vermont Agency of Transportation, Policy, Planning and Intermodal Development Division - Mapping Section, 219 North Main Street, Barre, VT 05641 Telephone: 802-828-2600.