



# Route Log and Progress Chart

**DRAFT**

Please Note: Errors and Omissions May Exist.  
Contact the VTrans Mapping Section with questions or concerns.

DISTRICT	TOWN	ROUTE
1	DOVER	Maj-0222

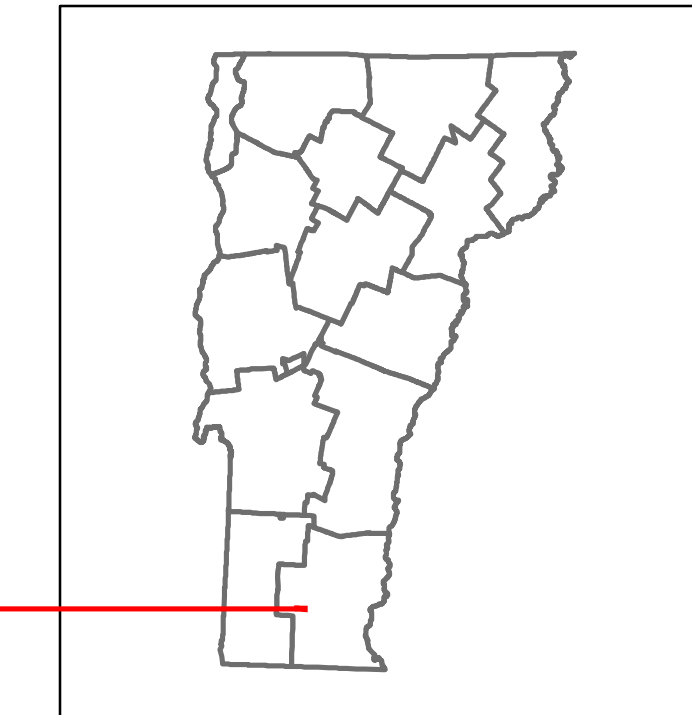

**Maj-0222**

**Base Map**

1 in = 500 feet

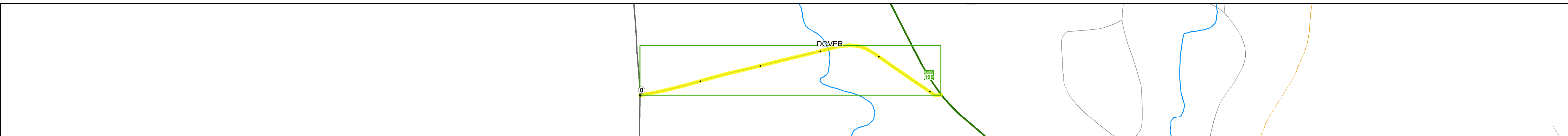

**Stick Diagram**

- Town Center
- Intersecting State Routes (excl. ramps/approaches)
- Other Intersecting Highways, Ramps, Approaches
- Railroad Crossings
- Primary Structures
- Secondary Structures
- Divided State Highway
- State Highway
- Divided Town Highway
- Town Highway
- Streams (Hydraulic Structure)
- Town Boundary
- District Boundaries
- State/Town Highway Change
- Divided Highway Limits
- Ghost Section Boundary
- Federal Urban Area Limits

Scale: 1 INCH = 1,000 FEET

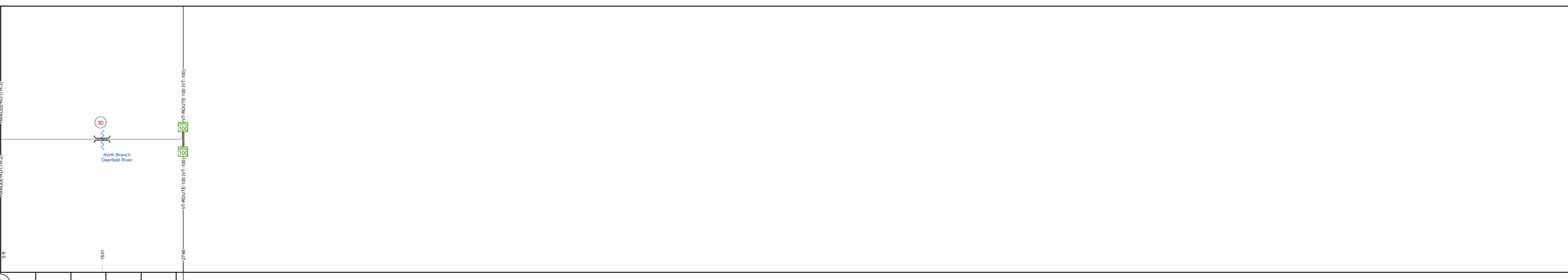

**STRUCTURE DESCRIPTIONS**

**Bridge 30:**  
Truss - thru - 1992  
Structure No - 200222003013042  
Length: 52'  
Height: 100.0'  
Width: 26.0'  
Weight Limit: 0  
Facility Carried: TR 03 FAS 222 FH1  
Structure Type: KING POST TRUSS  
Features Intersected: N BR DEERFIELD RIVER  
Surface: Bituminous  
Inspection Date: 6/2022  
Maintenance/Ownership: Town

**Road Widths**

Travellane	18	20	21	20
Roadway	18	20	21	20
Lane Count			2	
Base				
Subbase				

**Curves**

17.5
------

**Grades**

--

**Guardrails**

--

**Rumblestrips**

--

**Historic Projects**

1903 BR2 1441(17)
-------------------

**Maintenance Garage**

--

**Speed Zone**

--

**Functional Class**

5
---

**National Highway System**

--

**Limited Access Highway**

--

**Customer Service Level**

--

**Traffic Counters**

--

**AADT**

2022	1554
2021	1467
2020	1280
2019	1476
2018	1500

**Crash Locations**

(Incomplete) 2023	
2022	
2021	
2020	
2019	

<p><b>Historic Projects</b></p> <ul style="list-style-type: none"> <li>Unknown</li> <li>Retreatment</li> <li>Resurface</li> <li>Bituminous Mix</li> <li>Skinny Mix</li> <li>Bituminous Seal</li> </ul> <p><b>Surface Treated</b></p> <ul style="list-style-type: none"> <li>Gravel</li> <li>Cold Plane and</li> <li>Reclaimed Base and</li> <li>Bituminous Concrete</li> <li>Concrete</li> <li>Gravel</li> </ul> <p><b>Functional Class</b></p> <ul style="list-style-type: none"> <li>1 - Interstate System</li> <li>2 - Other</li> <li>3 - Principal Arterial</li> <li>4 - Minor Arterial</li> <li>5 - Major Collector</li> <li>6 - Minor Collector</li> </ul> <p><b>Speed Zones</b></p> <ul style="list-style-type: none"> <li>25</li> <li>30</li> <li>35</li> <li>40</li> <li>45</li> <li>50</li> <li>55</li> <li>60</li> <li>65</li> </ul> <p><b>Curves</b></p> <ul style="list-style-type: none"> <li>Left</li> <li>Right</li> </ul> <p><b>Grades</b></p> <ul style="list-style-type: none"> <li>grade up</li> <li>grade down</li> </ul> <p><b>Traffic Counters</b></p> <ul style="list-style-type: none"> <li>Continuous (CTC)</li> <li>Weight-In-Motion (WIM)</li> <li>Short-Term, Scheduled</li> <li>Short-Term, Unscheduled</li> </ul> <p><b>Crash Locations</b></p> <ul style="list-style-type: none"> <li>Fatal</li> <li>Injury</li> <li>Property Damage Only</li> <li>Unknown Crash Type</li> </ul> <p><b>High Crash Locations (HCL's)</b></p> <ul style="list-style-type: none"> <li>Sections (&amp; Intersections)</li> <li>HCL No. 1 - 100 (1 - 10)</li> <li>101 - 200 (11 - 20)</li> <li>201 - 300 (21 - 30)</li> <li>301 - 400 (31 - 40)</li> <li>401 - 800 (41 - 113)</li> </ul>	<p><b>Mileage by Functional Class By Sheet</b></p> <table border="1"> <tr> <td>0222</td> <td>5 - Major Collector</td> <td>0.520</td> </tr> </table> <p>Page Total Mileage: 0.520 mi</p>	0222	5 - Major Collector	0.520	<p><b>Mileage by Town By Sheet</b></p> <table border="1"> <tr> <td>DOVER - S02221304</td> <td>0.52 of 0.52</td> </tr> </table> <p>Page Total Mileage: 0.52 mi</p>	DOVER - S02221304	0.52 of 0.52	<p><b>DISTRICT</b></p> <p>1</p>	<p><b>TOWN</b></p> <p>DOVER</p>	<p><b>Date: 09/25/23</b></p>	<p><b>ROUTE</b></p> <p>Maj-0222</p> <p>ETE mileage: 0.0 to 0.52</p>
	0222	5 - Major Collector	0.520								
DOVER - S02221304	0.52 of 0.52										
			<p><b>1</b></p>	<p><b>DOVER</b></p>	<p><b>1 of 1</b></p> <p>TWN mileage: 0.0 to 0.52</p>						

For More Information Contact - Vermont Agency of Transportation, Policy, Planning and Intermodal Development Division - Mapping Section, 219 North Main Street, Barre, VT 05641 Telephone: 802-828-2600.