



Route Log and Progress Chart

DRAFT

Please Note: Errors and Omissions May Exist.
Contact the VTrans Mapping Section with questions or concerns.

DISTRICT	TOWN	ROUTE
7	BARNET	Maj-0215

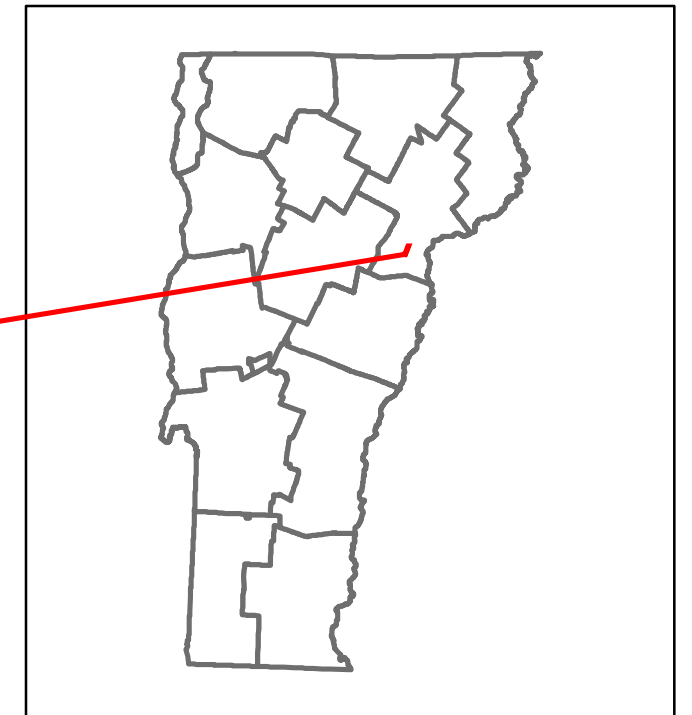

Maj-0215

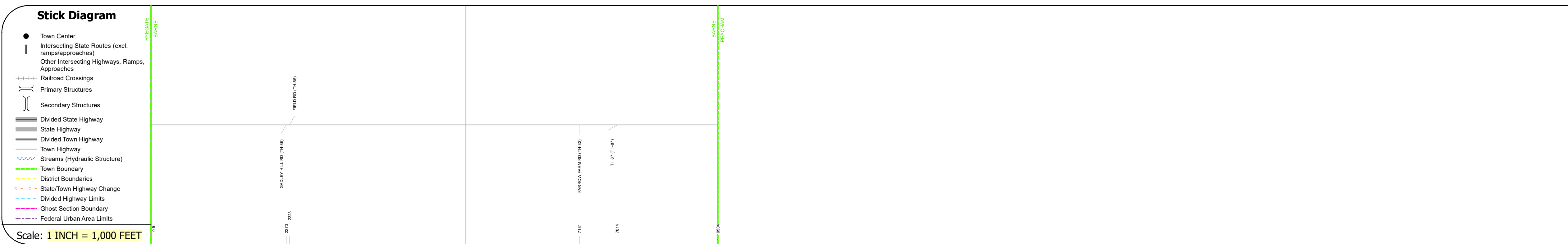
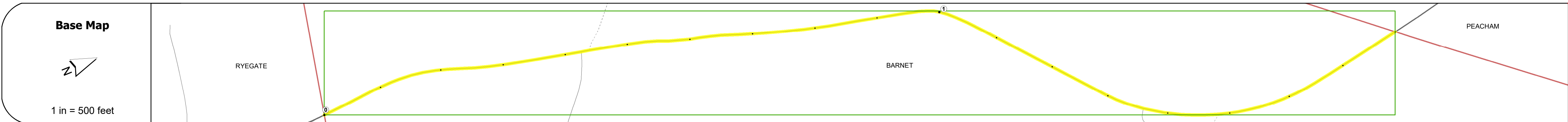

STRUCTURE DESCRIPTIONS

Road Widths	Travellane	Roadway	Lane Count	Base	Subbase
	22	22	2		

Curves	
--------	--

Grades	
--------	--

Guardrails	
------------	--

Rumblestrips	
--------------	--

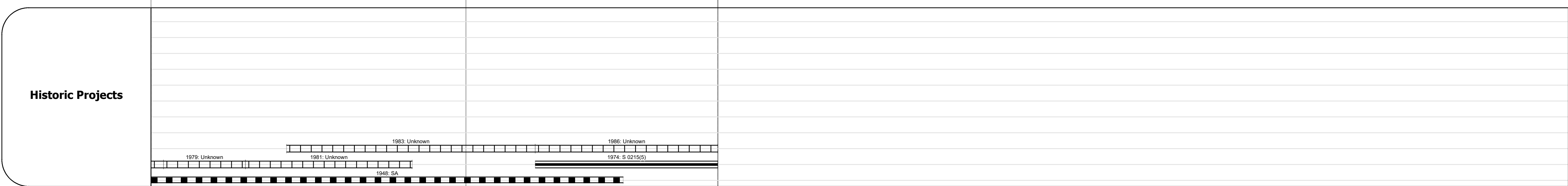

Maintenance Garage	
--------------------	--

Speed Zone	
------------	--

Functional Class	5
------------------	---

National Highway System	
-------------------------	--

Limited Access Highway	
------------------------	--

Customer Service Level	
------------------------	--

Traffic Counters	
------------------	--

ADT	2022	297	310
	2021	295	
	2020	260	
	2019	307	
	2018	290	

Crash Locations	(Incomplete) 2023	
	2022	
	2021	
	2020	
	2019	

Historic Projects Unknown, Bituminous Concrete, Retreatment, Cold Plane and Bituminous Concrete, Skiny Mix, Bituminous Seal, Surface Treated Gravel, Plant Mix, Reclaimed Base and Bituminous Concrete	Functional Class 1- Interstate System, 2- Other Freeways and Expressways, 3- Principal Arterial, 4- Minor Arterial, 5- Major Collector, 6- Minor Collector	Curves Left, Right, Grades (up/down)	Traffic Counters Continuous (CTC), Weigh-In-Motion (WIM), Short-Term, Scheduled, Short-Term, Unscheduled	Crash Locations Fatal, Injury, Property Damage Only, Unknown Crash Type, High Crash Locations (HCL's)	Mileage by Functional Class By Sheet 0215 5 - Major Collector 1.800	Mileage by Town By Sheet BARNET - S02150301 1.8 of 1.8	DISTRICT 7	TOWN BARNET	Date: 09/25/23	ROUTE Maj-0215 ETE mileage: 4.86 to 6.66
Page Total Mileage: 1.800 mi						Page Total Mileage: 1.8 mi				

For More Information Contact - Vermont Agency of Transportation, Policy, Planning and Intermodal Development Division - Mapping Section, 219 North Main Street, Barre, VT 05641 Telephone: 802-828-2600.