



# Route Log and Progress Chart

**DRAFT**

Please Note: Errors and Omissions May Exist.  
Contact the VTrans Mapping Section with questions or concerns.

DISTRICT	TOWN	ROUTE
5	BUELS GORE	Maj-0211

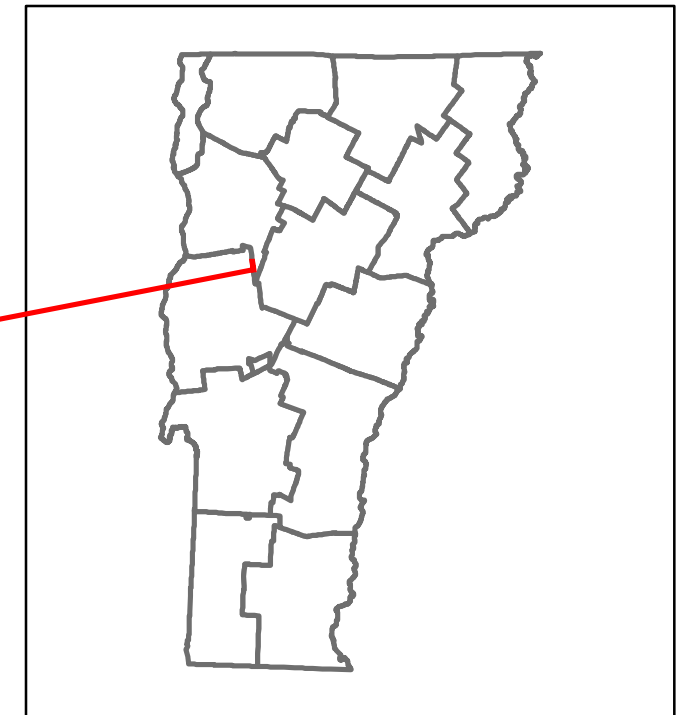

**Maj-0211**

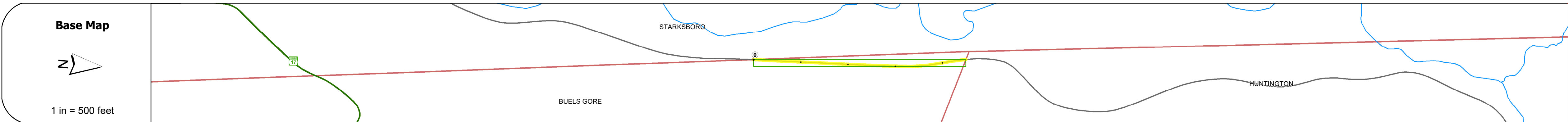

## STRUCTURE DESCRIPTIONS

Road Widths	Travellane: 24 Roadway: 24 Lane Count: 2 Base: Subbase:
-------------	---

Curves	
--------	--

Grades	
--------	--

Guardrails	
------------	--

Rumblestrips	
--------------	--

Historic Projects	
-------------------	--

Maintenance Garage	
--------------------	--

Speed Zone	
------------	--

Functional Class	5
------------------	---

National Highway System	
-------------------------	--

Limited Access Highway	
------------------------	--

Customer Service Level	
------------------------	--

Traffic Counters	
------------------	--

ADT	2022: 458 2021: 395 2020: 349 2019: 412 2018: 410
-----	---

Crash Locations	(Incomplete) 2023 2022 2021 2020 2019
-----------------	---

<b>Historic Projects</b> Unknown, Bituminous Concrete, Retreatment, Resurface, Bituminous Mix, Skiny Mix, Bituminous Seal, Surface Treated Gravel, Plant Mix, Reclaimed Base and Bituminous Concrete	<b>Functional Class</b> 1- Interstate System, 2- Other Freeways and Expressways, 3- Principal Arterial, 4- Minor Arterial, 5- Major Collector, 6- Minor Collector	<b>Curves</b> Left, Right, Grades (degrees), Left, Right, grade up, grade down	<b>Traffic Counters</b> Continuous (CTC), Weigh-In-Motion (WIM), Short-Term, Scheduled, Short-Term, Unscheduled (counter ID)	<b>Crash Locations</b> Fatal, Injury, Property Damage Only, Unknown Crash Type, High Crash Locations (HCL's)	<b>Mileage by Functional Class By Sheet</b> 0211 5 - Major collector 0.450	<b>Mileage by Town By Sheet</b> BUELS GORE - S02110402 0.45 of 0.45	<b>DISTRICT</b> 5	<b>TOWN</b> BUELS GORE	<b>Date:</b> 09/25/23	<b>ROUTE</b> Maj-0211 ETE mileage: 0.91 to 1.36
Page Total Mileage: 0.450 mi						Page Total Mileage: 0.45 mi				

For More Information Contact - Vermont Agency of Transportation, Policy, Planning and Intermodal Development Division - Mapping Section, 219 North Main Street, Barre, VT 05641 Telephone: 802-828-2600.