



# Route Log and Progress Chart

**DRAFT**

Please Note: Errors and Omissions May Exist.  
Contact the VTrans Mapping Section with questions or concerns.

DISTRICT	TOWN	ROUTE
1	PAWLET	VT-149

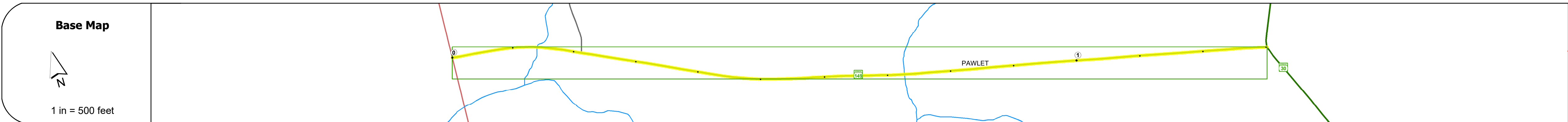
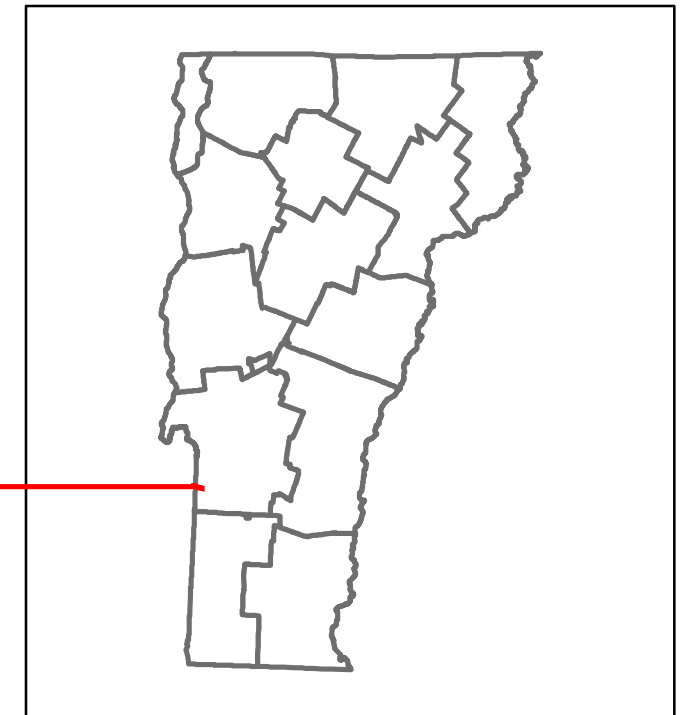

### STRUCTURE DESCRIPTIONS

**Bridge 1:**  
Culvert - 1977  
Structure No. 300151000111141  
Length: 8'  
Facility Carried: VT149  
Structure Type: CGMPPA W CONC INVERT  
Features Intersected: BROOK  
Maintenance/Ownership: State

**Bridge 2:**  
Tee Beam - 1971  
Structure No. 200154000211142  
Length: 34'  
Height: 5.33'  
Width: 3.9'  
Facility Carried: VT 00149 ML  
Structure Type: CONCRETE T-BEAM  
Features Intersected: WELLS BROOK  
Surface: Bituminous  
Maintenance/Ownership: State

<b>Road Widths</b>	<table border="1"> <tr> <th>Travellane</th> <td>28</td> <td>29</td> <td>27</td> <td>40</td> <td>41</td> <td>29</td> </tr> <tr> <th>Roadway</th> <td></td> <td></td> <td></td> <td></td> <td></td> <td></td> </tr> <tr> <th>Lane Count</th> <td></td> <td></td> <td></td> <td></td> <td></td> <td></td> </tr> <tr> <th>Base</th> <td></td> <td></td> <td></td> <td></td> <td></td> <td></td> </tr> <tr> <th>Subbase</th> <td></td> <td></td> <td></td> <td></td> <td></td> <td></td> </tr> </table>	Travellane	28	29	27	40	41	29	Roadway							Lane Count							Base							Subbase						
Travellane	28	29	27	40	41	29																														
Roadway																																				
Lane Count																																				
Base																																				
Subbase																																				

<b>Curves</b>	4	2
---------------	---	---

<b>Grades</b>	
---------------	--

<b>Guardrails</b>	
-------------------	--

<b>Rumblestrips</b>	
---------------------	--



<b>Maintenance Garage</b>	District 1 - DMF Maintenance East Dorset Garage
---------------------------	---

<b>Speed Zone</b>	40
-------------------	----

<b>Functional Class</b>	5
-------------------------	---

<b>National Highway System</b>	
--------------------------------	--

<b>Limited Access Highway</b>	
-------------------------------	--

<b>Customer Service Level</b>	Local Connector
-------------------------------	-----------------

<b>Traffic Counters</b>	RD11
-------------------------	------

<b>AADT</b>	<table border="1"> <tr> <th>Year</th> <th>Left</th> <th>Right</th> </tr> <tr> <td>2021</td> <td>2839</td> <td>1800</td> </tr> <tr> <td>2020</td> <td>2506</td> <td>1588</td> </tr> <tr> <td>2019</td> <td>5010</td> <td>1875</td> </tr> <tr> <td>2018</td> <td>5000</td> <td>1900</td> </tr> <tr> <td>2017</td> <td>5100</td> <td>2000</td> </tr> </table>	Year	Left	Right	2021	2839	1800	2020	2506	1588	2019	5010	1875	2018	5000	1900	2017	5100	2000
Year	Left	Right																	
2021	2839	1800																	
2020	2506	1588																	
2019	5010	1875																	
2018	5000	1900																	
2017	5100	2000																	

<b>Crash Locations</b>	<table border="1"> <tr> <th>Year</th> <th>Crash Count</th> </tr> <tr> <td>(Incomplete) 2022</td> <td></td> </tr> <tr> <td>2021</td> <td></td> </tr> <tr> <td>2020</td> <td></td> </tr> <tr> <td>2019</td> <td></td> </tr> <tr> <td>2018</td> <td></td> </tr> </table>	Year	Crash Count	(Incomplete) 2022		2021		2020		2019		2018	
Year	Crash Count												
(Incomplete) 2022													
2021													
2020													
2019													
2018													

<b>Historic Projects</b> <ul style="list-style-type: none"> <li>Unknown</li> <li>Bituminous Concrete</li> <li>Retreatment</li> <li>Resurface</li> <li>Bituminous Mix</li> <li>Skinny Mix</li> <li>Bituminous Seal</li> </ul>	<b>Functional Class</b> <ul style="list-style-type: none"> <li>1 - Interstate System</li> <li>2 - Other Freeways and Expressways</li> <li>3 - Principal Arterial</li> <li>4 - Minor Arterial</li> <li>5 - Major Collector</li> <li>6 - Minor Collector</li> </ul>	<b>Curves</b> <ul style="list-style-type: none"> <li>Left (degrees)</li> <li>Right (degrees)</li> </ul>	<b>Grades</b> <ul style="list-style-type: none"> <li>Left (percent) grade up</li> <li>Right (percent) grade down</li> </ul>	<b>Traffic Counters</b> <ul style="list-style-type: none"> <li>Continuous (CTC)</li> <li>Weight-In-Motion (WIM)</li> <li>Short-Term, Scheduled</li> <li>Short-Term, Unscheduled</li> </ul>	<b>Crash Locations</b> <ul style="list-style-type: none"> <li>Fatal</li> <li>Injury</li> <li>Property Damage Only</li> <li>Unknown Crash Type</li> </ul>	<b>High Crash Locations (HCL's)</b> <ul style="list-style-type: none"> <li>Sections (&amp; Intersections)</li> <li>HCL No. 1-100 (1-10)</li> <li>HCL No. 101-200 (11-20)</li> <li>HCL No. 201-300 (21-30)</li> <li>HCL No. 301-400 (31-40)</li> <li>HCL No. 401-800 (41-113)</li> </ul>	<b>Mileage by Functional Class By Sheet</b> 0154 5 - Major Collector 1.302	<b>Mileage by Town By Sheet</b> PAWLET - V149-1114 1.302 of 1.302	<b>DISTRICT</b> 1	<b>TOWN</b> PAWLET	<b>Date:</b> 10/03/22	<b>ROUTE</b> VT-149 ETE mileage: 0.0 to 1.302
<b>Page Total Mileage: 1.302 mi</b>								<b>Page Total Mileage: 1.302 mi</b>	<b>1</b>	<b>PAWLET</b>	<b>1 of 1</b> TWN mileage: 0.0 to 1.302	<b>ETE mileage: 0.0 to 1.302</b>

For More Information Contact - Vermont Agency of Transportation, Policy, Planning and Intermodal Development Division - Mapping Section, 219 North Main Street, Barre, VT 05641 Telephone: 802-828-2600.